



CITY OF SOMERVILLE
Commonwealth of Massachusetts
93 Highland Avenue
Somerville, MA 02143
(617) 625-6600

BUSINESS LICENSE APPLICATION - Grant of Location

File #: 22-020047

License #: BL22-000129

Address: 390 BROADWAY

Licensee: Angel Hart NSTAR Electric dba Eversource Energy

DBA Name: Eversource Energy

Business Ownership Type: Corporation

Legal Name of Entity: NSTAR Electric Company dba Eversource Energy

Owners/Officers: Joseph Nolan, , ,

License Information:

Grant of location issued to: NSTAR Electric Company dba Eversource Energy

Describe the reason for the work, and the intended beneficiaries: To supply power to new 32 unit building at 390 Broadway.

Insert here the same detailed description of the work as appears in the attached Grant of Location Order: Broadway-Southerly, from MH1969 at the intersection of Main Street to private property, install approximately 98 feet of conduit.

Approval Conditions:

Approved By:

Isabela Maia, Approved with Conditions

APPROVAL CONDITION IMM 2022-10-25: 12' wide permanent patch centered on trench to be installed following the calendar year after completion.

APPROVAL CONDITION IMM 2022-10-25: Pedestrian refuge island to be restored in-kind.

Malik Drayton, Approved with Conditions

APPROVAL CONDITION: MD20221027: Contractor shall take all necessary precautions to avoid damaging any tree or tree part with equipment.

APPROVAL CONDITION: MD20221027: All nearby street tree(s) shall be protected prior to and during all construction activities using TREE BOX or TREE WRAPS. . TREE BOX shall be constructed from 2 in. x 4 in. lumber creating a box around the border of the tree pit with 2 in. x 4 in. lumber standing straight up at the corners and wrapped with orange snow fence. Detail attached. . TREE WRAPS (TREE TRUNK WRAPPING PROTECTION LUMBER) shall consist of 2 in. x 4 in. and 8 ft. height lumber wired together in close spacing with zip ties or 16 gauge galvanized steel wire to form a protective

enclosure around tree trunks. Use burlap to separate the wood from the bark if necessary to prevent wood from scraping or bruising bark. Do not use staples or puncture the trunk in any way.

APPROVAL CONDITION: MD20221027: Any tree roots less than two (2) inches in diameter that cannot be avoided during construction shall be carefully and cleanly cut with a clean pair of pruning shears or loppers. Roots are to be cut back flush with the edge of the trench. If any tree roots greater than two (2) inches in diameter are encountered, stop work immediately and contact the City Urban Forester. Any and all pruning of roots greater than 2 inches in diameter must be completed under the supervision of the City Urban Forester.

Eric Weisman, Approved with Conditions

Care must be taken around irrigation and electric in island. Applicant responsible for repairing any damage to irrigation or electrical. Grass must be returned to original condition.

Kimberly M. Wells, Approved



CITY OF SOMERVILLE, MASSACHUSETTS
CITY CLERK'S OFFICE
KATJANA BALLANTYNE
MAYOR

KIMBERLY M. WELLS
CITY CLERK

November 1, 2022

NOTICE OF PUBLIC HEARING

You are hereby notified that the Somerville City Council will hold a Public Hearing on the following Petition. You are receiving this Notice because the Petitioner has reported that you own property that abuts the work that is being proposed. You and other members of the public are invited to attend and be heard at this Hearing.

This meeting of the City Council will also be conducted via remote participation, online in a webinar hosted on the GoToWebinar platform.

You have three ways to be heard at this meeting:

1. To attend and be heard, enter the link exactly as it appears below into your internet browser any time before the meeting. You will then be asked to register for the meeting. After registering, you will receive an email with instructions to join the webinar when it starts.
2. You may also testify in person in the City Council Chamber, City Hall, 2nd Floor, 93 Highland Avenue, Somerville, MA 02143
3. If you are unable to attend but wish to be heard, you may send written comments by US mail to the City Clerk at the address below, or by email to cityclerk@somervillema.gov. Your comments must arrive no later than 12 Noon on the day of the Hearing, in order to be sure they are conveyed to the Council.

PETITION: Eversource (NStar Electric) is applying for a Grant of Location to install 98 feet of conduit in Broadway, from Manhole 1969 located at the intersection of Broadway and Main Street to a point of pick up at 390 Broadway.

PLACE: <https://attendee.gotowebinar.com/register/4399306978260816909> or
City Council Chambers, City Hall, 2nd Floor, 93 Highland Avenue, Somerville, MA 02143

TIME: Thursday, November 10, 2022, at 7:00 PM.

PURPOSE: The work is necessary to provide service to 390 Broadway.

EVERSOURCE
101 Linwood Street
Somerville, MA 02143

October 18, 2022

Ms. Kimberly Wells
Office of the City Clerk
93 Highland Avenue
Somerville, MA 02143

RE: 390 Broadway
W.O. #7958747

Dear Members of the Board,

The NSTAR Electric Company d/b/a Eversource Energy respectfully requests a Grant of Location for the installation of 98 feet of conduit in Broadway.

This work is necessary to supply power to 390 Broadway.

If you have any questions or concerns, please call Jacqueline Duffy at 617-629-3204.

Very truly yours,

Kelly-Ann Correia

Kelly-Ann Correia
Supervisor, Rights and Permits

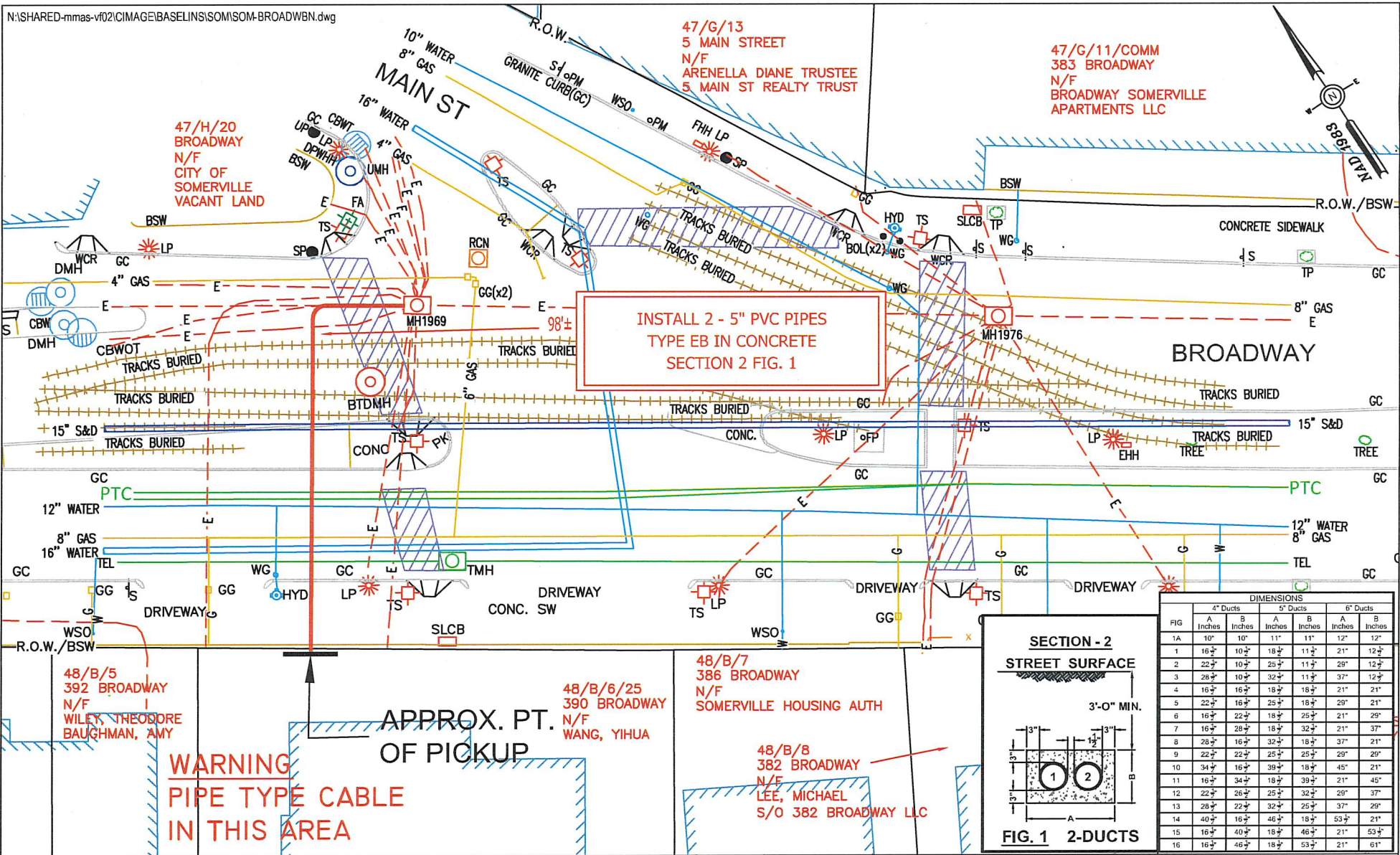

SECTION - 2
STREET SURFACE

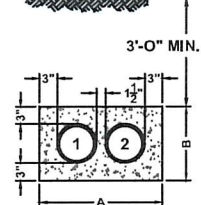

FIG. 1 2-DUCTS

FIG	4" Ducts				5" Ducts			
	A Inches	B Inches	A Inches	B Inches	A Inches	B Inches	A Inches	B Inches
1A	10"	10"	11"	11"	12"	12"	12"	12"
1	16 1/2"	10 1/2"	18 1/2"	11 1/2"	21"	12 1/2"		
2	22 1/2"	10 1/2"	25 1/2"	11 1/2"	29"	12 1/2"		
3	28 1/2"	10 1/2"	32 1/2"	11 1/2"	37"	12 1/2"		
4	16 1/2"	16 1/2"	18 1/2"	18 1/2"	21"	21"		
5	22 1/2"	16 1/2"	25 1/2"	18 1/2"	29"	21"		
6	16 1/2"	22 1/2"	18 1/2"	25 1/2"	21"	29"		
7	16 1/2"	28 1/2"	18 1/2"	32 1/2"	21"	37"		
8	28 1/2"	16 1/2"	32 1/2"	18 1/2"	37"	21"		
9	22 1/2"	22 1/2"	25 1/2"	25 1/2"	29"	29"		
10	34 1/2"	16 1/2"	39 1/2"	18 1/2"	45"	21"		
11	16 1/2"	34 1/2"	18 1/2"	39 1/2"	21"	45"		
12	22 1/2"	26 1/2"	25 1/2"	32 1/2"	29"	37"		
13	28 1/2"	22 1/2"	32 1/2"	25 1/2"	37"	29"		
14	40 1/2"	16 1/2"	46 1/2"	18 1/2"	53 1/2"	21"		
15	16 1/2"	40 1/2"	18 1/2"	46 1/2"	21"	53 1/2"		
16	16 1/2"	46 1/2"	18 1/2"	53 1/2"	21"	61"		

48/B/5
392 BROADWAY
N/F
WILEY, THEODORE
BAUGHMAN, AMY

WARNING
PIPE TYPE CABLE
IN THIS AREA

APPROX. PT.
OF PICKUP

48/B/6/25
390 BROADWAY
N/F
WANG, YIHUA

48/B/7
386 BROADWAY
N/F
SOMERVILLE HOUSING AUTH

48/B/8
382 BROADWAY
N/F
LEE, MICHAEL
S/O 382 BROADWAY LLC



BY YOUR USE OF THE INFORMATION CONTAINED IN THIS MAP, YOU AGREE THAT NO WARRANTY OF ANY KIND, EXPRESS OR IMPLIED, IS GIVEN WITH RESPECT TO THE INFORMATION. NEITHER NSTAR ELECTRIC COMPANY, NSTAR GAS COMPANY NOR ITS PARENTS, AFFILIATES, OFFICERS, DIRECTORS, SHAREHOLDERS, EMPLOYEES OR AGENTS (COLLECTIVELY THE "NSTAR ENTITIES") SHALL BE LIABLE FOR ANY LOSS OR INJURY CAUSED IN WHOLE OR IN PART BY USE OF THIS INFORMATION OR IN RELIANCE UPON IT, TO THE MAXIMUM EXTENT ALLOWED BY LAW, YOU AGREE BY YOUR ACCEPTANCE OF THE INFORMATION TO RELEASE, INDEMNIFY AND HOLD THE NSTAR ENTITIES HARMLESS FROM ANY SUCH LOSS OR INJURY.

THE INFORMATION MAY NOT REPRESENT A SURVEY, MAY NOT BE THE MOST COMPLETE AND IS SUBJECT TO CHANGE WITHOUT NOTICE. NO LIABILITY IS ASSUMED FOR THE ACCURACY OF THE INFORMATION, EITHER EXPRESSED OR IMPLIED. UNAUTHORIZED ATTEMPTS TO MODIFY THE INFORMATION OR USE THE INFORMATION FOR OTHER THAN ITS INTENDED PURPOSES ARE PROHIBITED.

MASS. LAW

REQUIRES 72 HOURS ADVANCE NOTICE TO UTILITY COMPANIES BEFORE DIGGING BY ANYONE. CALL DIG-SAFE 1-888-344-7233

C# 267-22
Ward #
Work Order # 7958747
Surveyed by: BP/JC
Research by: JC
Plotted by: SJ
Proposed Structures: SJ
Approved: T THIBAUT
P#

NSTAR EVERSOURCE
ELECTRIC
C/D/E

1165 MASSACHUSETTS AVE. DORCHESTER, MASS. 02125

Plan of BROADWAY
SOMERVILLE

Showing PROPOSED CONDUIT LOCATION

Scale 1"=30'
Date SEPTEMBER 30, 2022

SHEET 1 of 1

Location:
47/ H/ 19/ /
391 BROADWAY
Owner:
391 BROADWAY LLC
PO BOX 288
ARLINGTON, MA 02476

Location:
48/ B/ 6/ 12/
390 BROADWAY
Owner:
WANG XU
390 BROADWAY #12
SOMERVILLE, MA 02145

Location:
48/ B/ 6/ 21/
390 BROADWAY
Owner:
MARTINS JOSE BARROS & FERNANDO
C
390 BROADWAY #21
SOMERVILLE, MA 02145

Location:
48/ B/ 6/ 24/
390 BROADWAY
Owner:
SWEENEY ROBERT J
390 BROADWAY #24
SOMERVILLE, MA 02145

Location:
48/ B/ 6/ 32/
390 BROADWAY
Owner:
SUN BINGTONG
390 BROADWAY #32
SOMERVILLE, MA 02145

Location:
48/ B/ 6/ 35/
390 BROADWAY
Owner:
JACKSON DEAN E & CATHERINE A
7 WAINWRIGHT RD UNIT 76
WINCHESTER, MA 01890

Location:
48/ B/ 6/ 43/
390 BROADWAY
Owner:
NGAO SAU LEE
390 BROADWAY #43
SOMERVILLE, MA 02145

Location:
48/ B/ 6/ 51/
390 BROADWAY
Owner:
KIM DOHWEE
390 BROADWAY #51
SOMERVILLE, MA 02145

Location:
48/ B/ 6/ 54/
390 BROADWAY
Owner:
WENTZELL PATRICIA TRUSTEE
390 BROADWAY UNIT 54 REALTY TRUST
390 BROADWAY #54
SOMERVILLE, MA 02145

Location:
48/ B/ 6/ 62/
390 BROADWAY
Owner:
VALEVICH ARON
390 BROADWAY #62
SOMERVILLE, MA 02145

Location:
48/ B/ 5/ /
392 BROADWAY
Owner:
WILEY THEODORE & BAUGHMAN AMY
392 BROADWAY
SOMERVILLE, MA 02145

Location:
48/ B/ 6/ 13/
390 BROADWAY
Owner:
CHILINGARYAN IGOR
390 BROADWAY #13
SOMERVILLE, MA 02145

Location:
48/ B/ 6/ 22/
390 BROADWAY
Owner:
NASR KAMEEL & LISI W
390 BROADWAY UNIT 22
SOMERVILLE, MA 02145

Location:
48/ B/ 6/ 25/
390 BROADWAY
Owner:
WANG YIHUA
49 A DANA ST
CAMBRIDGE, MA 02138

Location:
48/ B/ 6/ 33/
390 BROADWAY
Owner:
RAMIREZ JOSE A
390 BROADWAY #33
SOMERVILLE, MA 02145

Location:
48/ B/ 6/ 41/
390 BROADWAY
Owner:
RAVASINI MARIA LISA
390 BROADWAY UNIT 41
SOMERVILLE, MA 02145

Location:
48/ B/ 6/ 44/
390 BROADWAY
Owner:
MORRISON AMANDA
390 BROADWAY #44
SOMERVILLE, MA 02145

Location:
48/ B/ 6/ 52/
390 BROADWAY
Owner:
MOYES ROSE MARIE
390 BROADWAY #52
SOMERVILLE, MA 02145

Location:
48/ B/ 6/ 55/
390 BROADWAY
Owner:
CAPLIN ALAN
S/O ZACKIN BENJAMIN I & MIHALEK
ELIZABET
390 BROADWAY # 55
SOMERVILLE, MA 02145

Location:
48/ B/ 6/ 63/
390 BROADWAY
Owner:
GREEN RENEE MICHELLE
390 BROADWAY #63
SOMERVILLE, MA 02145

Location:
48/ B/ 6/ 11/
390 BROADWAY
Owner:
GULATI VANESSA A
2 KNOWLTON DRIVE
ACTON, MA 01720

Location:
48/ B/ 6/ 14/
390 BROADWAY
Owner:
SCHWICKRATH HELEN L
390 BROADWAY UNIT #14
SOMERVILLE, MA 02145

Location:
48/ B/ 6/ 23/
390 BROADWAY
Owner:
EVANS CHRISTINE A TRUSTEE
CHRISTINE A EVANS TRUST 2013
390 BROADWAY #23
SOMERVILLE, MA 02145

Location:
48/ B/ 6/ 31/
390 BROADWAY
Owner:
JANNUZZI JANICE
390 BROADWAY UNIT #31
SOMERVILLE, MA 02145

Location:
48/ B/ 6/ 34/
390 BROADWAY
Owner:
LOPES DONNA
390 BROADWAY #34
SOMERVILLE, MA 02145

Location:
48/ B/ 6/ 42/
390 BROADWAY
Owner:
HOBART EDWIN T TRUSTEE
390 BROADWAY
SOMERVILLE, MA 02145

Location:
48/ B/ 6/ 45/
390 BROADWAY
Owner:
SCHIEVER BARBARA A.
S/O SCHIEVER BARBARA A. TRUSTEE
390 BROADWAY UNIT #45
SOMERVILLE, MA 02145-2713

Location:
48/ B/ 6/ 53/
390 BROADWAY
Owner:
GRADY MICHAEL J & PATRICIA
390 BROADWAY #53
SOMERVILLE, MA 02145

Location:
48/ B/ 6/ 61/
390 BROADWAY
Owner:
HANNA FRED A
390 BROADWAY UNIT #61
SOMERVILLE, MA 02145

Location:
48/ B/ 6/ 64/
390 BROADWAY
Owner:
DIDENKO SERGE
390 BROADWAY
SOMERVILLE, MA 02145

Location:
48/ B/ 6/ 65/
390 BROADWAY
Owner:
HANNA FRED M
390 BROADWAY UNIT 61
SOMERVILLE, MA 02145

Location:
48/ B/ 6/ L-3/
390 BROADWAY
Owner:
SHAH ALI
S/O JEWKES BENJAMIN
390 BROADWAY
SOMERVILLE, MA 02145

Location:
48/ B/ 6/ L-1/
390 BROADWAY
Owner:
SLAWINSKI LORETTA J
390 BROADWAY
SOMERVILLE, MA 02145

Location:
47/ H/ 20/ /
BROADWAY
Owner:
CITY OF SOMERVILLE
VACANT LAND
93 HIGHLAND AVE
SOMERVILLE, MA 02143

Location:
48/ B/ 6/ L-2/
390 BROADWAY
Owner:
ROSENGREN COLE D & KATIE
ELIZABETH
S/O PATRO RUTAYAN
390 BROADWAY #L - 2
SOMERVILLE, MA 02145

Location:
48/ B/ 7/ /
386 BROADWAY
Owner:
SOMERVILLE HOUSING AUTH
30 MEMORIAL RD
SOMERVILLE, MA 02145