



CITY OF SOMERVILLE
Commonwealth of Massachusetts
93 Highland Avenue
Somerville, MA 02143
(617) 625-6600

BUSINESS LICENSE APPLICATION - Grant of Location

File #: 22-004843

License #: BL22-000036

Address: 205 BEACON ST

Licensee: Hannah Cooper NSTAR Electric Company dba Eversource Energy

DBA Name: NSTAR dba Eversource Energy

Business Ownership Type: Corporation

Legal Name of Entity: NSTAR dba Eversource Energy

Owners/Officers: Joseph R Nolan Jr, , ,

License Information:

Grant of location issued to: NSTAR dba Eversource Energy

Describe the reason for the work, and the intended beneficiaries: This work is necessary to provide service to #205 Beacon Street.

Insert here the same detailed description of the work as appears in the attached Grant of Location Order: Ivaloo Street - Southerly from pole 179/6, northeast of Beacon street, to private property at #205 Beacon street, install approximately 85 feet of conduit. WO#7596748

Approval Conditions:

Approved By:

Isabela Maia, Approved

Malik Drayton, Approved with Conditions

APPROVAL CONDITION: MD20220314: Contractor shall take all necessary precautions to avoid damaging any tree or tree part with equipment. APPROVAL CONDITION: MD20220314: All nearby street tree(s) shall be protected prior to and during all construction activities using TREE BOX or TREE WRAPS. . TREE BOX shall be constructed from 2 in. x 4 in. lumber creating a box around the border of the tree pit with 2 in. x 4 in. lumber standing straight up at the corners and wrapped with orange snow fence. Detail attached. . TREE WRAPS (TREE TRUNK WRAPPING PROTECTION LUMBER) shall consist of 2 in. x 4 in. and 8 ft. height lumber wired together in close spacing with zip ties or 16 gauge galvanized steel wire to form a protective enclosure around tree trunks. Use burlap to separate the wood from the bark if necessary to prevent wood from scraping or bruising bark. Do not use staples or puncture the trunk in any way. APPROVAL CONDITION: MD20220314: Any tree roots less

than two (2) inches in diameter that cannot be avoided during construction shall be carefully and cleanly cut with a clean pair of pruning shears or loppers. Roots are to be cut back flush with the edge of the trench. If any tree roots greater than two (2) inches in diameter are encountered, stop work immediately and contact the City Urban Forester. Any and all pruning of roots greater than 2 inches in diameter must be completed under the supervision of the City Urban Forester.

APPROVAL CONDITION: MD20220314: All nearby street tree(s) shall be protected prior to and during all construction activities using TREE BOX or TREE WRAPS. . TREE BOX shall be constructed from 2 in. x 4 in. lumber creating a box around the border of the tree pit with 2 in. x 4 in. lumber standing straight up at the corners and wrapped with orange snow fence. Detail attached. . TREE WRAPS (TREE TRUNK WRAPPING PROTECTION LUMBER) shall consist of 2 in. x 4 in. and 8 ft. height lumber wired together in close spacing with zip ties or 16 gauge galvanized steel wire to form a protective enclosure around tree trunks. Use burlap to separate the wood from the bark if necessary to prevent wood from scraping or bruising bark. Do not use staples or puncture the trunk in any way.

APPROVAL CONDITION: MD20220314: Any tree roots less than two (2) inches in diameter that cannot be avoided during construction shall be carefully and cleanly cut with a clean pair of pruning shears or loppers. Roots are to be cut back flush with the edge of the trench. If any tree roots greater than two (2) inches in diameter are encountered, stop work immediately and contact the City Urban Forester. Any and all pruning of roots greater than 2 inches in diameter must be completed under the supervision of the City Urban Forester.

Eric Weisman, Approved

Kimberly M. Wells, Approved



CITY OF SOMERVILLE, MASSACHUSETTS

CITY CLERK'S OFFICE

KATJANA BALLANTYNE

MAYOR

KIMBERLY M. WELLS

CITY CLERK

April 19, 2022

NOTICE OF PUBLIC HEARING

You are hereby notified that the Somerville City Council will hold a Public Hearing on the following Petition. You are receiving this Notice because the Petitioner has reported that you own property that abuts the work that is being proposed. You and other members of the public are invited to attend and be heard at this Hearing.

This meeting of the City Council will be conducted via remote participation, online in a webinar hosted on the GoToWebinar platform.

You have two ways to be heard at this meeting:

1. You may testify remotely by entering the link exactly as it appears below into your internet browser any time before the meeting. You will then be asked to register for the meeting. After registering, you will receive an email with instructions to join the webinar when it starts.
2. If you are unable to attend but wish to be heard, you may send written comments by US mail to the City Clerk at the address below, or by email to cityclerk@somervillema.gov. Your comments must arrive no later than 12 Noon on the day of the Hearing, in order to be sure they are conveyed to the Council.

PETITION: Eversource (NStar Electric) is applying for a Grant of Location to install 85 feet of conduit in Ivaloo Street, from Utility Pole 179/6 to a point of pickup at the rear of 205 Beacon Street.

PLACE: <https://attendee.gotowebinar.com/register/6796143366429872655>

TIME: Thursday, April 28, 2022 at 7:00 PM.

PURPOSE: The work is necessary to provide service to 205 Beacon Street.

W.O. 7596748

EVERSOURCE
101 Linwood Street
Somerville, MA 02143

March 10, 2022

Ms. Kimberly Wells
Office of the City Clerk
93 Highland Avenue
Somerville, MA 02143

RE: Ivaloo Street
W.O. #7596748

Dear Members of the Board,

The NSTAR Electric Company d/b/a Eversource Energy respectfully requests a Grant of Location for the installation of 85 feet of conduit in Ivaloo Street.

This work is necessary to supply power to #205 Beacon Street.

If you have any questions or concerns, please call Jacqueline Duffy at 617-629-3204.

Very truly yours,

Kelly-Ann Correia

Kelly-Ann Correia
Supervisor, Rights and Permits

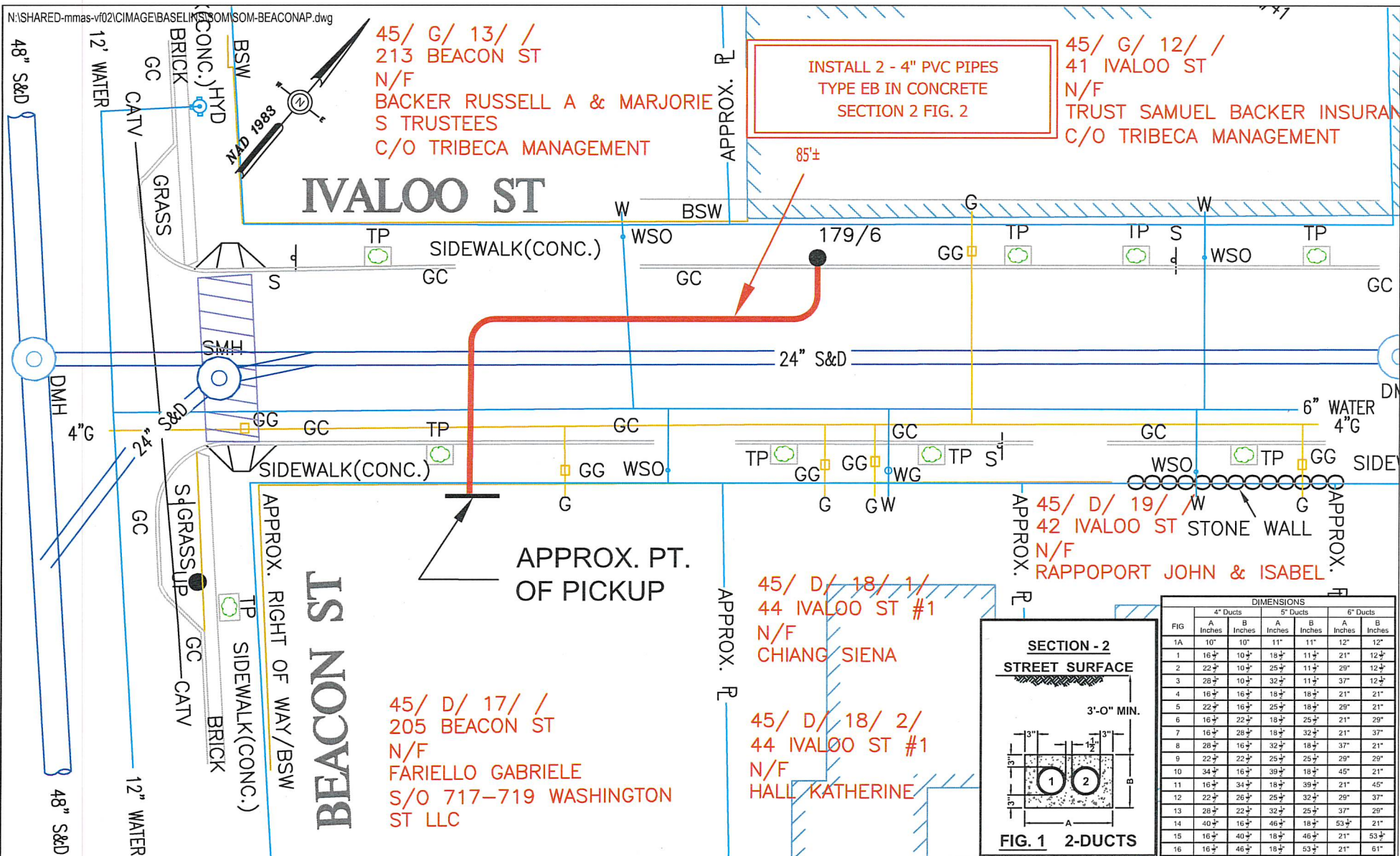

BY YOUR USE OF THE INFORMATION CONTAINED IN THIS MAP, YOU AGREE THAT NO WARRANTY OF ANY KIND, EXPRESS OR IMPLIED, IS GIVEN WITH RESPECT TO THE INFORMATION. NEITHER NSTAR ELECTRIC COMPANY, NSTAR GAS COMPANY NOR ITS PARENTS, AFFILIATES, OFFICERS, DIRECTORS, SHAREHOLDERS, EMPLOYEES OR AGENTS (COLLECTIVELY THE "NSTAR ENTITIES") SHALL BE LIABLE FOR ANY LOSS OR INJURY CAUSED IN WHOLE OR IN PART BY USE OF THIS INFORMATION OR IN RELIANCE UPON IT. TO THE MAXIMUM EXTENT ALLOWED BY LAW, YOU AGREE BY YOUR ACCEPTANCE OF THE INFORMATION TO RELEASE, INDEMNIFY AND HOLD THE NSTAR ENTITIES HARMLESS FROM ANY SUCH LOSS OR INJURY.

THE INFORMATION MAY NOT REPRESENT A SURVEY, MAY NOT BE THE MOST COMPLETE AND IS SUBJECT TO CHANGE WITHOUT NOTICE. NO LIABILITY IS ASSUMED FOR THE ACCURACY OF THE INFORMATION, EITHER EXPRESSED OR IMPLIED. UNAUTHORIZED ATTEMPTS TO MODIFY THE INFORMATION OR USE THE INFORMATION FOR OTHER THAN ITS INTENDED PURPOSES ARE PROHIBITED.

MASS. LAW

REQUIRES 72 HOURS ADVANCE NOTICE TO UTILITY COMPANIES
BEFORE DIGGING BY ANYONE. CALL DIG-SAFE 1-888-344-7233

C# 23-22

Ward #

Work Order # 7596748

Surveyed by: GR/SJ

Research by: JC

Plotted by: JC

Proposed Structures: JC

Approved: T THIBAUT

P#	
----	--

SECTION - 2
STREET SURFACE

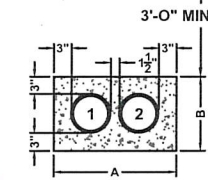

FIG. 1 2-DUCTS

DIMENSIONS						
FIG	4" Ducts		5" Ducts		6" Ducts	
	A Inches	B Inches	A Inches	B Inches	A Inches	B Inches
1A	10"	10"	11"	11"	12"	12"
1	16"	10"	18"	11"	21"	12"
2	22"	10"	25"	11"	29"	12"
3	28"	10"	32"	11"	37"	12"
4	16"	16"	18"	18"	21"	21"
5	22"	16"	25"	18"	29"	21"
6	16"	22"	18"	25"	21"	29"
7	16"	28"	18"	32"	21"	37"
8	28"	16"	32"	18"	37"	21"
9	22"	22"	25"	25"	29"	29"
10	34"	16"	39"	18"	45"	21"
11	16"	34"	18"	39"	21"	45"
12	22"	26"	25"	32"	29"	37"
13	28"	22"	32"	25"	37"	29"
14	40"	16"	46"	18"	53"	21"
15	16"	40"	18"	46"	21"	53"
16	16"	46"	18"	53"	21"	61"

NSTAR
ELECTRIC
d/b/a **EVERSOURCE**

1165 MASSACHUSETTS AVE. DORCHESTER, MASS. 02125

Plan of BEACON STREET

SOMERVILLE

Showing PROPOSED CONDUIT LOCATION

--	--

Scale	1"=20'
-------	--------

SHEET

Date JANUARY 18, 2022

Rev April 4, 2022

Location:
45/ G/ 12/ /
41 IVALOO ST
Owner:
TRUST SAMUEL BACKER INSURANCE
C/O TRIBECA MANAGEMENT
192 PRECINCT ST
MIDDLEBORO, MA 02346

Location:
45/ D/ 17/ /
205 BEACON ST
Owner:
717-719 WASHINGTON ST LLC
34 CENTURY LANE
MILTON, MA 02186

Location:
45/ D/ 18/ 2/
44 IVALOO ST #2
Owner:
HALL KATHERINE
115 PETERBOROUGH ST #43
BOSTON, MA 02115

Location:
45/ G/ 13/ /
213 BEACON ST
Owner:
BACKER RUSSELL A & MARJORIE S
TRUSTEES
C/O TRIBECA MANAGEMENT
192 PRECINCT ST
MIDDLEBORO, MA 02346

Location:
45/ D/ 19/ /
42 IVALOO ST
Owner:
RAPPOPORT JOHN & ISABEL
42 IVALOO ST
SOMERVILLE, MA 02143

Location:
45/ D/ 15/ /
199 BEACON ST
Owner:
MASLAK NOUREDDINE &
AMORE-MASLAK ROSANNE
47 GORE ST
CAMBRIDGE, MA 02141

Location:
45/ D/ 18/ 1/
44 IVALOO ST #1
Owner:
CHIANG SIENA
44 IVALOO ST 1
SOMERVILLE, MA 02143