



CITY OF SOMERVILLE

Commonwealth of Massachusetts

93 Highland Avenue

Somerville, MA 02143

(617) 625-6600

BUSINESS LICENSE APPLICATION - Grant of Location

File #: 22-017102

License #: BL22-000108

Address: 599 SOMERVILLE AVE

Licensee: Josh Libuda MTP Communications

DBA Name: Cambridge Network Solutions

Business Ownership Type: Corporation

Legal Name of Entity: Cambridge Network Solutions

Owners/Officers: , , ,

License Information:

Grant of location issued to: Cambridge Network Solutions

Describe the reason for the work, and the intended beneficiaries: Lightpath service order for Rafi Investments

Insert here the same detailed description of the work as appears in the attached Grant of Location Order: Trench approximately 210' from existing Level 3 manhole at corner of Somerville Ave and Bleachery CT to stubbed conduit placed by property owner at the corner of Spring and Somerville Ave

Approval Conditions:

Approved By:

Isabela Maia, Approved with Conditions

APPROVAL CONDITION IMM 2022-09-16: Provide the city a of copy approved MWRA 8(m) Permit when submitting for street occupancy permit.

APPROVAL CONDITION IMM 2022-09-16: 12' wide permanent patch centered on their trench to be installed following the calendar year after completion.

APPROVAL CONDITION IMM 2022-09-16: If the brick crosswalk is disturbed, bricks are not allowed to be cut. The brick must be reset immediately following installation. Contact Eamon Duane at 617-874-6319 to schedule a pre-construction inspection when applying for Street Occupancy Permit.

Malik Drayton, Approved with Conditions

APPROVAL CONDITION: MD20220922: Contractor shall take all necessary precautions to avoid damaging any tree or tree part with equipment.

APPROVAL CONDITION: MD20220922: All nearby street tree(s) shall be protected prior to and during

all construction activities using TREE BOX or TREE WRAPS. . TREE BOX shall be constructed from 2 in. x 4 in. lumber creating a box around the border of the tree pit with 2 in. x 4 in. lumber standing straight up at the corners and wrapped with orange snow fence. Detail attached. . TREE WRAPS (TREE TRUNK WRAPPING PROTECTION LUMBER) shall consist of 2 in. x 4 in. and 8 ft. height lumber wired together in close spacing with zip ties or 16 gauge galvanized steel wire to form a protective enclosure around tree trunks. Use burlap to separate the wood from the bark if necessary to prevent wood from scraping or bruising bark. Do not use staples or puncture the trunk in any way.

APPROVAL CONDITION: MD20220922: Any tree roots less than two (2) inches in diameter that cannot be avoided during construction shall be carefully and cleanly cut with a clean pair of pruning shears or loppers. Roots are to be cut back flush with the edge of the trench. If any tree roots greater than two (2) inches in diameter are encountered, stop work immediately and contact the City Urban Forester. Any and all pruning of roots greater than 2 inches in diameter must be completed under the supervision of the City Urban Forester.

Eric Weisman, Approved

Kimberly M. Wells, Approved



CITY OF SOMERVILLE, MASSACHUSETTS
CITY CLERK'S OFFICE
KATJANA BALLANTYNE
MAYOR

KIMBERLY M. WELLS
CITY CLERK

November 1, 2022

NOTICE OF PUBLIC HEARING

You are hereby notified that the Somerville City Council will hold a Public Hearing on the following Petition. You are receiving this Notice because the Petitioner has reported that you own property that abuts the work that is being proposed. You and other members of the public are invited to attend and be heard at this Hearing.

This meeting of the City Council will also be conducted via remote participation, online in a webinar hosted on the GoToWebinar platform.

You have three ways to be heard at this meeting:

1. To attend and be heard, enter the link exactly as it appears below into your internet browser any time before the meeting. You will then be asked to register for the meeting. After registering, you will receive an email with instructions to join the webinar when it starts.
2. You may also testify in person in the City Council Chamber, City Hall, 2nd Floor, 93 Highland Avenue, Somerville, MA 02143
3. If you are unable to attend but wish to be heard, you may send written comments by US mail to the City Clerk at the address below, or by email to cityclerk@somervillema.gov. Your comments must arrive no later than 12 Noon on the day of the Hearing, in order to be sure they are conveyed to the Council.

PETITION: Cambridge Network Solutions is applying for a Grant of Location to install 263 feet of conduit in Somerville Avenue, from Manhole 0515-3400 to a point of pickup at the intersection of Spring Street and Somerville Avenue.

PLACE: <https://attendee.gotowebinar.com/register/4399306978260816909> or
City Council Chambers, City Hall, 2nd Floor, 93 Highland Avenue, Somerville, MA 02143

TIME: Thursday, November 10, 2022, at 7:00 PM.

PURPOSE: The work is necessary to provide light path service.



CAMBRIDGE

NETWORK SOLUTIONS

PROPOSED CONDUIT INSTALLATION

AT

599 SOMERVILLE AVE

IN

SOMERVILLE, MA

INDEX OF DRAWING

SHT NO.	DESCRIPTION
01	PROPOSED PLAN

PREPARED BY:

FAYNET
ENGINEERING GROUP

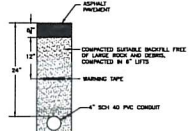

ROADWAY PATCH AND DUCT BANK INSTALLATION DETAIL
N.T.S.

- TRENCH DETAIL NOTES:
1. 24" MAXIMUM FROM TOP OF CONDUIT TO SURFACE.
 2. 12" FROM TOP OF CONDUIT TO METALLIC WARNING TAPE PLACED ABOVE.
 3. REPAIR SIDEWALKS AND WALKWAYS WITH SAME MATERIALS AS EXISTING.

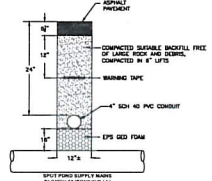

MWRA PIPE CROSSING DETAIL
N.T.S.

- TRENCH DETAIL NOTES:
1. MWRA PIPE LOCATION AND ELEVATION SHOULD BE ACCURATELY DETERMINED WITHOUT DELAY BY THE CONTRACTOR.
 2. THE CONTRACTOR MUST MAINTAIN A SEPARATION OF 18 INCHES MINIMUM WHEN CROSSING EXISTING MWRA FACILITIES.
 3. THE CONTRACTOR WILL BE FULLY RESPONSIBLE FOR ALL DAMAGES IF IT IS DETERMINED THAT THE MINIMUM CLEARANCES WERE NOT AGREED TO DURING CONDUIT INSTALLATION.

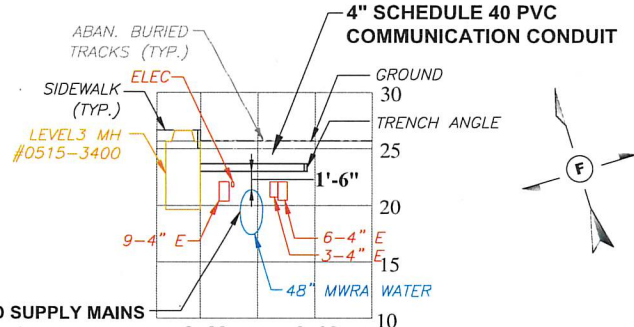

SPOT POND SUPPLY MAINS SECTION 67 (SOMERVILLE) STA 28+50 TO STA 42+50
PLAN & PROFILE

PROFILE VIEW
HORIZONTAL SCALE: 1" = 10'
VERTICAL SCALE: 1" = 5'

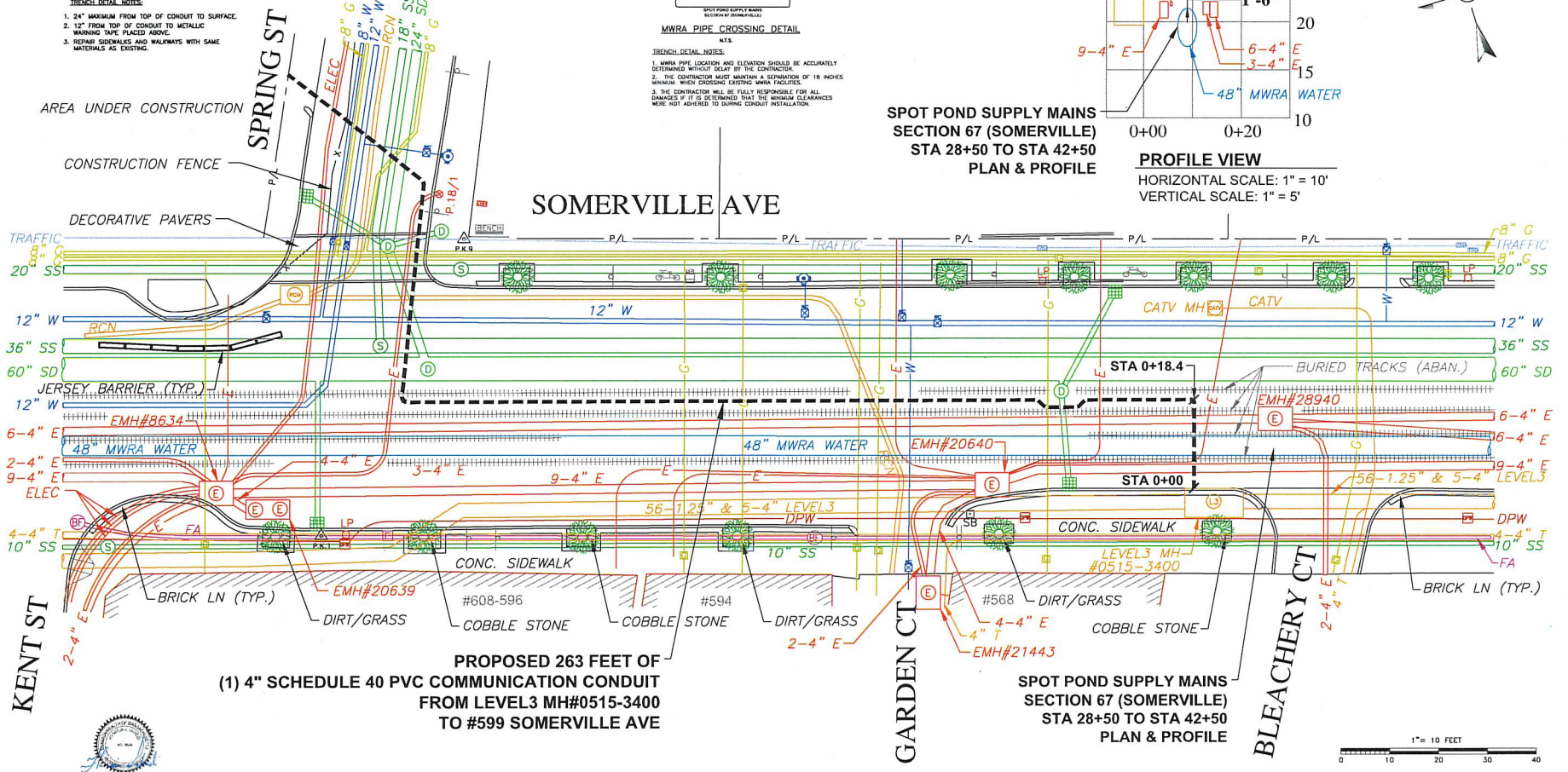
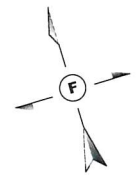

PROPOSED 263 FEET OF (1) 4" SCHEDULE 40 PVC COMMUNICATION CONDUIT FROM LEVEL3 MH#0515-3400 TO #599 SOMERVILLE AVE

SPOT POND SUPPLY MAINS SECTION 67 (SOMERVILLE) STA 28+50 TO STA 42+50
PLAN & PROFILE

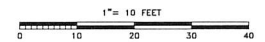

DATE	APPROVED	REVISION

LEGEND	
	PROPERTY LINE
	EDGE OF PAVEMENT
	PROPOSED HANDHOLE
	PROPOSED MANHOLE
	PROPOSED CONDUIT
	AS-BUILT CONDUIT
	PK NAIL
	PARKING METER
	DOUBLE PARKING METER
	HANDICAP RAMP
	STONE SOUND
	HANDHOLE
	STUMP
	TRAFFIC SIGNAL
	TRAFFIC BOX
	RCN MH
	UNKNOWN MH
	GAS DATE
	UNKNOWN GATE
	TREE
	BUSH
	SEWER MH
	DRAIN MH
	CATCH BASIN
	INLET CATCH BASIN
	TELEPHONE MH
	STEAM MH
	CABLE TV MH
	MISTA MH
	MONITORING WELL
	HYDRANT
	WATER VALVE
	WATER GATE
	WATER MH
	WATER METER
	JOINT OWNED POLE
	SOLE OWNED ELEC POLE
	SOLE OWNED TEL POLE
	LIGHT POLE
	ELECTRIC MH
	TRANSFORMER
	SIGN POLE
	WATER PIPE
	SEWER PIPE
	DRAIN PIPE
	TELEPHONE PIPE
	ELECTRIC PIPE
	CATV PIPE
	GAS PIPE
	STEAM PIPE

NOTE:	
THE LOCATION OF EXISTING UNDERGROUND UTILITIES ARE SHOWN IN AN APPROXIMATE WAY ONLY AND OWNER OR ITS REPRESENTATIVE, THE CONTRACTOR SHALL DETERMINE THE EXACT LOCATION OF ALL EXISTING UTILITIES BEFORE BEGINNING WORK AND AGREES TO BE FULLY RESPONSIBLE FOR ANY AND ALL DAMAGES WHICH MIGHT BE OCCURRED BY THE CONTRACTOR'S FAILURE TO EXACTLY LOCATE AND PRESENT ANY AND ALL UNDERGROUND UTILITIES. ALL REPAIRS SHALL BE MADE AT THE CONTRACTOR'S EXPENSE. THE CONTRACTOR IS TO CONTACT "DIG SAFE" 72 HOURS PRIOR TO ANY EXCAVATION.	

PREPARED FOR:	
CAMBRIDGE NETWORK SOLUTIONS	

PREPARED BY:	
FAYNET ENGINEERING GROUP	

TITLE:	
PROPOSED PLAN	

LOCATION:	
599 SOMERVILLE AVE SOMERVILLE, MA	

CHECKED BY:	APPROVED BY:
RM	MP

DRAWN BY:	DATE:
LS	AUGUST, 2022

SCALE:	SHEET:
1" = 10'	1 OF 1

UNDERGROUND SERVICE ALERT
1-888-8-SAFE (1-888-872333)
CALL BEFORE YOU DIG
72 HOURS NOTICE REQUIRED



Location:
44/ H/ 12/ 1/
583 SOMERVILLE AVE
Owner:
585 SOMERVILLE AVENUE LLC
P.O. BOX 440320
SOMERVILLE, MA 02144

Location:
45/ A/ 1/ 1/
596 SOMERVILLE AVE
Owner:
ANNE MARIE R CARNES TRUSTEE
ANNE MARIE CARNES REVOC TRUST
3333 NE 34TH ST UNIT 1608
FORT LAUDERDALE, FL 33308

Location:
44/ H/ 1/ 1/
9 SPRING ST
Owner:
FERNANDES ANTONIO D & MARIA C
TRSTEEES
9 SPRING STREET NOMINEE TRUST
9 SPRING ST
SOMERVILLE, MA 02143

Location:
45/ B/ 21/ 1/
578 SOMERVILLE AVE
Owner:
COMM OF MASS
C/O DIVISION OF CAPITAL ASSET
MANAGEMENT
ONE ASHBURTON PL 15TH FL
BOSTON, MA 02108

Location:
44/ H/ 14/ 3/
595 SOMERVILLE AVE #3
Owner:
SENECHAL THIBAUD
595 SOMERVILLE AVE #3
SOMERVILLE, MA 02143

Location:
44/ V/ 4/ 1/
40 PITMAN ST #1
Owner:
AUGENBRAUN JOSEPH J
40 PITMAN ST 1
SOMERVILLE, MA 02143

Location:
44/ V/ 4/ 4/
40 PITMAN ST #4
Owner:
DOOLEY-HAYES NATHAN & FRANCIS
COOLIDGE
247 WACHUSETT AVE
ARLINGTON, MA 02476

Location:
44/ H/ 13/ 2/
593 SOMERVILLE AVE #2
Owner:
KOCHARIAN NAIRA
593 SOMERVILLE AVE 2
SOMERVILLE, MA 02143

Location:
44/ H/ 13/ 5/
593 SOMERVILLE AVE #5
Owner:
WANG NING & ZHANG YUCHEN
593 SOMERVILLE AVE 5
SOMERVILLE, MA 02143

Location:
44/ V/ 7/ 1/
599 SOMERVILLE AVE
Owner:
599 SOMERVILLE VENTURES LLC
251 LITTLE FALLS DRIVE
WILMINGTON, DE 19808

Location:
45/ A/ 2/ 1/
594 SOMERVILLE AVE
Owner:
CARNES ANNE MARIE TRUSTEE
S/O ANNE MARIE CARNES TRUSTEE
REVOC-LIV
3333 NE 34TH ST, UNIT 1608
FORT LAUDERDALE, FL 33308

Location:
44/ V/ 2/ 1/
46 PITMAN ST
Owner:
DAVIDSON GEORGE H
46 PITMAN ST
SOMERVILLE, MA 02143

Location:
44/ H/ 14/ 1/
595 SOMERVILLE AVE #1
Owner:
DENG EDDIE L & LIN CHAOCHUN
595 SOMERVILLE AVE 1
SOMERVILLE, MA 02143

Location:
44/ H/ 14/ 4/
595 SOMERVILLE AVE #4
Owner:
NICHOLSON PHILLIP D
MIKEDIS MARIA M
595 SOMERVILLE AVE #4
SOMERVILLE, MA 02143

Location:
44/ V/ 4/ 2/
40 PITMAN ST #2
Owner:
PO DAVID & CHOI YOON SUN
40 PITMAN ST #2
SOMERVILLE, MA 02143

Location:
44/ V/ 4/ 5/
40 PITMAN ST #5
Owner:
MORIN CHAD
S/O MAR CHINKEVICIUTE ELEONORA
40 PITMAN ST #5
SOMERVILLE, MA 02143

Location:
44/ H/ 13/ 3/
593 SOMERVILLE AVE #3
Owner:
GAN JOSHUA & GREEN SARA J
S/O GAN JOSHUA & GREEN SARA J
TRUSTEES
593 SOMERVILLE AVE 3
SOMERVILLE, MA 02143

Location:
44/ H/ 13/ 6/
593 SOMERVILLE AVE #6
Owner:
GAMBINO EMILY & MORESHEAD EVAN
593 SOMERVILLE AVE #6
SOMERVILLE, MA 02143

Location:
44/ V/ 12/ 1/
627 SOMERVILLE AVE
Owner:
TRUST TAURO REALTY
TAURO RONALD R & EDWARD A TRS
PO BOX 153
SOMERVILLE, MA 02143

Location:
45/ B/ 20/ 1/
588 SOMERVILLE AVE
Owner:
BBD SOMERVILLE AVE LLC
99 CRESCENT AVE
CHELSEA, MA 02150

Location:
44/ V/ 3/ 1/
44 PITMAN ST
Owner:
LAIDLEY ROSE M & RONALD J
44 PITMAN ST
SOMERVILLE, MA 02143

Location:
44/ H/ 14/ 2/
595 SOMERVILLE AVE #2
Owner:
CHEN YIJING
777 TREMONT ST UNIT 3
BOSTON, MA 02118

Location:
44/ H/ 14/ A/
595 SOMERVILLE AVE #A
Owner:
PIAZZA LLC
595 SOMERVILLE AVE #A
SOMERVILLE, MA 02143

Location:
44/ V/ 4/ 3/
40 PITMAN ST #3
Owner:
POH MING-ZHER & YUK KEE C
S/O LI YANGYANG
40 PITMAN ST #3
SOMERVILLE, MA 02143

Location:
44/ H/ 13/ 1/
593 SOMERVILLE AVE #1
Owner:
YANG PETER & NIZZA SUZANNE
S/O SCHUMAN ARIEL & THAYER
SAMUEL
593 SOMERVILLE AVE #1
SOMERVILLE, MA 02143

Location:
44/ H/ 13/ 4/
593 SOMERVILLE AVE #4
Owner:
CHIRASEVINUPRAPHAND DENNIS
HSU EVELEEN S
593 SOMERVILLE AVE #4
SOMERVILLE, MA 02143

Location:
44/ H/ 13/ 7/
591 SOMERVILLE AVE #7
Owner:
HETU SETH N & NYEIN MYAT A
591 SOMERVILLE AVE 7
SOMERVILLE, MA 02143

Location:
44/ H/ 13/ A/
593 SOMERVILLE AVE #A
Owner:
AUGMENT INVESTMENTS LLC
4 TROWBRIDGE ST #2D
CAMBRIDGE, MA 02138

Location:
44/ H/ 13/ B/
593 SOMERVILLE AVE #B
Owner:
DOGRA SAMEER & NAGI SONIA
32 STOWELL RD
BEDFORD, MA 03110

Location:
44/ I/ 6/ 6/
6 SPRING ST #6
Owner:
SHULMAN MICHAEL & LERNER
DANIELE
6 SPRING ST 6
SOMERVILLE, MA 02143

Location:
41/ I/ 6/ 8/
6 SPRING ST #8
Owner:
AGRAWAL SAURABH & SHAH SHAILY
6 SPRING ST 8
SOMERVILLE, MA 02143