



CITY OF SOMERVILLE

Commonwealth of Massachusetts

93 Highland Avenue

Somerville, MA 02143

(617) 625-6600

BUSINESS LICENSE APPLICATION - Grant of Location

File #: 21-003860

License #: BL21-000045

Address: 81 PENNSYLVANIA AVE

Licensee: Anthony Marini UC Synergetic (Verizon)

DBA Name: Verizon New England Inc

Business Ownership Type: Corporation

Legal Name of Entity: Verizon New England Inc

Owners/Officers: , , ,

License Information:

Grant of location issued to: Verizon New England Inc

Describe the reason for the work, and the intended beneficiaries: provide new services on Pennsylvania Ave and the surrounding area

Insert here the same detailed description of the work as appears in the attached Grant of Location Order: Place one new two- inch (2) conduit approximately 92' south easterly from existing Manhole, MH117 to existing Hand Hole. Said MH is located on the northerly side of Pennsylvania Avenue.

Approval Conditions:

Approved By:

Karla Cuarezma, Approved

Malik Drayton, Approved with Conditions

APPROVAL CONDITION: MD20210405: Contractor shall take all necessary precautions to avoid damaging any tree or tree part with equipment.

APPROVAL CONDITION: MD20210405: All nearby street tree(s) shall be protected prior to and during all construction activities using TREE BOX or TREE WRAPS. . TREE BOX shall be constructed from 2 in. x 4 in. lumber creating a box around the border of the tree pit with 2 in. x 4 in. lumber standing straight up at the corners and wrapped with orange snow fence. Detail attached. . TREE WRAPS (TREE TRUNK WRAPPING PROTECTION LUMBER) shall consist of 2 in. x 4 in. and 8 ft. height lumber wired together in close spacing with zip ties or 16 gauge galvanized steel wire to form a protective enclosure around tree trunks. Use burlap to separate the wood from the bark if necessary to prevent wood from scraping or bruising bark. Do not use staples or puncture the trunk in any way.

APPROVAL CONDITION: MD20210405: Any tree roots less than two (2) inches in diameter that cannot be avoided during construction shall be carefully and cleanly cut with a clean pair of pruning shears or loppers. Roots are to be cut back flush with the edge of the trench. If any tree roots greater than two (2) inches in diameter are encountered, stop work immediately and contact the City Urban Forester. Any and all pruning of roots greater than 2 inches in diameter must be completed under the supervision of the City Urban Forester.

Mark Lawhorne, Approved

John J. Long, Approved



CITY OF SOMERVILLE, MASSACHUSETTS
CITY CLERK'S OFFICE
JOSEPH A. CURTATONE
MAYOR

JOHN J. LONG
CITY CLERK

April 14, 2021

NOTICE OF PUBLIC HEARING

You are hereby notified that the Somerville City Council will hold a Public Hearing on the following Petition. You are receiving this Notice because the Petitioner has reported that you own property that abuts the work that is being proposed. You and other members of the public are invited to attend and be heard at this Hearing.

Because of Governor Baker's and Mayor Curtatone's recent orders limiting the number of people that may gather in one place, **this meeting of the City Council will be conducted via remote participation, online in a webinar hosted on the GoToWebinar platform.**

You have two ways to be heard at this meeting:

1. To attend and be heard, enter the link exactly as it appears below into your internet browser any time before the meeting. You will then be asked to register for the meeting. After registering, you will receive an email with instructions to join the webinar when it starts.
2. If you are unable to attend but wish to be heard, you may send written comments by US mail to the City Clerk at the address below, or by email to cityclerk@somervillema.gov. Your comments must arrive no later than 12 Noon on the day of the Hearing, in order to be sure they are conveyed to the Council.

PETITION: Verizon seeks a Grant of Location to install 85 feet of conduit in Pennsylvania Avenue, from existing Manhole 117 to an existing handhole located near the intersection of Pennsylvania Avenue and Vermont Avenue.

PLACE: <https://attendee.gotowebinar.com/register/1136885541805016335>.

TIME: Thursday, April 22, 2021, at 7:00 PM.

PURPOSE: The work is necessary to provide or improve service to the surrounding area.



PETITION PLAN

MUNICIPALITY SOMERVILLE VZ N.E. Inc. No. 1A4TC6W

VERIZON NEW ENGLAND, INC DATE: MARCH 29, 2021

SHOWING PROPOSED INSTALLATION OF CONDUIT ON PENNSYLVANIA AVENUE

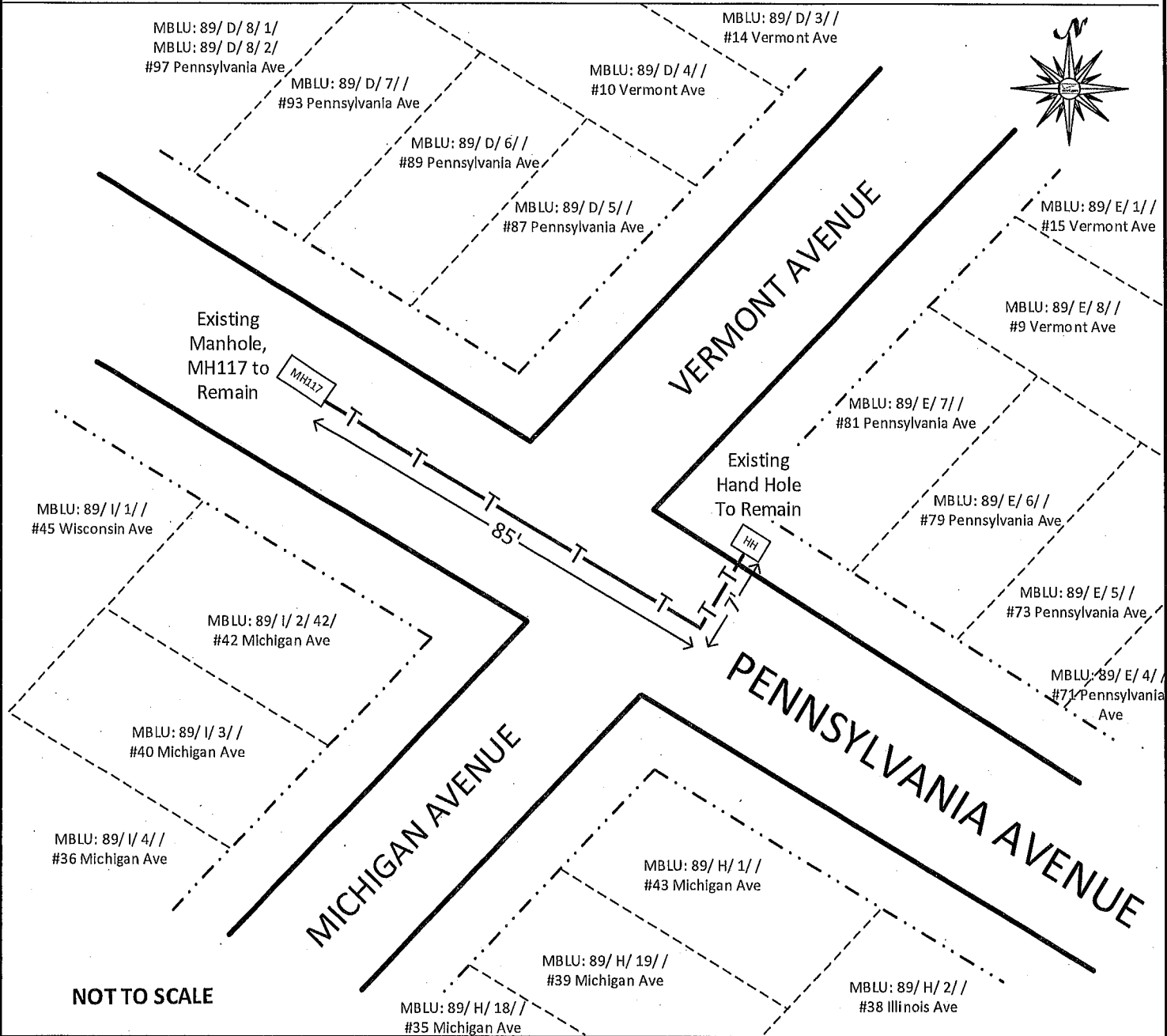

LEGEND

- | | | | |
|--|------------------|--|-----------------------|
| | EDGE OF PAVEMENT | | EXISTING MH TO REMAIN |
| | EDGE OF ROADWAY | | PROPOSED CONDUIT |
| | PROPERTY LINE | | EXISTING HAND HOLE |

ABUTTERS LIST

MBLU: 89/ E/ 4/ /
71 Pennsylvania Avenue

DIMITRAKOS MARIA PIA & EMMANUIL
71 Pennsylvania Avenue
Somerville, MA 02145

MBLU: 89/ E/ 5/ /
73 Pennsylvania Avenue

DIXON WALTER E & MARGARET M
121 Hanover Street
Hanover, MA 02339

MBLU: 89/ E/ 6/ /
79 Pennsylvania Avenue

ROBINSON THOMAS W
195 Davis Avenue #4
Brookline, MA 02445

MBLU: 89/ E/ 7/ /
81 Pennsylvania Avenue

LANIGAN JOHN T
83 Pennsylvania Avenue
Somerville, MA 02145

MBLU: 89/ E/ 8/ /
9 Vermont Avenue

BLACKET CAROL R & JOAN
11 Vermont Avenue
Somerville, MA 02145

MBLU: 89/ E/ 1/ /
15 Vermont Avenue

ERIC MARBERBLATT TRUSTEE
VERMONT REALTY TRUST
6 Whittier Place, Suite 3C
Boston, MA 02114

MBLU: 89/ D/ 3/ /
14 Vermont Avenue

WANG WENHUI & ZHANG XUAN
C/O ZMW PROPERTIES
PO BOX 43245
Somerville, MA 02143

ABUTTERS LIST

MBLU: 89/ D/ 4/ /
10 Vermont Avenue

LINEHAN MARY LOU
8 Vermont Avenue
Somerville, MA 02145

MBLU: 89/ D/ 5/ /
87 Pennsylvania Avenue

CIAMPA DIANA FOR LIFE
MARUJO DEBORAH A
87 Pennsylvania Avenue
Somerville, MA 02145

MBLU: 89/ D/ 6/ /
89 Pennsylvania Avenue

LA PIANA JOSEPH C & DOLORES A FOR LIFE
LAPIANA JOSEPH ETAL REM
89 Pennsylvania Avenue
Somerville, MA 02145

MBLU: 89/ D/ 7/ /
93 Pennsylvania Avenue

REYES-PINEDA AUSBERTO D
93 Pennsylvania Avenue
Somerville, MA 02145

MBLU: 89/ D/ 8/ 1/
97 Pennsylvania Avenue #1

CELANO KEN & HASKIN JESSICA
97 Pennsylvania Avenue #1
Somerville, MA 02145

MBLU: 89/ D/ 8/ 2/
97 Pennsylvania Avenue #2

TIERNAN III JAMES V
97 Pennsylvania Avenue #2
Somerville, MA 02145

MBLU: 89/ I/ 1/ /
45 Wisconsin Avenue

TOURKANTONIS ROBERT C
45 Wisconsin Avenue
Somerville, MA 02145

ABUTTERS LIST

MBLU: 89/ I/ 2/ 42/
42 Michigan Avenue

ANGELL JESSICA
S/O JOHN B & JESSICA ANGELL CARLSON
42 Michigan Avenue
Somerville, MA 02145

MBLU: 89/ I/ 3/ /
40 Michigan Avenue

LAO JOANNE
38 Michigan Avenue
Somerville, MA 02145

MBLU: 89/ I/ 4/ /
36 Michigan Avenue

BAIROS MANUEL
34 Michigan Avenue
Somerville, MA 02145

MBLU: 89/ H/ 18/ /
35 Michigan Avenue

DEANGELIS PAUL A & MARY ANN
37 Michigan Avenue
Somerville, MA 02145

MBLU: 89/ H/ 19/ /
39 Michigan Avenue

MITRANO FAMILY LLC
291 Main Street
Stoneham, MA 02180

MBLU: 89/ H/ 1/ /
43 Michigan Avenue

CANTALUPA ANTHONY & KATHLEEN FOR LIFE
43 MICHIGAN AVE REALTY TRUST
43 Michigan Avenue
Somerville, MA 02145

ABUTTERS LIST

MBLU: 89/ H/ 2/ /
38 Illinois Avenue

SOMNOIS LLC
C/O KUNEVICH & LAU PROP MGMT
810 Memorial Drive, STE 106
Cambridge, MA 02139
