

2013 NOV 25 P 2:17

CITY CLERK'S OFFICE
SOMERVILLE, MA

APPLICATION FOR A BOA MOBILE FOOD VENDOR LICENSE

Nonrefundable Application Fee \$150

Date 8/22/2013

FOR CITY CLERK'S OFFICE ONLY

Date Recorded 11/25/13

Amount Paid \$150.

☒ New Application

☐ Renewing Application with Amendments or Changes

☐ Renewing Application with NO Amendments or Changes

Business (DBA) Name: The Scoop N Scooterz Phone: (224) 567-9031

Applicant's Federal Employer Identification Number: 46-3569318

Applicant's Legal Name: Austin Catterden

Applicant's Address (with Zip Code): 184 Harvard St. Medford MA, 02155

Mailing Name (where we should send correspondence to): Austin Catterden

Mailing Address (with Zip Code): 184 Harvard St. Medford MA, 02155

Emergency Contact: John Catterden Phone: (847) 636-2998

Type of Business (Check Only One and Provide the Names Indicated):

☐ **Sole Proprietor:** Name of Owner: _____

☐ **Partnership (inc. LLP):** Name of Partnership: _____

Names of All Partners Who Own More Than 10%: _____

☐ **Trust:** Name of Trust: _____

Names of All Trustees Who Own More Than 10%: _____

☐ **Corporation:** Name of Corporation: _____

Name of President: _____

Name of Secretary: _____ Name of Treasurer: _____

☒ **LLC:** Name of LLC: The Scoop N Scooterz LLC

Names of All Managers: Austin Catterden

☐ **Other** (Attach a Description of the Form of Ownership and the Names of Owners)

Mass. Hawkers and Peddlers License Number (Attach a copy) _____

Description of the proposed foods to vend (attach menu) Richardson's Ice cream
and frozen Yogurt. See attached menu

Description of the proposed truck or cart with dimensions (attach photo) See attached
diagrams and pictures.

Location(s) you are requesting: (Depending on how you operate, there may be parking fees associated)	Months, Dates, Days, and Times you will operate. (You must be on-site at these times or your license may be rescinded)	Traffic & Parking Department Review:
<u>Tufts Campus</u> : College Ave. south of Talbot St., adjacent to the parking lot and adjacent to the Tufts Oval.	First available parking South of Talbot • Schedule attached	<input checked="" type="checkbox"/> Approved <input type="checkbox"/> Not Approved T&P: <u>AEHlt *</u>
<u>Davis Square</u> : 1 st legal parking space west of the MBTA Red Line station on the south side of Holland St.	First available parking west of MBTA Red Line • Schedule attached	<input checked="" type="checkbox"/> Approved <input type="checkbox"/> Not Approved T&P: <u>AEHlt *</u>
<u>Union Square</u> : Parking Lot space(s) in front of Precinct and Independent, adjacent to the pedestrian mall.		<input checked="" type="checkbox"/> Approved <input type="checkbox"/> Not Approved T&P:
<u>Magoun Square</u> : South side of Broadway east of Cedar St. adjacent to Trum Field. <u>Trum Field</u>	First legal parking west of Charles Ryan Road adjacent to Trum Field • Schedule Attached	<input checked="" type="checkbox"/> Approved <input type="checkbox"/> Not Approved T&P: <u>AEHlt *</u>
<u>City Hall</u> : Concourse in front of High School.	• See attached Diagram for specific location on concourse	<input checked="" type="checkbox"/> Approved <input type="checkbox"/> Not Approved T&P: <u>AEHlt *</u>
<u>Other Location</u> (attach Vending Site Plan): <u>Tufts University</u> <u>Packard Ave.</u>	• First parking spot on east side of Packard just North of Talbot Ave.	<input checked="" type="checkbox"/> Approved <input type="checkbox"/> Not Approved T&P: <u>AEHlt *</u>
<u>Other Location</u> (attach Vending Site Plan): <u>Union Square</u> <u>- Site Plan Attached</u>	First meter space on the right side of the street before the Somerville Ave, Brow Street Fork	<input checked="" type="checkbox"/> Approved <input type="checkbox"/> Not Approved T&P: <u>AEHlt *</u>
<u>Other Location</u> (attach Vending Site Plan):		<input type="checkbox"/> Approved <input type="checkbox"/> Not Approved T&P:

* Other vendors have applied
based on sharing of space

ACKNOWLEDGEMENT

I hereby state that all information provided on this application is true and accurate, and I understand that any information found to be false or misleading will result in the forfeiture of this license and may result in a one-year wait before a new application can be submitted, as well as criminal prosecution. I also understand that the application fee required by the City is not refundable for any reason. I also certify that the applicant, to my best knowledge and belief, has filed all State tax returns and paid all State taxes required under law.

Signature of Applicant: *Austin Cattenden* Date: 8/22/2013
Print Name: Austin Cattenden Phone: (224) 567-9031

RELEASE AND INDEMNITY AGREEMENT

I hereby agree to release, discharge and hold harmless, the City of Somerville, Massachusetts, and its officers, employees, agents and servants from all actions, causes of action, claims, demands, damages, costs, loss of services, expenses and compensation associated with the applicant's conduct under this license.

Signature of Applicant: *Austin Cattenden* Date: 8/22/2013
Print Name: Austin Cattenden Phone: (224) 567-9031

DEPARTMENTAL APPROVALS

INSPECTIONAL SERVICES DEPARTMENT/HEALTH DIVISION (Required for ALL Mobile Food Vendors).

I have reviewed the required material for Board of Health licensure of this Mobile Food Vendor and have found that it conforms to all laws set by the State and City with regard to food codes.

☒ Approved ☐ Not Approved ☐ N/A Date: September 3 2013
Conditions: Plans to be submitted for Food Permit
Signature: *Marcus Lee* Print Name: M. Lee

FIRE PREVENTION BUREAU (Required for ALL Mobile Food Vendors using flammables).

I have inspected the truck or cart to be used by this Mobile Food Vendor and have found that it conforms to all laws set by the State and City with regard to fire codes.

☐ Approved ☐ Not Approved ☐ N/A Date: 8/26/13
Conditions: PENDING INSPECTION
Signature: *Lt R. MacLaughlin* Print Name: ROBERT MACLAUGHLIN

POLICE DEPARTMENT (Required for ALL Ice Cream Vendors).

I have reviewed the application for Police Licensure of this Ice Cream Vendor and have found that it conforms to all laws set by the State and City with regard to Ice Cream Trucks.

☒ Approved ☐ Not Approved ☐ N/A Date _____
Conditions MSB license needs to reflect Applicant address
Signature [Signature] Print Name Thomas P. Bunnello

OTHER CONDITIONS

1. This license is required to operate anywhere within Somerville city limits, but it does not by itself give permission to operate in areas not under the City's control, including private property and certain streets and areas owned by the state. The City may require evidence that the Applicant has permission to operate in these areas at any time.
2. The following streets and areas are owned by the state, and may require state approval to operate, in addition to this license:

Alewife Brook Parkway	Foss Park	Mystic River shoreline
Fellsway	Lombardi Way	Mystic Valley Parkway
Fellsway West	McGrath Highway	
3. The Applicant shall not operate at, or within 500 feet of, public events legally permitted by the City, unless explicitly requested and authorized by the event organizer and approved by the Inspectional Services Department/Health Division.
4. The Applicant shall not operate between the hours of 9:00 PM and 8:00 AM, unless explicitly requested and authorized by this license.
5. The Applicant shall operate at the locations and times described and approved in this application.
6. The Applicant shall not use styrofoam products.
7. The Applicant shall not park adjacent to a bus stop, taxi stand, or loading zone, or handicap ramp, within 30 feet of an intersection, or directly in front of a property entryway. Pedestrian walkways of at least 6 feet must be maintained on the service side of the mobile food vehicle.
8. The Applicant shall not park at a designated short-term metered space, occupy more than 2 metered parking spaces, or operate at a hooded metered space or a parking meter that is temporarily out of service
9. Parking at a metered space shall only be allowed at an operational metered space, complying with all posted requirements and fees. Parking at a designated short-term metered space shall not be permitted.
10. When any portion of the mobile food vehicle, including any accessories, extends into an adjacent parking space, then that space shall be considered occupied by the mobile food vehicle and the licensee must comply with all posted meter requirements.
11. The Applicant shall not reserve a metered parking space by blocking, barricading, hooding, signing, or in any other manner preventing another vehicle from occupying the space.

12. The applicant shall not park in such a manner so as to create a traffic hazard.
13. Sales by licensee shall be made on the curbside only and the vehicle shall be parked within 1 foot of the curb.
14. The Applicant shall not sell, lend, lease, or in any manner transfer this license.
15. The Applicant shall post this License conspicuously in a place visible to all customers.
16. The Applicant shall set out a trash and recycling receptacle for the use of the public while at a vending site. Said receptacles, and all papers, containers, garbage or other litter shall be removed by the Applicant. The Applicant shall regularly remove any litter found on adjacent streets, sidewalks and alleys, within 100 feet of the vending site.
17. Other conditions: _____

ACCEPTANCE OF CONDITIONS

I hereby state that I will adhere to all of the conditions listed above, including all of the conditions set forth by the City Departments in the approvals provided above. I also understand that any violation of the City's rules and regulations pertaining to Mobile Food Vendors could subject me to arrest, fine, and/or loss of this license

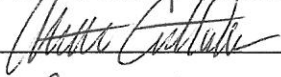
Signature of Applicant  Date 8/22/2013
Print Name: Austin Catterden Phone: (224) 567-9031

The Scoop 'N' Scootery
Ice Cream Delivery

Weekly Route Schedule

- **Monday**
 - 12pm- 4pm Somerville High School (Highland Ave)
 - 4pm- 9pm Trum Field (Broadway)
 - 9pm- 12am Tufts University (College Ave)
- **Tuesday**
 - 12pm- 4pm Davis Square (Holland St)
 - 4pm- 9pm Trum Field (Broadway)
 - 9pm- 2am Tufts University (College Ave)
- **Wednesday**
 - 12pm- 4pm Somerville High School (Highland Ave)
 - 4pm- 9pm Trum Field (Broadway)
 - 9pm- 12am Tufts University (College Ave)
- **Thursday**
 - 12pm- 3pm Trum Field (Broadway)
 - 3pm- 6pm Union Square (Somerville Ave)
 - 6pm- 9pm Davis Square (Holland Ave)
 - 9pm- 2am Tufts University (Packard Ave)
- **Friday**
 - 12pm- 4pm Somerville High School (Highland Ave)
 - 4pm- 6pm Union Square (Somerville Ave)
 - 6pm- 9pm Davis Square (Holland Ave)
 - 9pm- 2am Tufts University (Packard Ave)
- **Saturday**
 - 12pm-3pm Davis Square (Holland Ave)
 - 3pm- 9pm Trum Field (Broadway)
 - 9pm-2am Tufts University (Packard Ave)
- **Sunday**
 - 12pm-4pm Trum Field (Broadway)
 - 4pm-12am Tufts University (Packard Ave)

The Scoop N Scootery will operate Thursday-Saturday
12pm-12am until approval for extended hours of operation
agreement. Once extended hours are approved, The
Scoop N Scootery will operate Thursday-Saturday
12pm-2am.

Tufts University
Packard Ave. & College Ave.
Weekly Route Schedule

- **Monday**
 - 9pm- 12am
- **Tuesday**
 - 9pm- 2am
- **Wednesday**
 - 9pm- 12am
- **Thursday**
 - 9pm- 2am
- **Friday**
 - 9pm- 2am
- **Saturday**
 - 9pm- 2am
- **Sunday**
 - 4pm- 12am



TUFTS UNIVERSITY
PARKARD AVENUE
8/25/2013

PROFESSOR'S ROW

SYMBOLS KEY

- VENDING TRUCK
- BUSINESS VENDING VEHICLE
- SIGN
- STREET LIGHT
- TELEPHONE POLE
- ENTRY DOOR
- PROPERTY LINE

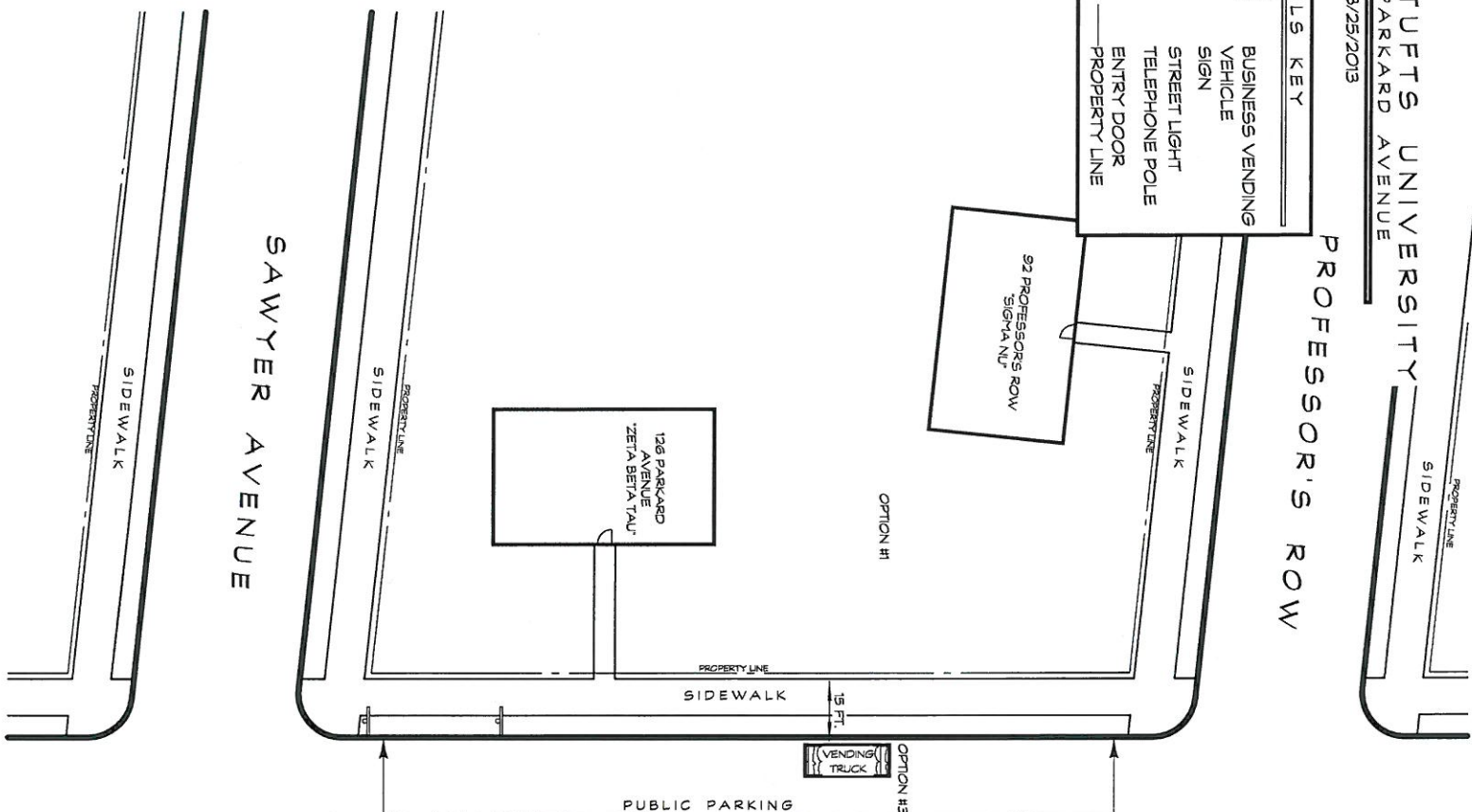

Proposed parking spot
First parking spot on east
side of Parkard after Talbot

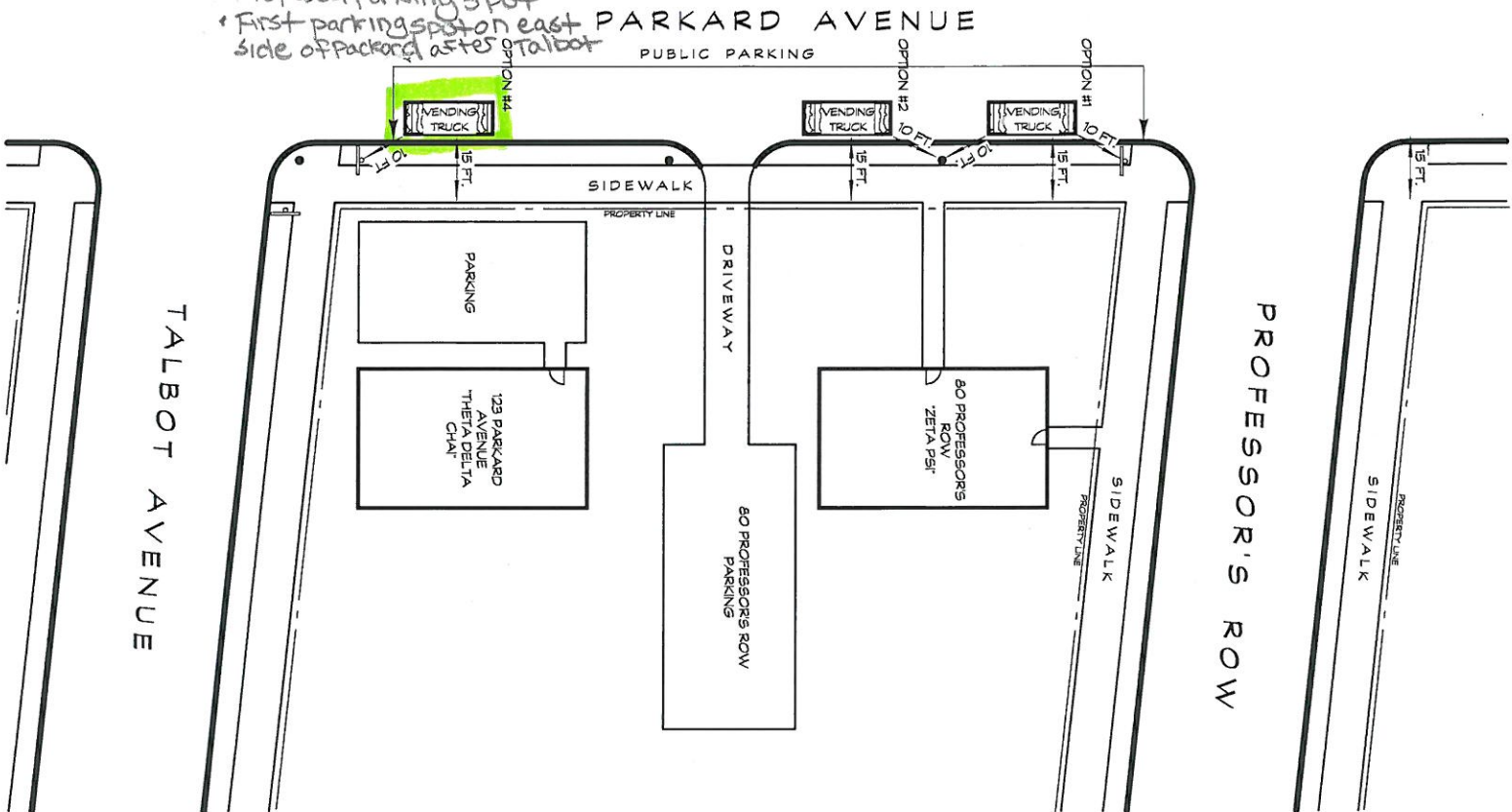



TUFTS UNIVERSITY
COLLEGE AVENUE
8/8/2013

SYMBOLS KEY	
	BUSINESS VENDING
	VEHICLE
	SIGN
	STREET LIGHT
	ENTRY DOOR
	PROPERTY LINE

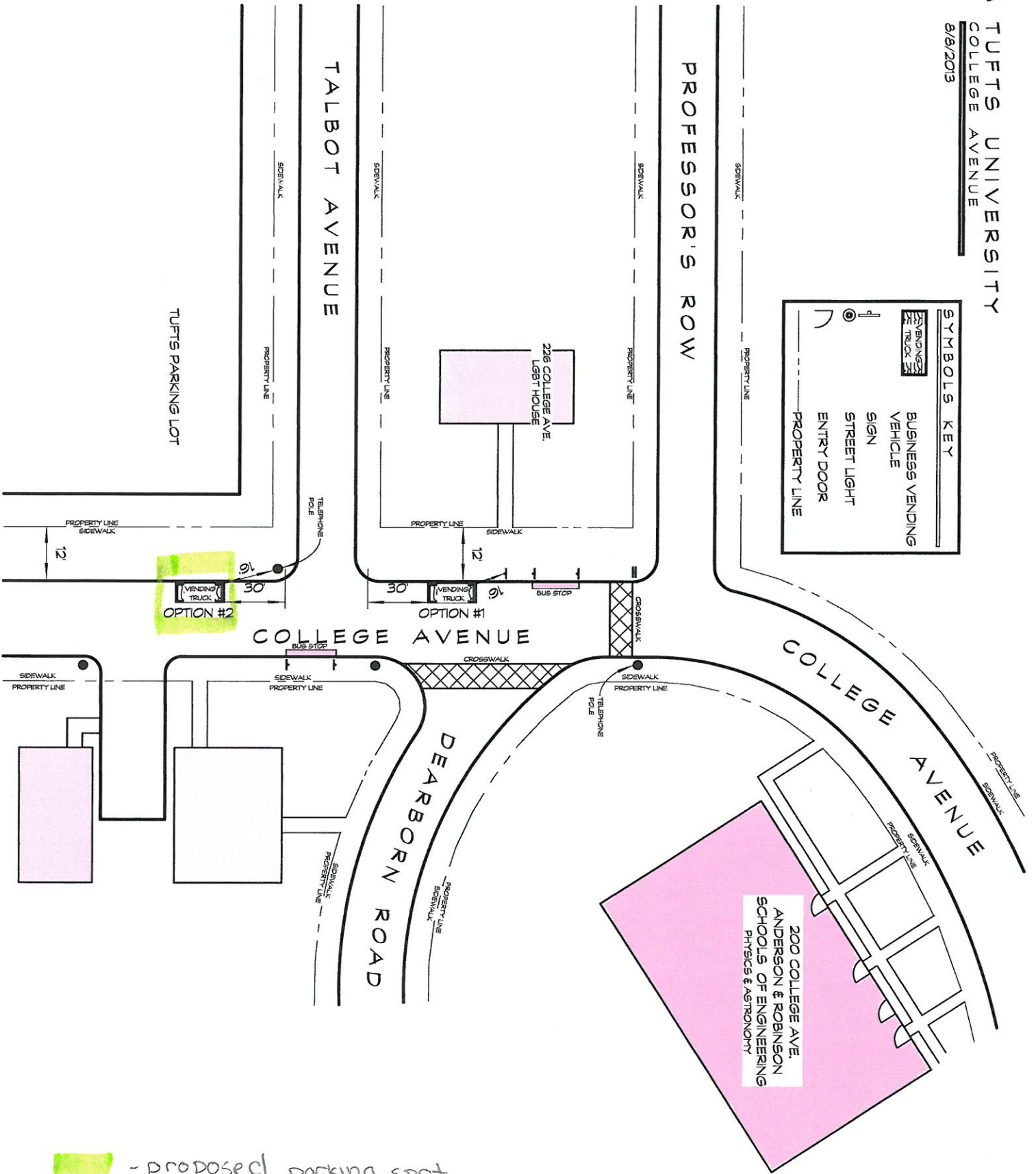

- proposed parking spot

**Davis Square
Holland St.**
Weekly Route Schedule

- **Monday**
 - N/A
- **Tuesday**
 - 12pm- 4pm
- **Wednesday**
 - N/A
- **Thursday**
 - 6pm- 9pm
- **Friday**
 - 6pm- 9pm
- **Saturday**
 - 12pm- 3pm
- **Sunday**
 - N/A

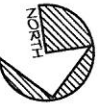

DAVIS SQUARE
HOLLAND STREET
8/20/2013

SYMBOLS KEY	
	BUSINESS VENDING TRUCK
	VEHICLE
	SIGN
	STREET LIGHT
	ENTRY DOOR
	PROPERTY LINE

SOMERVILLE
PAY-TO-PARK
PUBLIC PARKING

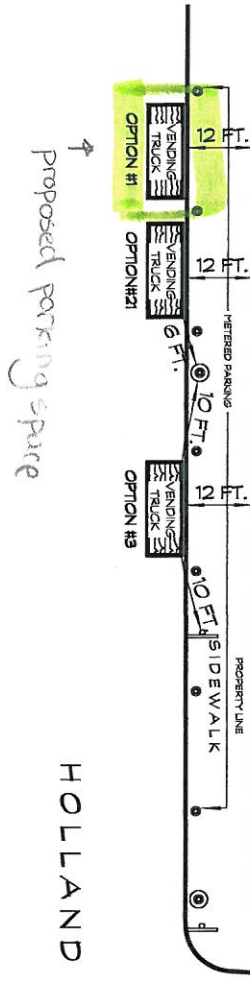

HOLLAND STREET

BUENA VISTA ROAD

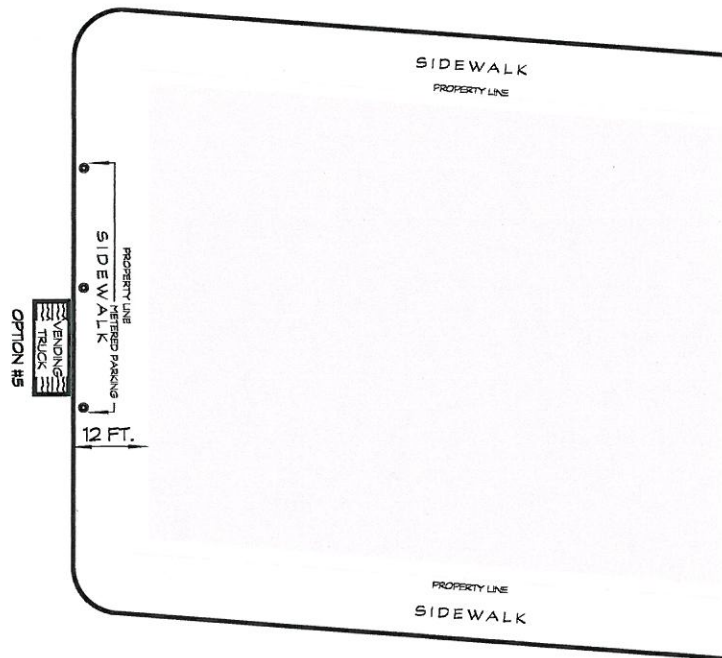

IRVING STREET

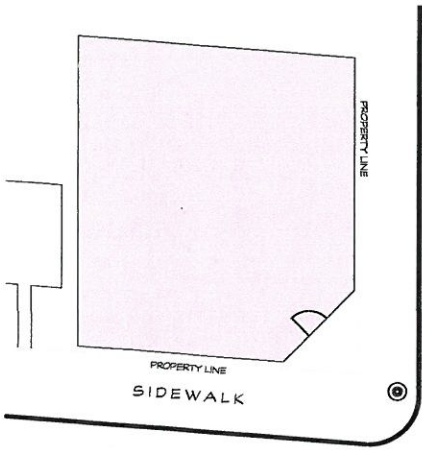
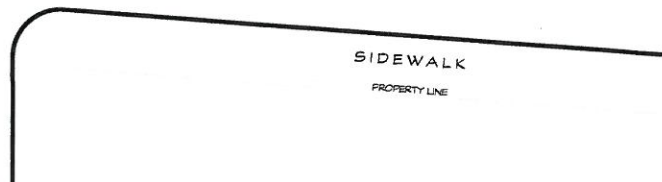

WALLACE STREET

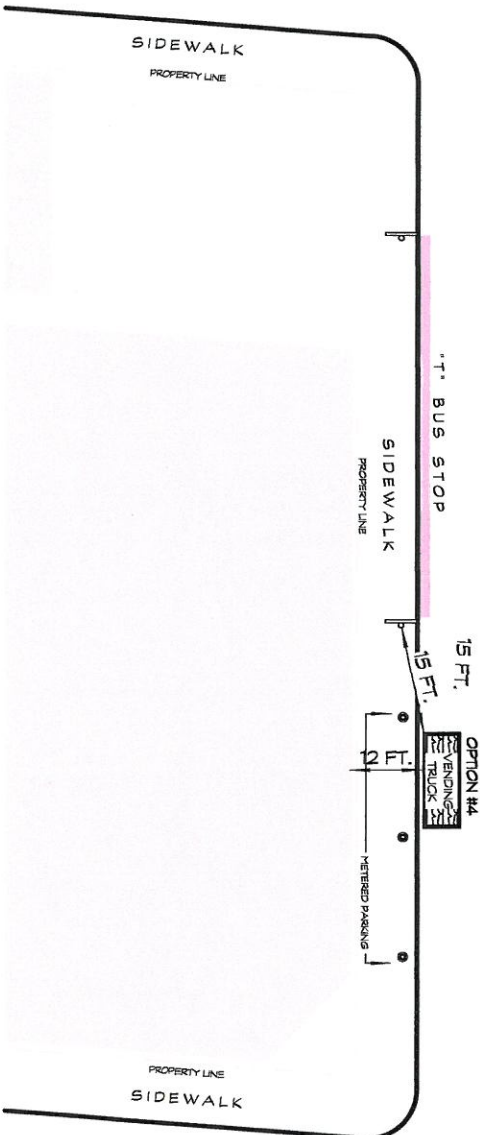

IRVING STREET

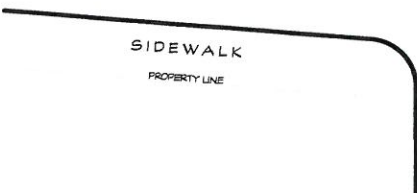

**Trum Field
Broadway**
Weekly Route Schedule

- **Monday**
 - 4pm- 9pm
- **Tuesday**
 - 4pm- 9pm
- **Wednesday**
 - 4pm- 9pm
- **Thursday**
 - 12pm- 3pm
- **Friday**
 - N/A
- **Saturday**
 - 3pm- 9pm
- **Sunday**
 - 12pm- 4pm



TRUM FIELD
BROADWAY

8/20/2013

SYMBOLS KEY



BUSINESS VENDING
VEHICLE

SIGN

STREET LIGHT

ENTRY DOOR

PROPERTY LINE

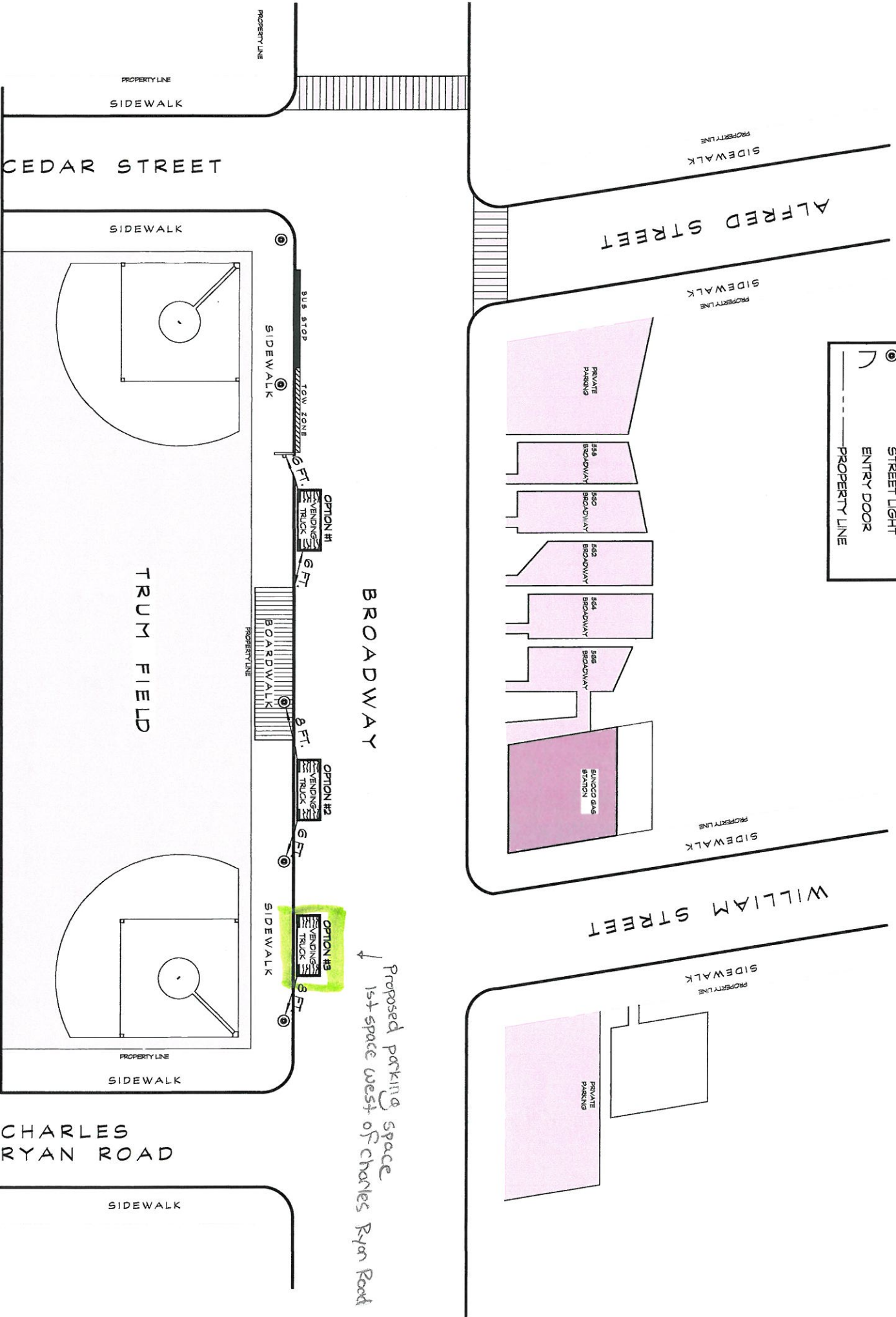

BROADWAY

TRUM FIELD

CEDAR STREET

ALFRED STREET

WILLIAM STREET

CHARLES
RYAN ROAD

Proposed parking space
1st space west of Charles Ryan Road

Somerville High School
Highland Ave.
Weekly Route Schedule

- **Monday**
 - 12pm-4pm
- **Tuesday**
 - N/A
- **Wednesday**
 - 12pm-4pm
- **Thursday**
 - N/A
- **Friday**
 - 12pm-4pm
- **Saturday**
 - N/A
- **Sunday**
 - N/A



9/21/2013

HIGHLAND AVENUE

SOMERVILLE HIGH SCHOOL

SYMBOLS KEY

- BUSINESS VENDING TRUCK
- SIGN
- STREET LIGHT
- ENTRY DOOR

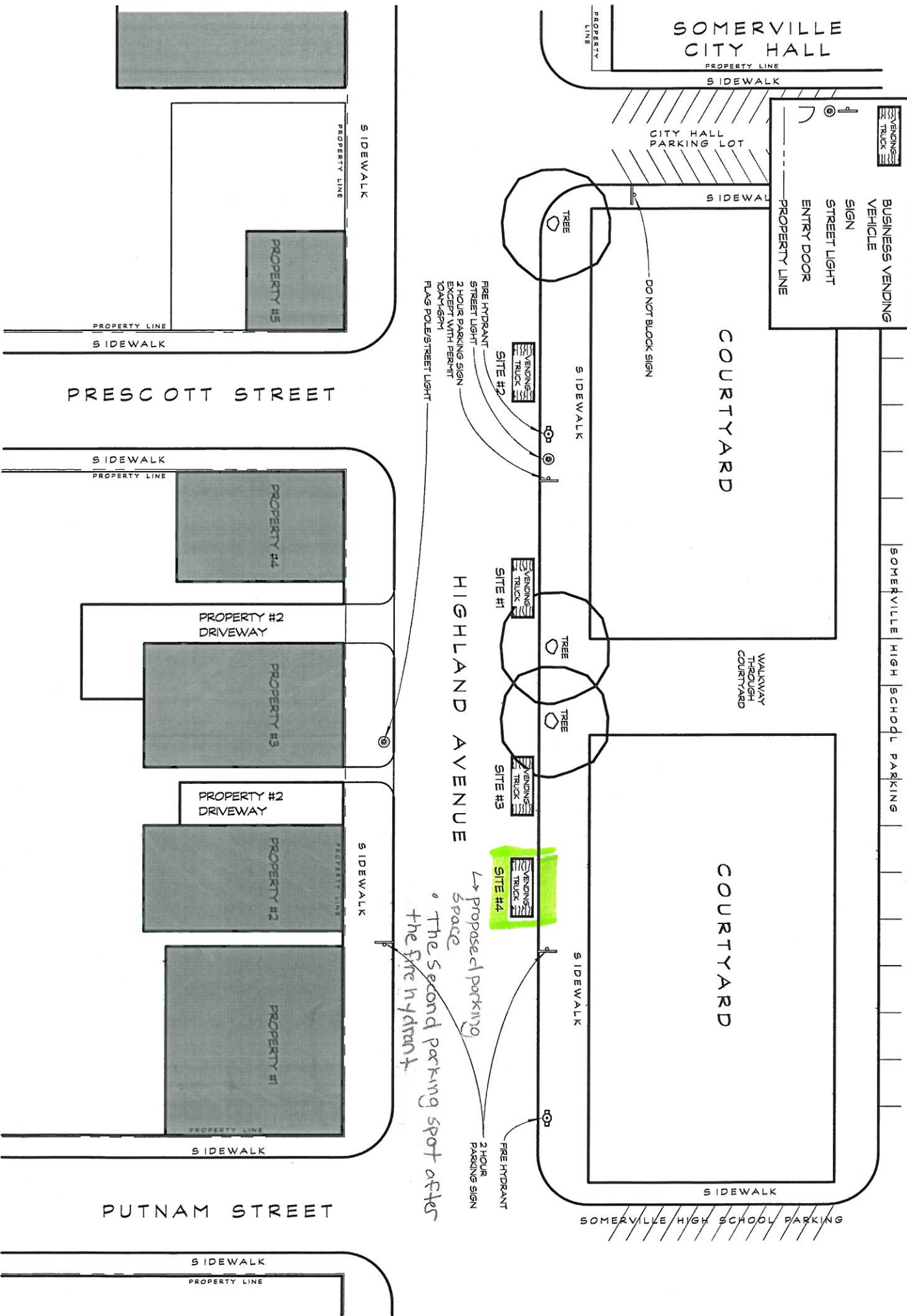

**Union Square
Somerville Ave.**
Weekly Route Schedule

- **Monday**
 - N/A
- **Tuesday**
 - N/A
- **Wednesday**
 - N/A
- **Thursday**
 - 3pm-6pm
- **Friday**
 - 4pm-6pm
- **Saturday**
 - N/A
- **Sunday**
 - N/A



UNION SQUARE
SOMERVILLE AVENUE
8/8/2013

SYMBOLS KEY	
	BUSINESS VENDING TRUCK
	SIGN
	STREET LIGHT
	ENTRY DOOR
	PROPERTY LINE

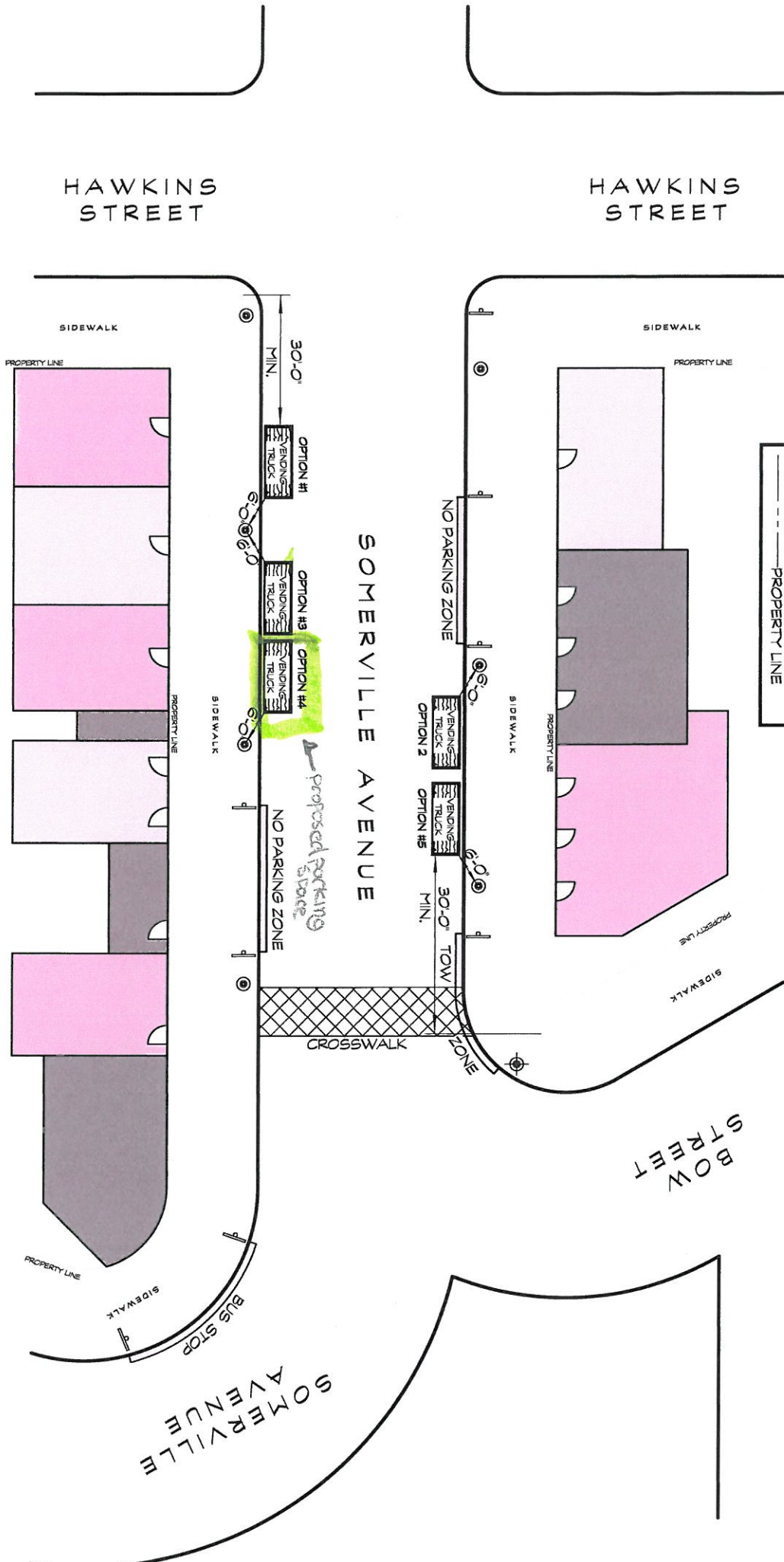

MAX FUSE SIZE 15 AMP
 NEMA PLUG CONFIGURATION: 5-15P
 TOTAL AMP DRAW: 7.3
 REFRIGERANT: R134a
 ELECTRICAL: 115/60/1

STAINLESS STEEL
 ICE CREAM PREP
 TABLE - 24" L x 24" D

ATLANTIC METALWORKS
 HS-59-5-55, 2-HOLE HAND
 SINK, 12" Wx 16" D, 12 1/2" H

64" SERVING WINDOW & COUNTER

ATLANTIC METALWORKS
 3CS-10-410, 3 COMPARTMENT
 SINK, 35" Wx 19 1/2" D, 42" H

STAINLESS STEEL ICE CREAM
 PREP TABLE - 48" L x 24" D

(4) 2 TIER - 6 QT. TOPPING BINS.

STAINLESS STEEL ICE CREAM PREP TABLE - 72" L x 24" D

KELVINATOR REACH-IN
 FREEZER - KRS221LH

KELVINATOR REACH-IN
 REFRIGERATOR - KRS220RH

NORLAK - ICE CREAM DIPPING & STORAGE CABINET - FP284

(2) NEWCO - 77316 ICE CREAM S.S. SPACE
 SAVING WHEELS 6" x 4" D, MOUNTED
 ABOVE DIPPING CABINET.

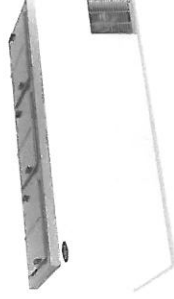
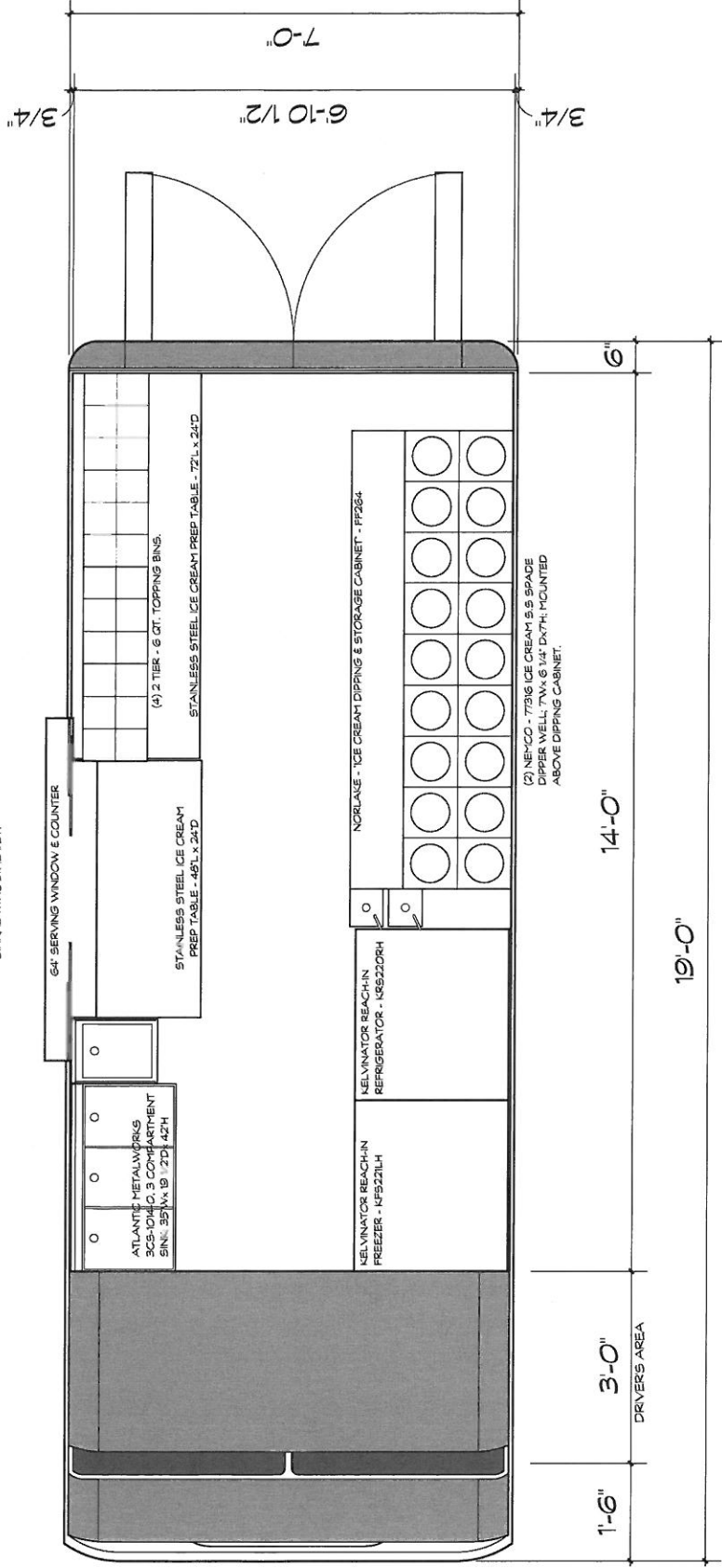

KELVINATOR REACH-IN FREEZER, MODEL KRS221LH
 DIMENSIONS:
 HEIGHT (INCL. CASTERS) - 72 3/4"
 WIDTH - 35"
 DEPTH (DOOR CLOSED) - 24 5/8"
 DEPTH (DOOR OPEN) - 59 1/4"
 SPECIFICATIONS:
 TOTAL CAPACITY (C. F.) - 9.2
 POWER OUTLET LOCATION - REAR, BOTTOM - RIGHT
 VOLTAGE - 120V/50A
 PLUG TYPE - NEMA A 5-5P
 SHIPPING WEIGHT (APPROX.) - 273 LBS.
 ENERGY STAR
 NSF INTERNATIONAL CERTIFICATION

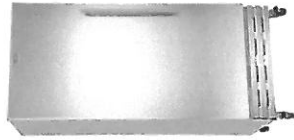

KELVINATOR REACH-IN REFRIGERATOR, MODEL KRS220RH
 DIMENSIONS:
 HEIGHT (INCL. CASTERS) - 72 3/4"
 WIDTH - 35"
 DEPTH (DOOR CLOSED) - 24 5/8"
 DEPTH (DOOR OPEN) - 59 1/4"
 SPECIFICATIONS:
 TOTAL CAPACITY (C. F.) - 18.4
 POWER OUTLET LOCATION - REAR, BOTTOM - RIGHT
 VOLTAGE - 120V/50A
 PLUG TYPE - NEMA A 5-5P
 SHIPPING WEIGHT (APPROX.) - 279 LBS.
 ENERGY STAR
 NSF INTERNATIONAL CERTIFICATION



SCOOP & SCOOTERY - ICE CREAM STEP VAN FLOOR PLAN/EQUIPMENT LAYOUT

3'-6" x 1'-0" SEPTEMBER 29TH, 2019 OCTOBER 2ND, 2019

The Scoop N Scootery

Current Menu

All Ice Cream and Frozen Yogurt will be produced and delivered by Richardson's Ice Cream to The Scoop N Scootery's commissary kitchen. Richardson's Ice Cream is located in Middleton Massachusetts. Richardson's is a reputable source of wholesale ice cream and frozen yogurt, and they will be the wholesale provider for The Scoop N Scootery for the foreseeable future.

Flavors

(Flavors Subject to Change)

Ice Cream	Frozen Yogurt (95%)
Rocky Road	Coffee Toffee
Totally Turtle	Pistachio
Mint Chocolate Chip	Vanilla
German Chocolate Cake	Purple Cow
Peanut Butter Oreo	Cookie Dough
Strawberry Cheesecake	Oreo
Coffee	Moose Tracks
Peanut Butter Cup	Chocolate Almond
Cake Batter	
Vanilla	

Toppings

(Whipped Cream Free on Sundays)

(Toppings Subject to Change)

(All Hot Toppings Go in To-Go Cup)

Chopped M&Ms	Gummy Bears	Chocolate Fudge	Crushed Pretzels
Chopped Kit Kat	Gummy Worms	Peanut Butter Sauce	Crushed Almonds
Chopped Oreos	Marshmallows	Chocolate Syrup	Crushed Pistachios
Chopped Reeses	Marshmallow Fluff	Caramel Syrup	Graham Cracker Bits
Chopped Snickers	Cookie Dough Bits	Butterscotch Sauce	Waffle Cone Bits
Chopped Toffee	Cinnamon	Strawberry Syrup	Crushed Cinnamon TC
Crushed Thin Mints	Whipped Cream and Cherry	Coconut	Strawberries
Chocolate Chips	Chocolate Sprinkles		Blueberries
White Chocolate Chips	Rainbow Sprinkles		Raspberries
Caramel Chips			Apples Bits
			Bananas
			Coconut

Sizes and Pricing

- Small (6oz.) (\$4.00) 12oz cup.
- Medium (8oz.) (\$5.50) 16 oz. cup.
- Large (10oz.) (\$6.75) 20oz. cup.

- *Choice of 2 Flavors.*
 - *Additional Flavors \$.25 (MAX 3 Additional)*
- *Toppings \$.50 Each (MAX 5 Toppings)*
- ******\$1 Delivery Charge******
- *No Delivery Minimum*
- *Foodler and Grubhub (Additional 8% to each order for GH and Foodler)*
 - ****Incentive for Website and Call order***

Scoop 'N' Scoot Sundae Creations

Original Sundae

1 Flavor Sundae- (Vanilla)

3 Toppings- (Hot Fudge, Whipped Cream, Crushed Almonds, Cherry on Top)

Sizes: Small \$5.25 Medium \$ 6.75 Large \$8.00

Candyland Delight Sundae

2 Flavor Sundae- (Vanilla and Strawberry Cheesecake)

3 Toppings- (Gummy Bears, Rainbow Sprinkles and Waffle Cone Bits)

Sizes: Small \$5.25 Medium \$ 6.75 Large \$8.00

Chocolate Mudslide Sundae

1 Flavor Sundae- (Peanut Butter Oreo)

2 Toppings (Caramel and Crushed Oreos)

Sizes: Small \$5.00 Medium \$6.50 Large \$7.75

Peanut Butter Mudslide Sundae

1 Flavor Sundae- (Peanut Butter Cup)

3 Toppings- (Caramel, Peanut Butter Sauce and Oreos)

Sizes: Small \$5.50 Medium \$ 7.00 Large \$8.25

MintMallow Sundae

1 Flavor Sundae- (Mint Chocolate Chip)

3 Toppings- (Hot Fudge, Marshmallows, Chocolate Sprinkles)

Sizes: Small \$5.50 Medium \$ 7.00 Large \$8.25

CarMallow Anthony Sundae

1 Flavor Sundae- (Totally Turtle)

3 Toppings- (Marshmallow Fluff, Caramel Chips and Marshmallows)

Sizes: Small \$5.50 Medium \$ 7.00 Large \$8.25

Peanut Butter Bomb Sundae

1 Flavor Sundae- (Peanut Butter Cup)

3 Toppings- (Peanut Butter Sauce, Chocolate Sauce and Chopped Reeses)

Sizes: Small \$5.50 Medium \$7.00 Large \$8.25

Fruity Waffle Sundae (Fro-yo Option)

1 Flavor Sundae- (Vanilla)

4 Toppings- (Waffle Cone Bits, Bananas, Strawberries, Blueberries)

Sizes: Small \$6.00 Medium \$ 7.50 Large \$8.75

Caramel Cone Crunch Sundae

1 Flavor Sundae- (Totally Turtle)

3 Toppings- (Waffle Cone Bits, Caramel Sauce, Whipped Cream and Cherry)
Sizes: Small \$5.25 Medium \$ 6.75 Large \$8.00

Reeses Pieces Sundae

2 Flavor Sundae- (Vanilla, Peanut Butter Cup)
3 Toppings- (Reeses, Whipped Cream, Chocolate Sprinkles)
Sizes: Small \$5.25 Medium \$ 6.75 Large \$8.00

Coffee Toffee Bomb Sundae (Fro Yo)

1 Flavor Sundae- (Coffee Toffee)
3 Toppings- (Mini Marshmallows, Whipped Cream, Caramel Sauce)
Sizes: Small \$5.25 Medium \$ 6.75 Large \$8.00

Cookie Monster Sundae (Fro Yo / Ice Cream)

1 Flavor Sundae- (Cookie Dough)
2 Toppings- (Cookie Dough Bits, Chopped M&Ms)
Sizes: Small \$5.00 Medium \$6.50 Large \$7.75

Purple Party Sundae (Fro-yo)

1 Flavor Sundae- (Purple Cow)
2 Toppings- (Gummy Bears and Rainbow Sprinkles)
Sizes: Small \$5.00 Medium \$6.50 Large \$7.75

The 'merican Sundae (Fro-yo Option)

1 Flavor Sundae- (Vanilla)
3 Toppings- (Blueberries, Strawberries, Whipped Cream and Cherry)
Sizes: Small \$5.25 Medium \$ 6.75 Large \$8.00

Irish Coffee Sundae (Fro-yo)

2 Flavor Sundae- (Coffee Toffee and Chocolate Almond)
2 Toppings- (Toffee Pieces and Light Chocolate Sauce)
Sizes: Small \$5.00 Medium \$6.50 Large \$7.75

Grasshopper Sundae

1 Flavor Sundae- (Mint Chocolate Chip)
3 Toppings- (Crushed Oreo, Chocolate Sprinkles, Whipped Cream)
Sizes: Small \$5.25 Medium \$6.75 Large \$8.00

S'more Sundae

1 Flavor Sundae- (Vanilla)
3 Toppings- (Marshmallows, Graham Cracker Bits and Chocolate Chips)
Sizes: Small \$5.50 Medium \$7.00 Large \$8.20

Mocha Chip Delight Sundae (Fro-yo)

1 Favor Sundae- (Coffee Toffee)
3 Toppings- (Chocolate Chips, Waffle Cone Pieces and White Chocolate Chips)
Sizes: Small \$5.50 Medium \$7.00 Large \$8.25

Almond Swirl Sundae (Fro-yo)

1 Flavor Sundae- (Chocolate Almond)
3 Toppings- (Caramel Sauce, Chocolate Chips and Caramel Sauce)
Sizes: Small \$5.50 Medium \$7.00 Large \$8.25

Purple Rain Sundae (Fro-yo)

1 Flavor Sundae- (Purple Cow)
2 Toppings- (Raspberries, White Chocolate Chips)
Sizes: Small \$5.00 Medium \$6.50 Large \$7.75

Apple Cinnamon Sundae (Fro-yo)

1 Flavor Sundae- (Vanilla)
3 Toppings- (Apple Bits, Crushed Cinnamon TC, Whipped Cream)

Sizes: Small \$5.25 Medium \$6.75 Large \$8.00

PB & Banana

2 Flavor Sundae- (Vanilla, Peanut Butter Cup)

3 Toppings- (Crushed Peanuts, Bananas, Whipped Cream)

Sizes: Small \$5.25 Medium \$ 6.75 Large \$8.00

Kit Kat Sundae (Fro-yo Option)

1 Flavor Sundae- (Vanilla)

2 Toppings- (Kit Kat Pieces, Chocolate Fudge)

Sizes: Small \$5.00 Medium \$6.50 Large \$7.75

Black Heart Sundae

1 Flavor Sundae- (German Chocolate Cake)

4 Toppings- (Chocolate Fudge, Chocolate Chips, Raspberries and Whipped Cream)

Sizes: Small \$5.75 Medium \$ 7.25 Large \$8.50

Banana Split Sundae

3 Flavor Sundae- (Choice of 3 Flavors)

3 Toppings- (Full Banana, Hot Fudge, Whipped Cream and Cherry)

Sizes: Small \$6.25 Medium \$7.75 Large \$9.00

Caramel Apple Sundae

1 Flavor Sundae- (Totally Turtle)

5 Toppings- (Apple bits, Caramel Sauce, Caramel Chips, Crushed Almonds, Chocolate Sauce)

Sizes: Small \$6.50 Medium \$ 7.75 Large \$9.00

Marshmallow Surprise Sundae

1 Flavor Sundae- (Vanilla)

4 Toppings- (Caramel Sauce, Hot Fudge, Marshmallows, Whipped Cream)

Sizes: Small \$5.75 Medium \$ 7.25 Large \$8.50

Banana Hammock Sundae

1 Flavor Sundae- (Totally Turtle)

4 Toppings- (Bananas, Chocolate Syrup, Chopped Reeses, Whipped Cream)

Sizes: Small \$5.75 Medium \$ 6.25 Large \$7.50

Caramel Almond Latte Sundae

2 Flavor Sundae- (Vanilla, Coffee)

3 Toppings- (Caramel Syrup, Crushed Almonds, Whipped Cream)

Sizes: Small \$5.25 Medium \$ 6.75 Large \$8.00

Dirt Sundae (Fro-yo Option)

1 Flavor Sundae- (Vanilla or Oreo)

4 Toppings- (Crushed Oreos, Gummy Worms, Chocolate Sauce, Whipped Cream)

Sizes: Small \$5.75 Medium \$7.25 Large \$8.50

Salted Caramel Sundae (Fro-yo Option)

1 Flavor Sundae- (Vanilla)

4 Toppings- (Caramel Sauce, Crushed Peanuts, Crushed Pretzels, Whipped Cream)

Sizes: Small \$5.75 Medium \$7.25 Large \$8.50

Peter Pan Sundae (Fro-yo)

1 Flavor Sundae- (Pistachio)

3 Toppings- Raspberries, Pistachio Bits, Whipped Cream

Sizes: Small \$5.25 Medium \$6.75 Large \$8.00

Smooth and Sticky Sundae (Fro-yo Option)

1 Flavor Sundae- (Vanilla)

4 Toppings- (Toffee Bits, Caramel Chips, Caramel Sauce, Butterscotch Sauce)

Sizes: Small \$6.00 Medium \$7.50 Large \$8.75

Mocha Madness

2 Flavor Sundae- (Coffee Toffee, Vanilla)

3 Toppings- (Caramel Sauce, Caramel Chips, Whipped Cream)

Sizes: Small \$5.25 Medium \$ 6.75 Large \$8.00

Strawberry Shortcake Sundae (Fro-yo Option)

1 Flavor Sundae- (Strawberry Cheesecake or Vanilla)

3 Toppings- (Strawberry Slices, Waffle Cone Bits, Whipped Cream and Cherry)

Sizes: Small \$5.25 Medium \$6.75 Large \$8.00

Chocolate Cookie Crumble Sundae

2 Flavor Sundae- (Oreo, Cookie Dough)

3 Toppings- (Crushed Oreo, Cookie Dough Bits, Whipped Cream)

Sizes: Small \$5.25 Medium \$6.75 Large \$8.00

Butternut Crunch Sundae (Fro-yo)

1 Flavor Sundae- (Moose Tracks)

3 Toppings- (Crushed Almonds, Butterscotch Sauce, Whipped Cream)

Sizes: Small \$5.25 Medium \$6.75 Large \$8.00

Tracks N Fluff Sundae (Fro-yo)

1 Flavor Sundae- (Moose Tracks)

4 Toppings- (Marshmallows, Chocolate Fudge, Marshmallow Fluff and Whipped Cream)

Sizes: Small \$5.75 Medium \$7.25 Large \$8.50

Beverages: Canned and Bottled

Coke	Sunkist
Diet Coke	Ice Tea
Sprite	Mountain Dew
Diet Sprite	Ginger Ale
Root Beer	Water



CITY OF SOMERVILLE, MASSACHUSETTS
Treasury Department
JOSEPH A. CURTATONE
MAYOR
CERTIFICATE OF GOOD STANDING

PLEASE PRINT

NAME OF PERSON REQUESTING CERTIFICATE: _____

BUSINESS LOCATION: N/A AND/OR

TAXPAYER'S HOME ADDRESS: 184 Harvard St. Medford MA

TAXPAYER/APPLICANT PHONE: DAY: (224) 667-9031 EVENING: (224) 667-9031

BUSINESS NAME: The Scoop N Scooters LLC

BUSINESS ID NUMBER: 416-3569318 BUSINESS PHONE: (224) 667-9031

I (print name) Austin Crittenden, the undersigned Taxpayer, do hereby certify that all the information contained herein is true and correct and all taxes and fees due to the City of Somerville have been paid or that the Taxpayer has entered into an agreement to pay all taxes and fees and is current on said agreement.

SIGNED UNDER THE PAINS AND PENALTIES OF PERJURY, this _____ day of _____,

20____. Austin Crittenden (Taxpayer's Signature)

CITY'S ACKNOWLEDGEMENT

DATE OF ISSUANCE: _____

TAXES AND ACCOUNT NUMBER(S)

**REAL ESTATE ID **WATER/SEWER ID **PERSONAL PROPERTY **OTHER

N/A N/A N/A _____

NOTES:

CLERKS INITIALS: UR

BUSINESS or BUILDING
PERMIT

ORIGINAL STAMP



The Commonwealth of Massachusetts
Department of Industrial Accidents
Office of Investigations
600 Washington Street
Boston, Mass. 02111

Workers' Compensation Insurance Affidavit - General Businesses

Applicant information:

Name: Austin Crittenden
Address: 184 Harvard St.
City: Medford State: MA Zip: 02155 Phone #: (224) 567-9031

- ☐ I am an employer with _____ employees (full and/or part time). Business Type: ☐ Retail
☐ I am a sole proprietor or partnership and have no employees. ☐ Restaurant/Bar/Eating Establishment
☐ We are a corporation that has exercised our right of exemption per c152 s1(4), and have no employees. ☐ Office and/or Sales (real estate, auto, etc.)
☐ We are a nonprofit organization staffed by volunteers and have no employees. ☐ Nonprofit
☐ Entertainment
☐ Manufacturing
☐ Health Care
☒ Other Mobile Food Business

Workers' compensation insurance information (if applicable):

Insurance Company Name: Total Insurance Services + The Travelers Indemnity Co.
Address: 3175 Commercial Ave.
City: Northbrook State: IL Zip: 60062 Phone #: _____
Policy #: UB - 6 DG 7502 - 1 - 13 Expiration Date: 10/01/2014

Applicant certification:

Failure to secure coverage as required under Section 25A of MGL 152 can lead to the imposition of criminal penalties of a fine up to \$1,500.00 and/or one years' imprisonment as well as civil penalties in the form of a STOP WORK ORDER and a fine of \$100.00 a day against me. I understand that a copy of this statement may be forwarded to the Office of Investigations of the DIA for coverage verification.

I do hereby certify under the pains and penalties of perjury that the information provided above is true and correct.

Signature: [Signature] Date: 10/16/2013
Print Name: Austin Crittenden

Official use only. Do not write in this area. To be completed by city or town official.

City or Town: _____ Permit/License #: _____
Contact Person: _____ Phone #: _____
☐ Board of Health
☐ Building Department
☐ City/Town Clerk
☐ Licensing Board
☐ Selectmen's Office
☐ Other _____