



**CITY OF SOMERVILLE**  
Commonwealth of Massachusetts  
93 Highland Avenue  
Somerville, MA 02143  
(617) 625-6600

## **BUSINESS LICENSE APPLICATION - Grant of Location**

File #: 23-000986

License #: BL23-000009

Address: 22 KENT ST

Licensee: Angel Hart NSTAR Electric dba Eversource Energy

DBA Name: NSTAR Electric dba Eversource Energy

Business Ownership Type: Corporation

Legal Name of Entity: NSTAR Electric Company dba Eversource Energy

Owners/Officers: Joseph R. Nolan Jr., , ,

### **License Information:**

**Grant of location issued to:** NSTAR Electric dba Eversource Energy

**Describe the reason for the work, and the intended beneficiaries:** To provide electric service to #22 Kent Street

**Insert here the same detailed description of the work as appears in the attached Grant of Location Order:** KENT ST- Northeasterly from pole 191/3, approximately 261' southwest of Somerville Avenue, to private property at #22 Kent Street, install approximately 102 feet of conduit WO #9225864

Approval Conditions:

### **Approved By:**

**Isabela Maia, Approved with Conditions**

APPROVAL CONDITION IMM 2023-01-24: Any work requiring the use of the street and/or sidewalk will require a Street/Sidewalk Occupancy Permit from the Engineering Department. Apply via Citizen Serve before conduit installation.

**Malik Drayton, Approved with Conditions**

APPROVAL CONDITION: MD20230123: Contractor shall take all necessary precautions to avoid damaging any tree or tree part with equipment.

APPROVAL CONDITION: MD20230123: All nearby street tree(s) shall be protected prior to and during all construction activities using TREE BOX or TREE WRAPS. . TREE BOX shall be constructed from 2 in. x 4 in. lumber creating a box around the border of the tree pit with 2 in. x 4 in. lumber standing straight up at the corners and wrapped with orange snow fence. Detail attached. . TREE WRAPS (TREE TRUNK WRAPPING PROTECTION LUMBER) shall consist of 2 in. x 4 in. and 8 ft. height lumber

wired together in close spacing with zip ties or 16 gauge galvanized steel wire to form a protective enclosure around tree trunks. Use burlap to separate the wood from the bark if necessary to prevent wood from scraping or bruising bark. Do not use staples or puncture the trunk in any way.

APPROVAL CONDITION: MD20230123: Any tree roots less than two (2) inches in diameter that cannot be avoided during construction shall be carefully and cleanly cut with a clean pair of pruning shears or loppers. Roots are to be cut back flush with the edge of the trench. If any tree roots greater than two (2) inches in diameter are encountered, stop work immediately and contact the City Urban Forester. Any and all pruning of roots greater than 2 inches in diameter must be completed under the supervision of the City Urban Forester.

**Eric Weisman, Approved**

**Kimberly M. Wells, Approved**



CITY OF SOMERVILLE, MASSACHUSETTS  
CITY CLERK'S OFFICE  
KATJANA BALLANTYNE  
MAYOR

KIMBERLY M. WELLS  
CITY CLERK

January 31, 2023

**NOTICE OF PUBLIC HEARING**

You are hereby notified that the Somerville City Council will hold a Public Hearing on the following Petition. You are receiving this Notice because the Petitioner has reported that you own property that abuts the work that is being proposed. You and other members of the public are invited to attend and be heard at this Hearing.

**This meeting of the City Council will also be conducted via remote participation, online in a webinar hosted on the GoToWebinar platform.**

You have three ways to be heard at this meeting:

1. To attend and be heard, enter the link exactly as it appears below into your internet browser any time before the meeting. You will then be asked to register for the meeting. After registering, you will receive an email with instructions to join the webinar when it starts.
2. You may also testify in person in the City Council Chamber, City Hall, 2<sup>nd</sup> Floor, 93 Highland Avenue, Somerville, MA 02143
3. If you are unable to attend but wish to be heard, you may send written comments by US mail to the City Clerk at the address below, or by email to [cityclerk@somervillema.gov](mailto:cityclerk@somervillema.gov). Your comments must arrive no later than 12 Noon on the day of the Hearing, in order to be sure they are conveyed to the Council.

**PETITION:** Eversource (NStar Electric) is applying for a Grant of Location to install 102 feet of conduit in Kent Street, from Utility Pole 191/3 to a point of pick up at 22 Kent Street.

**PLACE:** <https://attendee.gotowebinar.com/register/4903992713033911896> or  
City Council Chambers, City Hall, 2<sup>nd</sup> Floor, 93 Highland Avenue, Somerville, MA 02143

**TIME:** Thursday, February 9, 2023, at 7:00 PM.

**PURPOSE:** The work is necessary to provide service to 22 Kent Street.

W.O. 9225864

**EVERSOURCE**  
101 Linwood Street  
Somerville, MA 02143

January 13, 2023

Ms. Kimberly Wells  
Office of the City Clerk  
93 Highland Avenue  
Somerville, MA 02143

RE: Kent Street  
W.O. #9225864

Dear Ms. Wells:

NSTAR Electric Company d/b/a Eversource Energy respectfully requests a Grant of Location for the installation of conduit in Kent St, Somerville, MA.

This work is necessary in order to supply electric service to # 22 Kent St.

If you have any questions or concerns, please contact Jacqueline Duffy at 617-629-3204, or via email at [jacqueline.duffy@eversource.com](mailto:jacqueline.duffy@eversource.com).

Very truly yours,

*Kelly-Ann Correia*

Kelly-Ann Correia, Supervisor  
Rights, Permits and Public Works

rb/kc

INSTALL 2 - 4" PVC PIPES  
TYPE EB IN CONCRETE  
SECTION 2 FIG. 1

39/ B/ 5/ /  
622 SOMERVILLE AVE  
N/F  
FIRST SOMERVILLE INVEST  
LLC

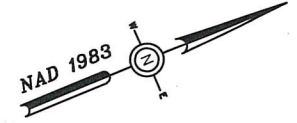

#622

# KENT ST

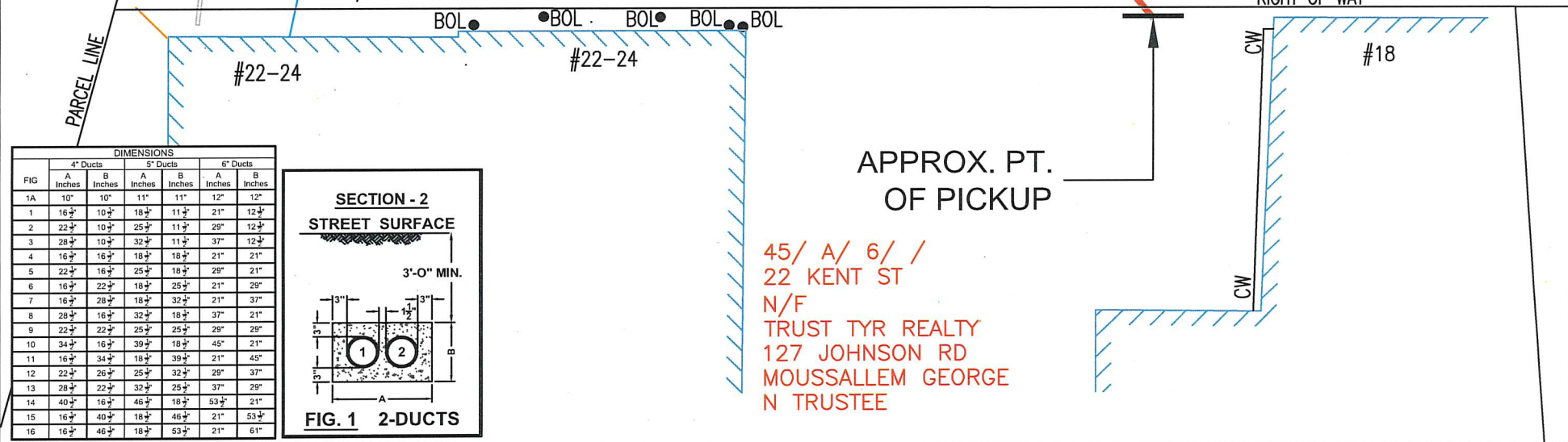
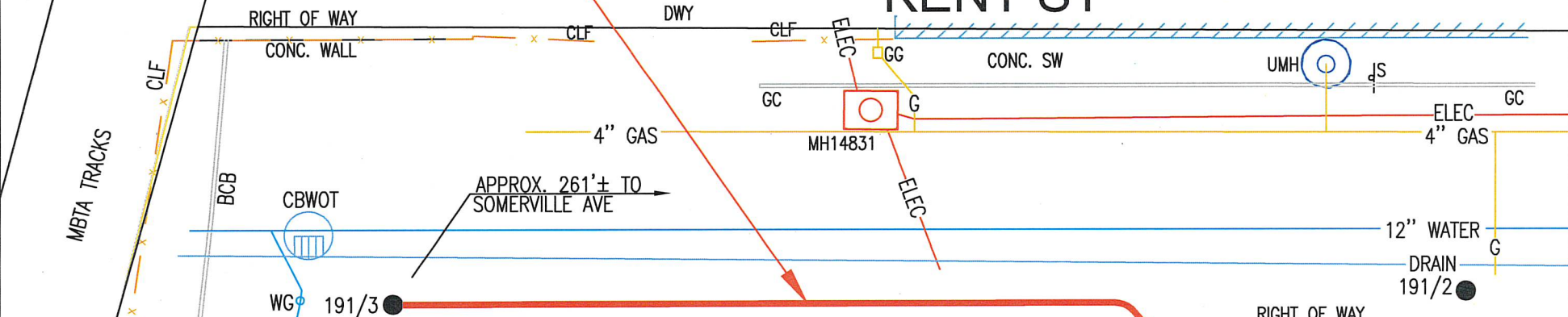
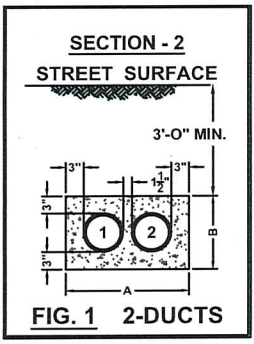

FIG	4" Ducts		5" Ducts		6" Ducts	
	A Inches	B Inches	A Inches	B Inches	A Inches	B Inches
1A	10"	10"	11"	11"	12"	12"
1	16 1/2"	10 1/2"	18 1/2"	11 1/2"	21"	12 1/2"
2	22 1/2"	10 1/2"	25 1/2"	11 1/2"	29"	12 1/2"
3	28 1/2"	10 1/2"	32 1/2"	11 1/2"	37"	12 1/2"
4	16 1/2"	16 1/2"	18 1/2"	18 1/2"	21"	21"
5	22 1/2"	16 1/2"	25 1/2"	18 1/2"	29"	21"
6	16 1/2"	22 1/2"	18 1/2"	25 1/2"	21"	29"
7	16 1/2"	28 1/2"	18 1/2"	32 1/2"	21"	37"
8	28 1/2"	16 1/2"	32 1/2"	18 1/2"	37"	21"
9	22 1/2"	22 1/2"	25 1/2"	25 1/2"	29"	29"
10	34 1/2"	16 1/2"	39 1/2"	18 1/2"	45"	21"
11	16 1/2"	34 1/2"	18 1/2"	39 1/2"	21"	45"
12	22 1/2"	26 1/2"	25 1/2"	32 1/2"	29"	37"
13	28 1/2"	22 1/2"	32 1/2"	25 1/2"	37"	29"
14	40 1/2"	16 1/2"	46 1/2"	18 1/2"	53 1/2"	21"
15	16 1/2"	40 1/2"	18 1/2"	46 1/2"	21"	53 1/2"
16	16 1/2"	46 1/2"	18 1/2"	53 1/2"	21"	61"



APPROX. PT.  
OF PICKUP

45/ A/ 6/ /  
22 KENT ST  
N/F  
TRUST TYR REALTY  
127 JOHNSON RD  
MOUSSALLEM GEORGE  
N TRUSTEE



BY YOUR USE OF THE INFORMATION CONTAINED IN THIS MAP, YOU AGREE THAT NO WARRANTY OF ANY KIND, EXPRESS OR IMPLIED, IS GIVEN WITH RESPECT TO THE INFORMATION. NEITHER NSTAR ELECTRIC COMPANY, NSTAR GAS COMPANY NOR ITS PARENTS, AFFILIATES, OFFICERS, DIRECTORS, SHAREHOLDERS, EMPLOYEES OR AGENTS (COLLECTIVELY THE "NSTAR ENTITIES") SHALL BE LIABLE FOR ANY LOSS OR INJURY CAUSED IN WHOLE OR IN PART BY USE OF THIS INFORMATION OR IN RELIANCE UPON IT, TO THE MAXIMUM EXTENT ALLOWED BY LAW, YOU AGREE BY YOUR ACCEPTANCE OF THE INFORMATION TO RELEASE, INDEMNIFY AND HOLD THE NSTAR ENTITIES HARMLESS FROM ANY SUCH LOSS OR INJURY.

THE INFORMATION MAY NOT REPRESENT A SURVEY, MAY NOT BE THE MOST COMPLETE AND IS SUBJECT TO CHANGE WITHOUT NOTICE. NO LIABILITY IS ASSUMED FOR THE ACCURACY OF THE INFORMATION, EITHER EXPRESSED OR IMPLIED. UNAUTHORIZED ATTEMPTS TO MODIFY THE INFORMATION OR USE THE INFORMATION FOR OTHER THAN ITS INTENDED PURPOSES ARE PROHIBITED.

**MASS. LAW**

REQUIRES 72 HOURS ADVANCE NOTICE TO UTILITY COMPANIES BEFORE DIGGING BY ANYONE. CALL DIG-SAFE 1-888-344-7233

C# 303-22
Ward #
Work Order # 9225864
Surveyed by: GC/BP
Research by: JC
Plotted by: GC
Proposed Structures: GC
Approved: T THIBAUT
P#

**NSTAR EVERSOURCE**  
ELECTRIC  
d/b/a  
1165 MASSACHUSETTS AVE. DORCHESTER, MASS. 02125

Plan of KENT STREET, SOMERVILLE

Showing PROPOSED CONDUIT LOCATION

Scale	1"=20'	Date	NOVEMBER 08, 2022
SHEET	1 of 1		

Location:  
39/ B/ 5/ /  
622 SOMERVILLE AVE  
Owner:  
FIRST SOMERVILLE INVEST LLC  
80 NASHUA RD BOX 24  
LONDONDERRY, NH 03053

Location:  
45/ A/ 6/ /  
22 KENT ST  
Owner:  
TRUST TYR RÉALTY  
MOUSSALLEM GEORGE N TRUSTEE  
18 STULTS RD.  
BELMONT , MA 02478

Location:  
45/ B/ 16/ /  
14 BLEACHERY CT  
Owner:  
CITY OF SOMERVILLE  
CONWAY PARK  
93 HIGHLAND ST  
SOMERVILLE, MA 02143