



CITY OF SOMERVILLE
Commonwealth of Massachusetts
93 Highland Avenue
Somerville, MA 02143
(617) 625-6600

BUSINESS LICENSE APPLICATION - Grant of Location

File #: 24-012769
License #: BL24-000090
Address: 154 BROADWAY
Licensee: Bill Conway Axis Engineering Group
DBA Name: RCN Telecommunication Services, LLC

Business Ownership Type: Partnership / LLP
Legal Name of Entity: RCN Telecommunication Services, LLC
Owners/Officers: , , ,

License Information:

Grant of location issued to: RCN Telecommunication Services, LLC

Describe the reason for the work, and the intended beneficiaries: Intercept existing RCN conduit in the roadway at 154 Broadway and trench and install (1) 4" PVC conduit southerly +/-10' to the property line. The purpose of the proposed work is to provide telecommunication service to the property.

Insert here the same detailed description of the work as appears in the attached Grant of Location

Order: Intercept existing RCN conduit in the roadway at 154 Broadway and trench and install (1) 4" PVC conduit southerly +/-10' to the property line.

Approval Conditions:

Approved By:

Isabela Maia, Approved with Conditions

APPROVAL CONDITION IMM 240618: Any work requiring the use of the street and/or sidewalk will require a Street/Sidewalk Occupancy Permit from the Engineering Department.

APPROVAL CONDITION IMM 240618: Bricks cannot be cut; brick crosswalks must be reset immediately following installation.

Malik Drayton, Approved with Conditions

APPROVAL CONDITION: MD20240618: Contractor shall take all necessary precautions to avoid damaging any tree or tree part with equipment.

APPROVAL CONDITION: MD20240618: All nearby street tree(s) shall be protected prior to and during all construction activities using TREE BOX or TREE WRAPS. . TREE BOX shall be constructed from 2 in. x 4 in. lumber creating a box around the border of the tree pit with 2 in. x 4 in. lumber standing straight up at the corners and wrapped with orange snow fence. Detail attached. . TREE WRAPS (TREE TRUNK WRAPPING PROTECTION LUMBER) shall consist of 2 in. x 4 in. and 8 ft. height lumber wired together in close spacing with zip ties or 16 gauge galvanized steel wire to form a protective enclosure around tree trunks. Use burlap to separate the wood from the bark if necessary to prevent wood from scraping or bruising bark. Do not use staples or puncture the trunk in any way. APPROVAL CONDITION:

MD20240618: Any tree roots less than two (2) inches in diameter that cannot be avoided during construction shall be carefully and cleanly cut with a clean pair of pruning shears or loppers. Roots are to be cut back flush with the edge of the trench. If any tree roots greater than two (2) inches in diameter are encountered, stop work immediately and contact the City Urban Forester. Any and all pruning of roots

greater than 2 inches in diameter must be completed under the supervision of the City Urban Forester. APPROVAL CONDITION: MD20240618: Any tree roots less than two (2) inches in diameter that cannot be avoided during construction shall be carefully and cleanly cut with a clean pair of pruning shears or loppers. Roots are to be cut back flush with the edge of the trench. If any tree roots greater than two (2) inches in diameter are encountered, stop work immediately and contact the City Urban Forester. Any and all pruning of roots greater than 2 inches in diameter must be completed under the supervision of the City Urban Forester.

APPROVAL CONDITION: MD20240618: Any tree roots less than two (2) inches in diameter that cannot be avoided during construction shall be carefully and cleanly cut with a clean pair of pruning shears or loppers. Roots are to be cut back flush with the edge of the trench. If any tree roots greater than two (2) inches in diameter are encountered, stop work immediately and contact the City Urban Forester. Any and all pruning of roots greater than 2 inches in diameter must be completed under the supervision of the City Urban Forester.

Eric Weisman, Approved

Kimberly M. Wells, Approved



CITY OF SOMERVILLE, MASSACHUSETTS
CITY CLERK'S OFFICE
KATJANA BALLANTYNE
MAYOR

KIMBERLY M. WELLS
CITY CLERK

August 13, 2024

NOTICE OF PUBLIC HEARING

You are hereby notified that the Somerville City Council will hold a Public Hearing on the following Petition. You are receiving this Notice because the Petitioner has reported that you own property that abuts the work that is being proposed. You and other members of the public are invited to attend and be heard at this Hearing.

This meeting of the City Council will also be conducted via remote participation, online in a webinar hosted on the Zoom platform.

You have three ways to be heard at this meeting:

1. To attend and be heard, enter the link exactly as it appears below into your internet browser any time before the meeting. You will then be asked to register for the meeting. After registering, you will receive an email with instructions to join the webinar when it starts.
2. You may also testify in person in the City Council Chamber, City Hall, 2nd Floor, 93 Highland Avenue, Somerville, MA 02143
3. If you are unable to attend but wish to be heard, you may send written comments by US mail to the City Clerk at the address below, or by email to cityclerk@somervillema.gov. Your comments must arrive no later than 12 Noon on the day of the Hearing, in order to be sure they are conveyed to the Council.

PETITION: RCN seeks a Grant of Location to install a total of 10 feet of conduit from an existing conduit to a point of pickup at 154 Broadway.

PLACE: https://us02web.zoom.us/webinar/register/WN_rTQrnfy-RQCG_QqKLjtYHsA or
City Council Chambers, City Hall, 2nd Floor, 93 Highland Avenue, Somerville, MA 02143

TIME: Thursday, August 22, 2024, at 7:00 PM.

PURPOSE: The work is necessary to provide service to 154 Broadway.



**PROPOSED CONDUIT INSTALLATION
AT
154 BROADWAY
SOMERVILLE, MA**

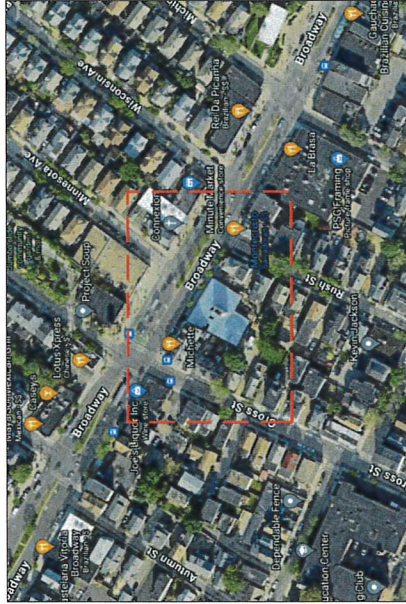

LOCUS
N.T.S

INDEX OF DRAWING

SHEET NO.	DESCRIPTION
01	COVER SHEET PROPOSED CONDUIT INSTALLATION

AXIS
ENGINEERING GROUP
201 Boston Post Rd West - Suite 100
Merrimack, MA 01752
(774) 356-2524 www.axisgroup.com

GENERAL NOTES

1. THE LOCATIONS OF EXISTING UNDERGROUND UTILITIES ARE SHOWN IN AN APPROXIMATE WAY ONLY AND HAVE NOT BEEN INDEPENDENTLY VERIFIED BY THE OWNER OR ITS REPRESENTATIVE. THE CONTRACTOR SHALL DETERMINE THE EXACT LOCATION OF ALL EXISTING UTILITIES BEFORE COMMENCING WORK, AND SHALL BE FULLY RESPONSIBLE FOR ANY AND ALL DAMAGES WHICH MIGHT BE OCCASIONED BY THE CONTRACTOR'S FAILURE TO EXACTLY LOCATE AND PRESERVE ANY AND ALL UNDERGROUND UTILITIES.
2. WHERE AN EXISTING UTILITY IS FOUND TO CONFLICT WITH THE PROPOSED WORK, THE LOCATION, ELEVATION AND SIZE OF THE UTILITY SHALL BE ACCURATELY DETERMINED WITHOUT DELAY BY THE CONTRACTOR, AND THE INFORMATION FURNISHED TO THE ENGINEER FOR RESOLUTION OF THE CONFLICT.
3. THE CONTRACTOR SHOULD MAINTAIN A SEPARATION OF 18 INCHES MIN. WHEN CROSSING EXISTING WATER FACILITIES.
4. THE CONTRACTOR SHALL MAKE ALL ARRANGEMENTS FOR THE ALTERATION AND ADJUSTMENT OF GAS, ELECTRIC, TELEPHONE AND ANY OTHER PRIVATE UTILITIES BY THE UTILITY COMPANY.
5. THE CONTRACTOR SHALL NOT DISTURB PUBLIC TREES AND SHRUBS.
6. AREAS OUTSIDE THE LIMITS OF PROPOSED WORK DISTURBED BY THE CONTRACTOR'S OPERATIONS SHALL BE RESTORED BY THE CONTRACTOR TO THEIR ORIGINAL CONDITION AT NO EXPENSE TO THE OWNER.
7. THE CONTRACTOR SHALL BE RESPONSIBLE FOR PLACING AND MAINTAINING TEMPORARY RESURFACING AND/OR PLATING FOR ALL EXCAVATIONS IN PAVED STREETS AND SIDEWALKS UNTIL PERMANENT RESURFACING IS COMPLETE.
8. JOINTS BETWEEN NEW BITUMINOUS CONCRETE ROADWAY PAVEMENT AND SAW CUT EXISTING PAVEMENT SHALL BE SEALED WITH BITUMEN AND BACK SANDED.
9. THE CONTRACTOR SHALL PROTECT AND SUPPORT ALL EXISTING UTILITY LINES THAT BECOME EXPOSED DUE TO EXCAVATION REQUIRED TO INSTALL THE PROPOSED CONDUIT.
10. THE CONTRACTOR SHALL REPLACE ALL DISTURBED TRAFFIC SIGNAL LOOP DETECTORS TO GOOD WORKING CONDITION AS REQUIRED BY THE LATEST STANDARDS OF THE MUNICIPAL TRAFFIC DEPARTMENT.
11. ALL EXISTING STATE, COUNTY, CITY, AND TOWN LOCATION LINES AND PRIVATE PROPERTY LINES HAVE BEEN ESTABLISHED FROM AVAILABLE INFORMATION AND THEIR EXACT LOCATION ARE NOT GUARANTEED.
12. THE CONTRACTOR SHALL REPLACE ALL PAVEMENT MARKINGS IN THEIR ENTIRETY THAT HAVE BEEN DAMAGED BY TRENCH EXCAVATION OR OPERATIONS OF THE CONTRACTOR WITH SIMILAR COLOR AND SIZE THERMOPLASTIC MARKINGS.

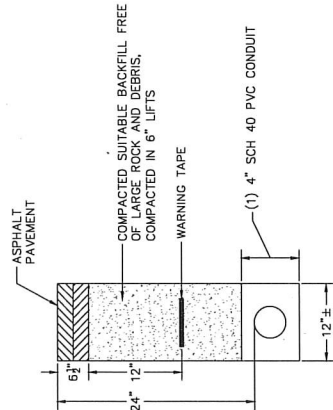

**ROADWAY PATCH AND DUCT BANK
INSTALLATION DETAIL**

N.T.S.

TRENCH DETAIL NOTES:

1. 24" MAXIMUM FROM TOP OF CONDUIT TO SURFACE.
2. 12" FROM TOP OF CONDUIT TO METALLIC WARNING TAPE PLACED ABOVE.
3. REPAIR SIDEWALKS AND WALKWAYS WITH SAME MATERIALS AS EXISTING.

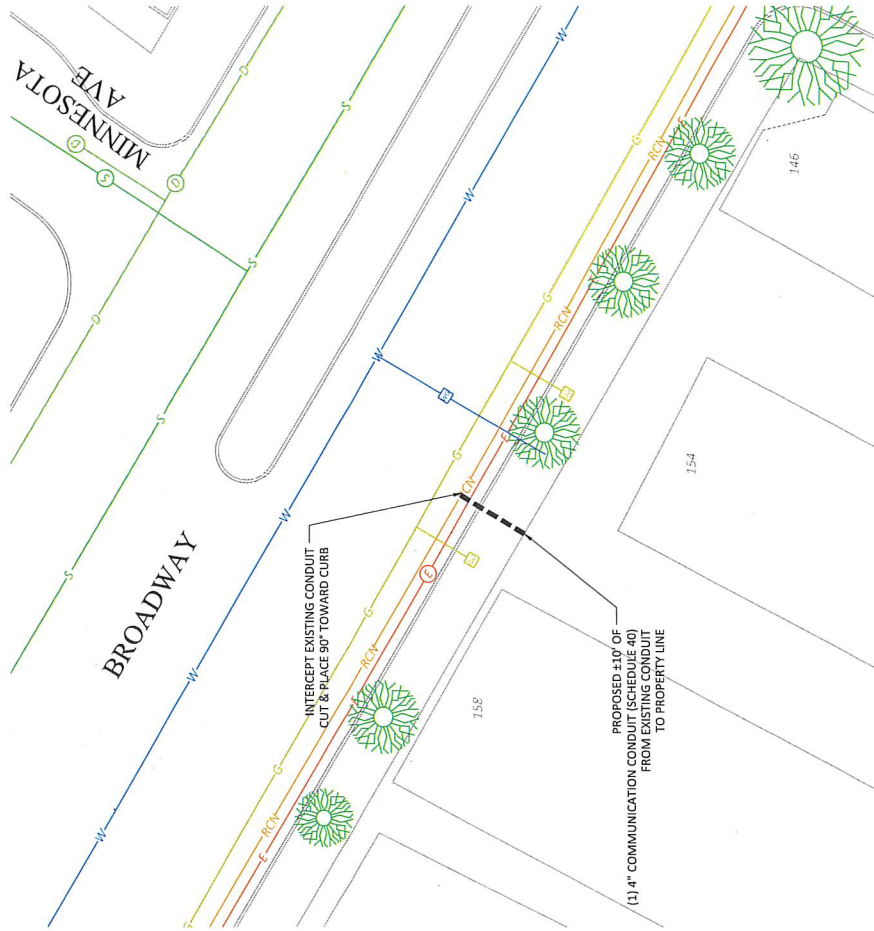

TRAFFIC CONTROL LEGEND

1	TRAFFIC CONTROL	1/2"	MINIMUM
2	TRAFFIC CONTROL	1/2"	MINIMUM

LEGEND

X	ELECTRIC POLE	A	STREET LIGHT
1	JOINT UTILITY POLE	B	ILLUMINATION
2	TRAFFIC LIGHT	C	LANE W/
3	TRAFFIC LIGHT	D	CONCRETE
4	TRAFFIC LIGHT	E	CONCRETE
5	TRAFFIC LIGHT	F	CONCRETE
6	TRAFFIC LIGHT	G	CONCRETE
7	TRAFFIC LIGHT	H	CONCRETE
8	TRAFFIC LIGHT	I	CONCRETE
9	TRAFFIC LIGHT	J	CONCRETE
10	TRAFFIC LIGHT	K	CONCRETE
11	TRAFFIC LIGHT	L	CONCRETE
12	TRAFFIC LIGHT	M	CONCRETE
13	TRAFFIC LIGHT	N	CONCRETE
14	TRAFFIC LIGHT	O	CONCRETE
15	TRAFFIC LIGHT	P	CONCRETE
16	TRAFFIC LIGHT	Q	CONCRETE
17	TRAFFIC LIGHT	R	CONCRETE
18	TRAFFIC LIGHT	S	CONCRETE
19	TRAFFIC LIGHT	T	CONCRETE
20	TRAFFIC LIGHT	U	CONCRETE
21	TRAFFIC LIGHT	V	CONCRETE
22	TRAFFIC LIGHT	W	CONCRETE
23	TRAFFIC LIGHT	X	CONCRETE
24	TRAFFIC LIGHT	Y	CONCRETE
25	TRAFFIC LIGHT	Z	CONCRETE

NOTE:
EXISTING UTILITIES SHOWN ARE APPROXIMATE AND NOT GUARANTEED TO BE CORRECT. THE CONTRACTOR SHALL VERIFY THE LOCATION OF ALL PUBLIC AND PRIVATE UTILITIES PRIOR TO BEGINNING ANY EXCAVATION.

CALL BEFORE YOU DIG
UNDERGROUND SERVICE ALERT
1-800-4-A-SAFE
EXITS 1-800-4-A-SAFE

AXIS
ENGINEERING GROUP

RCN

PREPARED BY: _____ DATE: _____
PREPARED FOR: _____ DATE: _____

PROPOSED CONDUIT INSTALLATION
DATE: _____
SCALE: 1" = 10'

DRAWN BY: WE
CHECKED BY: MB
DATE: 10/20/24

PARAPHRASE: _____
SCALE: 1" = 10'
DATE: 10/20/24

RCG 160 BROADWAY LLC
17 IVALOO STREET SUITE 100
SOMERVILLE, MA 02143

XIA LEON
258 MINISTERIAL DR
CONCORD, MA 01742