



CITY OF SOMERVILLE
Commonwealth of Massachusetts
93 Highland Avenue
Somerville, MA 02143
(617) 625-6600

BUSINESS LICENSE APPLICATION - Grant of Location

File #: 24-008919
License #: BL24-000072
Address: 29 MYSTIC AVE
Licensee: Erica Hudson Siena Engineering Group
DBA Name: Cambridge Network Solutions

Business Ownership Type: Corporation
Legal Name of Entity: Cambridge Network Solutions
Owners/Officers: , , ,

License Information:

Grant of location issued to: CNS

Describe the reason for the work, and the intended beneficiaries: This work is to provide service to customers in the area.

Insert here the same detailed description of the work as appears in the attached Grant of Location

Order: The proposed conduit installation will begin by breaking out of existing Eversource electrical MH#22834 on Mystic Ave to the proposed 3'x3' CNS Handhole which will include one (1) 4-inch PVC schedule 40 conduit. The conduit will continue northeast to the proposed riser on the south west side of Utility Pole# 249/4 which will include one (1) 4-inch PVC schedule 40 conduit. A total of approximately 43 feet.

Approval Conditions:

Approved By:

Isabela Maia, Approved with Conditions

APPROVAL CONDITION IMM 240520: Any work requiring the use of the street and/or sidewalk will require a Street/Sidewalk Occupancy Permit from the Engineering Department. Apply via Citizen Serve before conduit installation.

APPROVAL CONDITION IMM 240520: Provide the City a copy of approved MWRA 8(m) Permit when submitting for Street Occupancy permit.

APPROVAL CONDITION IMM 240520: Mystic Ave is on the 5-year street moratorium list; trench patches are not permitted. Provide mill & overlay from curb to curb and 12 feet on each side of utility trench.

Malik Drayton, Approved with Conditions

APPROVAL CONDITION: MD20240506: Contractor shall take all necessary precautions to avoid damaging any tree or tree part with equipment.

APPROVAL CONDITION: MD20240506 All nearby street tree(s) shall be protected prior to and during all construction activities using TREE BOX or TREE WRAPS. . TREE BOX shall be constructed from 2 in. x 4 in. lumber creating a box around the border of the tree pit with 2 in. x 4 in. lumber standing straight up at the corners and wrapped with orange snow fence. Detail attached. . TREE WRAPS (TREE TRUNK WRAPPING PROTECTION LUMBER) shall consist of 2 in. x 4 in. and 8 ft. height lumber wired together in close spacing with zip ties or 16 gauge galvanized steel wire to form a protective enclosure around tree trunks. Use burlap to separate the wood from the bark if necessary to prevent wood from scraping or

bruising bark. Do not use staples or puncture the trunk in any way.

APPROVAL CONDITION: MD20240506: Contractor shall take all necessary precautions to avoid damaging any tree or tree part with equipment. APPROVAL CONDITION: MD20240506 All nearby street tree(s) shall be protected prior to and during all construction activities using TREE BOX or TREE WRAPS. . TREE BOX shall be constructed from 2 in. x 4 in. lumber creating a box around the border of the tree pit with 2 in. x 4 in. lumber standing straight up at the corners and wrapped with orange snow fence. Detail attached. . TREE WRAPS (TREE TRUNK WRAPPING PROTECTION LUMBER) shall consist of 2 in. x 4 in. and 8 ft. height lumber wired together in close spacing with zip ties or 16 gauge galvanized steel wire to form a protective enclosure around tree trunks. Use burlap to separate the wood from the bark if necessary to prevent wood from scraping or bruising bark. Do not use staples or puncture the trunk in any way. APPROVAL CONDITION: MD20240506: Any tree roots less than two (2) inches in diameter that cannot be avoided during construction shall be carefully and cleanly cut with a clean pair of pruning shears or loppers. Roots are to be cut back flush with the edge of the trench. If any tree roots greater than two (2) inches in diameter are encountered, stop work immediately and contact the City Urban Forester. Any and all pruning of roots greater than 2 inches in diameter must be completed under the supervision of the City Urban Forester.

Eric Weisman, Approved

Kimberly M. Wells, Approved



CITY OF SOMERVILLE, MASSACHUSETTS
CITY CLERK'S OFFICE

KATJANA BALLANTYNE
MAYOR

KIMBERLY M. WELLS
CITY CLERK

June 4, 2024

NOTICE OF PUBLIC HEARING

You are hereby notified that the Somerville City Council will hold a Public Hearing on the following Petition. You are receiving this Notice because the Petitioner has reported that you own property that abuts the work that is being proposed. You and other members of the public are invited to attend and be heard at this Hearing.

This meeting of the City Council will also be conducted via remote participation, online in a webinar hosted on the Zoom platform.

You have three ways to be heard at this meeting:

1. To attend and be heard, enter the link exactly as it appears below into your internet browser any time before the meeting. You will then be asked to register for the meeting. After registering, you will receive an email with instructions to join the webinar when it starts.
2. You may also testify in person in the City Council Chamber, City Hall, 2nd Floor, 93 Highland Avenue, Somerville, MA 02143
3. If you are unable to attend but wish to be heard, you may send written comments by US mail to the City Clerk at the address below, or by email to cityclerk@somervillema.gov. Your comments must arrive no later than 12 Noon on the day of the Hearing, in order to be sure they are conveyed to the Council.

PETITION: Cambridge Network Solutions seeks a Grant of Location to install 43 feet of conduit in Mystic Avenue from existing Eversource Manhole #22834 to a proposed Handhole. Then it will continue to Utility Pole #249/4 located near 29 Mystic Avenue.

PLACE: https://us02web.zoom.us/webinar/register/WN_v5ceoNj3Q7GOy2FbcqAtCQ or City Council Chambers, City Hall, 2nd Floor, 93 Highland Avenue, Somerville, MA 02143

TIME: Thursday, June 13, 2024, at 7:00 PM

PURPOSE: The work is necessary to provide service to the surrounding area.



CAMBRIDGE NETWORK SOLUTIONS

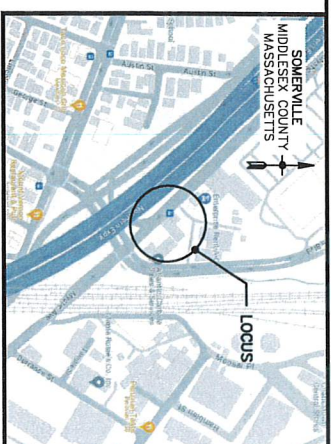

LOCUS MAP
NOT TO SCALE

PROPOSED CONDUIT PLACEMENT PLAN EVERSOURCE MH22834 AT 29 MYSTIC AVENUE SOMERVILLE, MASSACHUSETTS

SHEET INDEX

- TITLE SHEET
- 1. PROPOSED CONDUIT PLACEMENT PLAN
- 2. DETAIL SHEET
- 3. DETAIL SHEET
- 4. LEGEND & NOTES

<small>C:\Users\jkenne\AppData\Local\Temp\Veridata_10824\Xr-2023\Title.dwg 15:28:58 - 2:46pm by rstokey</small>	
Designed by	R. STOKER
Checked by	J. KENNEDY
Date	APRIL 15, 2024
TITLE SHEET	

PREPARED BY:

SIENA
200 WATER STREET, SUITE 200
 SOMERVILLE, MA 02143
 P: 781.221.4600 F: 781.221.7173

PREPARED FOR:

CNS
 CAMBRIDGE NETWORK SOLUTIONS

CITY OF SOMERVILLE
 ENGINEERING DIVISION
 GRANT OF LOCATION PLAN
 PROPOSED LATERAL CONDUIT PLACEMENT
 EVERSOURCE MH22834 AT 29 MYSTIC AVENUE

SHEET NUMBER:
CV

REGISTRY BOX

Brian C. Dorwart
 REGISTERED PROFESSIONAL ENGINEER
 State of Massachusetts
 License No. 22176, expires 12/31/24

SOMERVILLE
MIDDLESEX COUNTY
MASSACHUSETTS

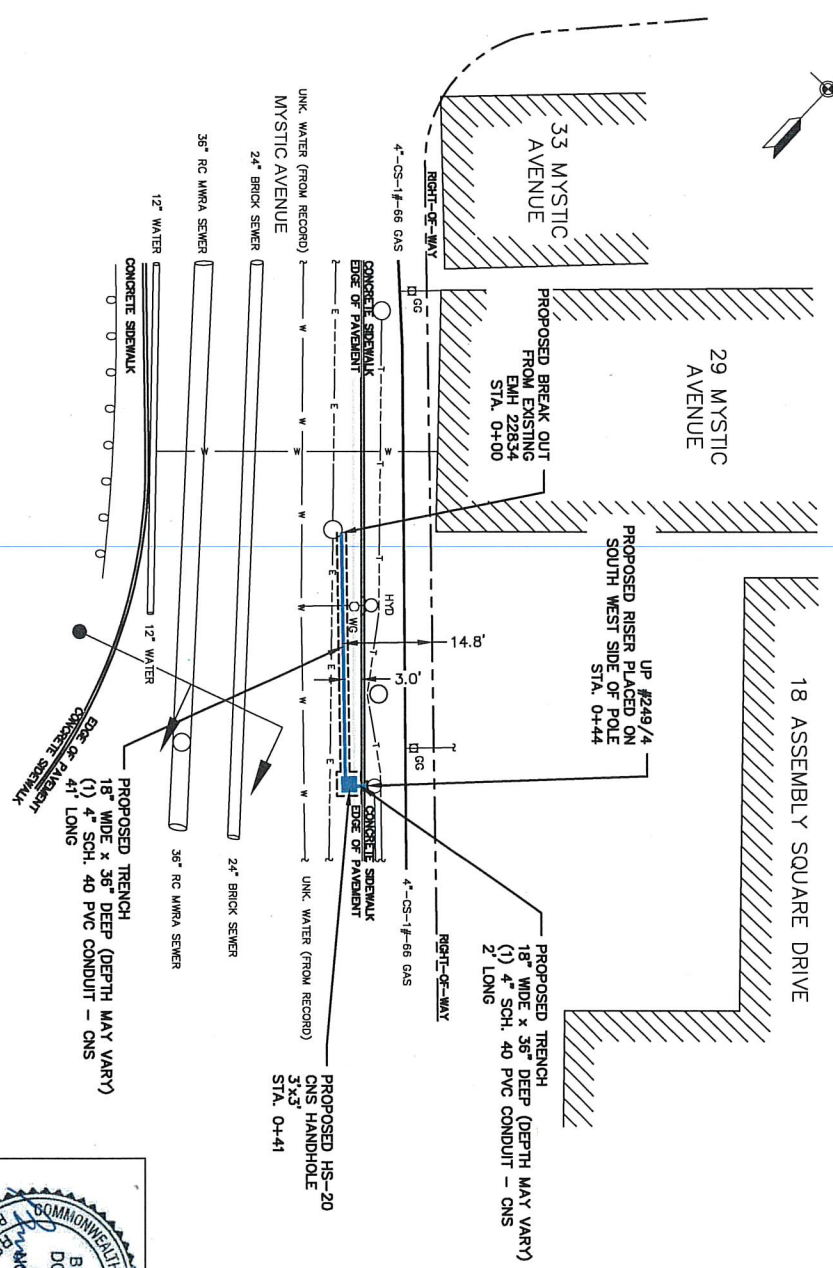

C:\Users\jstoker\AppData\Local\Temp\AutoCAD_10294\14-2023\Mydls_Am_Somerville.dwg App: 10/20/24 - 2:46pm by jstoker	
Designed by	Date
R. STOKER	APRIL 15, 2024
Checked by	
J. KENNEDY	
PROPOSED CONDUIT PLACEMENT PLAN	
Scale:	
1" = 20'	

PREPARED BY:

PREPARED FOR:

CITY OF SOMERVILLE	PUBLIC WORKS DEPARTMENT
ENGINEERING DIVISION	
GRANT OF LOCATION PLAN	
PROPOSED LATERAL CONDUIT PLACEMENT	
EVERSOURCE MH22834 AT 29 MYSTIC AVENUE	
SHEET NUMBER	
1	
OF 4 SHEETS	

REGISTRY BOX

NOTE:
 DEPTH SHALL VARY BASED UPON ENCOUNTERS WITH EXISTING UTILITIES.
 CONTRACTOR SHALL MAINTAIN A MINIMUM OF 24" DEPTH OF COVER.
 IF 24" MINIMUM DEPTH OF COVER CANNOT BE ACHIEVED, CONSULT W/
 ENGINEER.
 TRENCH WIDTH DIMENSIONS SHOWN FOR CLARITY, ACTUAL WIDTH WILL
 DEPEND ON FIELD CONDITIONS.

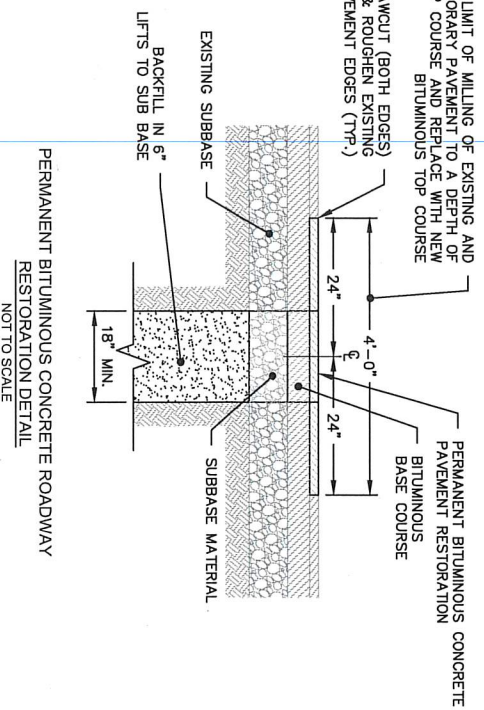
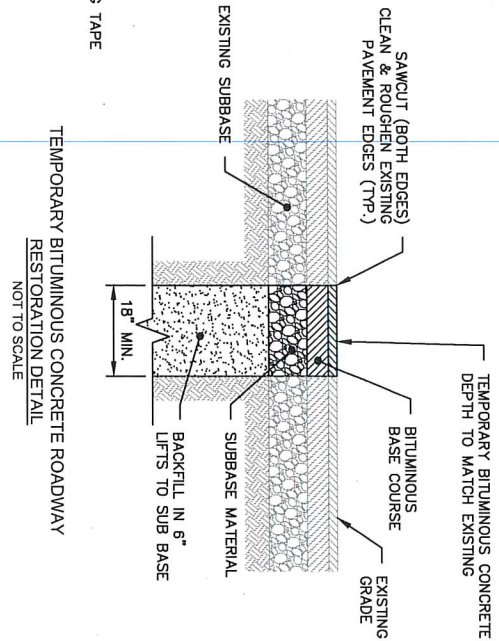
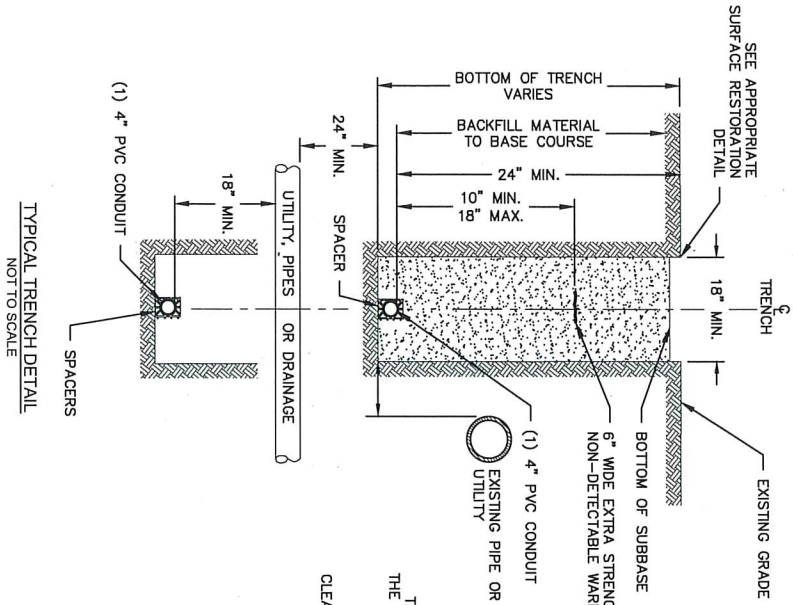

C:\Users\jstoker\AppData\Local\Temp\AutoCAD_16267134-2025\jstoker_1.mxd Job: 22834 - 29 Mystic Avenue Designed by: R. STOKER Checked by: J. KENNEDY Date: APRIL 15, 2024	Detail Sheet Scale: AS NOTED
--	---------------------------------



CITY OF SOMERVILLE
 ENGINEERING DIVISION
 GRANT OF LOCATION PLAN
 PROPOSED LATERAL CONDUIT PLACEMENT
 EVERSOURCE MH22834 AT 29 MYSTIC AVENUE

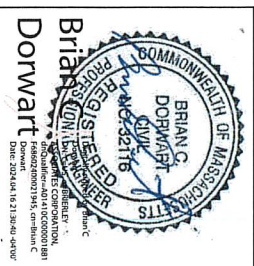

REGISTRY BOX

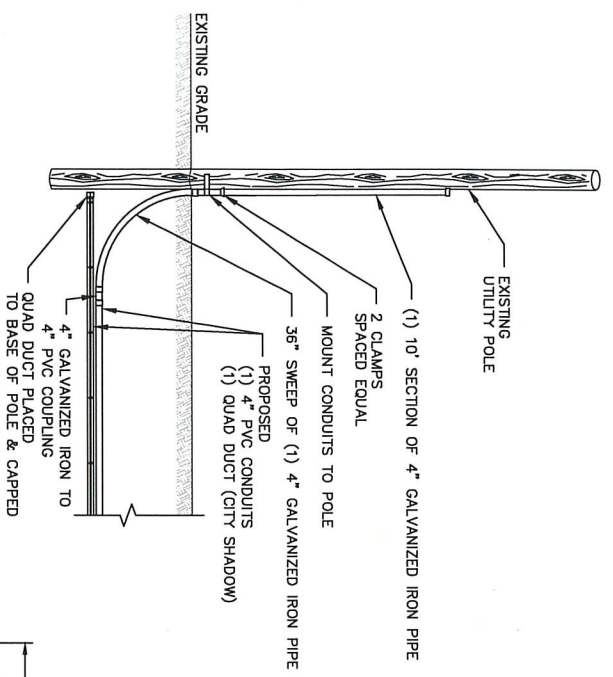

PROPOSED RISER DETAIL
NOT TO SCALE

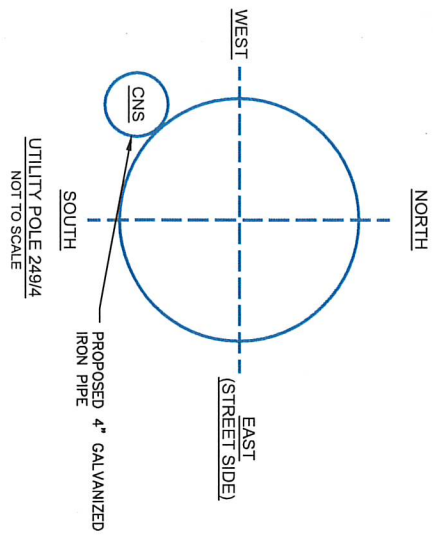

UTILITY POLE 249/4
NOT TO SCALE

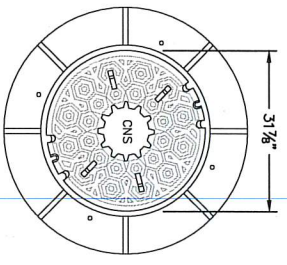

FRAME & STANDARD CAMBRIDGE NETWORK SOLUTIONS (CNS)
COVER ASSEMBLY DETAIL
NOT TO SCALE

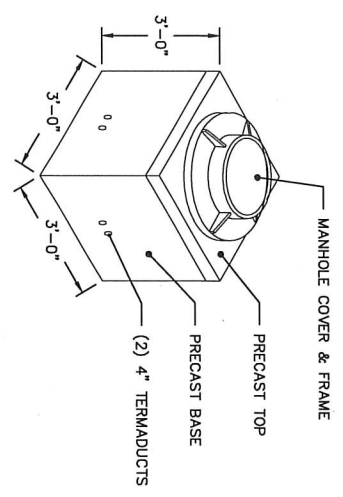

CONCRETE HS-20 RATED CAMBRIDGE NETWORK SOLUTIONS (CNS)
HANDHOLE DETAIL - 3'X3'X3'
NOT TO SCALE

- NOTES:
1. COVER COMPLIES WITH AASHTO HS-20 LOAD RATINGS FOR CEMENT IN ROADWAYS
 2. COVER SHALL CONFORM WITH THE LATEST REVISION OF CAMBRIDGE NETWORK SOLUTIONS (CNS) STANDARD SPECIFICATIONS FOR OUTSIDE PLANT CABLE CONSTRUCTION AND REMOVAL
 3. COVER AND FRAME PROPERLY ALIGNED AND FREE OF DIRT AND STONES WHEN JOINED.

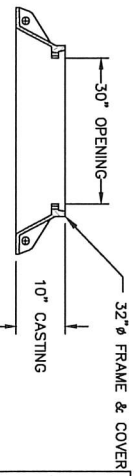

- NOTES:
1. HANDHOLES INSTALLED IN ACCORDANCE WITH THE LATEST REVISION OF CAMBRIDGE NETWORK SOLUTIONS (CNS) STANDARD SPECIFICATIONS FOR OUTSIDE PLANT CABLE CONSTRUCTION AND REMOVAL.
 2. CONCRETE COMPRESSIVE STRENGTH = 5,000 PSI. VAULT IS DESIGNED TO MEET ASTM C687 AND ACI 318 WITH AASHTO HS-20 LOADING
 3. CONSTRUCTION JOINT SEALED WITH 1" DIA. BUTYL RUBBER OR ENGINEER APPROVED EQUAL.
 4. MANHOLE RACKING CONFORMS WITH CAMBRIDGE NETWORK SOLUTIONS (CNS) SPECIFICATIONS.
 5. MANHOLE MANUFACTURED BY OLDCASTLE PRECAST, UTILITY MANHOLE MH3X3X30B

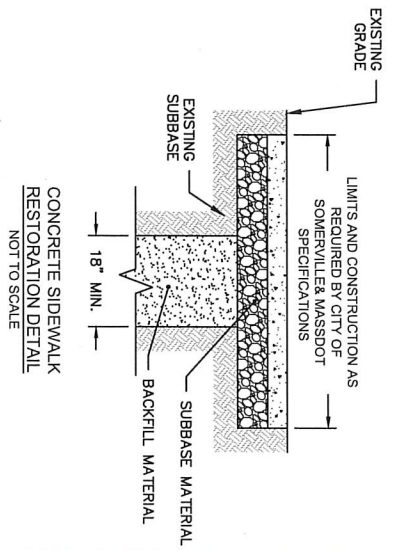

CONCRETE SIDEWALK RESTORATION DETAIL
NOT TO SCALE

<p>City of Somerville 100 Water Street Somerville, MA 02144 Tel: 617.624.3100 Fax: 617.624.3101</p>	<p>Designed by R. STOKER</p>	<p>Checked by J. KENNEDY</p>	<p>Date APRIL 15, 2024</p>	<p>DETAIL SHEET</p>
<p>Scale: AS NOTED</p>				



<p>CITY OF SOMERVILLE ENGINEERING DIVISION GRANT OF LOCATION PLAN PROPOSED LATERAL CONDUIT PLACEMENT EVERSOURCE MH22834 AT 29 MYSTIC AVENUE</p>	<p>PUBLIC WORKS DEPARTMENT</p>	<p>SHEET NUMBER 3 OF 4 SHEETS</p>
---	--------------------------------	--



REGISTRY BOX

SYMBOLS

	PROPOSED MANHOLE		PS	PEDESTRIAN SIGNAL
	PROPOSED HANDHOLE		SMH	SEWER MANHOLE
	SOMERVILLE WATER WORKS HANDHOLE		SLMH	STREAM MANHOLE
	CATCH BASIN		SLMH	STREET LIGHT MANHOLE
	DEPTH OF CABLE NOTE		TS	SIGN
	DRAIN MANHOLE		TMH	TELEPHONE MANHOLE
	ELECTRIC MANHOLE		TELHH	TELEPHONE HANDHOLE
	ELECTRIC HANDHOLE		THH	TRAFFIC HANDHOLE
	FIRE ALARM PULL BOX		TSCC	TRAFFIC MAST ARM
	GAS MANHOLE		TS	TRAFFIC SIGNAL CONTROL CABINET
	GAS METER		UP	TRAFFIC SIGNAL
	GAS GATE		WG	TREE
	GUARD POST (BOLLARD)		WM	UTILITY POLE
	HPFS MH			WATER GATE
	HYDRANT			WATER METER
	LIGHT POLE			
	PARKING METER			

LINETYPES - SIZE UNKNOWN

	PROPOSED CONDUIT
	PIPE TYPE CABLE (HIGH VOLTAGE ELEC)
	COMBINED SEWER LINE
	CURBING (TYPE)
	CABLE TELEVISION LINE
	DRAIN LINE
	ELECTRIC LINE
	FENCE (TYPE)
	GAS LINE
	OVERHEAD WIRES
	PROPERTY LINE
	SEWER LINE
	STEAM LINE
	TELEPHONE LINE
	TRAFFIC SIGNAL WIRES
	WATER LINE

ABBREVIATIONS

(ABAN)	ABANDONED
B/P	BEANPOLE
BIT CONC	BITUMINOUS CONCRETE
CP	CAST IRON PIPE
CLF	CHAIN LINK FENCE
CONC	CONCRETE
ELEC	ELECTRIC
FND	FOUND
GRAN	GRANITE
HCAP	HANDICAP
LST	LANDSCAPE TIMBER
N/F	NOW OR FORMERLY
PK	PK NAIL
PVC	POLYVINYL CHLORIDE
(R)	RECORD
SW	SIDEWALK
STK/TK	STAKE/TAACK
SB/DH	STONE BOUND/DRILL HOLE
W/	WITH

NOTES

- SUBSURFACE UTILITY LINES, AS SHOWN HEREON, WERE COMPILED ACCORDING TO AVAILABLE RECORD INFORMATION FROM THE REFERENCED COMPANIES AND PUBLIC UTILITIES. THE INFORMATION FROM THE REFERENCED COMPANIES AND PUBLIC UTILITIES MUST BE DETERMINED IN THE FIELD BY A PROFESSIONAL ENGINEER ASSUMES NO RESPONSIBILITY FOR DAMAGES INCURRED AS A RESULT OF UTILITIES OMITTED OR INACCURATELY SHOWN.
- PROPERTY OWNERS AND PARCEL IDENTIFIERS ARE ACCORDING TO THE CITY OF SOMERVILLE ASSESSORS ON-LINE PARCEL DATA, WWW.SOMERVILLEMA.GOV
- ALL WORK SHALL CONFORM TO CITY OF SOMERVILLE SPECIFICATIONS, AS WELL AS CONSTRUCTION DETAILS, INCLUDING MATERIALS AND CONSTRUCTION METHODS.

REFERENCES

- WATER INFORMATION PER DPW WATER AND SEWER PLANS, SCALE 1"=100'.
- SEWER INFORMATION PER MWRA WATER AND SEWER PLANS, SCALE 1"=100'.
- ELECTRIC INFORMATION PER EVERSOURCE ENERGY RECORD UTILITY PLANS.
- GAS INFORMATION PER NATIONAL GRID RECORD UTILITY PLAN.
- TELECOM INFORMATION PER RECORD PLANS RECEIVED FROM VERIZON, COMCAST, AT&T & TCS.

REGISTRY BOX



CITY OF SOMERVILLE
 PUBLIC WORKS DEPARTMENT
 ENGINEERING DIVISION
 GRANT OF LOCATION PLAN
 PROPOSED LATERAL CONDUIT PLACEMENT
 EVERSOURCE MH22834 AT 29 MYSTIC AVENUE

Designed by	Checked by	Date	LEGEND & NOTES
R. STOKER	J. KENNEDY	APRIL 15, 2024	



CITY OF SOMERVILLE	PUBLIC WORKS DEPARTMENT	SHEET NUMBER
ENGINEERING DIVISION	GRANT OF LOCATION PLAN	4
PROPOSED LATERAL CONDUIT PLACEMENT	EVERSOURCE MH22834 AT 29 MYSTIC AVENUE	OF 4 SHEETS

ECO LLC
20 ASSEMBLY SQ DR
SOMERVILLE, MA 02145 USA

MMCDM 29 MYSTIC LLC
7 DRIFTWOOD LN
LYNNFIELD, MA 01940 USA

STELLA MOON LLC
15 PAUL GORE STREET
JAMAICA PLAIN, MA 02130