



CITY OF SOMERVILLE

Commonwealth of Massachusetts
93 Highland Avenue
Somerville, MA 02143
(617) 625-6600

BUSINESS LICENSE APPLICATION - Grant of Location

File #: 22-013350

License #: BL22-000082

Address: 69 WEBSTER AVE

Licensee: Hannah Cooper NSTAR Electric Company dba Eversource Energy

DBA Name: NSTAR dba Eversource Energy

Business Ownership Type: Corporation

Legal Name of Entity: NSTAR dba Eversource Energy

Owners/Officers: , , ,

License Information:

Grant of location issued to: NSTAR dba Eversource Energy

Describe the reason for the work, and the intended beneficiaries: This work is necessary to support the Boynton Gateway project.

Insert here the same detailed description of the work as appears in the attached Grant of Location Order: Webster Avenue - Northerly from pole 326/4, approximately 180 feet south of Columbia Street, to manhole MH4118 approximately 30 feet north of Columbia Street, install approximately 256 feet of conduit and one new manhole, MH31615. Webster Avenue - Northerly from pole 362/5A, approximately 40 feet south of Tremont Street, to manhole MH13078 at the intersection of Tremont Street and Webster Avenue, install approximately 55 feet of conduit. WO#8937405

Approval Conditions:

Approved By:

Isabela Maia, Approved with Conditions

APPROVAL CONDITION IMM 2022-08-16: Provide 12' wide permanent patch centered on their trench to be installed following the calendar year after completion (Street Occupancy Permit).

APPROVAL CONDITION IMM 2022-08-16: Provide the city a of copy approved MWRA 8(m) Permit when submitting for Street Occupancy Permit.

Malik Drayton, Approved with Conditions

APPROVAL CONDITION: MD20220802: Contractor shall take all necessary precautions to avoid damaging any tree or tree part with equipment.

APPROVAL CONDITION: MD20220802: All nearby street tree(s) shall be protected prior to and during all construction activities using TREE BOX or TREE WRAPS. . TREE BOX shall be constructed from 2 in. x 4 in. lumber creating a box around the border of the tree pit with 2 in. x 4 in. lumber standing straight up at the corners and wrapped with orange snow fence. Detail attached. . TREE WRAPS (TREE TRUNK WRAPPING PROTECTION LUMBER) shall consist of 2 in. x 4 in. and 8 ft. height lumber wired together in close spacing with zip ties or 16 gauge galvanized steel wire to form a protective enclosure around tree trunks. Use burlap

to separate the wood from the bark if necessary to prevent wood from scraping or bruising bark. Do not use staples or puncture the trunk in any way.

APPROVAL CONDITION: MD20220802: Any tree roots less than two (2) inches in diameter that cannot be avoided during construction shall be carefully and cleanly cut with a clean pair of pruning shears or loppers. Roots are to be cut back flush with the edge of the trench. If any tree roots greater than two (2) inches in diameter are encountered, stop work immediately and contact the City Urban Forester. Any and all pruning of roots greater than 2 inches in diameter must be completed under the supervision of the City Urban Forester.

Eric Weisman, Approved

Kimberly M. Wells, Approved



CITY OF SOMERVILLE, MASSACHUSETTS
CITY CLERK'S OFFICE
KATJANA BALLANTYNE
MAYOR

KIMBERLY M. WELLS
CITY CLERK

August 30, 2022

NOTICE OF PUBLIC HEARING

You are hereby notified that the Somerville City Council will hold a Public Hearing on the following Petition. You are receiving this Notice because the Petitioner has reported that you own property that abuts the work that is being proposed. You and other members of the public are invited to attend and be heard at this Hearing.

This meeting of the City Council will also be conducted via remote participation, online in a webinar hosted on the GoToWebinar platform.

You have three ways to be heard at this meeting:

1. To attend and be heard, enter the link exactly as it appears below into your internet browser any time before the meeting. You will then be asked to register for the meeting. After registering, you will receive an email with instructions to join the webinar when it starts.
2. You may also testify in person in the City Council Chamber, City Hall, 2nd Floor, 93 Highland Avenue, Somerville, MA 02143
3. If you are unable to attend but wish to be heard, you may send written comments by US mail to the City Clerk at the address below, or by email to cityclerk@somervillema.gov. Your comments must arrive no later than 12 Noon on the day of the Hearing, in order to be sure they are conveyed to the Council.

PETITION: Eversource (NStar Electric) is applying for a Grant of Location to install a total of 311 feet of conduit in Webster Avenue as follows: Starting from Utility Pole 362/4 to new Manhole 31615, then continuing to Manhole 4118 located at the intersection of Webster Avenue and Columbia Street. Installation will also include conduit that will connect Utility Pole 362/5A to Manhole 13078 located at the intersection of Webster Avenue and Tremont Street.

PLACE: <https://attendee.gotowebinar.com/register/5367760117147071243> or
City Council Chambers, City Hall, 2nd Floor, 93 Highland Avenue, Somerville, MA 02143

TIME: Thursday, September 8, 2022, at 7:00 PM.

PURPOSE: The work is necessary to provide service to Boynton Gateway project.

W.O. 8937405

EVERSOURCE
101 Linwood Street
Somerville, MA 02143

July 29th, 2022

Ms. Kimberly Wells
Office of the City Clerk
93 Highland Avenue
Somerville, MA 02143

RE: Webster Avenue
W.O. #8937405

Dear Members of the Board,

The NSTAR Electric Company d/b/a Eversource Energy respectfully requests a Grant of Location for the installation of approximately 311 feet of conduit and one new manhole in Webster Avenue.

This work is necessary to support the Boynton Gateway project.

If you have any questions or concerns, please call Jacqueline Duffy at 617-629-3204.

Very truly yours,

Kelly-Ann Correia

Kelly-Ann Correia
Supervisor, Rights and Permits

FIG	DIMENSIONS			
	4" Ducts	6" Ducts	8" Ducts	10" Ducts
1A	10"	11"	12"	12"
1	10"	10"	11"	12"
2	10"	10"	11"	12"
3	10"	10"	11"	12"
4	10"	10"	11"	12"
5	10"	10"	11"	12"
6	10"	10"	11"	12"
7	10"	10"	11"	12"
8	10"	10"	11"	12"
9	10"	10"	11"	12"
10	10"	10"	11"	12"
11	10"	10"	11"	12"
12	10"	10"	11"	12"
13	10"	10"	11"	12"
14	10"	10"	11"	12"
15	10"	10"	11"	12"
16	10"	10"	11"	12"

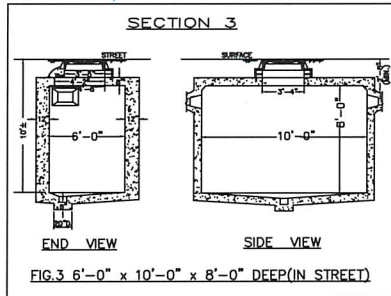
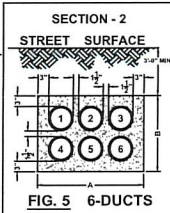
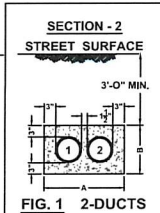
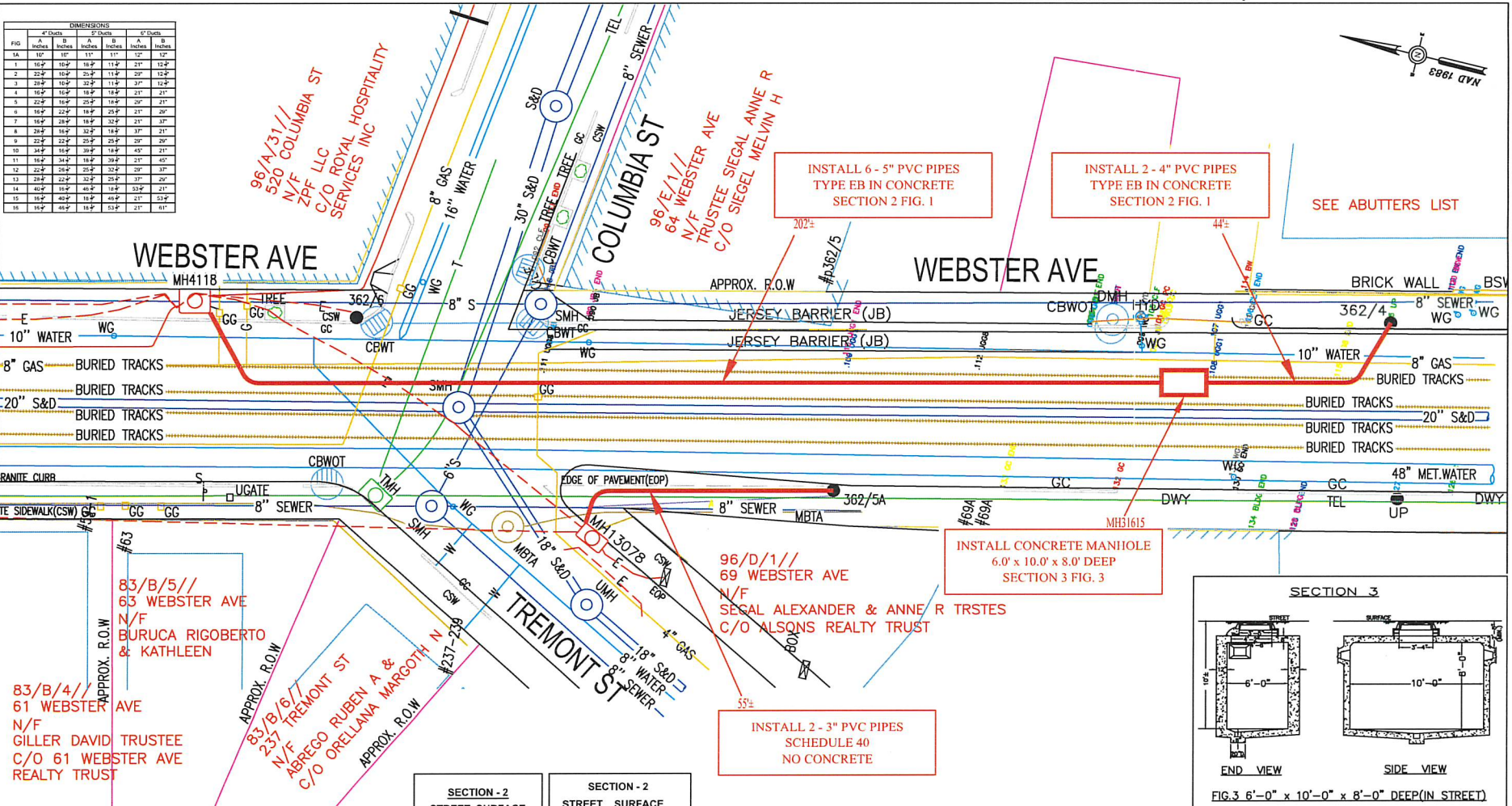
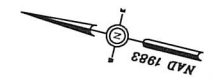

BY YOUR USE OF THE INFORMATION CONTAINED IN THIS MAP, YOU AGREE THAT NO WARRANTY OF ANY KIND, EXPRESS OR IMPLIED, IS GIVEN WITH RESPECT TO THE INFORMATION. NEITHER NSTAR ELECTRIC COMPANY, NEITHER ITS EMPLOYEES NOR ITS AGENTS, REPRESENTATIVES, OFFICERS, EMPLOYEES, SUBCONTRACTORS, EMPLOYEES OF AGENTS (COLLECTIVELY THE "NSTAR ENTITIES") SHALL BE LIABLE FOR ANY LOSS OF INJURY CAUSED IN WHOLE OR IN PART BY USE OF THIS INFORMATION. TO THE MAXIMUM EXTENT ALLOWED BY LAW, YOU AGREE TO HOLD THE NSTAR ENTITIES HARMLESS FROM ANY SUCH LOSS OR INJURY.

THIS INFORMATION MAY NOT REPRESENT A SURVEY, MAY NOT BE THE MOST COMPLETE AND IS SUBJECT TO CHANGE WITHOUT NOTICE. NO LIABILITY IS ASSUMED FOR THE ACCURACY OF THE INFORMATION, OTHER THAN THAT EXPRESSED OR IMPLIED. UNAUTHORIZED ATTEMPTS TO MODIFY THE INFORMATION OR USE THE INFORMATION FOR OTHER THAN ITS INTENDED PURPOSES ARE PROHIBITED.

MASS. LAW
REQUIRES 72 HOURS ADVANCE NOTICE TO UTILITY COMPANIES BEFORE DIGGING BY ANYONE. CALL DIG-SAFE 1-888-344-7233

C# 186-22	NSTAR EVERSOURCE d/b/a 1183 MASSACHUSETTS AVE. DORCHESTER, MASS. 02125
Ward #	
Work Order # 8337405	Plan of WEBSTER AVE. AT COLUMBIA ST, SOMERVILLE
Surveyed by: BP/GC	Showing PROPOSED CONDUIT LOCATION
Research by: JC	Proposed Structures: TL
Plotted by: TL	Approved: T THIBAUT
Scale 1"=20'	Date JULY 19, 2022
PH	SHEET 1 of 1

Abutting Properties for
69 WEBSTER AVE SOMERVILLE, MA
96/ D/ 1/ /
(100 Feet)

Location:
83/ B/ 6/ /
237 TREMONT ST
Owner:
ABREGO RUBEN A &
S/O RUBEN A ABREGO
237 TREMONT ST
SOMERVILLE, MA 02143

Location:
96/ D/ 2/ /
73 WEBSTER AVE
Owner:
WEBSTER AVENUE REALTY LLC
40 CLEVELAND RD
CHESTNUT HILL, MA 02467

Location:
83/ B/ 5/ /
63 WEBSTER AVE
Owner:
BURUCA RIGOBERTO & KATHLEEN
29 HOUGHTON ST
SOMERVILLE, MA 02143

Location:
96/ F/ 1/ 1C/
80 WEBSTER AVE #1C
Owner:
MILLER JACQUELYN
222 VALLEY ST #4
SAN FRANCISCO, CA 94131

Location:
96/ F/ 1/ 1F/
80 WEBSTER AVE #1F
Owner:
CHANEY ANN T
80 WEBSTER AVE #1F
SOMERVILLE, MA 02143

Location:
96/ F/ 1/ 1J/
80 WEBSTER AVE #1J
Owner:
GREENSPAN DANIEL E TRUSTEE
DANIEL E GREENSPAN REVOCABLE
TRUST 2017
292 MORGAN ROAD
RICHMOND, NH 03470

Location:
96/ F/ 1/ 2A/
80 WEBSTER AVE #2A
Owner:
JONASSON JONAS ODDUR
80 WEBSTER AVE 2A
SOMERVILLE, MA 02143

Location:
96/ F/ 1/ 2D/
80 WEBSTER AVE #2D
Owner:
QUEK BAO LIN
80 WEBSTER AVE #2D
SOMERVILLE, MA 02143

Location:
96/ F/ 1/ 2G/
80 WEBSTER AVE #2G
Owner:
MORGAN CARRIE M
80 WEBSTER AVE #2G
SOMERVILLE, MA 02143

Location:
96/ A/ 31/ /
520 COLUMBIA ST
Owner:
ZPF LLC
C/O ROYAL HOSPITALITY SERVICES INC
520 COLUMBIA ST ATT;D.NOBLE
SOMERVILLE, MA 02143

Location:
96/ E/ 1/ /
64 WEBSTER AVE
Owner:
BOYNTON GATEWAY OWNER,LLC
C/O COLUMBIA PROPERTY TRUST
315 PARK AVENUE SOUTH
NEW YORK, NY 10010

Location:
83/ B/ 7/ /
233 TREMONT ST
Owner:
REILLY JOHN F & LIESE
3 ASHWOOD RD
ACTON, MA 01720

Location:
96/ F/ 1/ 1D/
80 WEBSTER AVE #1D
Owner:
KUBICKI ELIZABETH
80 WEBSTER AVE #1D
SOMERVILLE, MA 02143

Location:
96/ F/ 1/ 1G/
80 WEBSTER AVE #1G
Owner:
PARK KIM Y
80 WEBSTER AVE #1G
SOMERVILLE, MA 02143

Location:
96/ F/ 1/ 1K/
80 WEBSTER AVE #1K
Owner:
SCHAEFER IAN & BETH TRUSTEES
SCHAEFER FAMILY REVOCABLE TRUST
26 CHARLES ST
MELROSE, MA 02176

Location:
96/ F/ 1/ 2B/
80 WEBSTER AVE #2B
Owner:
MALIK HASSAN
80 WEBSTER AVE #2B
SOMERVILLE, MA 02143

Location:
96/ F/ 1/ 2E/
80 WEBSTER AVE #2E
Owner:
SHOY ROSLYN
80 WEBSTER AVE 2E
SOMERVILLE, MA 02143

Location:
96/ F/ 1/ 2H/
80 WEBSTER AVE #2H
Owner:
WOOD SETH
80 WEBSTER AVE UNIT 2H
SOMERVILLE, MA 02143

Location:
96/ D/ 1/ /
69 WEBSTER AVE
Owner:
SEGAL ALEXANDER & ANNE R
TRSTES
ALSONS REALTY TRUST
69 WEBSTER AVE
SOMERVILLE, MA 02143

Location:
96/ E/ 4/ /
68 WEBSTER AVE
Owner:
BOYNTON GATEWAY OWNER, LLC
C/O COLUMBIA PROPERTY TRUST
315 PARK AVENUE SOUTH
NEW YORK, NY 10010

Location:
96/ F/ 1/ 1A/
80 WEBSTER AVE #1A
Owner:
APOSHIAN ANNA WAYNE
80 WEBSTER AVE UNIT 1A
SOMERVILLE, MA 02143

Location:
96/ F/ 1/ 1E/
80 WEBSTER AVE #1E
Owner:
COOLBAUGH RYAN S
80 WEBSTER AVE UNIT 1E
SOMERVILLE, MA 02143

Location:
96/ F/ 1/ 1H/
80 WEBSTER AVE #1H
Owner:
ROBAINA CLAUDIA
80 WEBSTER AVE 1H
SOMERVILLE, MA 02143

Location:
96/ F/ 1/ 1L/
80 WEBSTER AVE #1L
Owner:
RANJIT AMIRA & RANJEET VISHNU
80 WEBSTER AVE #1L
SOMERVILLE, MA 02143

Location:
96/ F/ 1/ 2C/
80 WEBSTER AVE #2C
Owner:
ARVIND AARATHI & SUBRAMANIAN
80 WEBSTER AVE 2C
SOMERVILLE, MA 02144

Location:
96/ F/ 1/ 2F/
80 WEBSTER AVE #2F
Owner:
DHILLA MURTUZA I
80 WEBSTER AVE #2F
SOMERVILLE, MA 02143

Location:
96/ F/ 1/ 2J/
80 WEBSTER AVE #2J
Owner:
ZEISER SARAH ELIZABETH
80 WEBSTER AVE UNIT 2J
SOMERVILLE, MA 02143

Location:
96/ F/ 1/ 2K/
80 WEBSTER AVE #2K
Owner:
KARIMI MARYAM
80 WEBSTER AVE #2K
SOMERVILLE, MA 02143

Location:
96/ F/ 1/ 3A/
80 WEBSTER AVE #3A
Owner:
LEVY ROGER P
80 WEBSTER AVE 3A
SOMERVILLE, MA 02143

Location:
96/ F/ 1/ 3D/
80 WEBSTER AVE #3D
Owner:
FAST NORMAN TRUSTEE
NORMAN FAST TRUST 2002
62 CHESTER ST
NEWTON, MA 02458

Location:
96/ F/ 1/ 3G/
80 WEBSTER AVE #3G
Owner:
SCHOLTE ANDREW A
SCHOLTE SARAH CLARK
24 BELMONT ST UNIT 24
SOMERVILLE, MA 02143

Location:
96/ F/ 1/ 3K/
80 WEBSTER AVE #3K
Owner:
CHEN MARK
80 WEBSTER AVE 3K
SOMERVILLE, MA 02143

Location:
96/ F/ 1/ 4A/
80 WEBSTER AVE #4A
Owner:
NG CHRISTOPHER W & NG JOHN N
80 WEBSTER AVE #4A
SOMERVILLE, MA 02143

Location:
96/ F/ 1/ 4D/
80 WEBSTER AVE #4D
Owner:
HUSSAIN AJAZ & NAAZ
6615 HUNTER TRAIL WAY
FREDRICK MD, MD 21702

Location:
96/ F/ 1/ 4G/
80 WEBSTER AVE #4G
Owner:
WU JOYCE
80 WEBSTER AVE #4G
SOMERVILLE, MA 02143

Location:
96/ F/ 1/ 4K/
80 WEBSTER AVE #4K
Owner:
SAWARD NEIL J & FENTON ANNY T
80 WEBSTER AVE 4K
SOMERVILLE, MA 02143

Location:
96/ F/ 1/ 2L/
80 WEBSTER AVE #2L
Owner:
KATZ ELANA
S/O KATHERIN E WADE
80 WEBSTER AVE UNIT 2L
SOMERVILLE, MA 02143

Location:
96/ F/ 1/ 3B/
80 WEBSTER AVE #3B
Owner:
CIULLA BRIAN J
80 WEBSTER AVE UNIT 3B
SOMERVILLE, MA 02143

Location:
96/ F/ 1/ 3E/
80 WEBSTER AVE #3E
Owner:
MCGRAW COLLEEN A
80 WEBSTER AVE #3E
SOMERVILLE, MA 02143

Location:
96/ F/ 1/ 3H/
80 WEBSTER AVE #3H
Owner:
ZHOU MIN & XINLIANG XU
80 WEBSTER AVE #3H
SOMERVILLE, MA 02143

Location:
96/ F/ 1/ 3L/
80 WEBSTER AVE #3L
Owner:
KRUSKAL DEBORAH W & THOMAS E
TRUSTEES
136 LINCOLN RD
SUDBURY, MA 01776

Location:
96/ F/ 1/ 4B/
80 WEBSTER AVE #4B
Owner:
FISCHER REBECCA A
80 WEBSTER AVE 4B
SOMERVILLE, MA 02143

Location:
96/ F/ 1/ 4E/
80 WEBSTER AVE #4E
Owner:
SINGH ANITA & THAPA ANUL
S/O TIMOTHY JASON BUGBEE
80 WEBSTER AVE UNIT 4E
SOMERVILLE, MA 02143

Location:
96/ F/ 1/ 4H/
80 WEBSTER AVE #4H
Owner:
SIEBRECHT HOLGER
19 GORHAM ST #2
SOMERVILLE, MA 02144

Location:
96/ F/ 1/ 4L/
80 WEBSTER AVE #4L
Owner:
SANCHEZ SUSANA SALDANA & LORANT
RICHARD
S/O KATHERINE HUANG & ERIC ALM
80 WEBSTER AVE #4L
SOMERVILLE, MA 02143

Location:
96/ F/ 1/ 2M/
80 WEBSTER AVE #2M
Owner:
WADHWA AMITA
80 WEBSTER AVE #2M
SOMERVILLE, MA 02143

Location:
96/ F/ 1/ 3C/
80 WEBSTER AVE #3C
Owner:
CHALKIAS SPYRIDON
80 WEBSTER AVE 3C
SOMERVILLE, MA 02143

Location:
96/ F/ 1/ 3F/
80 WEBSTER AVE #3F
Owner:
GERRITSEN JACQUELINE S
74 RAND STREET
REVERE, MA 02151

Location:
96/ F/ 1/ 3J/
80 WEBSTER AVE #3J
Owner:
SPEANBURG KATIE
1004 VALLEY FALLS RD
SCHAGHTICOKE, NY 12154

Location:
96/ F/ 1/ 3M/
80 WEBSTER AVE #3M
Owner:
CHUNG JENNY
80 WEBSTER AVE #3M
SOMERVILLE, MA 02143

Location:
96/ F/ 1/ 4C/
80 WEBSTER AVE #4C
Owner:
SCHREIBER ROBERT P, JANET C &
MICHAEL R
80 WEBSTER AVE 4C
SOMERVILLE, MA 02143

Location:
96/ F/ 1/ 4F/
80 WEBSTER AVE #4F
Owner:
VELJKOVIC JELENA
22 COPLEY ST
CAMBRIDGE, MA 02138

Location:
96/ F/ 1/ 4J/
80 WEBSTER AVE #4J
Owner:
LIU CHRISTINE M
80 WEBSTER AVE #4J
SOMERVILLE, MA 02143

Location:
96/ F/ 1/ 4M/
80 WEBSTER AVE #4M
Owner:
PAIVA BLAKE & MEGHAN
25 VINEWOOD ROAD
MILTON, MA 02186