



CITY OF SOMERVILLE
Commonwealth of Massachusetts
93 Highland Avenue
Somerville, MA 02143
(617) 625-6600

BUSINESS LICENSE APPLICATION - Grant of Location

File #: 19-009455

License #: BL19-000052

Address: 1299 Broadway

Licensee: Bill Conway Axis Engineering Group

DBA Name: RCN TELECOM SERVICES OF MASSACHUSETTS, LLC

Business Ownership Type: Corporation

Legal Name of Entity: RCN TELECOM SERVICES OF MASSACHUSETTS, LLC

Owners/Officers: JIM HOLANDA, , ,

License Information:

Grant of location issued to: RCN TELECOM SERVICES OF MASSACHUSETTS, LLC

Describe the reason for the work, and the intended beneficiaries: INSTALL CONDUIT FROM ELECTRIC MH#3730 NORTHERLY ON BROADWAY TO EXISTING UTILITY POLE#190/15 ON NORTH ST AT BROADWAY

Insert here the same detailed description of the work as appears in the attached Grant of Location Order: 1299 BROADWAY AT NORTH STREET - STARTING AT EXISTING ELECTRIC MH#3730, TRENCH AND INSTALL 20'+/- OF (1) 4" COMMUNICATION CONDUIT NORTHERLY TO EXISTING UTILITY POLE#190/15.

Approval Conditions: None

Approved By:

John J. Long, Approved

Carlos Perez, Approved

John J. Long, Approved



CITY OF SOMERVILLE, MASSACHUSETTS
CITY CLERK'S OFFICE

JOSEPH A. CURTATONE
MAYOR

JOHN J. LONG
CITY CLERK

July 1, 2019

NOTICE

You are hereby notified that the Somerville City Council will hold a Public Hearing on the following Petition. You are receiving this Notice because the Petitioner has reported that you own property that abuts the work that is being proposed. You and other members of the public are invited to attend and be heard at this Hearing. If you are unable to attend, you may send written comments by US mail or by email to my attention, but they must arrive no later than 12 Noon on the day of the Hearing, in order to be sure they are conveyed to the Council.

PETITION: RCN for a Grant of Location to install 20 feet of conduit in North Street, connecting existing Manhole 3730 on Broadway with point of pickup at an existing Utility Pole 190/15 on North Street at Broadway.

PLACE: City Council Chamber, 2nd Floor, City Hall, 93 Highland Avenue, Somerville.

TIME: Thursday, July 11, 2019, at 7:00 PM.

PURPOSE: The work is necessary to provide service to 1299 Broadway.

John J. Long
City Clerk



CITY OF SOMERVILLE, MASSACHUSETTS

DEPARTMENT OF PUBLIC WORKS

JOSEPH A. CURTATONE
MAYOR

STAN KOTY
Commissioner

RICK WILLETTE
Director of Operations

June 25, 2019

The Honorable City Council
City Hall
93 Highland Avenue
Somerville MA, 02143

RE: Grant of Location
RCN
1299 Broadway

Dear Board Members:

Preliminary approval is recommended for the petition and plan of RCN to install approximately 20 feet of (1) 4-inch PVC communication conduit from an existing electric manhole #3730 on Broadway to an existing utility pole #190/15 on North Street. Broadway and North Street are public ways in Somerville, MA.

This recommendation is made with reference to RCN's Petition for Grant of Location for Wires, Cables, Poles, Piers, Abutments, Conduits or Fixtures dated May 21, 2019 and plan of May 21, 2019 upon stipulation that the Grant of Location is subject to: a reservation of rescission by the City Council; indemnification of the City for all liability arising from said Grant; all permit procedures, conditions and approvals of municipal utilities; protection of existing infrastructure; and complete surface repair, restoration and maintenance. A public hearing will be required.

This work is necessary to bring RCN's network to 1299 Broadway.

Respectfully requested,

Department of Public Works

Stan Koty, Commissioner

1 Franey Road Somerville, Massachusetts 02145

(617) 625-6600 Ext 5100 TTY (866) 808-4851 Fax (617) 623-7649

www.somervillema.gov

**ORDER FOR GRANT OF LOCATION FOR
WIRES, CABLES, POLES, PIERS, ABUTMENTS, CONDUITS OR FIXTURES**

**City of Somerville, Massachusetts
In Board of Aldermen**

WHEREAS, RCN TELECOM SERVICES OF MASSACHUSETTS, LLC (hereinafter known as the PETITIONER) has petitioned for permission to construct upon, along, under or across the public way(s), the following:

INSERT DESCRIPTION OF WORK HERE

1299 BROADWAY AT NORTH STREET - STARTING AT EXISTING ELECTRIC MH#3730, TRENCH AND INSTALL 20'+/- OF (1) 4" COMMUNICATION CONDUIT NORTHERLY TO EXISTING UTILITY POLE#190/15.

AND WHEREAS, notice has been given and a hearing held on said petition as provided by law; NOW THEREFORE BE IT

ORDERED that the PETITIONER be and hereby is granted permission by the Board of Aldermen to complete the construction described above, all in accordance with the following conditions:

1. PETITIONER shall locate and complete all work as shown by plan(s) dated 5/21/2019, and as may have been amended by the City.
2. PETITIONER shall comply with the requirements of existing ordinances and such as may hereafter be adopted governing the construction.
3. PETITIONER shall perform all work to the requirements and satisfaction of the Department of Public Works or other such officer(s) as may be hereafter appointed by the City.

Approved by the Board of Aldermen on the _____ day of _____, 20____,

A True Record. Attest: _____ Date: _____
City Clerk

Certificate

I hereby certify that the foregoing Order was adopted by the Board of Aldermen on the _____ day of _____, 20____, after due notice and public hearing as prescribed by Section 22 of Chapter 166 of the General Laws and any additions or amendments thereto, said public hearing held in said City on the _____ day of _____, 20____, and recorded with the records of Grant of Location Orders of said City, as _____.

Certified. Attest: _____ Date: _____
City Clerk



PROPOSED CONDUIT INSTALLATION
AT
1299 BROADWAY
SOMERVILLE, MA



LOCUS
N.T.S.

AXIS
ENGINEERING GROUP
201 Boston Post Rd Suite 100
Marlborough, MA 01752
(774) 556-2924 www.axisgroup.com

INDEX OF DRAWING

SHEET NO.	DESCRIPTION
01	COVER SHEET
02	PROPOSED CONDUIT INSTALLATION

MAY 21, 2019

GENERAL NOTES

1. THE LOCATIONS OF EXISTING UNDERGROUND UTILITIES ARE SHOWN IN AN APPROXIMATE MANNER ONLY AND HAVE NOT BEEN VERIFIED BY THE OWNER OR ITS REPRESENTATIVE. THE CONTRACTOR SHALL DETERMINE THE EXACT LOCATION OF ALL EXISTING UTILITIES BEFORE COMMENCING WORK AND SHALL BE FULLY RESPONSIBLE FOR ANY AND ALL DAMAGES WHICH MIGHT BE OCCASIONED BY THE CONTRACTOR'S FAILURE TO EXACTLY LOCATE AND PRESERVE ANY AND ALL UNDERGROUND UTILITIES.
2. WHERE AN EXISTING UTILITY IS FOUND TO CONFLICT WITH THE PROPOSED WORK, THE LOCATION, ELEVATION AND SIZE OF THE UTILITY SHALL BE ACCURATELY DETERMINED WITHOUT DELAY BY THE CONTRACTOR, AND THE INFORMATION FURNISHED TO THE ENGINEER FOR RESOLUTION OF THE CONFLICT.
3. THE CONTRACTOR SHOULD MAINTAIN A SEPARATION OF 18 INCHES MIN. WHEN CROSSING EXISTING WATER FACILITIES.
4. THE CONTRACTOR SHALL MAKE ALL ARRANGEMENTS FOR THE ALTERATION AND ADJUSTMENT OF GAS, ELECTRIC, TELEPHONE AND ANY OTHER PRIVATE UTILITIES BY THE UTILITY COMPANY.
5. THE CONTRACTOR SHALL NOT DISTURB PUBLIC TREES AND SHRUBS.
6. AREAS OUTSIDE THE LIMITS OF PROPOSED WORK DISTURBED BY THE CONTRACTOR'S OPERATIONS SHALL BE RESTORED BY THE CONTRACTOR TO THEIR ORIGINAL CONDITION AT NO EXPENSE TO THE OWNER.
7. THE CONTRACTOR SHALL BE RESPONSIBLE FOR PLACING AND MAINTAINING TEMPORARY RESURFACING AND/OR PLANTING FOR ALL EXCAVATIONS IN PAVED STREETS AND SIDEWALKS UNTIL PERMANENT RESURFACING IS COMPLETE.
8. JOINTS BETWEEN NEW BITUMINOUS CONCRETE ROADWAY PAVEMENT AND SAW CUT EXISTING PAVEMENT SHALL BE SEALED WITH BITUMEN AND BACK SANDED.
9. THE CONTRACTOR SHALL PROTECT AND SUPPORT ALL EXISTING UTILITY LINES THAT BECOME EXPOSED DUE TO EXCAVATION REQUIRED TO INSTALL THE PROPOSED CONDUIT.
10. THE CONTRACTOR SHALL REPLACE ALL DISTURBED TRAFFIC SIGNAL LOOP DETECTORS TO GOOD WORKING CONDITION AS REQUIRED BY THE LATEST STANDARDS OF THE MUNICIPAL TRAFFIC DEPARTMENT.
11. ALL EXISTING STATE, COUNTY, CITY, AND TOWN LOCATION LINES AND PRIVATE PROPERTY LINES HAVE BEEN ESTABLISHED FROM AVAILABLE INFORMATION AND THEIR EXACT LOCATION ARE NOT GUARANTEED.
12. THE CONTRACTOR SHALL REPLACE ALL PAVEMENT MARKINGS IN THEIR ENTIRETY THAT HAVE BEEN DAMAGED BY THE EXCAVATION OR OPERATIONS OF THE CONTRACTOR WITH SIMILAR COLOR AND SIZE THERMOPLASTIC MARKINGS.
13. ITEM SHOWN ON UTILITY RECORDS, BUT NOT FOUND IN FIELD.
14. ITEM NOT FOUND IN UTILITY RECORDS, BUT NOT FOUND IN FIELD.

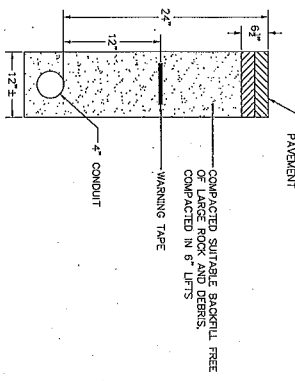

**ROADWAY PATCH AND DUCT BANK
INSTALLATION DETAIL**
N.T.S.

- TRENCH DETAIL NOTES:**
1. 24" MAXIMUM FROM TOP OF CONDUIT TO SURFACE.
 2. 12" FROM TOP OF CONDUIT TO METALLIC WARNING TAPE PLACED ABOVE.
 3. REPAIR SIDEWALKS AND WALKWAYS WITH SAME MATERIALS AS EXISTING.

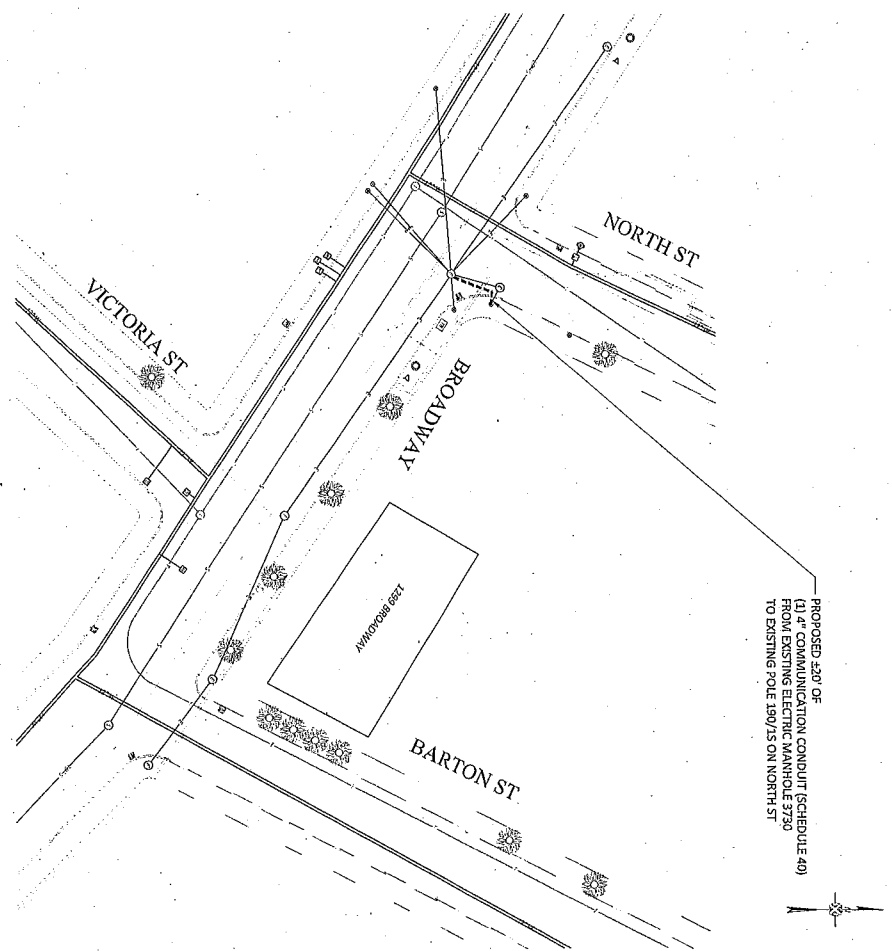

PROPOSED 2.20' DIA. COMMUNICATION CONDUIT (SCHEDULE 40) FROM EXISTING ELECTRIC MANHOLE 3730 TO EXISTING POLE 199/15 ON NORTH ST

LEGEND

(X) UNDERGROUND UTILITIES	(A) TRENCH LIMIT
(O) EXISTING UTILITY	(B) TRENCH WALL
(S) SANITARY SEWER	(C) TRENCH FLOOR
(T) TELEPHONE	(D) TRENCH BACKFILL
(G) GAS	(E) TRENCH WARNING TAPE
(W) WATER	(F) TRENCH ASPHALT PAVEMENT
(E) ELECTRICAL	(G) CONDUIT
(M) METAL MANHOLE	(H) CONDUIT JOINT
(C) CEMENT CONCRETE	(I) CONDUIT END
(D) DUCT BANK	(J) CONDUIT LIFT
(P) PAVEMENT	(K) CONDUIT CURVE
(S) SIDEWALK	(L) CONDUIT CONNECTION TO MANHOLE
(T) TRUNK	(M) CONDUIT CONNECTION TO POLE
(V) VERIFICATION POINT	(N) CONDUIT CONNECTION TO STREET
(W) WARNING TAPE	(O) CONDUIT CONNECTION TO TRENCH
(Y) YELLOW PAVEMENT	(P) CONDUIT CONNECTION TO UTILITY
(Z) ZONE	(Q) CONDUIT CONNECTION TO WATER
(1) 12" TRENCH	(R) CONDUIT CONNECTION TO GAS
(2) 18" TRENCH	(S) CONDUIT CONNECTION TO TELEPHONE
(3) 24" TRENCH	(T) CONDUIT CONNECTION TO CEMENT CONCRETE
(4) 30" TRENCH	(U) CONDUIT CONNECTION TO METAL MANHOLE
(5) 36" TRENCH	(V) CONDUIT CONNECTION TO CEMENT CONCRETE
(6) 42" TRENCH	(W) CONDUIT CONNECTION TO METAL MANHOLE
(7) 48" TRENCH	(X) CONDUIT CONNECTION TO CEMENT CONCRETE
(8) 54" TRENCH	(Y) CONDUIT CONNECTION TO METAL MANHOLE
(9) 60" TRENCH	(Z) CONDUIT CONNECTION TO CEMENT CONCRETE
(10) 66" TRENCH	(1) CONDUIT CONNECTION TO METAL MANHOLE
(11) 72" TRENCH	(2) CONDUIT CONNECTION TO CEMENT CONCRETE
(12) 78" TRENCH	(3) CONDUIT CONNECTION TO METAL MANHOLE
(13) 84" TRENCH	(4) CONDUIT CONNECTION TO CEMENT CONCRETE
(14) 90" TRENCH	(5) CONDUIT CONNECTION TO METAL MANHOLE
(15) 96" TRENCH	(6) CONDUIT CONNECTION TO CEMENT CONCRETE
(16) 102" TRENCH	(7) CONDUIT CONNECTION TO METAL MANHOLE
(17) 108" TRENCH	(8) CONDUIT CONNECTION TO CEMENT CONCRETE
(18) 114" TRENCH	(9) CONDUIT CONNECTION TO METAL MANHOLE
(19) 120" TRENCH	(10) CONDUIT CONNECTION TO CEMENT CONCRETE

AXIS
ENGINEERING GROUP

CALL BEFORE YOU DIG
ENGINEERING SERVICE ALERT
ENTERS 1-800-368-5828

EXISTING UTILITIES SHOWN ARE APPROXIMATE AND NOT WARRANTED TO BE CORRECT. THE CONTRACTOR SHALL VERIFY THE LOCATION, DEPTH, AND CONTENTS OF ALL EXISTING UTILITIES PRIOR TO BEGINNING ANY EXCAVATION.

RCN

PROPOSED CONDUIT INSTALLATION

2.20" DIA. COMMUNICATION CONDUIT (SCHEDULE 40)

1569 BROADWAY

DESIGNED BY: ANDREW CHEN	DRAWN BY: ANDREW CHEN
CHECKED BY: ANDREW CHEN	DATE: 05/19/23
APPROVED BY: ANDREW CHEN	SCALE: AS SHOWN

Map	Blk	Lot	Street	Grantee	Co grantee's Name	Mailing Address	City	St Zip	Code Use
3	I	10	6 BARTON ST	MAOLFHOCHHAIR SEANUS	DOLAN RUTH M	6 BARTON ST 1500 DISTRICT AVE	SOMERVILLE BURLINGTON	MA 02144 MA 01803	1040 TWC 3250 CONV
3	I	11	1295 BROADWAY	TIANCHENG INTERNATIONAL GROUP					
3	I	12	1305 BROADWAY	DITUCCI COSMO & IDA		9 LAKE TERRACE	ROBURN	MA 01801	3250 CONV

SOMERVILLE, MA

