

SECOND HAND MOTOR VEHICLE DEALER LICENSE APPLICATION

2015 FEB 23 12:07

Nonrefundable Application Fee \$550.00

FOR CITY CLERK'S OFFICE ONLY
Date Recorded 2/23/15
Amount Paid \$550

Date 1-28-15

New Application Check one: Class 1 [X] Class 2 Class 3
Renewing Application with Additions or Changes Vehicles stored: 0 inside
Renewing Application with NO Additions or Changes 18 outside

Business (DBA) Name: Alewife Automotive Phone: 617-623-9615

Business Address (in Somerville): 395 Alewife Brook Parkway

Applicant's Federal Employer Identification Number: 043-564-703

Applicant's Legal Name: Elias Michael

Mailing Name (who we should send correspondence to): Elias Michael

Mailing Address (with Zip Code): 229 Curve St. Dedham Ma. 02026

Emergency Contact: George Michael Phone: 617-372-0648

Type of Business (Check Only One and Provide the Names Indicated):
Sole Proprietor: Name of Owner:
Partnership (inc. LLP): Name of Partnership:
Names of All Partners Who Own More Than 10%:
Trust: Name of Trust:
Names of All Trustees Who Own More Than 10%:
[X] Corporation: Name of Corporation: G E & M Auto Service Inc.
Name of President: Elias Michael
Name of Secretary: Elias Michael Name of Treasurer: George Michael
LLC: Name of LLC:
Names of All Managers Who Own More Than 10%:
Other (Attach a Description of the Form of Ownership and the Names of Owners)

Are you engaged principally in the business of buying, selling or exchanging motor vehicles? Y __ N

Is your principal business the sale of new motor vehicles? Y __ N

If yes, are you a recognized agent of a motor vehicle manufacturer, or do you have authority to sell the vehicles of a motor vehicle manufacturer via a written contract? Y __ N __

If yes, provide the name of the manufacturer(s): _____

Is your principal business the buying and selling of second hand motor vehicles? Y N __

If yes, have you obtained a \$25,000 bond pursuant to MGL c. 140 § 58, for this business, at this location? Y N __

If yes, do you have access to a repair facility to comply with the warranty obligations imposed by MGL c. 90 § 7N¼? Y N __

If yes, provide the name of the repair facility: Alewife Automotive

Is your principal business that of a motor vehicle junk dealer? Y __ N

Have you ever obtained a license to deal in second hand motor vehicles or parts? Y N __

If yes, list year, city and state 2008 - Present
Somerville Ma.

Have you ever been denied a license to deal in second hand motor vehicles or parts? Y __ N

If yes, list year, city and state _____

Have you ever had a license to deal in second hand motor vehicles or parts revoked or suspended? Y __ N

If yes, list year, city and state _____

I request permission to store ~~10~~⁰ vehicles inside the building, and 18 vehicles on the parking lot.

Attach a scaled site plan drawing of your property, showing exactly where you will store each of the vehicles you wish to park on the premises. Include a plan for both the inside of the building and the outside parking lot. Include the dimensions for each space.

The hours of operation for used car dealers are Monday through Friday, 8 AM to 6 PM, Saturday, 8 AM to 2 PM, and Sunday, Closed. If you require different hours of operation, list them and explain:

ACKNOWLEDGEMENT

I hereby state that all information provided on this application is true and accurate, and I understand that any information that is found to be false or misleading may result in the forfeiture of this license. This license will only be effective for the listed location, will expire on December 31, and will be subject to all of the terms, conditions, and limitations set forth in the Somerville Code of Ordinances, any applicable State and Federal laws, and any conditions prescribed by the City of Somerville. I certify under the penalties of perjury that I, to my best knowledge and belief, have filed all State tax returns and paid all State taxes required under law.

Signature of Applicant: ~~ECM~~ Date 1.28.15

Business Name: Alewife Automotive

Business Address: 395 Alewife Brook Parkway

FOR NEW APPLICANTS:

INSPECTIONAL SERVICES DEPARTMENT RECOMMENDATION:

The building located at the premises mentioned above is in a NB Zone.

- The use is permitted as of right
- The use requires a special permit
- The use is prohibited

Class 1 & 2: Maximum number of vehicles to be kept on the premises: 3 inside
29 outside

Signature: [Signature] Date: 2/23/15

Print Name: JAMES AVRILIO Title: BLOS INSP.

POLICE DEPARTMENT RECOMMENDATION:

The Chief of Police recommends that the application be

- Approved
- Denied

Signature: [Signature] Name and Title: PAUL R. TRANT
Deputy Chief

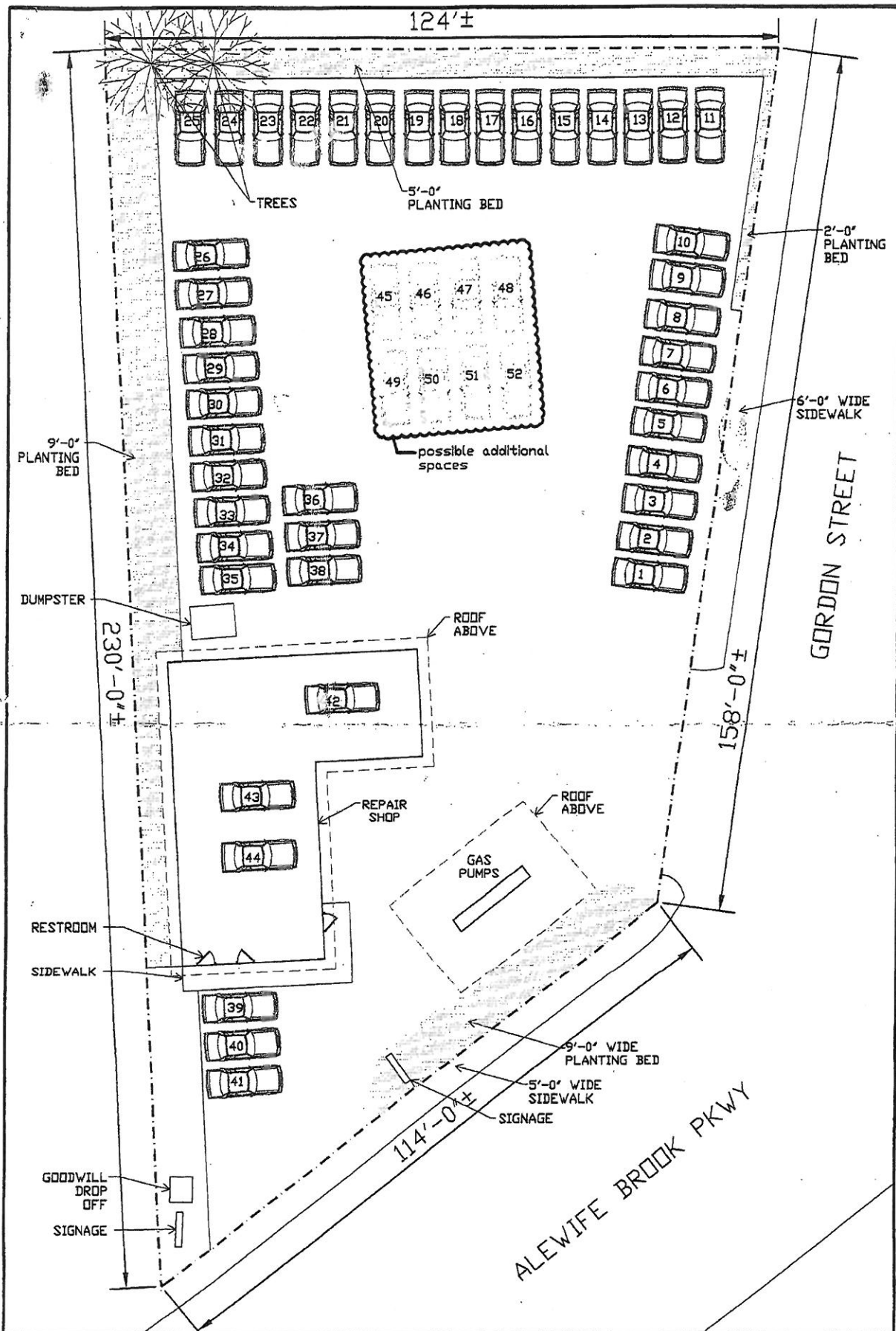

Alewife Automotive – Site Plan

395 Alewife Brook Pkwy Somerville, MA 02144

SHEET No.
S1
SCALE =
1/16" = 1'-0"

Massachusetts

Western Surety Company

SECOND HAND MOTOR VEHICLE DEALER BOND (Mass. Gen. Laws Ann. 140, § 58(c))

Bond No. 70354227

KNOW ALL PERSONS BY THESE PRESENTS:

Effective Date: August 6, 2007

That we, GE & M Auto Services, Inc., as Principal, and WESTERN SURETY COMPANY, a corporation authorized to do surety business in the Commonwealth of Massachusetts, as Surety, are held and firmly bound unto persons who purchase a vehicle from the Principal and who suffer loss on account of a breach of the condition of this bond described below, in the sum of not to exceed TWENTY-FIVE THOUSAND AND NO/100 DOLLARS (\$25,000.00), for the payment of which well and truly to be made, we bind ourselves and our legal representatives, firmly by these presents.

WHEREAS, the Principal is a second hand motor vehicle dealer and is required to furnish a bond or equivalent proof of financial responsibility pursuant to Mass. Gen. Laws Ann. 140, § 58(c)(1).

NOW, THEREFORE, the condition of this obligation is such that if the Principal shall pay the amount of actual damages, not to exceed the amount of this bond, to any person who purchases a vehicle from the Principal and who suffers loss on account of: (a) the Principal's default or nonpayment of valid bank drafts, including checks drawn by the Principal for the purchase of motor vehicles; (b) the Principal's failure to deliver, in conjunction with the sale of a motor vehicle, a valid motor vehicle title certificate free and clear of any prior owner's interests and all liens, except a lien created by or expressly assumed in writing by the buyer of the vehicle; (c) the fact that the motor vehicle purchased from the Principal was a stolen vehicle; (d) the Principal's failure to disclose the vehicle's actual mileage at the time of sale; (e) the Principal's unfair and deceptive acts or practices, misrepresentations, failure to disclose material facts or failure to honor a warranty claim or arbitration order in a retail transaction; or (f) the Principal's failure to pay off a lien on a vehicle traded in as part of a transaction to purchase a vehicle when the Principal had assumed the obligation to pay off the lien, then this obligation to be void; otherwise to remain in full force and effect.

PROVIDED, that recovery against this bond may be made only by a person who obtains a final judgment in a court of competent jurisdiction against the Principal for an act or omission on which this bond is conditioned, if the act or omission occurred during the term of this bond. No suit may be maintained to enforce any liability on this bond unless brought within one (1) year after the event giving rise to the cause of action. This bond shall cover only those acts and omissions described above. The Surety shall not be liable for total claims in excess of the bond amount, regardless of the number of claims made against this bond or the number of years this bond remains in force.

This bond shall be continuous and may be cancelled by the Surety by giving thirty (30) days' written notice of cancellation to the municipal licensing authority at 100 Highland Ave., Somerville, MA 02176

by First Class U.S. Mail. _____ Address _____

Dated this 6th day of August, 2007.



GE & M Auto Services, Inc., Principal

By: _____

WESTERN SURETY COMPANY, Surety

By: Paul T. Bruflat
Paul T. Bruflat, Senior Vice President

Western Surety Company

POWER OF ATTORNEY

KNOW ALL MEN BY THESE PRESENTS:

That WESTERN SURETY COMPANY, a corporation organized and existing under the laws of the State of South Dakota, and authorized and licensed to do business in the States of Alabama, Alaska, Arizona, Arkansas, California, Colorado, Connecticut, Delaware, District of Columbia, Florida, Georgia, Hawaii, Idaho, Illinois, Indiana, Iowa, Kansas, Kentucky, Louisiana, Maine, Maryland, Massachusetts, Michigan, Minnesota, Mississippi, Missouri, Montana, Nebraska, Nevada, New Hampshire, New Jersey, New Mexico, New York, North Carolina, North Dakota, Ohio, Oklahoma, Oregon, Pennsylvania, Rhode Island, South Carolina, South Dakota, Tennessee, Texas, Utah, Vermont, Virginia, Washington, West Virginia, Wisconsin, Wyoming, and the United States of America, does hereby make, constitute and appoint

Paul T. Brufat of Sioux Falls
State of South Dakota, its regularly elected Senior Vice President
as Attorney-in-Fact, with full power and authority hereby conferred upon him to sign, execute, acknowledge and deliver for and on its behalf as Surety and as its act and deed, the following bond:

One SECOND HAND MOTOR VEHICLE DEALER

bond with bond number 70354227

for GE & M AUTO SERVICES, INC.

as Principal in the penalty amount not to exceed: \$25,000.00

Western Surety Company further certifies that the following is a true and exact copy of Section 7 of the by-laws of Western Surety Company duly adopted and now in force, to-wit:

Section 7. All bonds, policies, undertakings, Powers of Attorney, or other obligations of the corporation shall be executed in the corporate name of the Company by the President, Secretary, any Assistant Secretary, Treasurer, or any Vice President, or by such other officers as the Board of Directors may authorize. The President, any Vice President, Secretary, any Assistant Secretary, or the Treasurer may appoint Attorneys-in-Fact or agents who shall have authority to issue bonds, policies, or undertakings in the name of the Company. The corporate seal is not necessary for the validity of any bonds, policies, undertakings, Powers of Attorney or other obligations of the corporation. The signature of any such officer and the corporate seal may be printed by facsimile.

In Witness Whereof, the said WESTERN SURETY COMPANY has caused these presents to be executed by its Senior Vice President with the corporate seal affixed this 6th day of August, 2007.

ATTEST

L. Nelson
L. Nelson, Assistant Secretary

WESTERN SURETY COMPANY
By Paul T. Brufat
Paul T. Brufat, Senior Vice President



STATE OF SOUTH DAKOTA }
COUNTY OF MINNEHAHA } ss

On this 6th day of August, 2007, before me, a Notary Public, personally appeared Paul T. Brufat and L. Nelson Senior Vice President

who, being by me duly sworn, acknowledged that they signed the above Power of Attorney as Senior Vice President and Assistant Secretary, respectively, of the said WESTERN SURETY COMPANY, and acknowledged said instrument to be the voluntary act and deed of said Corporation.

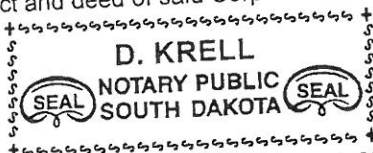

D. Krell
Notary Public

My Commission Expires November 30, 2012





CITY OF SOMERVILLE, MASSACHUSETTS
CITY CLERK'S OFFICE
JOSEPH A. CURTATONE
MAYOR

JOHN J. LONG
CITY CLERK

February 23, 2015

To an Abutter or Interested Party:

You are receiving this letter because the City of Somerville's records indicate that you own property within 300 feet of 395 Alewife Brook Parkway.

A Public Hearing for all persons interested will be held before the Somerville Board of Aldermen, Committee on Licenses and Permits, in the Committee Room, City Hall, 2nd Floor, 93 Highland Avenue, Somerville, MA, 02143, on Tuesday, March 3, 2015, at 7:00 PM, to consider the following matter:

GE & M Auto Service Inc. dba Alewife Automotive seeks to obtain a Used Car Dealer's License Class II at 395 Alewife Brook Parkway, with 18 vehicles stored outside (in addition to the 3 vehicles inside and 29 vehicles outside allowed under the existing Garage License).

You, the abutter or interested party, are invited to appear and be heard at this Hearing.

Sincerely,

John J. Long
City Clerk

Abutting Properties for
395 ALEWIFE BROOK PKWY
2/ A/ 30/ /
(300 feet)

Location:
3/ C/ 1/ /
379 ALEWIFE BROOK PKWY
Owner:
SCIUCCO FIORE A TRUSTEE
SCIUCCO FAMILY TRUST
379 ALEWIFE BROOK PKWY
SOMERVILLE, MA 02144

Location:
2/ A/ 22/ /
67 GORDON ST
Owner:
GILMAN NANCY G
67 GORDON ST
SOMERVILLE, MA 02144

Location:
2/ A/ 25/ /
75 GORDON ST
Owner:
KARGATZIS SOTIRIOS ANDY &
KARGATZIS KOSTAS
54 BROMFIELD RD #1
SOMERVILLE, MA 02144

Location:
3/ C/ 2/ /
90 GORDON ST
Owner:
SACHER MATHEW J
103 WESTGATE RD
WELLESLEY, MA 02481

Location:
3/ C/ 6/ /
74 GORDON ST
Owner:
DEFRANZO THOMAS & ROBYN L
74 GORDON ST
SOMERVILLE, MA 02144

Location:
3/ C/ 50/ /
87 WOODS AVE
Owner:
TIERNEY JOHN T & JULIA FOR LIFE
S TIERNEY TR / TIERNEY FAM IRREV R
E TR
87 WOODS AVE
SOMERVILLE, MA 02144

Location:
3/ C/ 54/ /
103 WOODS AVE
Owner:
PORTILLO JOSE
PALACIOS FRANCISCA
103 WOODS AVE
SOMERVILLE, MA 02144

Location:
2/ A/ 33/ /
1 CAPEN CT
Owner:
SOMERVILLE HOUSING AUTH
30 MEMORIAL RD
SOMERVILLE, MA 02145

Location:
2/ A/ 18/A /
136 CAPEN ST
Owner:
DE MELIS JOHN
1ST 136 CAPEN ST
MEDFORD, MA 02155

Location:
2/ A/ 23/ /
69 GORDON ST
Owner:
DIFUSCO DANIEL
69 GORDON ST
SOMERVILLE, MA 02144

Location:
2/ A/ 26/ /
79 GORDON ST
Owner:
GERVER MARJORIE & IRA S & PAUL A
79 GORDON ST
SOMERVILLE, MA 02144

Location:
3/ C/ 4/ /
82 GORDON ST
Owner:
DUMAS PAUL F & JEAN E
82 GORDON ST
SOMERVILLE, MA 02144

Location:
3/ C/ 7/ /
72 GORDON ST
Owner:
DIFUSCO GIUSEPPE & TIZIANA FOR
LIFE
ANNA & DANIELA DIFUSCO
72 GORDON ST
SOMERVILLE, MA 02144

Location:
3/ C/ 51/ /
91 WOODS AVE
Owner:
LUCREZIANO JOSEPHINE M TRUSTEE
TRUST WOODS AVENUE REALTY
91 WOODS AVE
SOMERVILLE, MA 02144

Location:
3/ D/ 1/ /
373 ALEWIFE BROOK PKWY
Owner:
BOSSI LORRAINE TRUSTEE
LORRAINE TRUST
47 BROOKSDALE ROAD
BRIGHTON, MA 02135

Location:
2/ B/ 1/ /
0 ALEWIFE BROOK PKWY
Owner:
COMM OF MASS
C/O DIVISION OF CAPITAL ASSET
MANAGEMENT
ONE ASHBURTON PL 15TH FL
BOSTON, MA 02108

Location:
2/ A/ 19/ /
138 CAPEN ST
Owner:
LEAHY THOMAS B & DIANE J
138 CAPEN ST
MEDFORD, MA 02155

Location:
2/ A/ 24/ /
73 GORDON ST
Owner:
DIFUSCO FRANCO & FILOMENA
TRUSTEES
F & F DIFUSCO IRREVOCABLE TRUST
73 GORDON ST
SOMERVILLE, MA 02144

Location:
2/ A/ 29/ /
85 GORDON ST
Owner:
RODRIGUES MARCELO
S/O WILLIAMS BRENDA & KEVIN M
85 GORDON ST
SOMERVILLE, MA 02144

Location:
3/ C/ 5/ /
80 GORDON ST
Owner:
FULCHINI JOSEPH & MARY LOUISE
80 GORDON ST
SOMERVILLE, MA 02144-1110

Location:
3/ C/ 8/ /
66 GORDON ST
Owner:
HOSSEINIAN-AZGHADI RASOUL &
FARSI MEHRI
68 GORDON STREET
SOMERVILLE, MA 02144

Location:
3/ C/ 52/ /
97 WOODS AVE
Owner:
RESMINI ROSEMARY & CHRISTINE
TRUSTEES
97 WOODS AVENUE REALTY TRUST
97 WOODS AVE
SOMERVILLE, MA 02144

Location:
2/ A/ 31/ /
149 CAPEN ST
Owner:
SOMERVILLE HOUSING AUTHORITY
30 MEMORIAL RD
SOMERVILLE, MA 02145

Location:
3/ G/ 1/ /
ALEWIFE BROOK PKWY
Owner:
COMM OF MASS
DEPT OF CONSERVATION &
RECREATION
251 CAUSEWAY ST
BOSTON, MA 02114

Location:
2/ A/ 34/ /
405 ALEWIFE BROOK PKWY
Owner:
CONWELL CAPEN LLC
C/O VISITING NURSE ASSISTED LIV INC
259 LOWELL ST
SOMERVILLE, MA 02144

Location:
3/ C/ 53/ 99/
99 WOODS AVE
Owner:
GELLER DENNIS
99 WOODS AVE
SOMERVILLE, MA 02144

Location:
3/ C/ 53/ 101/
101 WOODS AVE
Owner:
HERZOG AMY L
S/O RAPOPORT REBECCA L & CHUNG
DEAN R
286 BEDFORD ST
LEXINGTON, MA 02421

Location:
3/ C/ 3/ 86/
86 GORDON ST
Owner:
POMMET DAVID MICHAEL
86 GORDON ST
SOMERVILLE, MA 02144

Location:
3/ C/ 3/ 88/
88 GORDON ST
Owner:
POMMET TONI MARIE
88 GORDON ST
SOMERVILLE, MA 02144



City of Somerville, Massachusetts
Finance Department, Treasury Division

CERTIFICATE OF GOOD STANDING

Exact name of taxpayer/applicant's business: GE 3 M Auto service Inc.
DBA Alewife Automotive

Address of taxpayer/applicant's business in Somerville: 395 Alewife Brook Parkway

Address of taxpayer/applicant's home in Somerville: _____

Taxpayer/applicant's phone: day: 617-623-9615 evening: 617-372-0648

I, (print name) Elias Mikhail, the undersigned Taxpayer, do hereby certify that all the information contained herein is true and correct and all taxes and fees due the City have been paid or that the Taxpayer has entered into an agreement to pay all taxes and fees and is current on said agreement.

SIGNED UNDER THE PAINS AND PENALTIES OF PERJURY, this 3rd day of February, 2015.
[Signature]
(Taxpayer's signature)

CITY'S ACKNOWLEDGEMENT

DATE OF ISSUANCE: _____ INCLUDES RELEVANT POSTINGS THROUGH: _____

TAXES AND ACCOUNT NUMBER(S) INCLUDED IN CERTIFICATE:

Real Estate Water/Sewer Personal Property Other: _____
335 # 346654001 # 14 # _____

NOTES:

CLERK'S INITIALS: _____

ORIGINAL STAMP:

RECEIVED
Urban
2-3-15

The Commonwealth of Massachusetts
Department of Industrial Accidents
Office of Investigations
600 Washington Street
Boston, Mass. 02111

Workers' Compensation Insurance Affidavit - General Businesses

Applicant information:

Name: GE 3 M Auto Service Inc. DBA Alewife Automotive
 Address: 395 Alewife Brook Parkway Sa
 City: Somerville State: Ma. Zip: 02144 Phone #: 617-623-9615

- I am an employer with 5 employees (full and/or part time). Business Type: Retail
 I am a sole proprietor or partnership and have no employees. Restaurant/Bar/Eating Establishment
 We are a corporation that has exercised our right of exemption per c152 s1(4), and have no employees. Office and/or Sales (real estate, auto, etc.)
 We are a nonprofit organization staffed by volunteers and have no employees. Nonprofit
 Entertainment
 Manufacturing
 Health Care
 Other Gas Station, Auto Repair
3 Sales.

Workers' compensation insurance information (if applicable):

Insurance Company Name: MA. Retail Merchant WC Group Inc.
 Address: P.O. Box 859222-9222
 City: Braintree State: Ma. Zip: 02185 Phone #: 781-843-0005
 Policy #: 014005032305115 Expiration Date: 01-01-16

Applicant certification:

Failure to secure coverage as required under Section 25A of MGL 152 can lead to the imposition of criminal penalties of a fine up to \$1,500.00 and/or one years' imprisonment as well as civil penalties in the form of a STOP WORK ORDER and a fine of \$100.00 a day against me. I understand that a copy of this statement may be forwarded to the Office of Investigations of the DIA for coverage verification.

I do hereby certify under the pains and penalties of perjury that the information provided above is true and correct.

Signature: Elias Michael Date: 2.3.15
 Print Name: Elias Michael

Official use only. Do not write in this area. To be completed by city or town official.

City or Town: _____ Permit/License #: _____

Contact Person: _____ Phone #: _____

Board of Health
 Building Department
 City/Town Clerk
 Licensing Board
 Selectmen's Office
 Other _____



CITY OF SOMERVILLE
Commonwealth of Massachusetts
93 Highland Avenue
Somerville, MA 02143
(617) 625-6600

License #: 22

Docket #196122

Account ID: 25

Reference #: 22

USED CAR DEALER CLASS 2

GE & M AUTO SERVICE
ALEWIFE AUTOMOTIVE
395 ALEWIFE BROOK PKWY
SOMERVILLE, MA 02144

License Expires: 12/31/2014

This is to certify that GE & M AUTO SERVICE, dba ALEWIFE AUTOMOTIVE,
has been granted a/an USED CAR DEALER CLASS 2 license in the City of Somerville, ONLY at the
following address: 395 ALEWIFE BROOK PKWY.

This license is issued subject to the provisions of the General Laws of the Commonwealth, all
ordinances of the City, and all regulations or conditions of the BOARD OF ALDERMEN, including
but not limited to any specific conditions listed below.

License Information:

Hours: M-Sa 9-9, Su 9-5

Food Manager / Emergency Contact: GEORGE MIKHAEL 617-372-0648

30 VEHICLES OUTSIDE

Attest for the BOARD OF ALDERMEN:

This license is NOT Transferable, and no changes may be made to this license
without the approval of the BOARD OF ALDERMEN.
This license must be posted in a conspicuous place on the premises.