



**CITY OF SOMERVILLE**  
Commonwealth of Massachusetts  
93 Highland Avenue  
Somerville, MA 02143  
(617) 625-6600

## BUSINESS LICENSE APPLICATION - Grant of Location

File #: 24-007580  
License #: BL24-000062  
Address: 37-39 Main St  
Licensee: Angel Hart NSTAR Electric dba Eversource Energy  
DBA Name: EVERSOURCE ENERGY

Business Ownership Type: Corporation  
Legal Name of Entity: NSTAR ELECTRIC COMPANY dba EVERSOURCE ENERGY  
Owners/Officers: JOSEPH NOLAN JR, , ,

### License Information:

**Grant of location issued to:** NSTAR ELECTRIC COMPANY dba EVERSOURCE ENERGY

**Describe the reason for the work, and the intended beneficiaries:** To upgrade service at 37-39 Main Street

**Insert here the same detailed description of the work as appears in the attached Grant of Location**

**Order:** MAIN STREET – Westerly from Pole 146/5, across from Moreland Street, to private property at #37-39 Main Street, install approximately 7 feet of conduit WO#16093696

Approval Conditions:

### Approved By:

**Isabela Maia, Approved with Conditions**

APPROVAL CONDITION IMM 240417: Any work requiring the use of the street and/or sidewalk will require a Street/Sidewalk Occupancy Permit from the Engineering Department. Apply via Citizen Serve before conduit installation.

APPROVAL CONDITION IMM 240417: Handhole to be installed on private property.

**Malik Drayton, Approved with Conditions**

APPROVAL CONDITION: MD20240419: Contractor shall take all necessary precautions to avoid damaging any tree or tree part with equipment.

APPROVAL CONDITION: MD20240419 All nearby street tree(s) shall be protected prior to and during all construction activities using TREE BOX or TREE WRAPS. . TREE BOX shall be constructed from 2 in. x 4 in. lumber creating a box around the border of the tree pit with 2 in. x 4 in. lumber standing straight up at the corners and wrapped with orange snow fence. Detail attached. . TREE WRAPS (TREE TRUNK WRAPPING PROTECTION LUMBER) shall consist of 2 in. x 4 in. and 8 ft. height lumber wired together in close spacing with zip ties or 16 gauge galvanized steel wire to form a protective enclosure around tree trunks. Use burlap to separate the wood from the bark if necessary to prevent wood from scraping or bruising bark. Do not use staples or puncture the trunk in any way.

APPROVAL CONDITION: MD20240419: Any tree roots less than two (2) inches in diameter that cannot be avoided during construction shall be carefully and cleanly cut with a clean pair of pruning shears or loppers. Roots are to be cut back flush with the edge of the trench. If any tree roots greater than two (2) inches in diameter are encountered, stop work immediately and contact the City Urban Forester. Any and all pruning of roots greater than 2 inches in diameter must be completed under the supervision of the City

Urban Forester.

**Eric Weisman, Approved**

**Kimberly M. Wells, Approved**



CITY OF SOMERVILLE, MASSACHUSETTS  
CITY CLERK'S OFFICE  
KATJANA BALLANTYNE  
MAYOR

KIMBERLY M. WELLS  
CITY CLERK

April 30, 2024

**NOTICE OF PUBLIC HEARING**

You are hereby notified that the Somerville City Council will hold a Public Hearing on the following Petition. You are receiving this Notice because the Petitioner has reported that you own property that abuts the work that is being proposed. You and other members of the public are invited to attend and be heard at this Hearing.

**This meeting of the City Council will also be conducted via remote participation, online in a webinar hosted on the Zoom platform.**

You have three ways to be heard at this meeting:

1. To attend and be heard, enter the link exactly as it appears below into your internet browser any time before the meeting. You will then be asked to register for the meeting. After registering, you will receive an email with instructions to join the webinar when it starts.
2. You may also testify in person in the City Council Chamber, City Hall, 2<sup>nd</sup> Floor, 93 Highland Avenue, Somerville, MA 02143
3. If you are unable to attend but wish to be heard, you may send written comments by US mail to the City Clerk at the address below, or by email to [cityclerk@somervillema.gov](mailto:cityclerk@somervillema.gov). Your comments must arrive no later than 12 Noon on the day of the Hearing, in order to be sure they are conveyed to the Council.

**PETITION:** Eversource (NStar Electric) is applying for a Grant of Location to install 7 feet of conduit in Main Street, from Utility Pole 146/5 to a point of pickup at 37-39 Main Street.

**PLACE:** [https://us02web.zoom.us/webinar/register/WN\\_G-Pp0xeqQcuOTq9y2cpN-g](https://us02web.zoom.us/webinar/register/WN_G-Pp0xeqQcuOTq9y2cpN-g) or City Council Chambers, City Hall, 2<sup>nd</sup> Floor, 93 Highland Avenue, Somerville, MA 02143

**TIME:** Thursday, May 9, 2024, at 7:00 PM.

**PURPOSE:** The work is necessary to provide service to 37-39 Main Street.

W.O. #16093696

**EVERSOURCE**  
101 Linwood Street  
Somerville, MA 02143

March 25, 2024

Ms. Kimberly Wells  
Office of the City Clerk  
37-39 Main Street  
Somerville, MA 02143

RE: Main Street  
W.O. #16093696

Dear Members of the Board,

The NSTAR Electric Company d/b/a Eversource Energy respectfully requests a Grant of Location for the installation of approximately 7 feet of conduit in Main Street.

This work is necessary to provide service to #37-39 Main Street..

If you have any questions or concerns, please call Jacqueline Duffy at 617-629-3204.

Very truly yours,

*Kelly-Ann Correia*

Kelly-Ann Correia  
Supervisor, Rights and Permits

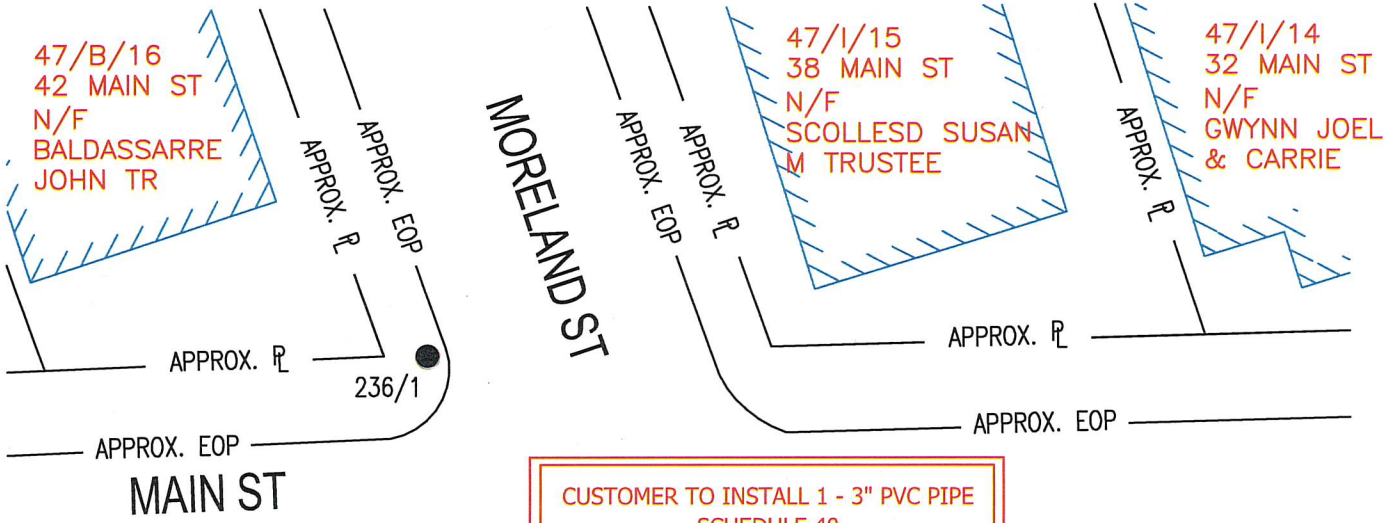
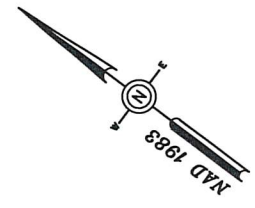

CUSTOMER TO INSTALL 1 - 3" PVC PIPE  
SCHEDULE 40  
NO CONCRETE

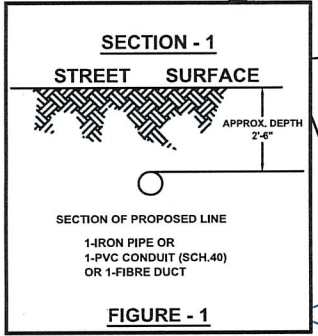
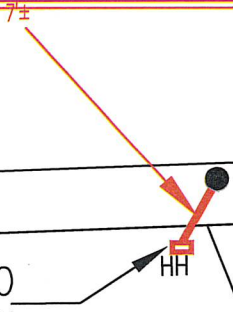

47/H/14  
41 MAIN ST  
N/F  
PRIVITERA JENNIE  
TRUSTEE

47/H/14/A  
37-39 MAIN ST  
N/F  
0037 MAIN  
SOMERVILLE LLC

47/H/15/1  
33 MAIN ST  
SEE ABUTTERS LIST

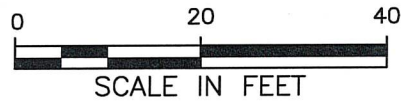

BY YOUR USE OF THE INFORMATION CONTAINED IN THIS MAP, YOU AGREE THAT NO WARRANTY OF ANY KIND, EXPRESS OR IMPLIED, IS GIVEN WITH RESPECT TO THE INFORMATION. NEITHER NSTAR ELECTRIC COMPANY, NSTAR GAS COMPANY NOR ITS PARENTS, AFFILIATES, OFFICERS, DIRECTORS, SHAREHOLDERS, EMPLOYEES OR AGENTS (COLLECTIVELY THE "NSTAR ENTITIES") SHALL BE LIABLE FOR ANY LOSS OR INJURY CAUSED IN WHOLE OR IN PART BY USE OF THIS INFORMATION OR IN RELIANCE UPON IT, TO THE MAXIMUM EXTENT ALLOWED BY LAW, YOU AGREE BY YOUR ACCEPTANCE OF THE INFORMATION TO RELEASE, INDEMNIFY AND HOLD THE NSTAR ENTITIES HARMLESS FROM ANY SUCH LOSS OR INJURY.

THE INFORMATION MAY NOT REPRESENT A SURVEY, MAY NOT BE THE MOST COMPLETE AND IS SUBJECT TO CHANGE WITHOUT NOTICE. NO LIABILITY IS ASSUMED FOR THE ACCURACY OF THE INFORMATION, EITHER EXPRESSED OR IMPLIED. UNAUTHORIZED ATTEMPTS TO MODIFY THE INFORMATION OR USE THE INFORMATION FOR OTHER THAN ITS INTENDED PURPOSES ARE PROHIBITED.

**MASS. LAW**

REQUIRES 72 HOURS ADVANCE NOTICE TO UTILITY COMPANIES BEFORE DIGGING BY ANYONE. CALL DIG-SAFE 1-888-344-7233

C# 72-24	<b>NSTAR EVERSOURCE</b> ELECTRIC d/b/a 1165 MASSACHUSETTS AVE. DORCHESTER, MASS. 02125
Ward #	
Work Order # 16093696	Plan of MAIN STREET
Surveyed by: N/A	SOMERVILLE
Research by: VT	Showing CUSTOMER TO INSTALL PROPOSED CONDUIT LOCATION
Plotted by: VT	Proposed Structures: GC
Approved: T THIBAUT	Scale 1"=20' Date MARCH 12, 2024
P#	SHEET 1 of 1

37 MAIN ST LLC  
37 MAIN ST  
SOMERVILLE, MA 02145

EMMONS NICHOLAS WAINRIGHT  
63 CENTURY ST # 1  
MEDFORD, MA 02155

GRACI JUSTIN WILLIAM  
33 MAIN ST 3  
SOMERVILLE, MA 02145

LABUDOVICH MARKO & VUCETIC  
NATASA  
61 CARLETON RD  
BELMONT, MA 02478

PARDES AMBER  
33 MAIN ST 2  
SOMERVILLE, MA 02145

PERLINI STEVEN L  
191 SPRING ST  
HOPKINTON, MA 01748

PRIVITERA JENNIE TRUSTEE  
59 UNION SQ  
SOMERVILLE, MA 02143 USA

VAN DYNE KAREN F  
33 MAIN ST #4  
SOMERVILLE, MA 02143