



CITY OF SOMERVILLE

Commonwealth of Massachusetts
93 Highland Avenue
Somerville, MA 02143
(617) 625-6600

BUSINESS LICENSE APPLICATION - Grant of Location

File #: 20-006567

License #: BL20-000072

Address: 128 HEATH ST

Licensee: Joanne Callender NSTAR Electric

DBA Name: Eversource Energy

Business Ownership Type: Corporation

Legal Name of Entity: NSTAR Electric Company dba Eversource Energy

Owners/Officers: James Judge, , ,

License Information:

Grant of location issued to: NSTAR Electric Company dba Eversource Energy

Describe the reason for the work, and the intended beneficiaries: N* 200A UG SERVICE TO POLE 84 ON THE SAME SIDE OF STREET...1800SQ FT.. .GS HEAT AND HOT WATER...GAS RANGE, ELECT DRYER...3 TONS A/C...NO JACU ZZI OR HOT TUB...PENDING INSP.

Insert here the same detailed description of the work as appears in the attached Grant of

Location Order: At and South of pole 165/15, approximately 70 feet south of Moreland street to install approximately 64 feet conduit.

Approval Conditions:

Approved By:

Karla Cuarezma, Approved

Malik Drayton, Approved with Conditions

APPROVAL CONDITION: MD20200601: Contractor shall take all necessary precautions to avoid damaging any tree or tree part with equipment.

APPROVAL CONDITION: MD20200601: All nearby street tree(s) shall be protected prior to and during all construction activities using TREE BOX or TREE WRAPS. . TREE BOX shall be constructed from 2 in. x 4 in. lumber creating a box around the border of the tree pit with 2 in. x 4 in. lumber standing straight up at the corners and wrapped with orange snow fence. Detail attached. . TREE WRAPS (TREE TRUNK WRAPPING PROTECTION LUMBER) shall consist of 2 in. x 4 in. and 8 ft. height lumber wired together in close spacing with zip ties or 16 gauge galvanized steel wire to form a protective enclosure around tree trunks. Use burlap to separate the wood from the bark if necessary to prevent wood from scraping or bruising bark. Do not use staples or puncture the trunk in any way.

APPROVAL CONDITION: MD20200601: Any tree roots less than two (2) inches in diameter that cannot be avoided during construction shall be carefully and cleanly cut with a clean pair of pruning shears or loppers.

Roots are to be cut back flush with the edge of the trench. If any tree roots greater than two (2) inches in diameter are encountered, stop work immediately and contact the City Urban Forester. Any and all pruning of roots greater than 2 inches in diameter must be completed under the supervision of the City Urban Forester.

Mark Lawhorne, Approved

John J. Long, Approved



CITY OF SOMERVILLE, MASSACHUSETTS
CITY CLERK'S OFFICE
JOSEPH A. CURTATONE
MAYOR

JOHN J. LONG
CITY CLERK

June 2, 2020

NOTICE OF PUBLIC HEARING

You are hereby notified that the Somerville City Council will hold a Public Hearing on the following Petition. You are receiving this Notice because the Petitioner has reported that you own property that abuts the work that is being proposed. You and other members of the public are invited to attend and be heard at this Hearing.

Because of Governor Baker's and Mayor Curtatone's recent orders limiting the number of people that may gather in one place, **this meeting of the City Council will be conducted via remote participation, online in a webinar hosted on the GoToWebinar platform.**

You have two ways to be heard at this meeting:

1. To attend and be heard, enter the link exactly as it appears below into your internet browser anytime before the meeting. You will then be asked to register for the meeting. After registering, you will receive an email with instructions to join the webinar when it starts.
2. If you are unable to attend but wish to be heard, you may send written comments by US mail to the City Clerk at the address below, or by email to cityclerk@somervillema.gov. Your comments must arrive no later than 12 Noon on the day of the Hearing, in order to be sure they are conveyed to the Council.

PETITION: Eversource (NStar Electric) is applying for a Grant of Location to install 64 feet of conduit in Heath Street, from utility pole 165/15 to a point of pickup at 128 Heath Street.

PLACE: <https://attendee.gotowebinar.com/register/6500907986524570891>.

TIME: Thursday, June 11, 2020 at 7:00 PM.

PURPOSE: The work is necessary to provide service to 128 Heath Street.

W.O. #2382930

EVERSOURCE

101 Linwood Street
Somerville, MA 02143

May 26, 2020

John Long
Office of the City Clerk
93 Highland Avenue
Somerville, MA 02143

Re: Heath Street
Somerville, MA
W.O. #2382930

Dear Sir:

The NSTAR Electric Company d/b/a Eversource Energy, respectfully requests a Grant of Location to install approximately 64 feet of conduit in Heath Street .

This work is necessary to supply service to 128 Heath Street.

Thank you for your prompt attention to this request. If you have any questions, please call Jacqueline Duffy, Right of Way Agent, 617-629-3204.

Very truly yours,

Kelly-Ann Correia

Kelly-Ann Correia,
Supervisor

KC/jc

cc: Highway Department
Engineering Department

47/ C/ 23/ /
133 HEATH ST
N/F
VOLPE VIRGINIA TRUSTEE
#133

INSTALL 1 - 4" PVC PIPES
SCHEDULE 40, NO CONCRETE
SECTION 1 FIG. 1 64±

47/ C/ 22/ 1/
127 HEATH ST #1
N/FSEE ABUTTERS
#127

47/ C/ 21/ /
125 HEATH ST
N/F
COHEN JOEL &
PRALL MAVIS
#125

HEATH ST

APPROX. 70'±
TO MORELAND ST

APPROX. PT.
OF PICKUP

**AREA WITHIN THIS PARCEL
IS CURRENTLY UNDER
CONSTRUCTION**

47/ 1/ 3/ 1/
132-134 HEATH ST #1
N/F
SEE ABUTTERS

47/ 1/ 1/ 7/
7 MORELAND ST
N/F
SEE ABUTTERS

47/ 1/ 4/ /
128-126 HEATH ST
N/F
EMERALD 785 LLC
S/O 124 HEATH
DEL CAM LLC

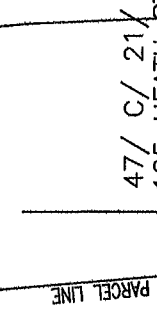

SCALE IN FEET

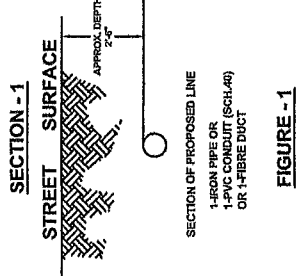

FIGURE - 1

BY YOUR USE OF THE INFORMATION CONTAINED IN THIS MAP, YOU AGREE THAT NO WARRANTY OF ANY KIND, EXPRESS OR IMPLIED, IS GIVEN WITH RESPECT TO THE INFORMATION. NEITHER NSTAR ELECTRIC COMPANY, NSTAR GAS COMPANY NOR ITS PARENTS, AFFILIATES, OFFICERS, DIRECTORS, SHAREHOLDERS, EMPLOYEES OR AGENTS (COLLECTIVELY THE "NSTAR ENTITIES") SHALL BE LIABLE FOR ANY LOSS OR INJURY CAUSED IN WHOLE OR IN PART BY USE OF THIS INFORMATION OR IN RELIANCE UPON IT. THE INFORMATION IS PROVIDED AS IS, WITHOUT WARRANTY OF ANY KIND, AND THE NSTAR ENTITIES SHALL NOT BE HELD LIABLE FOR ANY LOSS OR INJURY. THE INFORMATION MAY NOT REPRESENT A SURVEY, MAY NOT BE THE MOST COMPLETE AND IS SUBJECT TO CHANGE WITHOUT NOTICE. NO LIABILITY IS ASSUMED FOR THE ACCURACY OF THE INFORMATION, EITHER EXPRESSED OR IMPLIED. UNAUTHORIZED ATTEMPTS TO MODIFY THE INFORMATION OR USE THE INFORMATION FOR OTHER THAN ITS INTENDED PURPOSES ARE PROHIBITED.

MASS. LAW

REQUIRES 72 HOURS ADVANCE NOTICE TO UTILITY COMPANIES BEFORE DIGGING BY ANYONE. CALL DIG-SAFE 1-888-344-7233

C# 80-20
Ward #
Work Order # 2362940
Surveyed by: GC/BP
Research by: SC
Plotted by: GC
Proposed Structures: LM
Approved: A DEBENEDICTIS
P#

NSTAR EVERSOURCE
1165 MASSACHUSETTS AVE. DORCHESTER, MASS. 02125

Plan of HEATH ST, SOMERVILLE

Showing PROPOSED CONDUIT LOCATION

Date APRIL 18, 2020

Scale 1"=20'

SHEET 1 of 1

WO # 2382930
HEATH ST
SOMERVILLE, MA 02145

47/ V/ 1/ 7/
7 MORELAND ST
N/F
RUBINO IAN & TODD
S/O SCHEUERMAN AMY E & BROWNING
7 MORELAND ST
SOMERVILLE, MA 02145

47/ V/ 1/ 9/
9 MORELAND ST
N/F
ALTER LYNNE & JESSICA
S/O ALLESSIO COURTNEY & WARD
9 MORELAND ST
SOMERVILLE, MA 02145

47/ V/ 3/ 1/
132-134 HEATH ST #1
N/F
132-134 HEATH STREET LLC
S/O LIPSHAW ARIELLE & LATOUR JEREMY
132-134 HEATH ST 1
SOMERVILLE, MA 02145

47/ V/ 3/ 2/
132-134 HEATH ST #2
N/F
132-134 HEATH STREET LLC
S/O GREENWALD CHERLY R
& KINCHLA PAUL
132-134 HEATH ST #2
SOMERVILLE, MA 02145

47/ V/ 3/ 3/
132-134 HEATH ST #3
N/F
132-134 HEATH STREET LLC
S/O AEBI STEPHINE C
132-134 HEATH ST #3
SOMERVILLE, MA 02145

47/ V/ 4/ 1/
126-128 HEATH ST
N/F
EMERALD 785 LLC
S/O 124 HEATH DELCAM LLC
65 WABAN PARK
NEWTON, MA 02458

47/ C/ 23/ 1/
133 HEATH ST
N/F
VOLPE VIRGINIA TRUSTEE
S/O 133 HEATH STREET, LLC
9 LAKE TERRACE
WOBURN, MA 01810

47/ C/ 22/ 1/
127 HEATH ST #1
N/F
NETO JAQUER D
S/O JAQUER & BILL LLC
96 POND ST
HOLBROOK, MA 02343

47/ C/ 22/ 2/
127 HEATH ST #2
N/F
RIVNAK ANDREW J
127 HEATH ST #2
SOMERVILLE, MA 02145

47/ C/ 21/ 1/
125 HEATH ST
N/F
COHEN JOEL & PRALL MAVIS
125 HEATH ST
SOMERVILLE, MA 02145