



CITY OF SOMERVILLE
Commonwealth of Massachusetts
93 Highland Avenue
Somerville, MA 02143
(617) 625-6600

BUSINESS LICENSE APPLICATION - Grant of Location

File #: 20-015522

License #: BL20-000139

Address: 15 MOSSLAND ST

Licensee: Kelly-Ann Correia Eversource Energy dba NSTAR Electric Company

DBA Name: NSTAR Electric Company DBA Eversource Energy

Business Ownership Type: Corporation

Legal Name of Entity: NSTAR Electric Company DBA Eversource Energy

Owners/Officers: James Judge, , ,

License Information:

Grant of location issued to: NSTAR Electric Company DBA Eversource Energy

Describe the reason for the work, and the intended beneficiaries: The purpose of this work is to provide electric service to 15 Mossland Street.

Insert here the same detailed description of the work as appears in the attached Grant of Location

Order: In Mossland Street, install approximately 89 feet of conduit southwesterly from P241/4, southwest of Elm Street, to private property at 15 Mossland Street.

Approval Conditions:

Approved By:

Karla Cuarezma, Approved

Malik Drayton, Approved with Conditions

APPROVAL CONDITION: MD20200921: Contractor shall take all necessary precautions to avoid damaging any tree or tree part with equipment.

APPROVAL CONDITION: MD20200921: All nearby street tree(s) shall be protected prior to and during all construction activities using TREE BOX or TREE WRAPS. . TREE BOX shall be constructed from 2 in. x 4 in. lumber creating a box around the border of the tree pit with 2 in. x 4 in. lumber standing straight up at the corners and wrapped with orange snow fence. Detail attached. . TREE WRAPS (TREE TRUNK WRAPPING PROTECTION LUMBER) shall consist of 2 in. x 4 in. and 8 ft. height lumber wired together in close spacing with zip ties or 16 gauge galvanized steel wire to form a protective enclosure around tree trunks. Use burlap to separate the wood from the bark if necessary to prevent wood from scraping or bruising bark. Do not use staples or puncture the trunk in any way.

APPROVAL CONDITION: MD20200921: Any tree roots less than two (2) inches in diameter that cannot be avoided during construction shall be carefully and cleanly cut with a clean pair of pruning shears or loppers. Roots are to be cut back flush with the edge of the trench. If any tree roots greater than two (2) inches in diameter are encountered, stop work immediately and contact the City Urban Forester. Any and all pruning of roots greater than 2 inches in diameter must be completed under the supervision of the City Urban Forester.

Mark Lawhorne, Approved
Andrea Torres, Approved

From: jlong@somervillema.gov
Sent: 09/23/2020 - 09:08 AM
To: kelly-ann.correia@eversource.com, Jacqueline.Duffy@eversource.com
CC:
Subject: City Council Interim Approval GOL

To Whom It May Concern:

NStar Electric Company has applied for a Grant of Location for work at 15 Mossland St. The plans for this Grant of Location are attached.

The appropriate city departments have all signed off on the appropriate documents, which are now at City Hall awaiting the next meeting of the City Council.

The President of the City Council, the Chair of the City Council's Committee on Licenses and Permits, and the appropriate Ward City Councilor(s) have also indicated their interim approval. This email will confirm interim approval by the City Council, so the project that has been proposed may proceed as long as all conditions of the City Engineer, the Commissioner of Public Works, the Parking Director, and any other municipal departments have been met.

If you have any questions, please contact John J. Long, City Clerk.

John J. Long, City Clerk
City of Somerville
93 Highland Avenue
Somerville, MA 02143
617 625-6600 x4110
FAX 617 625-4239
www.somervillema.gov
jlong@somervillema.gov



CITY OF SOMERVILLE, MASSACHUSETTS
CITY CLERK'S OFFICE
JOSEPH A. CURTATONE
MAYOR

JOHN J. LONG
CITY CLERK

September 30, 2020

NOTICE OF PUBLIC HEARING

You are hereby notified that the Somerville City Council will hold a Public Hearing on the following Petition. You are receiving this Notice because the Petitioner has reported that you own property that abuts the work that is being proposed. You and other members of the public are invited to attend and be heard at this Hearing.

Because of Governor Baker's and Mayor Curtatone's recent orders limiting the number of people that may gather in one place, **this meeting of the City Council will be conducted via remote participation, online in a webinar hosted on the GoToWebinar platform.**

You have two ways to be heard at this meeting:

1. To attend and be heard, enter the link exactly as it appears below into your internet browser anytime before the meeting. You will then be asked to register for the meeting. After registering, you will receive an email with instructions to join the webinar when it starts.
2. If you are unable to attend but wish to be heard, you may send written comments by US mail to the City Clerk at the address below, or by email to cityclerk@somervillema.gov. Your comments must arrive no later than 12 Noon on the day of the Hearing, in order to be sure they are conveyed to the Council.

PETITION: Eversource (NStar Electric) is applying for a Grant of Location to install 89 feet of conduit in Mossland Street, from utility pole 241/4 to a point of pickup at 15 Mossland Street.

PLACE: <https://attendee.gotowebinar.com/register/4410650622739523596>

TIME: Thursday, October 8, 2020 at 7:00 PM.

PURPOSE: The work is necessary to provide service to 15 Mossland Street.

W.O. 2401367

EVERSOURCE
101 Linwood Street
Somerville, MA 02143

September 19, 2020

Mr. John Long
Office of the City Clerk
93 Highland Avenue
Somerville, MA 02143

RE: Mossland Street
W.O. #2401367

Dear Members of the Board,

The NSTAR Electric Company d/b/a Eversource Energy respectfully requests a Grant of Location for the installation of approximately 89± feet of conduit in Mossland Street.

This work is necessary to supply power to #15 Mossland Street.

If you have any questions or concerns, please call Jacqueline Duffy at 617-629-3204.

Very truly yours,

Kelly-Ann Correia

Kelly-Ann Correia
Supervisor, Rights and Permits

sky/KC

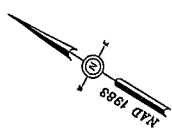

N:\SHARED\pmsse\11020\IMAGES\BASELINES\SS\MOSSLAND\MOSSLAND.dwg

INSTALL 1 - 4" PVC PIPES
SCHEDULE 40, NO CONCRETE
SECTION 1 FIG. 1
89±

MOSSLAND ST

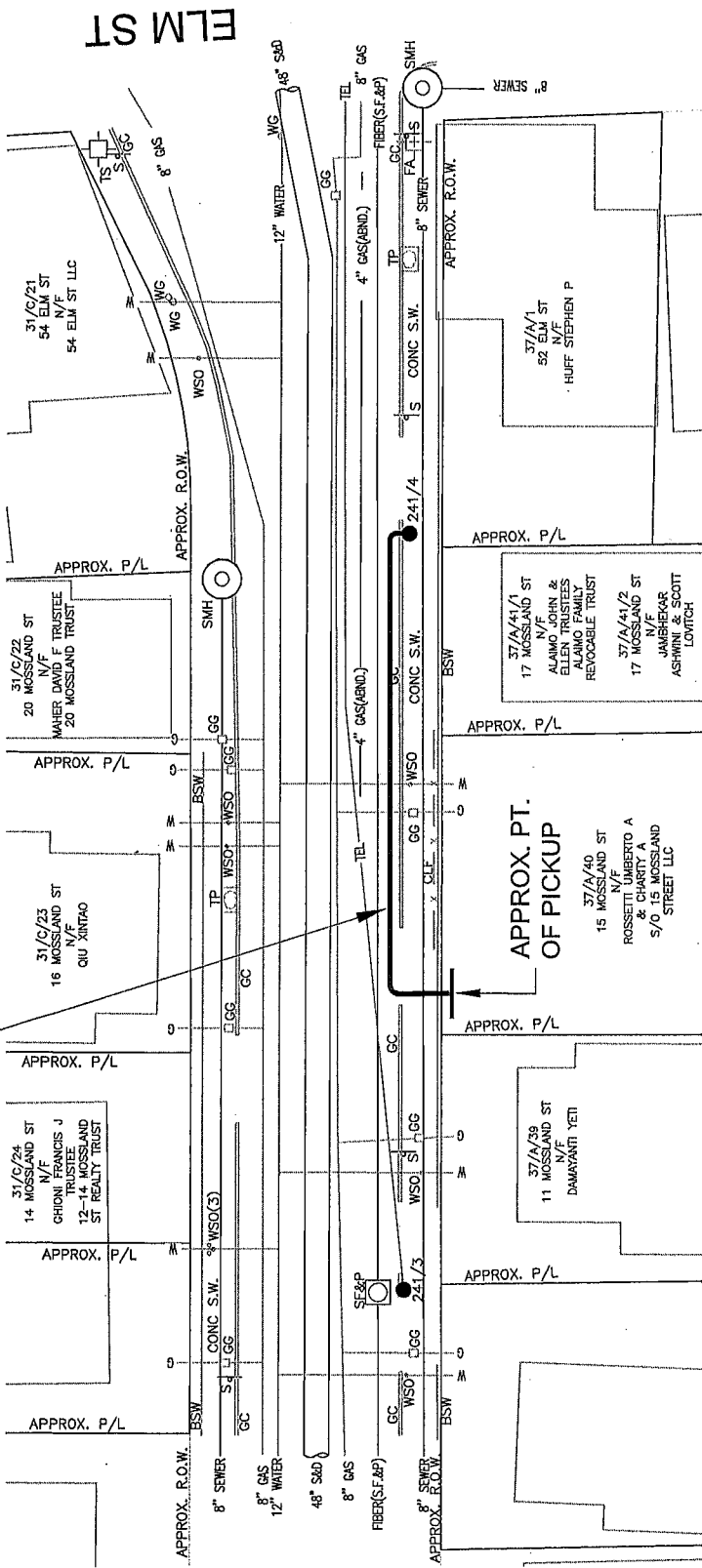

ELM ST

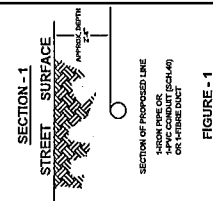

FIGURE - 1

NSTAR EVERSOURCE
2025
1165 MASSACHUSETTS AVE. DORCHESTER, MASS. 02125

Plan of MOSSLAND ST., SOMERVILLE

Showing PROPOSED CONDUIT LOCATION

Scale 1"=20'

Date SEPTEMBER 17, 2020

SHEET 1 of 1

C# 190-20
Ward #
Work Order # 2401387
Surveyed by: JC/OR
Researched by: JC
Plotted by: JF
Proposed Structures: LM
Approved: T THIBAUT
P#

BY YOUR USE OF THE INFORMATION CONTAINED IN THIS MAP, YOU AGREE THAT NO WARRANTY OF ANY KIND IS MADE BY THE ENGINEER OR SURVEYOR FOR THE ACCURACY OF THE INFORMATION. THE USER SHALL BE RESPONSIBLE FOR VERIFYING THE ACCURACY OF THE INFORMATION. THE ENGINEER OR SURVEYOR SHALL BE LIABLE FOR ANY LOSS OR DAMAGE CAUSED BY THE USER'S NEGLIGENCE OR MISUSE OF THE INFORMATION. THE INFORMATION IS PROVIDED AS IS, WITHOUT WARRANTY OF ANY KIND, INCLUDING MERCHANTABILITY AND FITNESS FOR A PARTICULAR PURPOSE. THE INFORMATION IS PROVIDED FOR YOUR INFORMATION ONLY AND DOES NOT CONSTITUTE AN OFFER OF ANY SERVICE OR PRODUCT. THE INFORMATION IS PROVIDED FOR YOUR INFORMATION ONLY AND DOES NOT CONSTITUTE AN OFFER OF ANY SERVICE OR PRODUCT.

MASS LAW
REQUIRES 72 HOURS ADVANCE NOTICE TO UTILITY COMPANIES BEFORE DIGGING BY ANYONE. CALL DIG-SAFE 1-888-344-7293

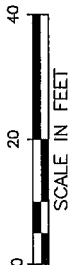

31/C/21
54 ELM ST
N/F
54 ELM ST LLC

31/C/22
20 MOSSLAND ST
N/F
MAHER DAVID F TRUSTEE
20 MOSSLAND TRUST

31/C/23
16 MOSSLAND ST
N/F
QIU XINTAO

31/C/24
14 MOSSLAND ST
N/F
GHONI FRANCIS J TRUSTEE
12-14 MOSSLAND ST REALTY TRUST

37/A/1
52 ELM ST
N/F
HUFF STEPHEN P

37/A/41/1
17 MOSSLAND ST
N/F
ALAMO JOHN & ALAMO FAMILY REVOCABLE TRUST

37/A/41/2
17 MOSSLAND ST
N/F
JAMBEKAR ASHWINI & SCOTT LOWTICH

37/A/40
15 MOSSLAND ST
N/F
ROSSETTI ROBERTO A & CHARITY S/O 15 MOSSLAND STREET LLC

37/A/39
11 MOSSLAND ST
N/F
DAMAYANTI YENI

WO #2401367
15 MOSSLAND ST
SOMERVILLE, MA 02144

37/A/39
11 MOSSLAND ST
N/F
DAMAYANTI YETI
11 MOSSLAND ST
SOMERVILLE, MA 02144

31/C/24
14 MOSSLAND ST
N/F
GHIONI FRANCIS J TRUSTEE
12-14 MOSSLAND ST REALTY TRUST
10 MOSSLAND ST
SOMERVILLE, MA 02144

37/A/40
15 MOSSLAND ST
N/F
ROSSETTI UMBERTO A & CHARITY A
S/O 15 MOSSLAND STREET LLC
100 TRADECENTER SUITE G-700
WOBURN, MA 01801

31/C/23
16 MOSSLAND ST
N/F
QIU XINTAO
16 MOSSLAND ST
SOMERVILLE, MA 02144

37/A/41/1
17 MOSSLAND ST
N/F
ALAIMO JOHN & ELLEN TRUSTEES
ALAIMO FAMILY REVOCABLE TRUST
17 MOSSLAND ST. #1
SOMERVILLE, MA 02144

37/A/41/2
17 MOSSLAND ST
N/F
JAMBHEKAR ASHWINI & SCOTT
LOVITCH
17 MOSSLAND ST #2
SOMERVILLE, MA 02144

31/C/22
20 MOSSLAND ST
N/F
MAHER DAVID F TRUSTEE
20 MOSSLAND TRUST
20 MOSSLAND ST
SOMERVILLE, MA 02144

31/C/21
54 ELM ST
N/F
54 ELM ST LLC
464 COMMON ST. #322
BELMONT, MA 02478

37/A/1
52 ELM ST
N/F
HUFF STEPHEN P
52 ELM ST
SOMERVILLE, MA 02144