



CITY OF SOMERVILLE

Commonwealth of Massachusetts
93 Highland Avenue
Somerville, MA 02143
(617) 625-6600

BUSINESS LICENSE APPLICATION - Grant of Location

File #: 20-008485

License #: BL20-000083

Address: 360 WASHINGTON ST

Licensee: Hayleigh Walker Siena Engineering Group Inc.

DBA Name: TC Systems Inc

Business Ownership Type: Corporation

Legal Name of Entity: TC Systems, Inc.

Owners/Officers: , , ,

License Information:

Grant of location issued to: TC Systems Inc.

Describe the reason for the work, and the intended beneficiaries: This work is to provide service to customers in the area

Insert here the same detailed description of the work as appears in the attached Grant of Location

Order: The installation shall begin at the existing utility pole located in the sidewalk in front of the property of 360 Washington St and extend to where it reaches the proposed handhole across the street and continue to the adjacent utility pole; a total distance of approx. 78 ft.

Approval Conditions:

Approved By:

Karla Cuarezma, Approved

Malik Drayton, Approved with Conditions

APPROVAL CONDITION: MD20200601: Contractor shall take all necessary precautions to avoid damaging any tree or tree part with equipment.

APPROVAL CONDITION: MD20200601: All nearby street tree(s) shall be protected prior to and during all construction activities using TREE BOX or TREE WRAPS. . TREE BOX shall be constructed from 2 in. x 4 in. lumber creating a box around the border of the tree pit with 2 in. x 4 in. lumber standing straight up at the corners and wrapped with orange snow fence. Detail attached. . TREE WRAPS (TREE TRUNK WRAPPING PROTECTION LUMBER) shall consist of 2 in. x 4 in. and 8 ft. height lumber wired together in close spacing with zip ties or 16 gauge galvanized steel wire to form a protective enclosure around tree trunks. Use burlap to separate the wood from the bark if necessary to prevent wood from scraping or bruising bark. Do not use staples or puncture the trunk in any way.

APPROVAL CONDITION: MD20200601: Any tree roots less than two (2) inches in diameter that cannot be avoided during construction shall be carefully and cleanly cut with a clean pair of pruning shears or loppers. Roots are to be cut back flush with the edge of the trench. If any tree roots greater than two (2) inches in diameter are encountered, stop work immediately and contact the City Urban Forester. Any and all pruning of roots greater than 2 inches in diameter must be completed under the supervision of the City Urban Forester.

Mark Lawhorne, Approved
John J. Long, Approved



CITY OF SOMERVILLE, MASSACHUSETTS
CITY CLERK'S OFFICE
JOSEPH A. CURTATONE
MAYOR

JOHN J. LONG
CITY CLERK

July 6, 2020

NOTICE OF PUBLIC HEARING

You are hereby notified that the Somerville City Council will hold a Public Hearing on the following Petition. You are receiving this Notice because the Petitioner has reported that you own property that abuts the work that is being proposed. You and other members of the public are invited to attend and be heard at this Hearing.

Because of Governor Baker's and Mayor Curtatone's recent orders limiting the number of people that may gather in one place, **this meeting of the City Council will be conducted via remote participation, online in a webinar hosted on the GoToWebinar platform.**

You have two ways to be heard at this meeting:

1. To attend and be heard, enter the link exactly as it appears below into your internet browser anytime before the meeting. You will then be asked to register for the meeting. After registering, you will receive an email with instructions to join the webinar when it starts.
2. If you are unable to attend but wish to be heard, you may send written comments by US mail to the City Clerk at the address below, or by email to cityclerk@somervillema.gov. Your comments must arrive no later than 12 Noon on the day of the Hearing, in order to be sure they are conveyed to the Council.

PETITION: TC Systems Inc is applying for a Grant of Location to install a total of 78 feet of conduit as follows: Starting from existing utility pole 358/58 located at the corner of Washington Street and Magnus Avenue to a proposed handhole located in front of Perry Park. Then from proposed handhole, 3 feet to existing utility pole 58x.

PLACE: <https://attendee.gotowebinar.com/register/3992812013161860622>

TIME: Tuesday, July 14, 2020 at 7:00 PM.

PURPOSE: The work is necessary to provide service to surrounding area.

**ORDER FOR GRANT OF LOCATION FOR
WIRES, CABLES, POLES, PIERS, ABUTMENTS, CONDUITS OR FIXTURES**

**City of Somerville, Massachusetts
In Board of Aldermen**

WHEREAS, TC Systems Inc (hereinafter known as the PETITIONER) has petitioned for permission to construct upon, along, under or across the public way(s), the following:

INSERT DESCRIPTION OF WORK HERE

The installation shall begin at the existing utility pole located in the sidewalk in front of the property of 360 Washington St and extend to where it reaches the proposed handhole across the street and continue to the adjacent utility pole; a total distance of approx. 78 ft.

AND WHEREAS, notice has been given and a hearing held on said petition as provided by law; NOW THEREFORE BE IT

ORDERED that the PETITIONER be and hereby is granted permission by the Board of Aldermen to complete the construction described above, all in accordance with the following conditions:

1. PETITIONER shall locate and complete all work as shown by plan(s) dated 6/19/20, and as may have been amended by the City.
2. PETITIONER shall comply with the requirements of existing ordinances and such as may hereafter be adopted governing the construction.
3. PETITIONER shall perform all work to the requirements and satisfaction of the Department of Public Works or other such officer(s) as may be hereafter appointed by the City.

Approved by the Board of Aldermen on the _____ day of _____, 20____,

A True Record. Attest: _____ Date: _____
City Clerk

Certificate

I hereby certify that the foregoing Order was adopted by the Board of Aldermen on the _____ day of _____, 20____, after due notice and public hearing as prescribed by Section 22 of Chapter 166 of the General Laws and any additions or amendments thereto, said public hearing held in said City on the _____ day of _____, 20____, and recorded with the records of Grant of Location Orders of said City, as _____.

Certified. Attest: _____ Date: _____
City Clerk

TC SYSTEMS, INC
An Affiliate of **AT&T**

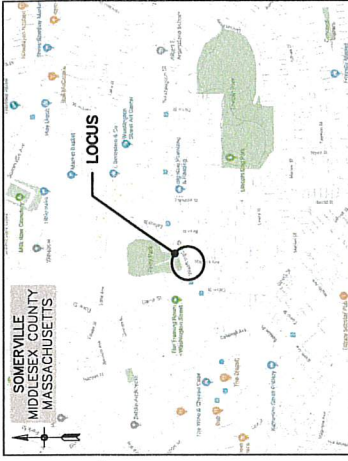

VICINITY MAP
NOT TO SCALE

PROPOSED CONDUIT PLACEMENT WASHINGTON STREET AT MAGNUS AVENUE SOMERVILLE, MA

CONDUIT CONSTRUCTION PLANS
MIDDLESEX COUNTY
JUNE 19, 2020
PERMIT ISSUE

PRELIMINARY
NOT FOR CONSTRUCTION



PRELIMINARY
NOT FOR CONSTRUCTION

NOTE:
1. SUBMITTALS MUST BE MADE TO THE DESIGNER'S OFFICE OR TO THE PROJECT MANAGER'S OFFICE. ALL SUBMITTALS MUST BE MADE TO THE PROJECT MANAGER'S OFFICE. THE PROJECT MANAGER'S OFFICE IS LOCATED AT 18-14300 NORTON ROAD, SUITE 100, WASHINGTON STREET AT DANES, SOMERVILLE, MA 01948. THE PROJECT MANAGER'S OFFICE IS OPEN MONDAY THROUGH FRIDAY, 9:00 AM TO 5:00 PM. THE PROJECT MANAGER'S OFFICE IS CLOSED ON SATURDAY, SUNDAY AND HOLIDAYS. THE PROJECT MANAGER'S OFFICE IS NOT RESPONSIBLE FOR DAMAGE TO OR LOSS OF SUBMITTALS. THE PROJECT MANAGER'S OFFICE IS NOT RESPONSIBLE FOR DAMAGE TO OR LOSS OF SUBMITTALS. THE PROJECT MANAGER'S OFFICE IS NOT RESPONSIBLE FOR DAMAGE TO OR LOSS OF SUBMITTALS.



Call before you dig.

AT&T PROPRIETARY
(Internal Use Only)

Not for disclosure outside the AT&T companies, except under written agreement.

© 2019 AT&T Intellectual Property. All Rights Reserved

AT&T PROPRIETARY: This information constitutes confidential trade secrets and proprietary information of AT&T Intellectual Property and is shared for Critical Infrastructure Protection purposes only. It is exempt from disclosure under the Freedom of Information Act (5 U.S.C. 552), Exemption (b)(3)(A), and its disclosure is prohibited under the Information Act of 2002, 5 U.S.C. 133, and the Information Act of 2009, 5 U.S.C. 552. This information is not to be copied or disseminated to others not authorized to receive it. This information may be copied or distributed to such others without notification pursuant to Executive Order 13526.

PREPARED FOR RECORD
OUTSIDE PLANT ENGINEER DATE

TC SYSTEMS, INC
An Affiliate of **AT&T**



DESIGNED BY: J. CONNOR
CHECKED BY: D. P. CHALHA
APPROVED BY: B. DORNWART PE

PROPRIETARY
LIST PURSUANT TO COMPANY INSTRUCTIONS

SPECIFICATION:
PROJECT NUMBER:
OWNER:
OWNER'S PROJECT NUMBER:
CABLE CLLI:

SCALE:

WASHINGTON STREET AT
MAGNUS AVENUE
SOMERVILLE, MA

LIST OF DRAWINGS

PT001

LIST OF DRAWINGS

PT001	COVER
PT002	LIST OF DRAWINGS
DN001	LEGEND & REFERENCES
DT001	PROPOSED CONDUIT PLACEMENT PLAN
DT002	TYPICAL TRENCH & SURFACE RESTORATION DETAILS
DT003	PROPOSED HANDHOLE & HANDHOLE PLACEMENT DETAILS
DT003	PROPOSED UTILITY RISER DETAIL

**PRELIMINARY
 NOT FOR CONSTRUCTION**

NOTES:
 1. SURFACE UTILITY PLANS, AS SHOWN HEREON, ACCORDING TO THE CITY OF SOMERVILLE, MASSACHUSETTS, SHALL BE CONSIDERED TO BE THE FINAL DESIGN AND SHALL BE USED FOR THE LOCATION AND APPROXIMATE ONLY. ACTUAL CONDITIONS SHALL BE VERIFIED BY THE CONTRACTOR PRIOR TO ANY CONSTRUCTION ACTIVITIES. SIENA ASSUMES NO LIABILITY FOR DAMAGES INCURRED AS A RESULT OF UTILITIES SHOWN OR NOT SHOWN ON THESE PLANS.



Call before you dig.
AT&T PROPRIETARY
 (Internal Use Only)

Not for disclosure outside the AT&T companies, except under written agreement.

2019 AT&T Intellectual Property. All rights reserved.
 AT&T PROPRIETARY: This information constitutes confidential trade secrets and other intellectual property owned by AT&T Intellectual Property. It is exempt from disclosure under the Freedom of Information Act (5 U.S.C. 552). Enforcement of this act and its disclosure is prohibited under the Information Act of 2002, 5 U.S.C. 133, and other applicable laws. This information must not be copied or distributed to others not authorized to receive it. If you are not an employee or affiliate of such entity without notification pursuant to Executive Order 13526, you should not disseminate this information.

PREPARED FOR RECORD
 PROJECT NO. 18-14300
 SHEET NO. 14
 DATE

TC SYSTEMS, INC
 An Affiliate of **AT&T**



DRAWN BY: J. CONRADO
 CHECKED BY: J. CONRADO
 APPROVED BY: B. CORWART PE
PROPRIETARY
 USE PURSUANT TO COMPANY INSTRUCTIONS
 SPECIFICATION
 PROJECT NUMBER

OWNERSHIP
 LINE CODE: C
 CABLE COLOR

SCALE:
 WASHINGTON STREET AT
 MAGNUS AVENUE
 SOMERVILLE, MA

LEGEND & REFERENCES

PT002

PLANIMETRIC SYMBOL LEGEND

	UTILITY POLE W/LIGHT		SURVEY ANGLE POINT
	UTILITY POLE		SURVEY BENCH MARK
	UTILITY POLE ANCHOR		SURVEY IRON PIPE
	PAD MOUNTED TRANSFORMER		MONUMENT (IN CASE)
	GAS METER		MONUMENT (SURFACE)
	GAS VALVE		BUS STOP
	TELEPHONE MANHOLE		MAIL BOX
	WATER METER		RIP RAP
	2-NOZZLE FIRE HYDRANT		ROCKERY
	3-NOZZLE FIRE HYDRANT		SHRUBBERY
	WATER GATE		SIGN
	SEWER CLEAN OUT		CONIFER TREE
	SEWER MANHOLE		DECIDUOUS TREE
	DRAIN MANHOLE		LIGHT POLE
	CATCH BASIN		WETLAND
	VERIZON MANHOLE		WATER FLOW
	IRRIGATION HANDHOLE		GUARD POST
	ELECTRIC HANDHOLE		PARKING METER
	ELECTRIC OUTLET		FIRE ALARM
	STREET LIGHT HANDHOLE		
	MASS HIGHWAY HANDHOLE		
	STORMWATER TREATMENT BASIN		
	TRAFFIC SIGNAL POLE		SURVEY ANGLE POINT
	TRAFFIC SIGNAL POLE W/LUMINARE		SURVEY BENCH MARK
	TRAFFIC SIGNAL SUPPORT POLE		SURVEY IRON PIPE
	FLASHING WARNING SYSTEM		MONUMENT (IN CASE)
	JUNCTION BOX		MONUMENT (SURFACE)
	R/R CROSSING GATE		BUS STOP
	SIGNAL		MAIL BOX
	SIGNAL CONTROLLER		RIP RAP
	SIGN BRIDGE		ROCKERY
	CANTILEVERED SIGN		SHRUBBERY
	SINGLE POST		SIGN
	DOUBLE POST		CONIFER TREE
	COUNTY ROAD		DECIDUOUS TREE
	INTERSTATE HIGHWAY		LIGHT POLE
	STATE HIGHWAY		WETLAND
	US HIGHWAY		WATER FLOW
	MONITORING WELL		GUARD POST

LINETYPE LEGEND

	OVERHEAD WIRES		PROPOSED BURIED CONDUIT
	BURIED ELECTRIC LINE		EASEMENT LINE
	BURIED TELEPHONE LINE		PROPERTY LINE
	BURIED CABLE TV LINE		RIGHT-OF-WAY LINE
	SANITARY SEWER LINE		STONEWALL
	STORM DRAIN LINE		
	WATER LINE		
	GAS LINE		
	RAILROAD TRACKS		
	DITCH		
	TREE LINE		
	GUARD RAIL		
	FENCE		
	RETAINING WALL		

EXISTING UTILITIES

	OVERHEAD WIRES
	BURIED ELECTRIC LINE
	BURIED TELEPHONE LINE
	BURIED CABLE TV LINE
	SANITARY SEWER LINE
	STORM DRAIN LINE
	WATER LINE
	GAS LINE

REFERENCES & NOTES

- ELECTRIC UTILITY INFORMATION PER RECORD PLANS PROVIDED BY EVERSOURCE.
- TELECOM UTILITY INFORMATION PER RECORD PLANS PROVIDED BY VERIZON, LEVEL(3), AT&T, COMCAST AND TCG.
- GAS UTILITY INFORMATION PER RECORD PLANS PROVIDED BY EVERSOURCE.
- WATER, SEWER & DRAIN UTILITY INFORMATION PER RECORD PLANS PROVIDED BY CITY OF SOMERVILLE.

SOMERVILLE
MIDDLESEX COUNTY
MASSACHUSETTS

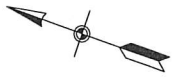

ISSUE DATE: 11/19/2020 PERMIT ISSUE
INITIALS: JCC

PRELIMINARY
NOT FOR CONSTRUCTION

NOTES:
1. SURFACE UTILITY LINES, AS SHOWN HEREON, ARE BASED ON RECORD DRAWINGS AND FIELD SURVEY INFORMATION FROM THE MAINTENANCE DEPARTMENT OF THE CITY OF SOMERVILLE. THE LOCATION AND DEPTH OF ANY UTILITIES ARE APPROXIMATE ONLY. ACTUAL LOCATIONS AND DEPTHS SHOULD BE DETERMINED BY THE CONTRACTOR PRIOR TO ANY CONSTRUCTION ACTIVITIES. THE CONTRACTOR SHALL BE RESPONSIBLE FOR ANY DAMAGE INCURRED AS A RESULT OF UTILITIES OMITTED OR MISLOCATED ON THIS PLAN.



Call before you dig.
AT&T PROPRIETARY
(Internal Use Only)

Not for disclosure outside the AT&T company without prior written agreement.

2019 AT&T Intellectual Property. All Rights Reserved.
AT&T, the AT&T logo, and the AT&T globe are trademarks of AT&T Knowledge Ventures, L.P. All other marks contained herein are trademarks of AT&T Knowledge Ventures, L.P. or AT&T Knowledge Ventures, L.P.'s direct or indirect parent company. This document is for informational purposes only. It is exempt from the Freedom of Information Act. The information contained herein is confidential and its disclosure is prohibited under the U.S.C. Trade Secrets Act. (18 U.S.C. 1835). No representation is made that the information contained herein is accurate, complete, or current. It may be subject to change without notice and is not to be copied or distributed to others without the prior written permission of AT&T. In all events, no warranty is made by AT&T, and in all events, no liability shall be incurred by AT&T for any damage or loss, including consequential damage, arising out of or from the use of the information contained herein. A copy of this document may be obtained from AT&T Knowledge Ventures, L.P. by contacting AT&T Knowledge Ventures, L.P. at 1-800-433-8300.

PREPARED FOR RECORD

APPROVED FOR: [Signature] DATE: [Date]
SUBMITTANT: [Signature] DATE: [Date]

TC SYSTEMS, INC.
An Affiliate of **AT&T**

SIENA
SOMERVILLE, MA 02143

DRAWN BY: J. CONNER
CHECKED BY: J. CONNER
DESIGNED BY: B. BARBARELLE
PROPRIETARY
UNLESS OTHERWISE NOTED
SPECIFICATIONS AND INSTRUCTIONS
PROJECT NUMBER

OWNERSHIP:
LINE CODE:
CABLE CLL:

SCALE: 1" = 30'

WASHINGTON STREET AT
MAGNUS AVENUE
SOMERVILLE, MA

PROPOSED CONDUIT
PLACEMENT PLAN

DN001

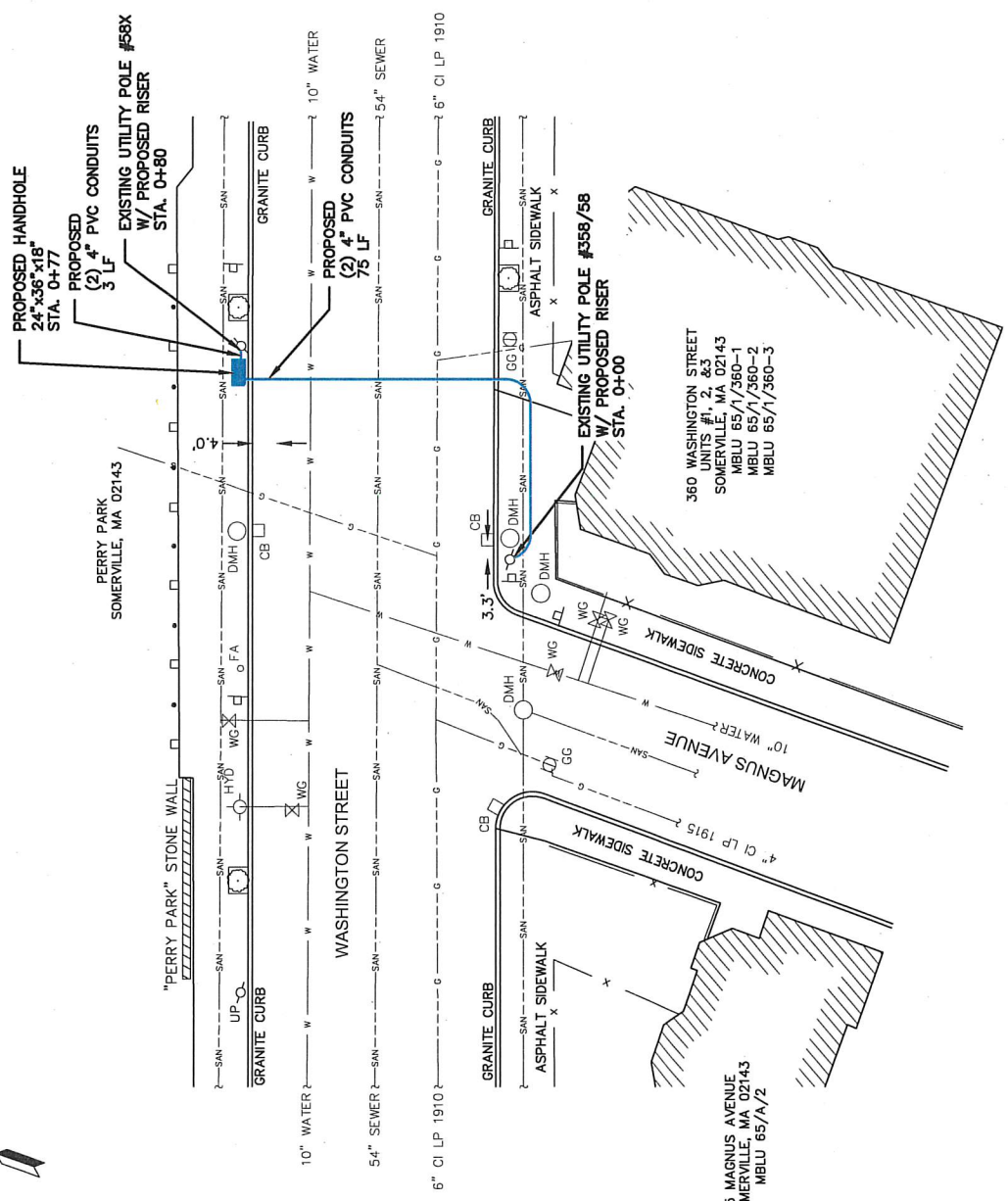

PRELIMINARY
NOT FOR CONSTRUCTION

UNDESIGNED SURFACE FINISHES, AS SHOWN HEREON, ARE FOR INFORMATION ONLY. THE CONTRACTOR SHALL VERIFY THE EXISTING CONDITIONS AND RECORD INFORMATION FROM THE REFERENCED SURVEY AND RECORDS. THE CONTRACTOR SHALL VERIFY THE LOCATION AND DEPTH OF ALL UTILITIES AND RECORD THEM IN THE RECORD DRAWINGS. THE CONTRACTOR SHALL BE RESPONSIBLE FOR OBTAINING ALL NECESSARY PERMITS AND APPROVALS FROM THE CITY OF SOMERVILLE. THE CONTRACTOR SHALL BE RESPONSIBLE FOR OBTAINING ALL NECESSARY PERMITS AND APPROVALS FROM THE CITY OF SOMERVILLE. THE CONTRACTOR SHALL BE RESPONSIBLE FOR OBTAINING ALL NECESSARY PERMITS AND APPROVALS FROM THE CITY OF SOMERVILLE.



Call before you dig.

AT&T PROPRIETARY
(Internal Use Only)

Not for disclosure outside the AT&T company, except under written agreement.

© 2019 AT&T Intellectual Property. All rights reserved.

AT&T PROPRIETARY: The Recipient shall not disclose, copy, reproduce, or disseminate confidential trade secrets and commercial or financial information owned by AT&T Intellectual Property, or its subsidiaries, to any third party without the prior written consent of AT&T Intellectual Property. This Agreement shall be governed by the laws of the State of Texas. The Recipient shall indemnify and hold AT&T Intellectual Property harmless from and against all claims, damages, and expenses, including reasonable attorneys' fees, that may be asserted against or incurred by AT&T Intellectual Property, its subsidiaries, or its agents, in connection with this Agreement.

(18 U.S.C. 1030; 18 U.S.C. 133, and any State or local law requiring disclosure of information to a third party) Information disclosed hereon by AT&T Intellectual Property, its subsidiaries, or its agents, in connection with this Agreement, is confidential and intended for the use of the Recipient only. It is exempt from disclosure under the Freedom of Information Act, 5 U.S.C. 552, and its disclosure is prohibited under the Trade Secrets Act.

PREPARED FOR RECORD
DATE: _____
DRAWN BY: _____
CHECKED BY: _____
APPROVED BY: _____
PROJECT NUMBER: _____

TC SYSTEMS, INC.
An Affiliate of AT&T



SIENA
DRAWN BY: J. CONNOR
CHECKED BY: B. DOWNWARDE
APPROVED BY: B. DOWNWARDE
PROJECT NUMBER: _____
SPECIFICATION: _____
OWNER: _____
OWNER'S PROJECT NUMBER: _____
LINE CODE: _____
CABLE COLOR: _____
SCALE: AS NOTED

WASHINGTON STREET AT
MAGNUS AVENUE
SOMERVILLE, MA

PROPOSED TRENCH & SURFACE RESTORATION DETAILS

DT001

RESTORATION REQUIREMENTS:
SUBBASE & TRENCH BACKFILL SHALL CONFORM TO CITY OF SOMERVILLE SPECIFICATIONS FOR MATERIAL, PLACEMENT & COMPACTION.

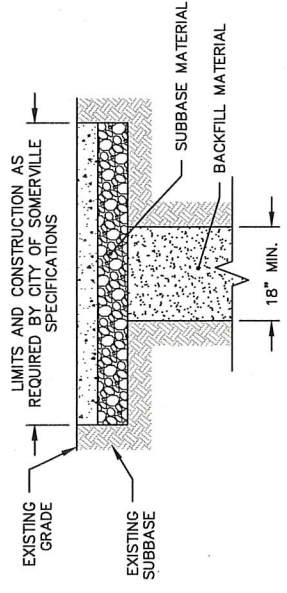

CONCRETE SIDEWALK RESTORATION DETAIL
NOT TO SCALE

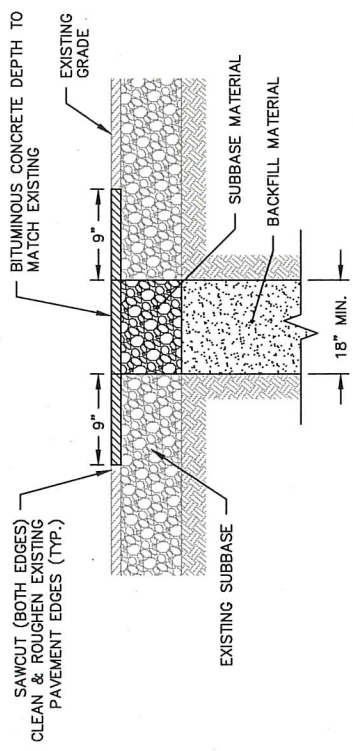

BITUMINOUS CONCRETE ROADWAY RESTORATION DETAIL
NOT TO SCALE

NOTE:
DEPTH SHALL VARY BASED UPON ENCOUNTERS WITH EXISTING UTILITIES. CONTRACTOR SHALL MAINTAIN A MINIMUM OF 24\"/>

TRENCH WIDTH DIMENSIONS SHOWN FOR CLARITY, ACTUAL WIDTH WILL DEPEND ON FIELD CONDITIONS.

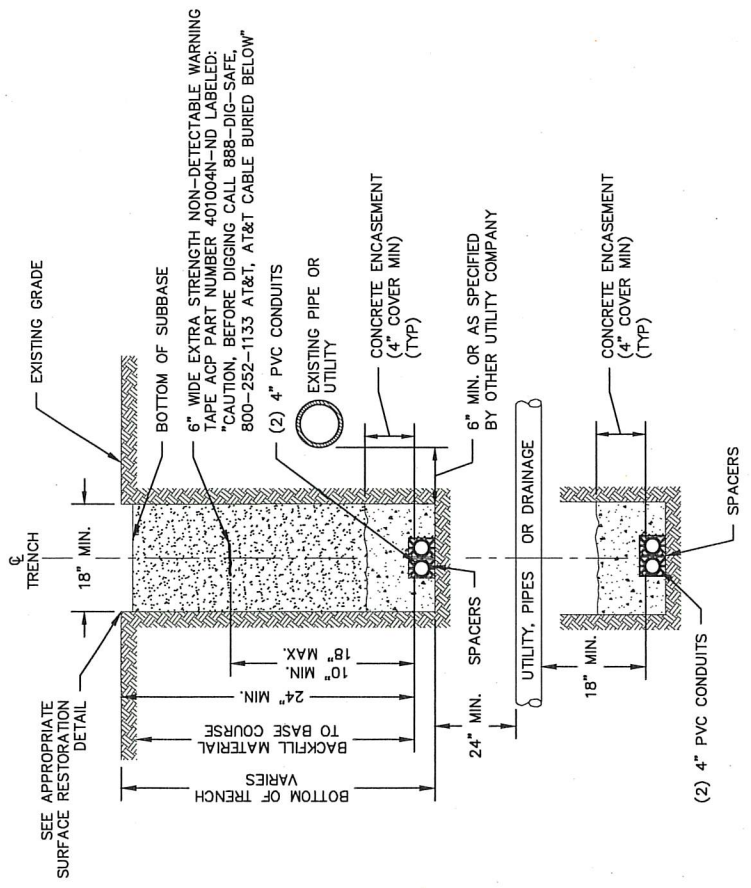

TYPICAL TRENCH DETAIL
NOT TO SCALE

**PRELIMINARY
NOT FOR CONSTRUCTION**

NOTES:
1. SUBSURFACE UTILITY LINES, AS SHOWN HEREON, ARE NOT TO BE CONSIDERED AS GUARANTEED INFORMATION FROM THE FIELD. THE CONTRACTOR SHALL VERIFY THE LOCATION AND DEPTH OF ALL UTILITIES PRIOR TO ANY CONSTRUCTION ACTIVITIES. THE CONTRACTOR SHALL BE RESPONSIBLE FOR DAMAGE INCURRED AS A RESULT OF ANY UTILITIES DAMAGED OR INCARCERATED, SHOWN.



Call before you dig.

AT&T PROPRIETARY
(Internal Use Only)

Not for disclosure outside the AT&T companies, except under written agreement.

© 2019 AT&T Intellectual Property. All rights reserved. This document contains confidential trade secrets and commercial or financial information owned by AT&T Intellectual Property. It is exempt from disclosure under the Freedom of Information Act and the disclosure is prohibited under the Trade Secrets Act (18 U.S.C. 1835). Any State or local law requiring disclosure of information may be applied to this document, but only if such law does not conflict with the provisions of this document. For more information, see the notification parameters to Executive Order 13526.

PREPARED FOR RECORD
DATE: _____
ENGINEER: _____

TC SYSTEMS, INC
An Affiliate of **AT&T**

SIENA
DESIGNED BY: J. CONNOR
CHECKED BY: B. LORWARTLE
APPROVED BY: B. LORWARTLE

PROPRIETARY
SEE PERMITMENT TO COMPANY INSTRUCTIONS
PROJECT NUMBER: _____

OWNERSHIP:
FILE CODE: _____
SCALE: AS NOTED

WASHINGTON STREET AT
MAGNUS AVENUE
SOMERVILLE, MA

PROPOSED HANDHOLE &
HANDHOLE PLACEMENT DETAILS

DT002

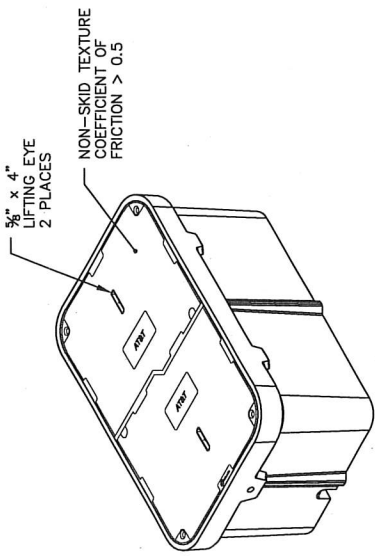

- NOTES:**
- HANDHOLES INSTALLED IN ACCORDANCE WITH THE LATEST REVISION OF AT&T STANDARD SPECIFICATIONS FOR OUTSIDE PLANT CABLE CONSTRUCTION AND REMOVAL.
 - HANDHOLE SECTIONS PROPERLY ALIGNED AND FREE OF DIRT AND STONES WHEN JOINED.
 - HANDHOLE RACKING CONFORMS WITH AT&T SPECIFICATIONS.
 - SPLICE HANDHOLES INCLUDE AC/DC FILTER PROTECTION PER AT&T SPECIFICATIONS.
 - HANDHOLE MATERIAL IS POLYMER CONCRETE.
 - HANDHOLE MANUFACTURED BY OLDCASTLE ENCLOSURE SOLUTIONS, 801 S. PINE ST., MADERA, CA 95367 1-800-486-7070. UNIT, PC2436-18.

TYPICAL HANDHOLE DETAIL - 24"x36"x18"
NOT TO SCALE

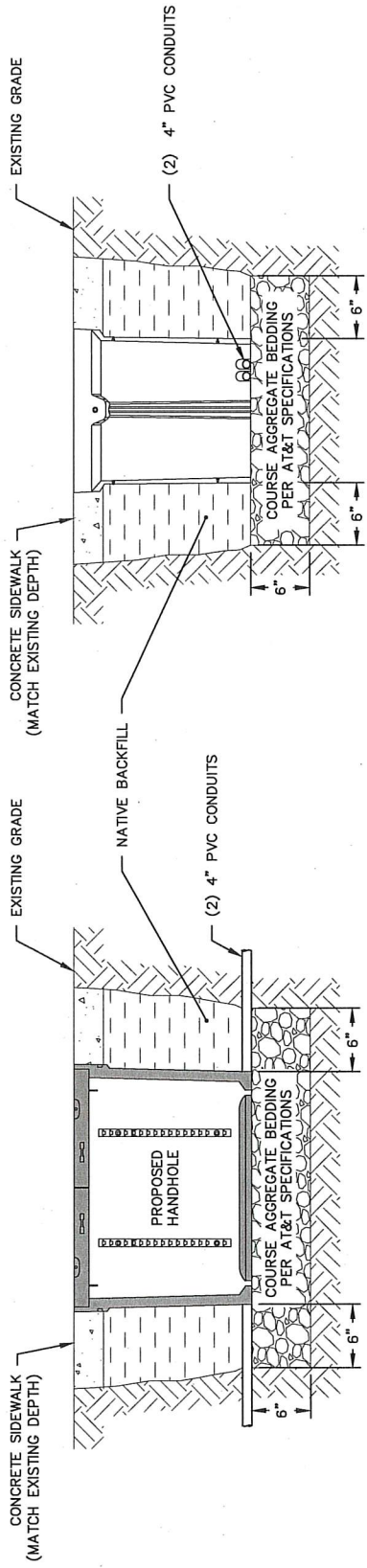

**HANDHOLE PLACEMENT DETAIL
SIDE VIEW**
NOT TO SCALE

**HANDHOLE PLACEMENT DETAIL
END VIEW**
NOT TO SCALE

**PRELIMINARY
 NOT FOR CONSTRUCTION**

NOTES:
 1. SUBMITTANT UTILITIES, AS SHOWN HEREON, ARE BASED ON RECORD DRAWINGS AND FIELD SURVEY DATA. THE SUBMITTANT IS RESPONSIBLE FOR VERIFYING THE LOCATION AND DEPTH OF ALL UTILITIES PRIOR TO ANY CONSTRUCTION ACTIVITIES. SIENA SHALL NOT BE RESPONSIBLE FOR DAMAGES INCURRED AS A RESULT OF UTILITIES DAMAGED OR INTERRUPTED BY ANY WORK SHOWN.



Call before you dig.

AT&T PROPRIETARY
 (Internal Use Only)

Not for disclosure outside the AT&T companies, except under written agreement.

© 2019 AT&T Intellectual Property. All Rights Reserved

AT&T PROPRIETARY: This information constitutes confidential trade secrets and proprietary information of AT&T Intellectual Property and is intended for Critical Infrastructure Protection purposes only. It is exempt from disclosure under the Freedom of Information Act (5 U.S.C. 552). Exemptness (b)(3)(A) and its disclosure is prohibited under the Information Act of 2002, 6 U.S.C. 133, and other applicable laws. This information must not be copied or distributed to others not authorized to receive it. This information may be modified or distributed to such others without notification pursuant to Executive Order 13526.

PREPARED FOR RECORD
 APPROVED FOR: OUTSIDE PLANT ENGINEER DATE

TC SYSTEMS, INC
 An Affiliate of **AT&T**

SIENA
 ENGINEERING GROUP, INC.
 18-14300 NODE 14 - WASHINGTON ST AT DANE ST, SOMERVILLE, MA 01908
 CHECKED BY: B. DORWART PE

APPROVED BY: B. DORWART PE
 PROPRIETARY
 USE PERMITANT TO COMPANY INSTRUCTIONS
 SPECIFICATION
 PROJECT NUMBER

OWNERSHIP:
 WORK DATE:
 SCALE: AS NOTED

WASHINGTON STREET AT
 MAGNUS AVENUE
 SOMERVILLE, MA

PROPOSED UTILITY
 RISER DETAIL

DT003

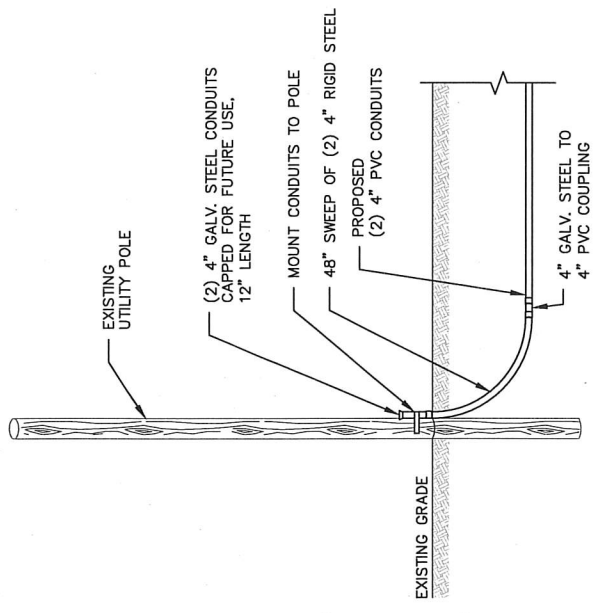

PROPOSED RISER DETAIL
 NOT TO SCALE

SOMERVILLE, MA

Map	Blo	Lot	Stree	Grantee	Co grantee-s Name	Mailing Address	City	St Zip	Use
4	C	16	353 WASHINGTON ST	KELLER ROBERT T		353 WASHINGTON ST #1	SOMERVILLE	MA 02143	1020 CONDO MDL
4	C	16	353 WASHINGTON ST	RUBINSTEIN JARED F		353 WASHINGTON ST #2	SOMERVILLE	MA 02143	1020 CONDO MDL
4	C	18	355 WASHINGTON ST	GRAF PROPERTIES LLC	C/O KURT GRAF	18 THORNTON STREET	NEWTON MA	MA 02459	0104 2 FAM MIX
4	C	19	WASHINGTON ST	CITY OF SOMERVILLE	PERRY PARK	93 HIGHLAND AVE	SOMERVILLE	MA 02143	9300 CITY VACAN
4	C	20	WASHINGTON ST	PENNEY DAN	TRACY ELIZABETH A.M.	286 SCHOOL ST	ACTON	MA 01720	1050 THREE FAM
4	C	21	WASHINGTON ST	BARCELOS BENJAMIN & LUCIA FOR L	BARCELOS MICHAEL P	365 WASHINGTON ST	SOMERVILLE	MA 02143	1050 THREE FAM
5	A	2	5 MAGNUS AVE	TRUST DINITTO REALTY	DINITTO RAYMOND & ANN TRS	4 WESTCHESTER DR	N READING	MA 01864	1050 THREE FAM
5	B	1	358 WASHINGTON ST	MUTHA HEENA & HUGHES MICHAEL		358 WASHINGTON ST UNIT 1	SOMERVILLE	MA 02143	1020 CONDO MDL
5	B	1	358 WASHINGTON ST	GARRETT RACHAEL & DOW GRAHAM		358 WASHINGTON ST #2	SOMERVILLE	MA 02143	1020 CONDO MDL
5	B	1	358 WASHINGTON ST	ROBBINS ERIKA & JEFFREY		358 WASHINGTON ST #3	SOMERVILLE	MA 02143	1020 CONDO MDL
5	B	1	360 WASHINGTON ST	VISHWANATHAN DEEPIKA		360 WASHINGTON ST 1	SOMERVILLE	MA 02143	1020 CONDO MDL
5	B	1	360 WASHINGTON ST	REYON DEEPAK		360 WASHINGTON ST. UNIT 2	SOMERVILLE	MA 02143	1020 CONDO MDL
5	B	1	360 WASHINGTON ST	WU ONA		360 WASHINGTON ST #3	SOMERVILLE	MA 02143	1020 CONDO MDL
5	B	2	3 ROSE ST	CORREIA ALVARO M & MARIA L		3 ROSE ST	SOMERVILLE	MA 02143	1050 THREE FAM