



**CITY OF SOMERVILLE**  
Commonwealth of Massachusetts  
93 Highland Avenue  
Somerville, MA 02143  
(617) 625-6600

## BUSINESS LICENSE APPLICATION - Grant of Location

File #: 24-020968

License #: BL24-000134

Address: 45 Middlesex Ave

Licensee: Robert Cassano CITY OF SOMERVILLE

DBA Name: ASTOUND BROADBAND / RCN TELECOM OF MASSACHUETTS LLC

Business Ownership Type: LLC

Legal Name of Entity: ASTOUND BROADBAND / RCN TELECOM OF MASSACHUETTS LLC

Owners/Officers: , , ,

### License Information:

**Grant of location issued to:** ASTOUND BROADBAND / RCN TELECOM OF MASSACHUETTS LLC

**Describe the reason for the work, and the intended beneficiaries:** RCN CITY NETWORK FOR FIRE STATION - to provide service to 45 Middlesex Avenue

**Insert here the same detailed description of the work as appears in the attached Grant of Location**

**Order:** Starting from MH001, install approximately 20 feet of conduit in Foley Street to a point of pickup at 45 Middlesex Avenue.

### Approved By:

**Malik Drayton, Approved with Conditions**

APPROVAL CONDITION: MD20240910: Contractor shall take all necessary precautions to avoid damaging any tree or tree part with equipment.

APPROVAL CONDITION: MD20240910: All nearby street tree(s) shall be protected prior to and during all construction activities using TREE BOX or TREE WRAPS. . TREE BOX shall be constructed from 2 in. x 4 in. lumber creating a box around the border of the tree pit with 2 in. x 4 in. lumber standing straight up at the corners and wrapped with orange snow fence. Detail attached. . TREE WRAPS (TREE TRUNK WRAPPING PROTECTION LUMBER) shall consist of 2 in. x 4 in. and 8 ft. height lumber wired together in close spacing with zip ties or 16 gauge galvanized steel wire to form a protective enclosure around tree trunks. Use burlap to separate the wood from the bark if necessary to prevent wood from scraping or bruising bark. Do not use staples or puncture the trunk in any way.

APPROVAL CONDITION: MD20240910: Any tree roots less than two (2) inches in diameter that cannot be avoided during construction shall be carefully and cleanly cut with a clean pair of pruning shears or loppers. Roots are to be cut back flush with the edge of the trench. If any tree roots greater than two (2) inches in diameter are encountered, stop work immediately and contact the City Urban Forester. Any and all pruning of roots greater than 2 inches in diameter must be completed under the supervision of the City Urban Forester.

**Eric Weisman, Approved**

**Mads Filtenborg, Approved with Conditions**

APPROVAL CONDITION 09/17/24-MF: Concrete sidewalk to be restored in-kind after conduit installation.

APPROVAL CONDITION 09/17/24-MF: Any work requiring the use of the street and/or sidewalk will

require a Street/Sidewalk Occupancy Permit from the Engineering Department. Apply via Citizen Serve before conduit installation.

APPROVAL CONDITION 09/17/24-MF: Bricks cannot be cut; brick crosswalks must be reset immediately following installation.

**Kimberly M. Wells, Approved**



CITY OF SOMERVILLE, MASSACHUSETTS  
CITY CLERK'S OFFICE

KATJANA BALLANTYNE  
MAYOR

KIMBERLY M. WELLS  
CITY CLERK

November 15, 2024

**NOTICE OF PUBLIC HEARING**

You are hereby notified that the Somerville City Council will hold a Public Hearing on the following Petition. You are receiving this Notice because the Petitioner has reported that you own property that abuts the work that is being proposed. You and other members of the public are invited to attend and be heard at this Hearing.

**This meeting of the City Council will also be conducted via remote participation, online in a webinar hosted on the Zoom platform.**

You have three ways to be heard at this meeting:

1. To attend and be heard, enter the link exactly as it appears below into your internet browser any time before the meeting. You will then be asked to register for the meeting. After registering, you will receive an email with instructions to join the webinar when it starts.
2. You may also testify in person in the City Council Chamber, City Hall, 2<sup>nd</sup> Floor, 93 Highland Avenue, Somerville, MA 02143
3. If you are unable to attend but wish to be heard, you may send written comments by US mail to the City Clerk at the address below, or by email to [publiccomments@somervillema.gov](mailto:publiccomments@somervillema.gov). Your comments must arrive no later than 12 Noon on the day of the Hearing, in order to be sure they are conveyed to the Council.

**PETITION:** RCN and the City of Somerville seek a Grant of Location to install approximately 20 feet of conduit in Middlesex Avenue, from existing manhole MH001 to a point of pickup at 45 Middlesex Avenue.

**PLACE:** [https://us02web.zoom.us/webinar/register/WN\\_5JCQCge9RPu5wYqJ8hAFfw](https://us02web.zoom.us/webinar/register/WN_5JCQCge9RPu5wYqJ8hAFfw) or City Council Chambers, City Hall, 2<sup>nd</sup> Floor, 93 Highland Avenue, Somerville, MA 02143

**TIME:** Thursday, November 26, 2024, at 7:00 PM.

**PURPOSE:** The work is necessary to provide service to 45 Middlesex Avenue.

**Legend**

Exist.	Prop.	Exist.	Prop.	Exist.	Prop.
					PROPERTY LINE
					PROJECT LIMIT LINE
					RIGHT-OF-WAY/PROPERTY LINE
					EASEMENT
					BUILDING SETBACK
					PARKING SETBACK
		27.35 TC x	27.35 TC x		BASELINE
		26.85 BC x	26.85 BC x		CONSTRUCTION LAYOUT
		132.75 x	132.75 x		SPOT ELEVATION
		45.0 TW x	45.0 TW x		TOP & BOTTOM OF WALL ELEVATION
		38.5 SW	38.5 SW		BORING LOCATION
					TEST PIT LOCATION
					MONITORING WELL
					LIMIT OF DISTURBANCE
					WETLAND LINE WITH FLAG
					FLOODPLAIN
					UNDERDRAIN
					DRAIN
					ROOF DRAIN
					SEWER
					FORCE MAIN
					OVERHEAD WIRE
					WATER
					FIRE PROTECTION
					DOMESTIC WATER
					GAS
					ELECTRIC
					STEAM
					TELEPHONE
					FIRE ALARM
					CABLE TV
					CATCH BASIN CONCENTRIC
					CATCH BASIN ECCENTRIC
					DOUBLE CATCH BASIN CONCENTRIC
					DOUBLE CATCH BASIN ECCENTRIC
					GUTTER INLET
					DRAIN MANHOLE CONCENTRIC
					DRAIN MANHOLE ECCENTRIC
					TRENCH DRAIN
					PLUG OR CAP
					CLEANOUT
					FLARED END SECTION
					HEADWALL
					SEWER MANHOLE CONCENTRIC
					SEWER MANHOLE ECCENTRIC
					CURB STOP & BOX
					WATER VALVE & BOX
					TAPPING SLEEVE, VALVE & BOX
					SIAMSESE CONNECTION
					FIRE HYDRANT
					WATER METER
					POST INDICATOR VALVE
					GAS GATE
					GAS METER
					ELECTRIC MANHOLE
					ELECTRIC METER
					LIGHT POLE
					TELEPHONE MANHOLE
					TRANSFORMER PAD
					UTILITY POLE
					GUY POLE
					GUY WIRE & ANCHOR
					HAND HOLE
					PULL BOX
					MATCHLINE

Match Line  
See Sheet C1.01

**Abbreviations**

General	
ABAN	ABANDON
ACR	ACCESSIBLE CURB RAMP
ADJ	ADJUST
APPROX	APPROXIMATE
BIT	BITUMINOUS
BS	BOTTOM OF SLOPE
BWLL	BROKEN WHITE LANE LINE
CONC	CONCRETE
DYCL	DOUBLE YELLOW CENTER LINE
EL	ELEVATION
ELEV	ELEVATION
EX	EXISTING
FN	FOUNDATION
FFE	FIRST FLOOR ELEVATION
GRAN	GRANITE
GTD	GRADE TO DRAIN
LA	LANDSCAPE AREA
LOD	LIMIT OF DISTURBANCE
MAX	MAXIMUM
MIN	MINIMUM
NIC	NOT IN CONTRACT
NTS	NOT TO SCALE
PERF	PERFORATED
PROP	PROPOSED
REM	REMOVE
RET	RETAIN
RD	ROLLING DOOR
R&D	REMOVE AND DISPOSE
R&R	REMOVE AND RESET
SWEL	SOLID WHITE EDGE LINE
SWCHL	SOLID WHITE CHANNELIZATION LINE
SWLL	SOLID WHITE LANE LINE
TS	TOP OF SLOPE
TYP	TYPICAL
Utility	
CB	CATCH BASIN
CMP	CORRUGATED METAL PIPE
CO	CLEANOUT
DCB	DOUBLE CATCH BASIN
DMH	DRAIN MANHOLE
CIP	CAST IRON PIPE
COND	CONDUIT
DIP	DUCTILE IRON PIPE
FES	FLARED END SECTION
FM	FORCE MAIN
F&G	FRAME AND GRATE
F&C	FRAME AND COVER
GI	GUTTER INLET
GT	GREASE TRAP
HDPE	HIGH DENSITY POLYETHYLENE PIPE
HH	HANDHOLE
HW	HEADWALL
HYD	HYDRANT
INV	INVERT ELEVATION
I=	INVERT ELEVATION
LP	LIGHT POLE
MES	METAL END SECTION
PIV	POST INDICATOR VALVE
PWW	PAVED WATER WAY
PVC	POLYVINYLCHLORIDE PIPE
RCP	REINFORCED CONCRETE PIPE
R=	RIM ELEVATION
RIM=	RIM ELEVATION
SMH	SEWER MANHOLE
TSV	TAPPING SLEEVE, VALVE AND BOX
UG	UNDERGROUND
UP	UTILITY POLE

**Notes**

- General**
- CONTRACTOR SHALL NOTIFY "DIG-SAFE" (1-888-344-7233) AT LEAST 72 HOURS BEFORE EXCAVATING.
  - CONTRACTOR SHALL BE RESPONSIBLE FOR SITE SECURITY AND JOB SAFETY. CONSTRUCTION ACTIVITIES SHALL BE IN ACCORDANCE WITH OSHA STANDARDS AND LOCAL REQUIREMENTS.
  - ACCESSIBLE ROUTES, PARKING SPACES, RAMPS, SIDEWALKS AND WALKWAYS SHALL BE CONSTRUCTED IN CONFORMANCE WITH THE FEDERAL AMERICANS WITH DISABILITIES ACT AND WITH STATE AND LOCAL LAWS AND REGULATIONS (WHICHEVER ARE MORE STRINGENT).
  - AREAS DISTURBED DURING CONSTRUCTION AND NOT RESTORED WITH IMPERVIOUS SURFACES (BUILDINGS, PAVEMENTS, WALKS, ETC.) SHALL RECEIVE SIX (6) INCHES LOAM AND SEED.
  - WITHIN THE LIMITS OF THE BUILDING FOOTPRINT, THE SITE CONTRACTOR SHALL PERFORM EARTHWORK OPERATIONS REQUIRED UP TO SUBGRADE ELEVATIONS.
  - WORK WITHIN THE LOCAL RIGHTS-OF-WAY SHALL CONFORM TO LOCAL MUNICIPAL STANDARDS. WORK WITHIN STATE RIGHTS-OF-WAY SHALL CONFORM TO THE LATEST EDITION OF THE STATE HIGHWAY DEPARTMENTS STANDARD SPECIFICATIONS FOR HIGHWAYS AND BRIDGES.
  - UPON AWARD OF CONTRACT, CONTRACTOR SHALL MAKE NECESSARY CONSTRUCTION NOTIFICATIONS AND APPLY FOR AND OBTAIN NECESSARY PERMITS, PAY FEES, AND POST BONDS ASSOCIATED WITH THE WORK INDICATED ON THE DRAWINGS, IN THE SPECIFICATIONS, AND IN THE CONTRACT DOCUMENTS. DO NOT CLOSE OR OBSTRUCT ROADWAYS, SIDEWALKS, AND FIRE HYDRANTS, WITHOUT APPROPRIATE PERMITS.
  - TRAFFIC SIGNAGE AND PAVEMENT MARKINGS SHALL CONFORM TO THE MANUAL ON UNIFORM TRAFFIC CONTROL DEVICES.
  - AREAS OUTSIDE THE LIMITS OF PROPOSED WORK DISTURBED BY THE CONTRACTOR'S OPERATIONS SHALL BE RESTORED BY THE CONTRACTOR TO THEIR ORIGINAL CONDITION AT THE CONTRACTOR'S EXPENSE.
  - IN THE EVENT THAT SUSPECTED CONTAMINATED SOIL, GROUNDWATER, AND OTHER MEDIA ARE ENCOUNTERED DURING EXCAVATION AND CONSTRUCTION ACTIVITIES BASED ON VISUAL, OLFACTORY, OR OTHER EVIDENCE, THE CONTRACTOR SHALL STOP WORK IN THE VICINITY OF THE SUSPECT MATERIAL TO AVOID FURTHER SPREADING OF THE MATERIAL, AND SHALL NOTIFY THE OWNER IMMEDIATELY SO THAT THE APPROPRIATE TESTING AND SUBSEQUENT ACTION CAN BE TAKEN.
  - CONTRACTOR SHALL PREVENT DUST, SEDIMENT, AND DEBRIS FROM EXITING THE SITE AND SHALL BE RESPONSIBLE FOR CLEANUP, REPAIRS AND CORRECTIVE ACTION IF SUCH OCCURS.
  - DAMAGE RESULTING FROM CONSTRUCTION LOADS SHALL BE REPAIRED BY THE CONTRACTOR AT NO ADDITIONAL COST TO OWNER.
  - CONTRACTOR SHALL CONTROL STORMWATER RUNOFF DURING CONSTRUCTION TO PREVENT ADVERSE IMPACTS TO OFF-SITE AREAS, AND SHALL BE RESPONSIBLE TO REPAIR RESULTING DAMAGES, IF ANY, AT NO COST TO OWNER.
- Layout and Materials**
- DIMENSIONS ARE FROM THE FACE OF CURB, FACE OF BUILDING, FACE OF WALL, AND CENTER LINE OF PAVEMENT MARKINGS, UNLESS OTHERWISE NOTED.
  - CURB RADI ARE THREE (3) FEET UNLESS OTHERWISE NOTED.
  - CURBING SHALL BE VERTICAL GRANITE CURB (VGC) UNLESS OTHERWISE INDICATED ON THE PLANS.
  - SEE ARCHITECTURAL DRAWINGS FOR EXACT BUILDING DIMENSIONS AND DETAILS CONTIGUOUS TO THE BUILDING, INCLUDING SIDEWALKS, RAMPS, BUILDING ENTRANCES, STAIRWAYS, UTILITY PENETRATIONS, CONCRETE DOOR PADS, COMPACTOR PAD, LOADING DOCKS, BOLLARDS, ETC.
  - PROPOSED BOUNDS AND ANY EXISTING PROPERTY LINE MONUMENTATION DISTURBED DURING CONSTRUCTION SHALL BE SET OR RESET BY A PROFESSIONAL LAND SURVEYOR.
  - PRIOR TO START OF CONSTRUCTION, CONTRACTOR SHALL VERIFY EXISTING PAVEMENT ELEVATIONS AT INTERFACE WITH PROPOSED PAVEMENTS, AND EXISTING GROUND ELEVATIONS ADJACENT TO DRAINAGE OUTLETS TO ASSURE PROPER TRANSITIONS BETWEEN EXISTING AND PROPOSED FACILITIES.
- Demolition**
- CONTRACTOR SHALL REMOVE AND DISPOSE OF EXISTING MANMADE SURFACE FEATURES WITHIN THE LIMIT OF WORK INCLUDING BUILDINGS, STRUCTURES, PAVEMENTS, SLABS, CURBING, FENCES, UTILITY POLES, SIGNS, ETC. UNLESS INDICATED OTHERWISE ON THE DRAWINGS. REMOVE AND DISPOSE OF EXISTING UTILITIES, FOUNDATIONS AND UNSUITABLE MATERIAL BENEATH AND FOR A DISTANCE OF 10 FEET BEYOND THE PROPOSED BUILDING FOOTPRINT INCLUDING EXTERIOR COLUMNS.
  - EXISTING UTILITIES SHALL BE TERMINATED UNLESS OTHERWISE NOTED. IN CONFORMANCE WITH LOCAL, STATE AND INDIVIDUAL UTILITY COMPANY STANDARD SPECIFICATIONS AND DETAILS, THE CONTRACTOR SHALL COORDINATE UTILITY SERVICE DISCONNECTS WITH THE UTILITY REPRESENTATIVES.
  - CONTRACTOR SHALL DISPOSE OF DEMOLITION DEBRIS IN ACCORDANCE WITH APPLICABLE FEDERAL, STATE AND LOCAL REGULATIONS, ORDINANCES AND STATUTES.
  - THE DEMOLITION LIMITS DEPICTED IN THE PLANS IS INTENDED TO AID THE CONTRACTOR DURING THE BIDDING AND CONSTRUCTION PROCESS AND IS NOT INTENDED TO DEPICT EACH AND EVERY ELEMENT OF DEMOLITION. THE CONTRACTOR IS RESPONSIBLE FOR IDENTIFYING THE DETAILED SCOPE OF DEMOLITION BEFORE SUBMITTING ITS BID/PROPOSAL TO PERFORM THE WORK AND SHALL MAKE NO CLAIMS AND SEEK NO ADDITIONAL COMPENSATION FOR CHANGED CONDITIONS OR UNFORESEEN OR LATENT SITE CONDITIONS RELATED TO ANY CONDITIONS DISCOVERED DURING EXECUTION OF THE WORK.
  - UNLESS OTHERWISE SPECIFICALLY PROVIDED ON THE PLANS OR IN THE SPECIFICATIONS, THE ENGINEER HAS NOT PREPARED DESIGNS FOR AND SHALL HAVE NO RESPONSIBILITY FOR THE PRESENCE, DISCOVERY, REMOVAL, ABATEMENT OR DISPOSAL OF HAZARDOUS MATERIALS, TOXIC WASTES OR POLLUTANTS AT THE PROJECT SITE. THE ENGINEER SHALL NOT BE RESPONSIBLE FOR ANY CLAIMS OF LOSS, DAMAGE, EXPENSE, DELAY, INJURY OR DEATH ARISING FROM THE PRESENCE OF HAZARDOUS MATERIAL AND CONTRACTOR SHALL INDEMNIFY AND HOLD HARMLESS THE ENGINEER FROM ANY CLAIMS MADE IN CONNECTION THEREWITH. MOREOVER, THE ENGINEER SHALL HAVE NO ADMINISTRATIVE OBLIGATIONS OF ANY TYPE WITH REGARD TO ANY CONTRACTOR AMENDMENT INVOLVING THE ISSUES OF PRESENCE, DISCOVERY, REMOVAL, ABATEMENT OR DISPOSAL OF ASBESTOS OR OTHER HAZARDOUS MATERIALS.
- Erosion Control**
- PRIOR TO STARTING ANY OTHER WORK ON THE SITE, THE CONTRACTOR SHALL NOTIFY APPROPRIATE AGENCIES AND SHALL INSTALL EROSION CONTROL MEASURES AS SHOWN ON THE PLANS AND AS IDENTIFIED IN FEDERAL, STATE, AND LOCAL APPROVAL DOCUMENTS PERTAINING TO THIS PROJECT.
  - CONTRACTOR SHALL INSPECT AND MAINTAIN EROSION CONTROL MEASURES ON A WEEKLY BASIS (MINIMUM) OR AS REQUIRED PER THE STORMWATER POLLUTION PREVENTION PLAN (SWPPP). THE CONTRACTOR SHALL ADDRESS DEFICIENCIES AND MAINTENANCE ITEMS WITHIN TWENTY-FOUR HOURS OF INSPECTION. CONTRACTOR SHALL PROPERLY DISPOSE OF SEDIMENT SUCH THAT IT DOES NOT ENCUMBER OTHER DRAINAGE STRUCTURES AND PROTECTED AREAS.
  - CONTRACTOR SHALL BE FULLY RESPONSIBLE TO CONTROL CONSTRUCTION SUCH THAT SEDIMENTATION SHALL NOT AFFECT REGULATORY PROTECTED AREAS, WHETHER SUCH SEDIMENTATION IS CAUSED BY WATER, WIND, OR DIRECT DEPOSIT.
  - CONTRACTOR SHALL PERFORM CONSTRUCTION SEQUENCING SUCH THAT EARTH MATERIALS ARE EXPOSED FOR A MINIMUM OF TIME BEFORE THEY ARE COVERED, SEEDED, OR OTHERWISE STABILIZED TO PREVENT EROSION.
  - UPON COMPLETION OF CONSTRUCTION AND ESTABLISHMENT OF PERMANENT GROUND COVER, CONTRACTOR SHALL REMOVE AND DISPOSE OF EROSION CONTROL MEASURES AND CLEAN SEDIMENT AND DEBRIS FROM ENTIRE DRAINAGE AND SEWER SYSTEMS.
- Existing Conditions Information**
- BASE PLAN: THE PROPERTY LINES SHOWN WERE DETERMINED BY AN ACTUAL FIELD SURVEY CONDUCTED BY VHB, INC. IN OCTOBER 2017 AND FROM DEEDS AND PLANS OF RECORD. THE TOPOGRAPHY AND PHYSICAL FEATURES ARE BASED ON AN ACTUAL FIELD SURVEY PERFORMED ON THE GROUND BY VHB, INC. IN OCTOBER 2017 AND UPDATED IN DECEMBER OF 2018.
  - TOPOGRAPHY: HORIZONTAL DATUM ARE BASED ON MASS GRID SYSTEM, NAD 1983. ELEVATIONS SHOWN ON THE PLANS HEREON REFER TO NGVD OF 1929.
- Document Use**
- THESE PLANS AND CORRESPONDING CADD DOCUMENTS ARE INSTRUMENTS OF PROFESSIONAL SERVICE, AND SHALL NOT BE USED, IN WHOLE OR IN PART, FOR ANY PURPOSE OTHER THAN FOR WHICH IT WAS CREATED WITHOUT THE EXPRESSED, WRITTEN CONSENT OF VHB. ANY UNAUTHORIZED USE, REUSE, MODIFICATION OR ALTERATION, INCLUDING AUTOMATED CONVERSION OF THIS DOCUMENT SHALL BE AT THE USER'S SOLE RISK WITHOUT LIABILITY OR LEGAL EXPOSURE TO VHB.
  - CONTRACTOR SHALL NOT RELY SOLELY ON ELECTRONIC VERSIONS OF PLANS, SPECIFICATIONS, AND DATA FILES THAT ARE OBTAINED FROM THE DESIGNERS, BUT SHALL VERIFY LOCATION OF PROJECT FEATURES IN ACCORDANCE WITH THE PAPER COPIES OF THE PLANS AND SPECIFICATIONS THAT ARE SUPPLIED AS PART OF THE CONTRACT DOCUMENTS.
  - SYMBOLS AND LEGENDS OF PROJECT FEATURES ARE GRAPHIC REPRESENTATIONS AND ARE NOT NECESSARILY SCALED TO THEIR ACTUAL DIMENSIONS OR LOCATIONS ON THE DRAWINGS. THE CONTRACTOR SHALL REFER TO THE DETAIL SHEET DIMENSIONS, MANUFACTURERS' LITERATURE, SHOP DRAWINGS AND FIELD MEASUREMENTS OF SUPPLIED PRODUCTS FOR LAYOUT OF THE PROJECT FEATURES.
- Utilities**
- THE LOCATIONS, SIZES, AND TYPES OF EXISTING UTILITIES ARE SHOWN AS AN APPROXIMATE REPRESENTATION ONLY. THE OWNER OR ITS REPRESENTATIVE(S) HAVE NOT INDEPENDENTLY VERIFIED THIS INFORMATION AS SHOWN ON THE PLANS. THE UTILITY INFORMATION SHOWN DOES NOT GUARANTEE THE ACTUAL EXISTENCE, SERVICEABILITY, OR OTHER DATA CONCERNING THE UTILITIES, NOR DOES IT GUARANTEE AGAINST THE POSSIBILITY THAT ADDITIONAL UTILITIES MAY BE PRESENT THAT ARE NOT SHOWN ON THE PLANS. PRIOR TO ORDERING MATERIALS AND BEGINNING CONSTRUCTION, THE CONTRACTOR SHALL VERIFY AND DETERMINE THE EXACT LOCATIONS, SIZES, AND ELEVATIONS OF THE POINTS OF CONNECTIONS TO EXISTING UTILITIES AND, SHALL CONFIRM THAT THERE ARE NO INTERFERENCES WITH EXISTING UTILITIES AND THE PROPOSED UTILITY ROUTES, INCLUDING ROUTES WITHIN THE PUBLIC RIGHTS OF WAY.
  - WHERE AN EXISTING UTILITY IS FOUND TO CONFLICT WITH THE PROPOSED WORK, OR EXISTING CONDITIONS DIFFER FROM THOSE SHOWN SUCH THAT THE WORK CANNOT BE COMPLETED AS INTENDED, THE LOCATION, ELEVATION, AND SIZE OF THE UTILITY SHALL BE ACCURATELY DETERMINED WITHOUT DELAY BY THE CONTRACTOR, AND THE INFORMATION FURNISHED IN WRITING TO THE OWNER'S REPRESENTATIVE FOR THE RESOLUTION OF THE CONFLICT AND CONTRACTOR'S FAILURE TO NOTIFY PRIOR TO PERFORMING ADDITIONAL WORK RELEASES OWNER FROM OBLIGATIONS FOR ADDITIONAL PAYMENTS WHICH OTHERWISE MAY BE WARRANTED TO RESOLVE THE CONFLICT.
  - SET CATCH BASIN RIMS, AND INVERTS OF SEWERS, DRAINS, AND DITCHES IN ACCORDANCE WITH ELEVATIONS ON THE GRADING AND UTILITY PLANS.
    - PAVEMENTS AND CONCRETE SURFACES: FLUSH
    - ALL SURFACES ALONG ACCESSIBLE ROUTES: FLUSH
    - LANDSCAPE, LOAM AND SEED, AND OTHER EARTH SURFACE AREAS: ONE INCH ABOVE SURROUNDING AREA AND TAPER EARTH TO THE RIM ELEVATION.
  - THE LOCATION, SIZE, DEPTH, AND SPECIFICATIONS FOR CONSTRUCTION OF PROPOSED PRIVATE UTILITY SERVICES SHALL BE INSTALLED ACCORDING TO THE REQUIREMENTS PROVIDED BY, AND APPROVED BY, THE RESPECTIVE UTILITY COMPANY (GAS, TELEPHONE, ELECTRIC, FIRE ALARM, ETC.), FINAL DESIGN LOADS AND LOCATIONS TO BE COORDINATED WITH OWNER AND ARCHITECT.
  - CONTRACTOR SHALL MAKE ARRANGEMENTS FOR AND SHALL BE RESPONSIBLE FOR PAYING FEES FOR POLE RELOCATION AND FOR THE ALTERATION AND ADJUSTMENT OF GAS, ELECTRIC, TELEPHONE, FIRE ALARM, AND ANY OTHER PRIVATE UTILITIES, WHETHER WORK IS PERFORMED BY CONTRACTOR OR BY THE UTILITIES COMPANY.
  - UTILITY PIPE MATERIALS SHALL BE AS FOLLOWS, UNLESS OTHERWISE NOTED ON THE PLAN:
    - WATER PIPES SHALL BE CEMENT LINED DUCTILE IRON (DIP) CLASS 52
    - SANITARY SEWER PIPES SHALL BE SDR 35 POLYVINYL CHLORIDE (PVC) SEWER PIPE
    - STORM DRAINAGE PIPES SHALL BE REINFORCED CONCRETE PIPE (RCP); ALL PIPES 18 INCHES AND SMALLER SHALL BE CLASS V. ALL OTHER PIPES SHALL BE CLASS III UNLESS INDICATED OTHERWISE ON THE PLANS.
    - PIPE INSTALLATION AND MATERIALS SHALL COMPLY WITH THE STATE PLUMBING CODE WHERE APPLICABLE. CONTRACTOR SHALL COORDINATE WITH LOCAL PLUMBING INSPECTOR PRIOR TO BEGINNING WORK.
  - CONTRACTOR SHALL COORDINATE WITH ELECTRICAL CONTRACTOR AND SHALL FURNISH EXCAVATION, INSTALLATION, AND BACKFILL OF ELECTRICAL FURNISHED STEWOREK RELATED ITEMS SUCH AS PULL BOXES, CONDUITS, DUCT BANKS, LIGHT POLE BASES, AND CONCRETE PADS. SITE CONTRACTOR SHALL FURNISH CONCRETE ENCASMENT OF DUCT BANKS IF REQUIRED BY THE UTILITY COMPANY AND AS INDICATED ON THE DRAWINGS.
  - CONTRACTOR SHALL EXCAVATE AND BACKFILL TRENCHES FOR GAS IN ACCORDANCE WITH GAS COMPANY'S REQUIREMENTS.
  - ALL DRAINAGE AND SANITARY STRUCTURE INTERIOR DIAMETERS (4" MIN) SHALL BE DETERMINED BY THE MANUFACTURER BASED ON THE PIPE CONFIGURATIONS SHOWN ON THESE PLANS AND LOCAL MUNICIPAL STANDARDS. FOR MANHOLES THAT ARE 20 FEET IN DEPTH AND GREATER, THE MINIMUM DIAMETER SHALL BE 5 FEET.



City of Somerville

**ASSEMBLY SQUARE FIRE HOUSE**

45 Middlesex Ave, Somerville, MA 02145

**CambridgeSeven**

Architects and Planners  
1050 Massachusetts Avenue  
Cambridge, MA 02138  
617 492-7000 Fax 492-7007



101 Walnut Street  
PO Box 9151  
Watertown, MA 02471  
617.924.1770

No.	Description	Date
-----	-------------	------

**BID DOCUMENTS**

Job #	2116.002
Project	ASSEMBLY SQUARE FIRE HOUSE
Drawn By	Checked
Date	9.18.2023
Scale	As indicated

**LEGEND AND GENERAL NOTES**

**C01.00**



City of Somerville

ASSEMBLY SQUARE FIRE HOUSE

45 Middlesex Ave, Somerville, MA 02145

CambridgeSeven

Architects and Planners  
1050 Massachusetts Avenue  
Cambridge, MA 02138  
617 492-7000 Fax 492-7007



101 Walnut Street  
PO Box 9151  
Watertown, MA 02471  
617.924.1770

No.	Description	Date
-----	-------------	------

BID DOCUMENTS

Job #	2116.002
Project	ASSEMBLY SQUARE FIRE HOUSE
Drawn By	Checked
Date	9.18.2023
Scale	As indicated

LAYOUT AND MATERIALS PLAN

C02.00

\\vhb\gbl\proj\Wal-LD14000-10\cambridge7 fire station\cad\l\Plans\set\DD1400010\_LM.dwg P:\Man 6/15/2023 11:15:31 AM

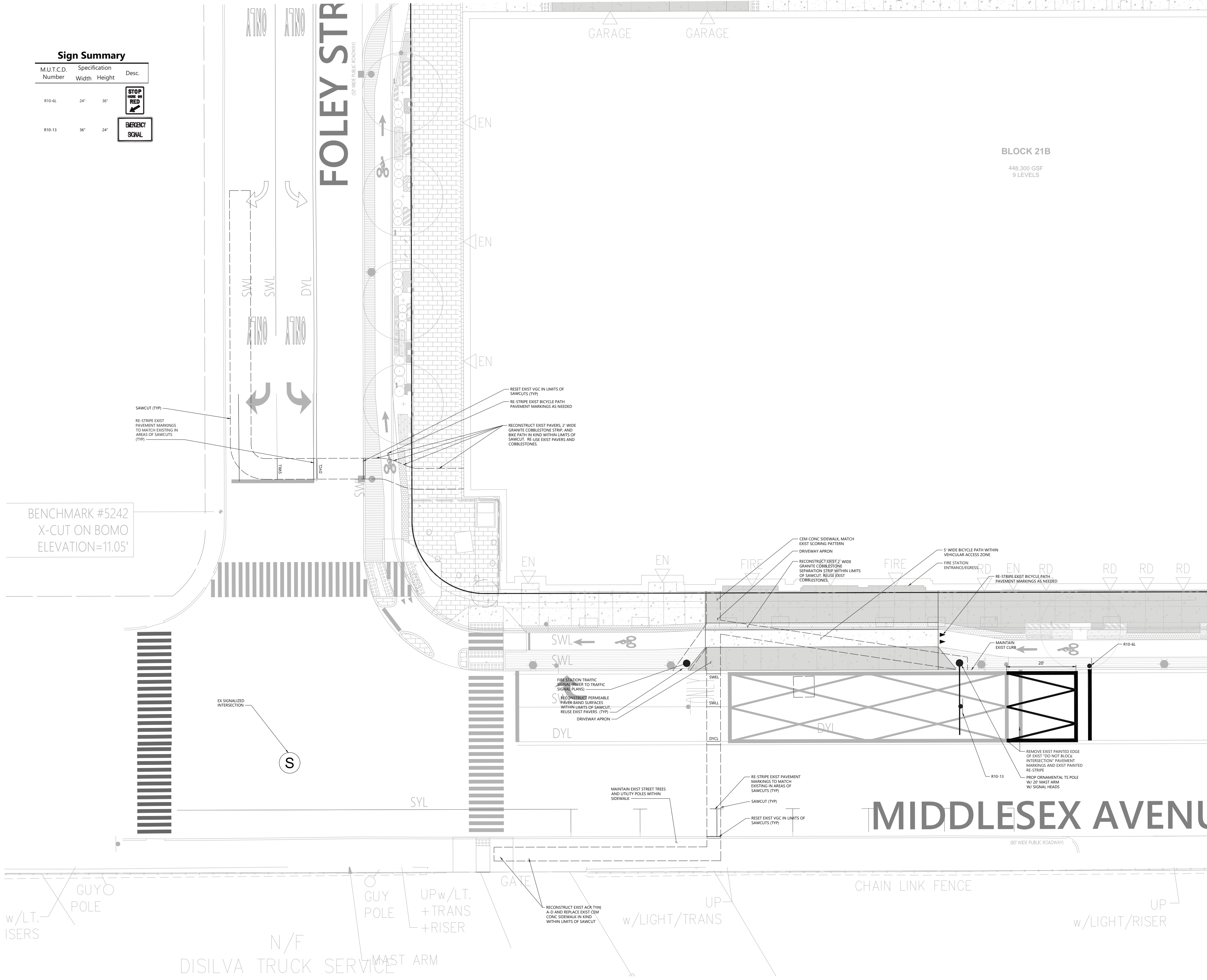

BLOCK 21B  
448,300 GSF  
9 LEVELS

**Sign Summary**

M.U.T.C.D. Number	Specification Width	Height	Desc.
R10-6L	24"	36"	
R10-13	36"	24"	

BENCHMARK #5242  
X-CUT ON BOMO  
ELEVATION=11.05'

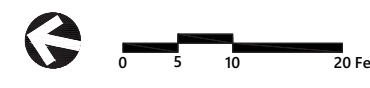

MIDDLESEX AVENUE

N/F DISILVA TRUCK SERVICE

CHAIN LINK FENCE

w/LIGHT/RISER

w/LIGHT/TRANS

UP w/LT. + TRANS + RISER

GUYO POLE

MAST ARM

GATE

w/LT. ISERS

\\hgl\proj\Wor\LD\14000\10\_cambridge7\_fire\_station\cad\plans\set\DD1\4000\10\_UT.dwg P:\Mar 6/15/2023 9:28:01 AM

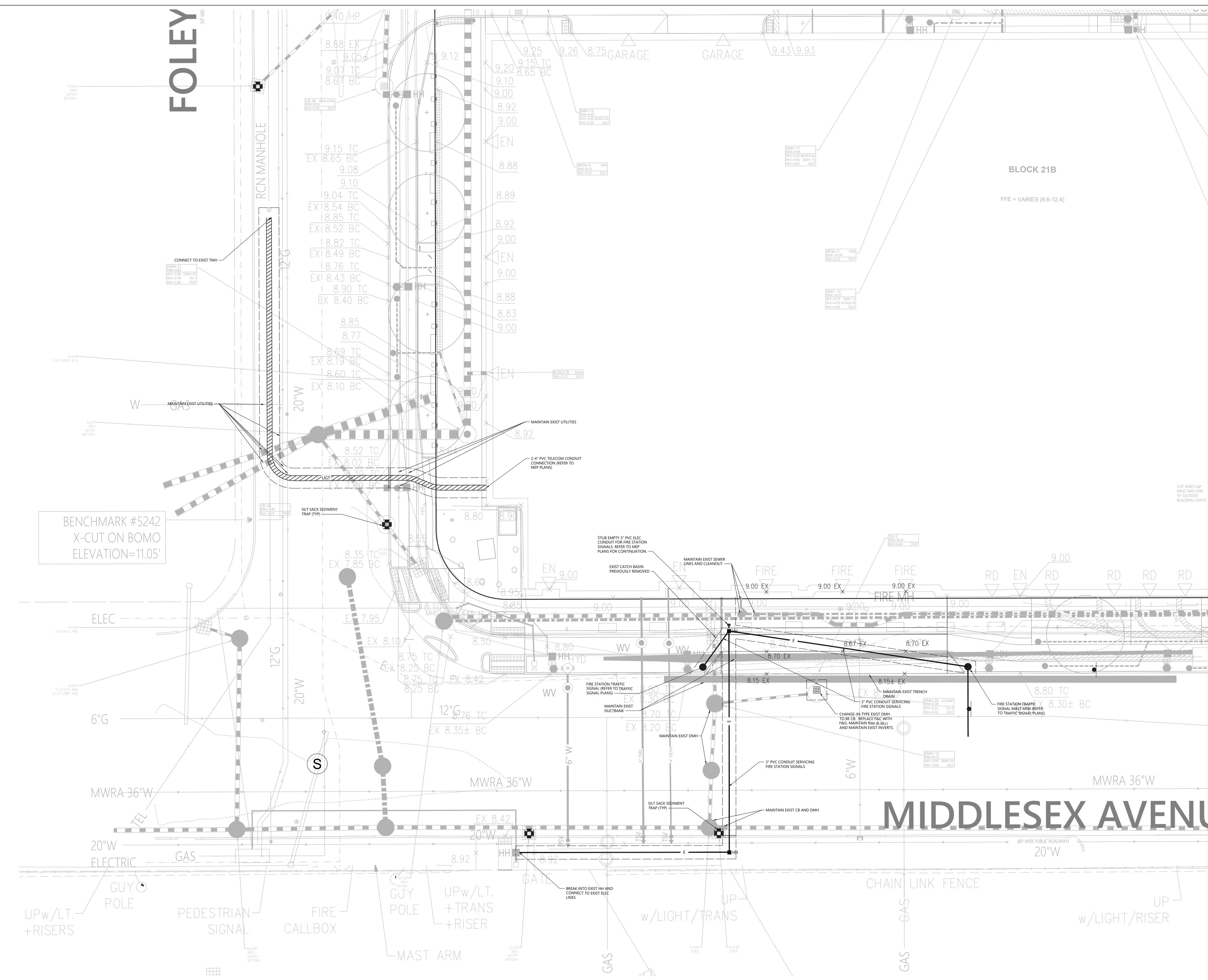

City of Somerville

**ASSEMBLY SQUARE  
FIRE HOUSE**  
45 Middlesex Ave, Somerville, MA 02145

**CambridgeSeven**  
Architects and Planners  
1050 Massachusetts Avenue  
Cambridge, MA 02138  
617 492-7000 Fax 492-7007



101 Walnut Street  
PO Box 9151  
Watertown, MA 02471  
617.924.1770

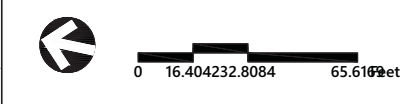

No.	Description	Date
-----	-------------	------

**BID DOCUMENTS**

Job #	2116.002
Project	ASSEMBLY SQUARE FIRE HOUSE
Drawn By	Checked
Date	9.18.2023
Scale	As indicated

Drawing Title:  
**GRADING AND  
UTILITY PLAN**

**C03.00**



City of Somerville

**ASSEMBLY SQUARE FIRE HOUSE**

45 Middlesex Ave, Somerville, MA 02145

**CambridgeSeven**

Architects and Planners  
1050 Massachusetts Avenue  
Cambridge, MA 02138  
617 492-7000 Fax 492-7007



101 Walnut Street  
PO Box 9151  
Watertown, MA 02471  
617.924.1770

**EXIST VIDEO DETECTION DATA**

DETECTION ZONE	APPROACH/LANE	CAMERA	DELAY /TEXT	CALL PHASE	UTILIZATION PHASE
1	MIDDLESEX AVE SB LEFT-TURN LANE (FRONT)	C1	0	Ø1	-
2	MIDDLESEX AVE SB LEFT-TURN LANE (BACK)	C1	0	Ø6	-
3	MIDDLESEX AVE SB THRU LANE	C1	0	Ø6	-
4	MIDDLESEX AVE NB THRU LANE	C1	0	Ø2	-
5	MIDDLESEX AVE NB RIGHT LANE	C1	0	Ø2	-
6	FOLEY ST WB LEFT LANE	C1	0	Ø4	-
7	FOLEY ST WB RIGHT LANE	C1	5 SEC DELAY	Ø4	-
8	MIDDLESEX AVE SB BIKE LANE	C1	0	Ø6	-
17	MIDDLESEX AVE SB LEFT-TURN LANE	C1	0	-	Ø1
18	MIDDLESEX AVE SB THRU LANE	C1	0	-	Ø6
19	MIDDLESEX AVE NB THRU LANE	C1	0	-	Ø2
20	MIDDLESEX AVE NB RIGHT TURN LANE	C1	0	-	Ø2
21	FOLEY ST WB LEFT TURN LANE	C1	0	-	Ø4
22	FOLEY ST WB RIGHT LANE	C1	0	-	Ø4
23	FOLEY ST EB DEPARTURE	C1	0	-	COUNTING

IDENTIFICATION NUMBER	SIZE OF SIGN		TEXT
	WIDTH	HEIGHT	
R10-6L	24"	36"	
R10-13	36"	24"	

**EXIST/PROP PRE-EMPTION PHASING & PRIORITY**

DETECTOR & PRIORITY	PRE-EMPT PHASE ASSIGNMENT	MOVEMENT	VEHICLE PHASE ASSIGNMENT
HARDWIRE	1		Ø2
D1	2		Ø2
D2	3		Ø1&Ø6
D3	4		Ø4

- PROPOSED/EXISTING EMERGENCY VEHICLE PRE-EMPTION OPERATION.**
- EMERGENCY VEHICLE PRE-EMPTION SIGNALS SHALL BE OPTICALLY TRANSMITTED BY OPTICAL EMITTERS MOUNTED IN EMERGENCY VEHICLES AND RECEIVED BY OPTICAL DETECTORS LOCATED AT EACH INTERSECTION.
  - PRE-EMPTION SIGNALS SHALL BE SERVICED ON A FIRST COME, FIRST SERVE BASIS.
  - IN RESPONSE TO A PRE-EMPTION SIGNAL RECEIVED AT AN INTERSECTION BY OPTICAL DETECTOR D1 (OR D2, D3) THE CONTROLLER SHALL HOLD OR ADVANCE TO AND HOLD IN EMERGENCY VEHICLE PRE-EMPTION PHASE #1 (OR #2, #3) GREEN FOR A MINIMUM OF TEN (10) SECONDS OR UNTIL PRE-EMPTION SIGNAL CEASES. THE CONTROLLER SHALL THEN TIME PRE-EMPTION PHASE CLEARANCES FOR THE ASSOCIATED PHASE(S) AS SHOWN IN THE SEQUENCE AND TIMING CHART AND SERVICE SUBSEQUENT EMERGENCY VEHICLE PRE-EMPTION PHASES AS NECESSARY.
  - UNLESS OTHERWISE STATED, ONCE A PRE-EMPTION CALL HAS BEEN RECEIVED BY THE TRAFFIC SIGNAL CONTROLLER AND THE PRE-EMPTION PHASE IS BEING PROVIDED GREEN AND NORMAL VEHICLE/PEDESTRIAN CLEARANCE SHALL BE TERMINATED. IT SHALL REMAIN IN THAT PHASE AS LONG AS THE CALL IS PRESENT. ON PHASES THAT ARE TO BE TERMINATED BY PRE-EMPTION DEMAND, PRE-EMPTION STROBE SHALL BE ILLUMINATED WHENEVER ANY EMERGENCY VEHICLE PRE-EMPTION SHALL OVERRIDE COORDINATION. EMERGENCY VEHICLE PRE-EMPTION GREEN IS ON.
  - HARDWIRE PRE-EMPTION SHALL OVERRIDE OPTICAL BASED PRE-EMPTION.**

EXIST SINGLE POINT VIDEO DETECTION CAMERA (GRIDSART)

**PROPOSED/EXISTING SIGNAL HEAD DATA**

APPROACH	DIRECTION	HOUSING	1	2	3	4	5	6	7	8	9	10	11	12	13	14	15	FLASHING OPERATION	FIRE PRE-EMPTION			
MIDDLESEX AVENUE	NB	A,B	R	R	R	G	Y	R	R	R	R	R	R	R	R	R	R	FY	PRE-CLEAR	HOLD	CLEAR	ALL RED
MIDDLESEX AVENUE	NB	H	R	R	R	G	Y	R	R	R	R	R	R	R	R	R	R	FY	R	G	Y	R
MIDDLESEX AVENUE	SB	C	R	R	R	R	R	R	R	R	R	R	R	R	R	R	R	FY	R	R	R	R
MIDDLESEX AVENUE	SB	D	R	R	R	R	R	R	R	R	R	R	R	R	R	R	R	FY	R	R	R	R
FOLEY STREET	WB	E,F	R	R	R	R	R	R	R	R	R	R	R	R	R	R	R	FR	R	R	R	R
FOLEY STREET	WB	G	R	R	R	R	R	R	R	R	R	R	R	R	R	R	R	FR	R	R	R	R
MIDDLESEX AVENUE	NB	J,K	FY	FY	FY	FY	FY	FY	FY	FY	FY	FY	FY	FY	FY	FY	FY	FY	Y	R	R	R
FIRE STATION DWY	EB	L,M	R	R	R	R	R	R	R	R	R	R	R	R	R	R	R	FR	R	G	R	R
PEDESTRIAN X-ING	ALL	P1-P6	DW	DW	DW	DW	DW	DW	W	FDW	DW	DW	DW	DW	DW	DW	DW	OUT	DW	DW	DW	DW
DETECTOR			NON-LOCK		NON-LOCK		-		NON-LOCK		NON-LOCK		-		-		-					
RECALL			OFF		SOFT		-		OFF		SOFT		-		-		-					

- NOTES:**
- AUTOMATIC FLASHING OPERATION PER M.U.T.C.D. SECTION 4D.12.
  - \* UPON PEDESTRIAN PUSH BUTTON ACTUATION
  - PERM = PERMISSIVE
  - MAXIMUM 1 = NORMAL OPERATION
  - MAXIMUM 2 = NOT USED
  - OL = OVERLAP
  - = HOLD TIME TO BE DETERMINED BY THE FIRE CHIEF

**EXISTING PREFERENTIAL PHASE SEQUENCE**

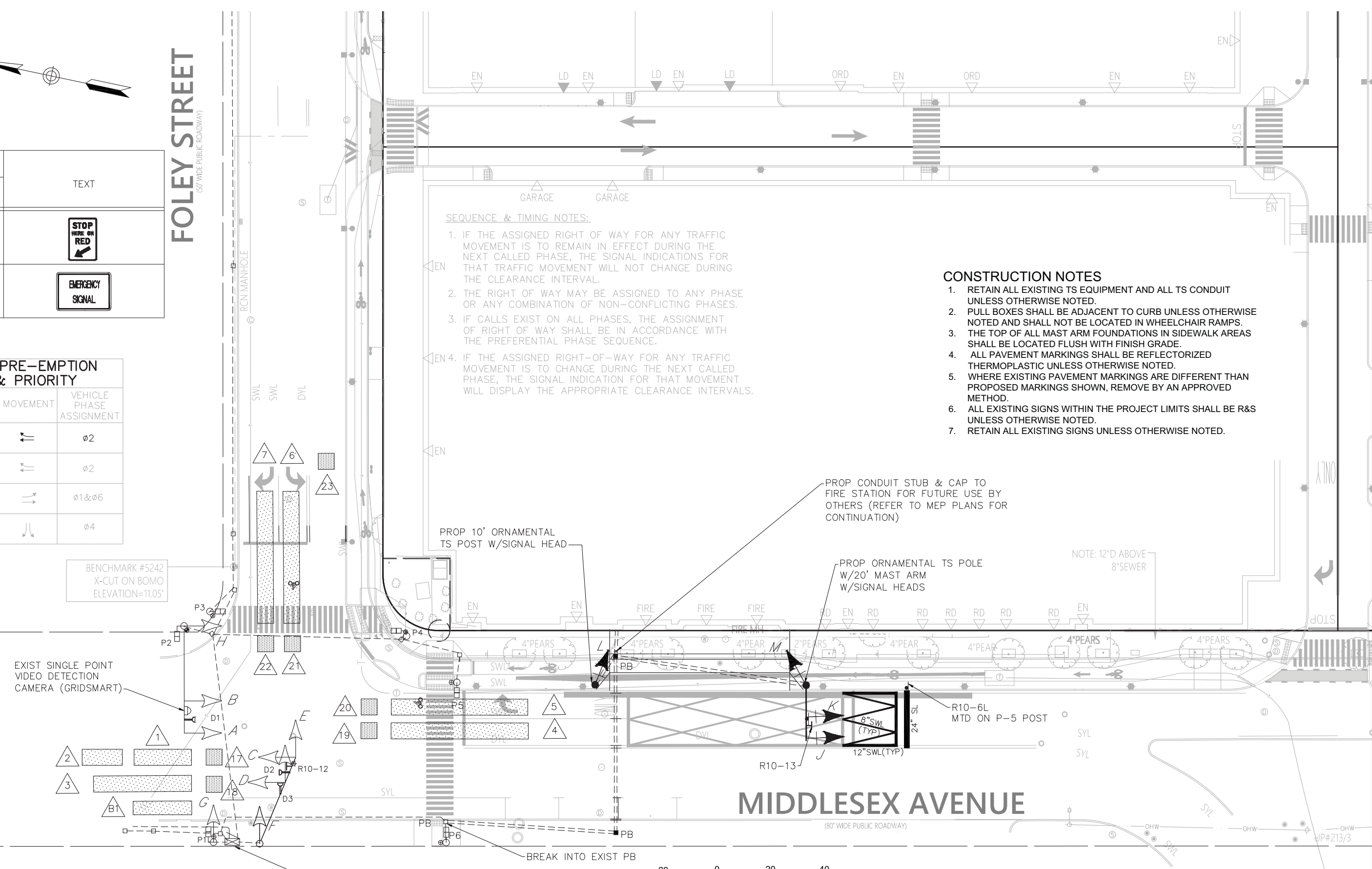

**PROPOSED/EXISTING SIGNAL HEAD DATA**

C	G,H	A,B,D,E,F	P1-P4	P5-P6	J,K	L,M

ALL 12" LENS

- NOTES:**
- ALL PROPOSED SIGNAL HEADS SHALL BE RIGID MOUNTED
  - ALL PROPOSED SIGNAL DISPLAYS SHALL BE EQUIPPED W/L.E.D. MODULES AND TUNNEL VISORS
  - SIGNAL HEADS J & K SHALL BE EQUIPPED WITH 5" ± LOUVERED BACKPLATES

**LIST OF MAJOR ITEMS REQUIRED**

PAY ITEM	QUANTITY	DESCRIPTION
816.01	1	MODIFY EXIST 80 TS 2 TYPE 1 CONTROLLER TO PROP CHANGES SHOWN
	1	ORNAMENTAL TS 20' MAST ARM TYPE 2, STEEL, INCL. FOUNDATION
	1	ORNAMENTAL TS POST 10' STANDARD INCL. FOUNDATION
	2	SIGNAL HEAD, 2-SECTION, 12" LENSES
	2	SIGNAL HEAD, 3-SECTION, 8"12" LENSES
	2	PULL BOX-12"x12"
804.3	1	FUSED +24 VDC OUTPUT (USED TO SUPPLY POWER TO THE CONTROL SWITCHES LOCATED INSIDE THE FIRE STATION)
	220±	3" CONDUIT, SCHEDULE 80, TYPE NM

PLUS NECESSARY DUCT, CABLE, LABOR, MISCELLANEOUS MATERIAL AND EQUIPMENT TO COMPLETE THE INSTALLATION AND PROVIDE AN OPERATING TRAFFIC CONTROL SIGNAL.

No.	Description	Date
-----	-------------	------

**BID DOCUMENTS**

Job #	2116.002
Project	ASSEMBLY SQUARE FIRE HOUSE
Drawn By	Checked
Date	9.18.2023
Scale	As indicated

**TRAFFIC SIGNAL PLAN**

**C04.00**

P:\Plans\6162023\11-43-25 AM\11-43-25 AM.dwg  
P:\Plans\6162023\11-43-25 AM\11-43-25 AM.dwg  
P:\Plans\6162023\11-43-25 AM\11-43-25 AM.dwg

P:\Misc\6/15/2023 10:03:04 AM  
\\vhb\proj\Wet-LD14000-10\cambridge7 fire station\cadd\Plans\set\DD1400010\_DT.dwg

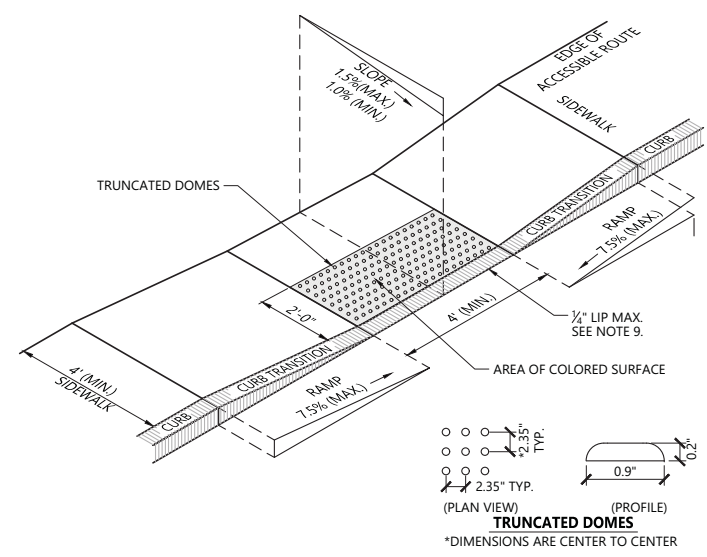

**Accessible Curb Ramp (ACR) Type 'A-D'** 1/16  
N.T.S. Source: VHB LD\_500

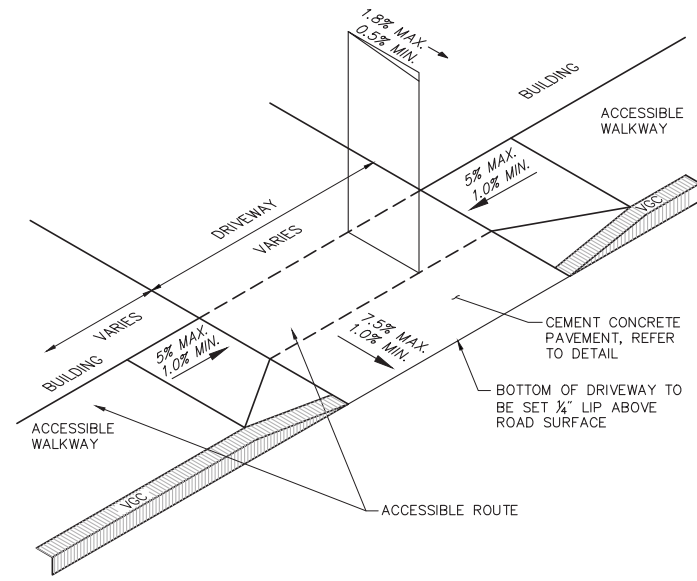

**Driveway Apron with Sidewalk** 12/04  
N.T.S. Source: VHB LD\_403

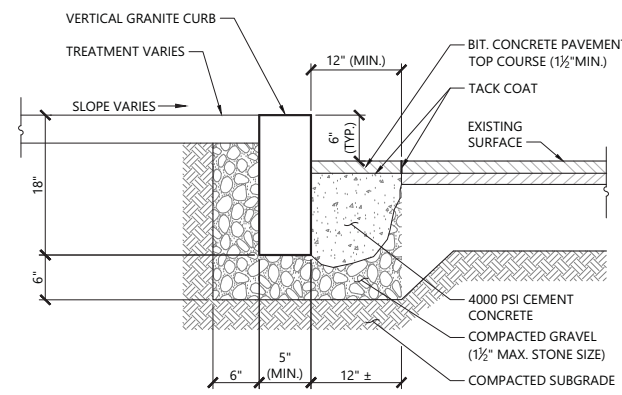

**Vertical Granite Curb (VGC) Set In Existing Pavement** 1/16  
N.T.S. Source: VHB LD\_403

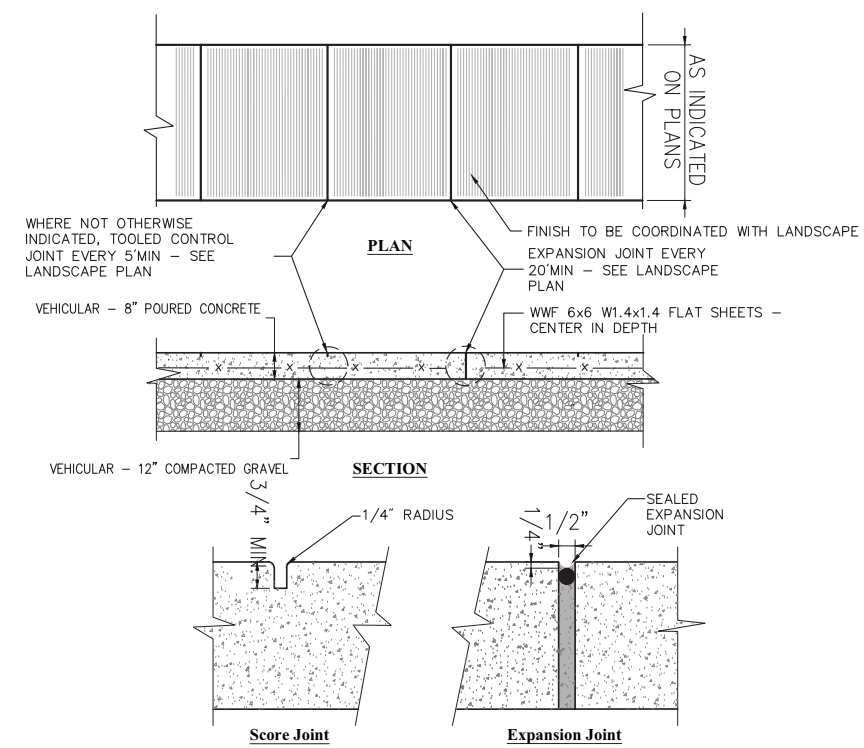

**Cement Concrete Pavement**  
N.T.S. Source: VHB

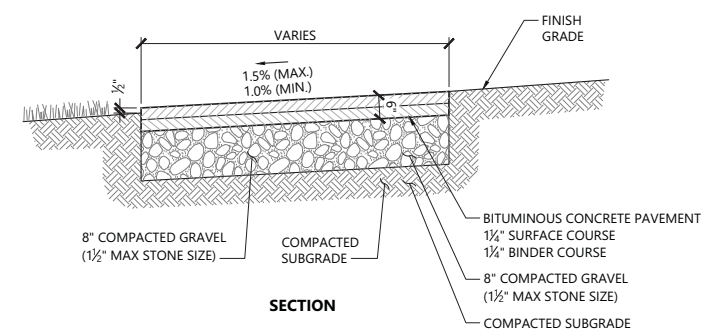

**Bituminous Concrete Bike Path** 3/21  
N.T.S. Source: VHB LD\_426

**PAVEMENT NOTES\***

**RESURFICED FULL DEPTH PAVEMENT:**

TOP COURSE: 1-1/2" CLASS 1 BITUMINOUS CONCRETE PAVEMENT, TYPE 1-1 PLACED IN 1 LAYER.

BINDER: 4" CLASS 1 BITUMINOUS CONCRETE PAVEMENT, TYPE 1-1 PLACED IN 2 LAYERS.

BASE: 12" DENSE GRADED DRUSHED STONE FOR SUBBASE

SUBBASE: SUBGRADE SHALL BE PROOF-ROLLED WITH A HEAVY VIBRATORY ROLLER OR FULLY LOADED TEN WHEEL DUMP TRUCK - ANY LOOSE ROCK SHALL BE COVERED WITH 5/8" INCHES OF CRUSHED OR CHOK STONE. SOFT OR HARD AREAS AND OTHER OBSTRUCTIONARY MATERIAL (OTAP, ROOT, ORGANICS) SHALL BE ENGRAINED AND BACKFILLED WITH COMPACTED STRUCTURAL FILL.

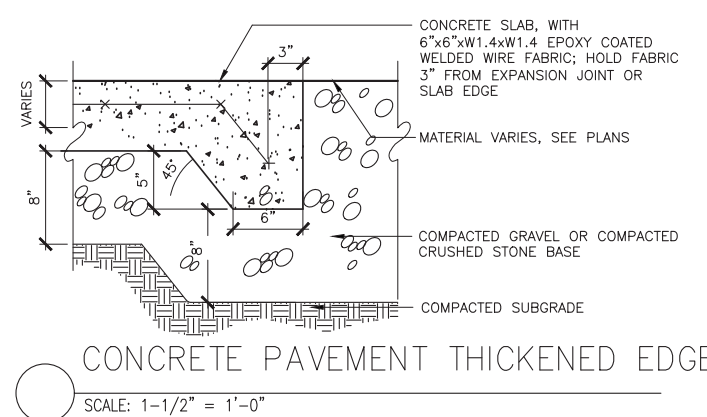

**CONCRETE PAVEMENT THICKENED EDGE**  
SCALE: 1-1/2" = 1'-0"

**Bituminous Concrete Pavement Section** 9/16  
N.T.S. Source: VHB

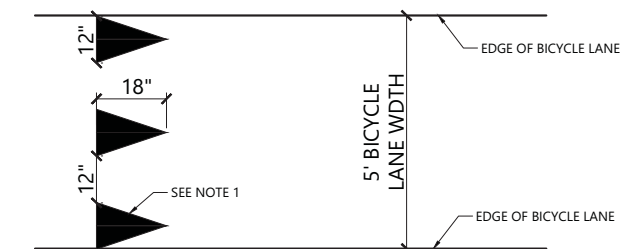

**Bicycle Lane Yield Marking** 6/21  
N.T.S. Source: VHB

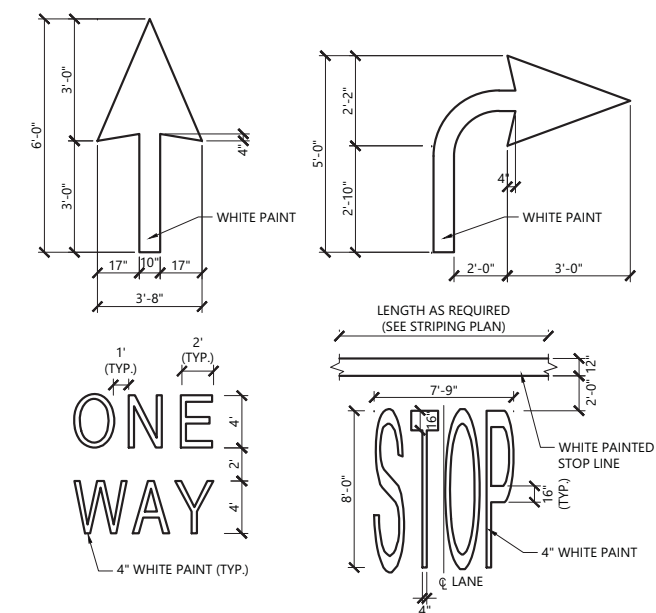

**Painted Pavement Markings - On Site** 1/16  
N.T.S. Source: VHB LD\_554

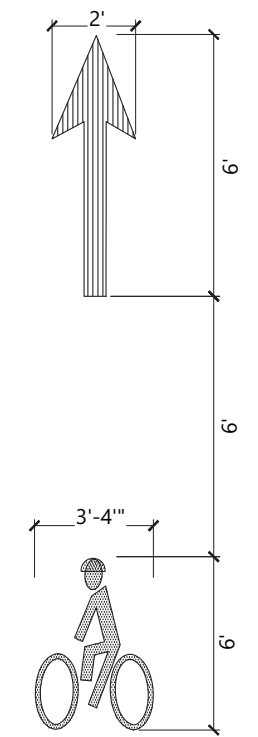

**Bicycle Lane Pavement Marking** 11/15  
N.T.S. Source: VHB

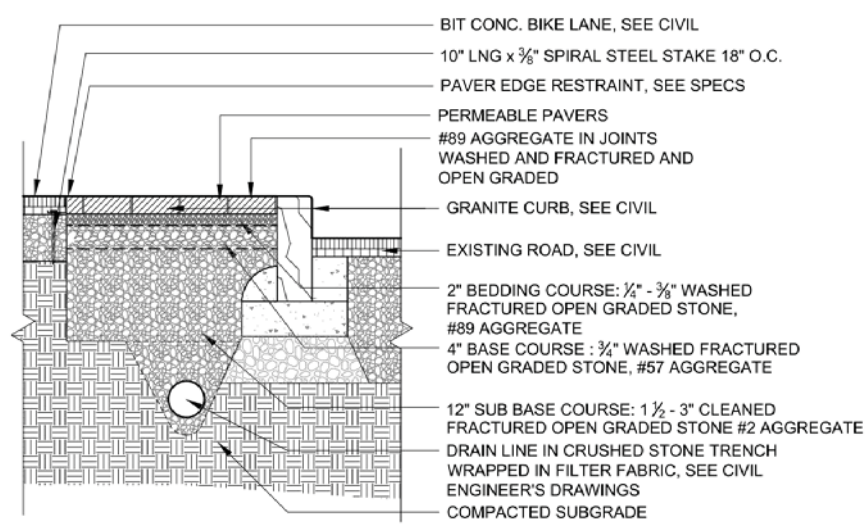

**4 PERMEABLE PAVING BAND AT CURB EDGE**  
SCALE: 3/4" = 1'-0"

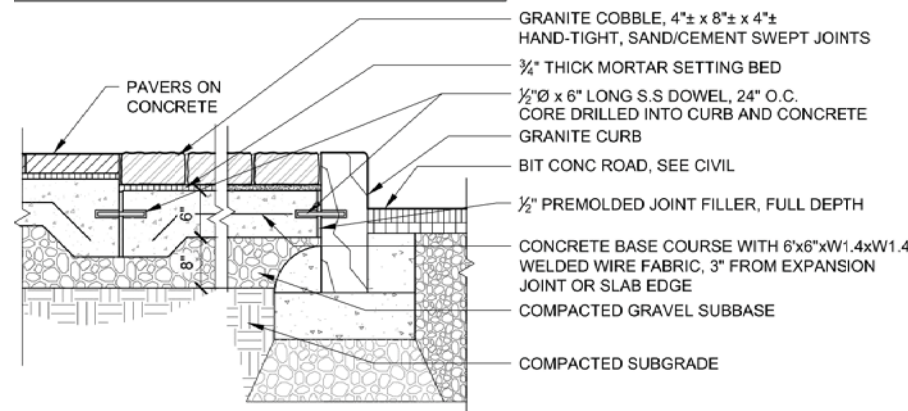

**GRANITE COBBLE PAVING**

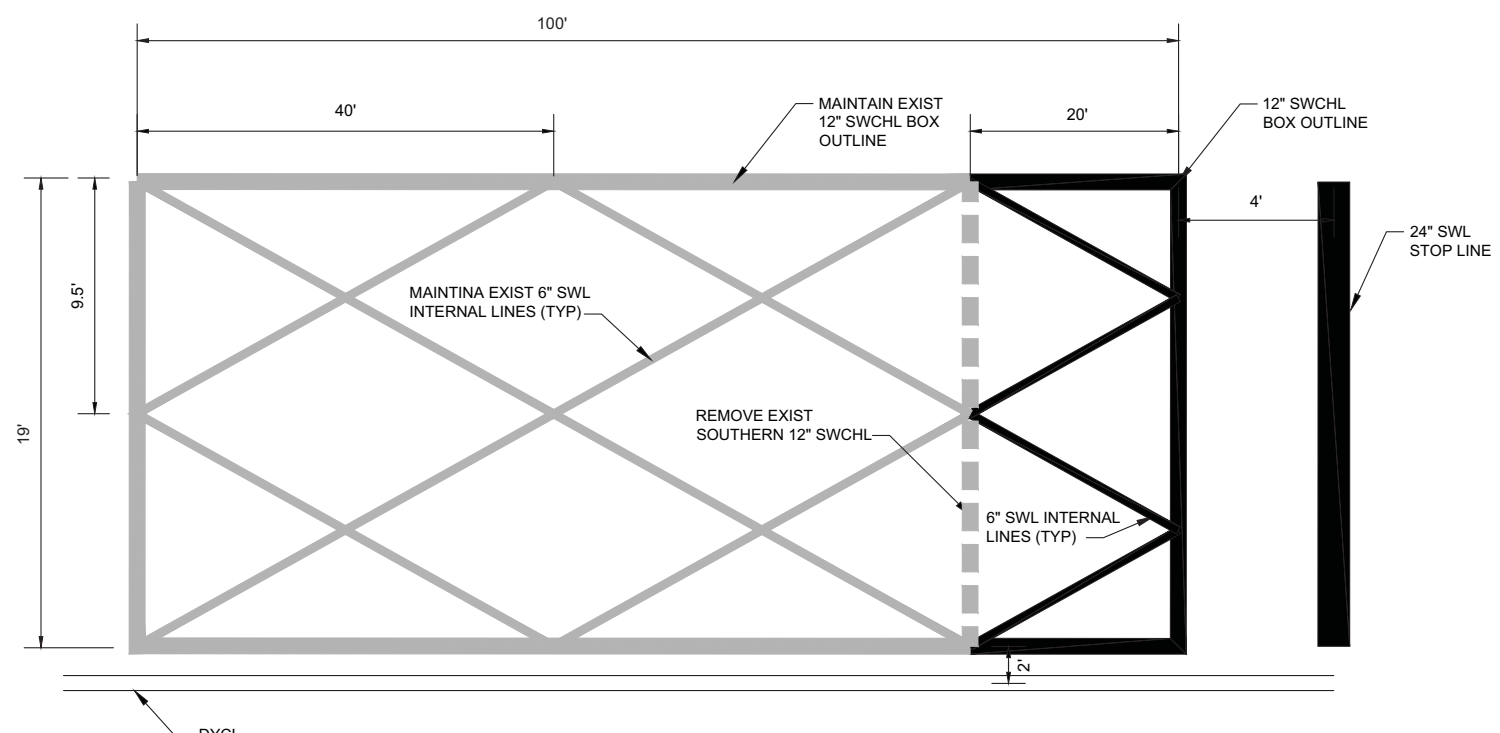

**DO NOT BLOCK INTERSECTION MARKINGS**  
SCALE: N.T.S.



City of Somerville

**ASSEMBLY SQUARE FIRE HOUSE**  
45 Middlesex Ave, Somerville, MA 02145

**CambridgeSeven**

Architects and Planners  
1050 Massachusetts Avenue  
Cambridge, MA 02138  
617 492-7000 Fax 492-7007



101 Walnut Street  
PO Box 9151  
Watertown, MA 02471  
617.924.1770

No.	Description	Date
-----	-------------	------

**BID DOCUMENTS**

Job #	2116.002
Project	ASSEMBLY SQUARE FIRE HOUSE
Drawn By	Checked
Date	9.18.2023
Scale	As indicated

**SITE DETAILS**

**C05.01**





City of Somerville

**ASSEMBLY SQUARE  
FIRE HOUSE**

45 Middlesex Ave, Somerville, MA 02145

**CambridgeSeven**

Architects and Planners

1050 Massachusetts Avenue  
Cambridge, MA 02138  
617.492.7000 Fax 492.7007



101 Walnut Street  
PO Box 9151  
Watertown, MA 02471  
617.924.1770

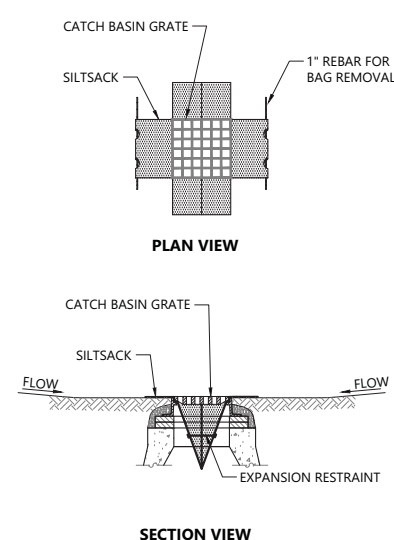

- NOTES**
1. INSTALL SILTSACK IN ALL CATCH BASINS WHERE INDICATED ON THE PLAN BEFORE COMMENCING WORK OR IN PAVED AREAS AFTER BINDER COURSE IS PLACED AND HAY BALES HAVE BEEN REMOVED.
  2. GRATE TO BE PLACED OVER SILTSACK.
  3. SILTSACK SHALL BE INSPECTED PERIODICALLY AND AFTER ALL STORM EVENTS AND CLEANING OR REPLACEMENT SHALL BE PERFORMED PROMPTLY AS NEEDED. MAINTAIN UNTIL UPSTREAM AREAS HAVE BEEN PERMANENTLY STABILIZED.

**Silt sack Sediment Trap** 1/16  
N.T.S. Source: VHB LD\_674

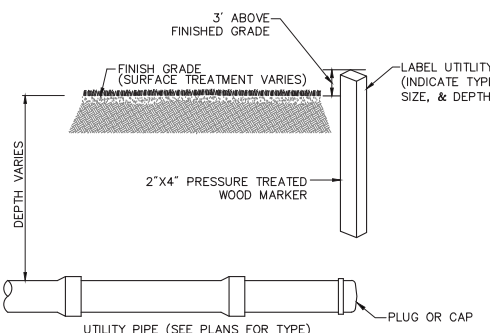

- Notes:**
1. EXTEND SERVICE STUBS A MINIMUM OF 10 FEET FROM UTILITY MAIN AND/OR A MINIMUM OF 10 FEET ACROSS PROPERTY LINE.

**Utility Stub, Plug/Cap, and Marker** 1/05  
N.T.S. Source: VHB

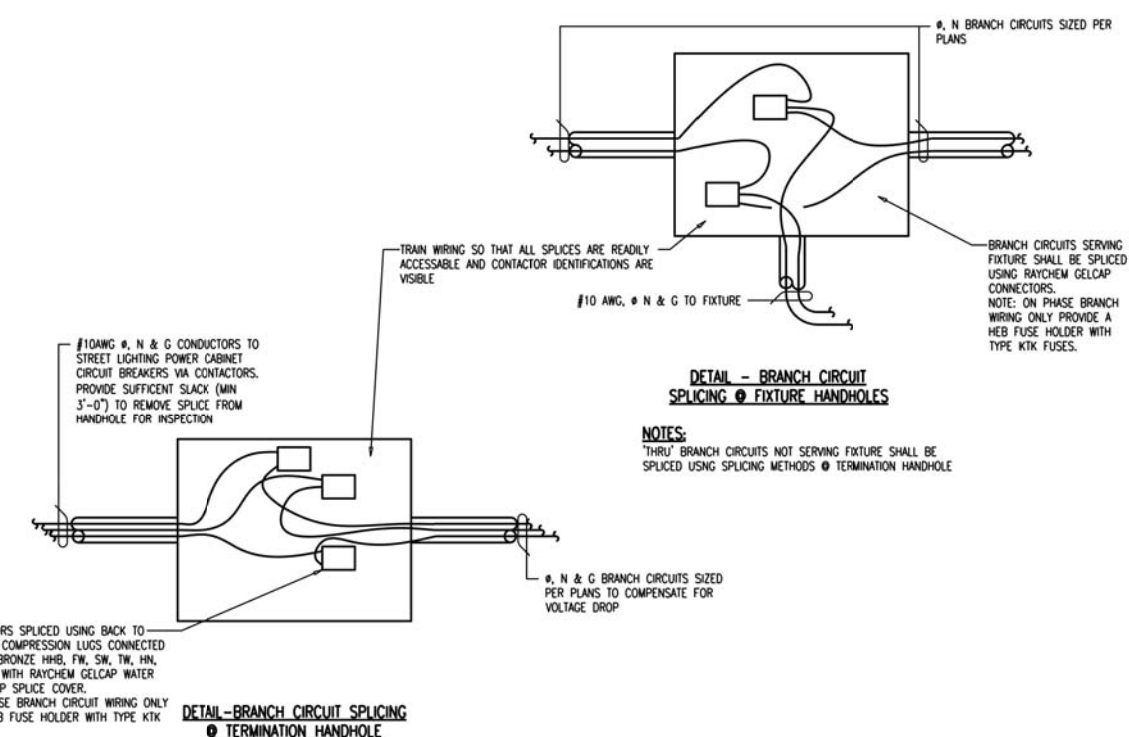

- NOTES**
- ALL CONDUCTORS SPliced USING BACK TO BACK COPPER COMPRESSION LUGS CONNECTED WITH DURUM BRONZE WIRE. THE SW, TR, HN, AND COVERED WITH RATCHEM GELCAP WATER RESISTANT STOP SPLICE COVER.
  - NOTE: ON PHASE BRANCH CIRCUIT WIRING ONLY PROVIDE A REB FUSE HOLDER WITH TYPE KIT FUSES.

**Branch Circuit Splicing at Termination Handhole Detail**  
N.T.S. Source: Engineering Advantage

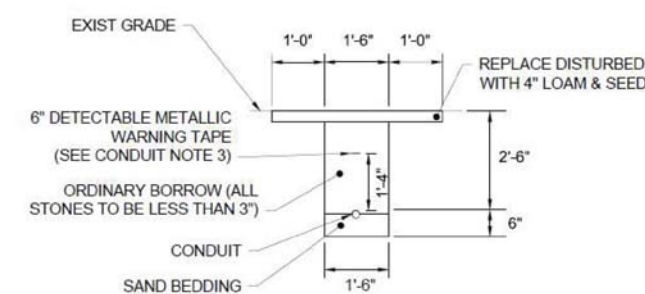

- CONDUIT UNDER GRASS**  
NOT TO SCALE
- EXIST GRADE
  - 1'-0" 1'-6" 1'-0"
  - REPLACE DISTURBED WITH 4" LOAM & SEED
  - 6" DETECTABLE METALLIC WARNING TAPE (SEE CONDUIT NOTE 3)
  - ORDINARY BORROW (ALL STONES TO BE LESS THAN 3")
  - CONDUIT
  - SAND BEDDING
  - 2'-6"
  - 6"
  - 1'-6"

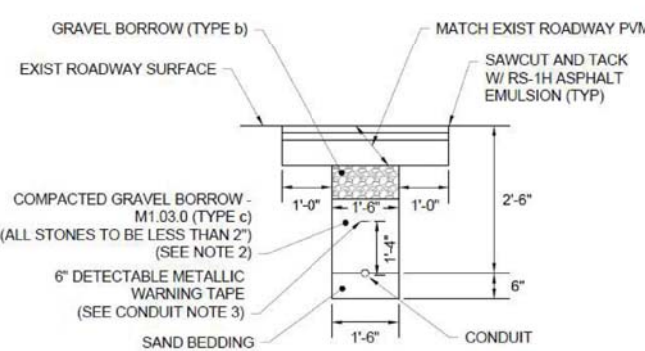

- CONDUIT UNDER ROADWAY**  
NOT TO SCALE
- GRAVEL BORROW (TYPE b)
  - MATCH EXIST ROADWAY PVMT
  - EXIST ROADWAY SURFACE
  - SAWCUT AND TACK W/ RS-1H ASPHALT EMULSION (TYP)
  - COMPACTED GRAVEL BORROW - M1.03.0 (TYPE c) (ALL STONES TO BE LESS THAN 2") (SEE NOTE 2)
  - 6" DETECTABLE METALLIC WARNING TAPE (SEE CONDUIT NOTE 3)
  - SAND BEDDING
  - 2'-6"
  - 6"
  - 1'-6"
  - CONDUIT

**City Standard Conduit Details**  
N.T.S. Source: City of Somerville

- NOTES**
1. SCHEDULE 80 ELECTRICAL CONDUIT TYPE NM-PLASTIC (UL), WITH PULL ROPE, PER MASSDOT STANDARDS.
  2. CONTROL DENSITY FILL SHALL BE USED FOR CONDUIT UNDER ROADWAY AS DETERMINED BY THE ENGINEER AND MEET THE REQUIREMENTS OF SUBSECTION 144.00(1).
  3. WARNING TAPE SHALL BE PER CURRENT APWA STANDARDS.

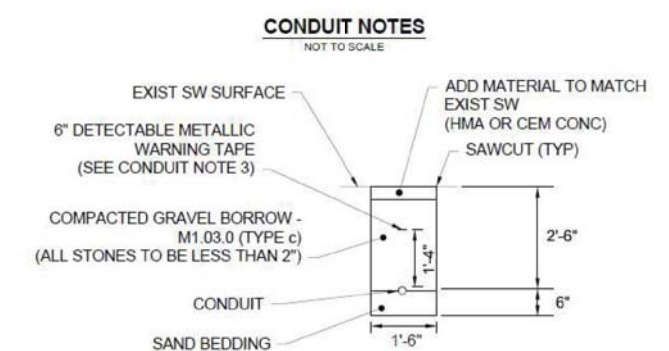

- CONDUIT NOTES**  
NOT TO SCALE
- EXIST SW SURFACE
  - ADD MATERIAL TO MATCH EXIST SW (HMA OR CEM CONC)
  - SAWCUT (TYP)
  - 6" DETECTABLE METALLIC WARNING TAPE (SEE CONDUIT NOTE 3)
  - COMPACTED GRAVEL BORROW - M1.03.0 (TYPE c) (ALL STONES TO BE LESS THAN 2")
  - CONDUIT
  - SAND BEDDING
  - 2'-6"
  - 6"
  - 1'-6"

No.	Description	Date
<b>BID DOCUMENTS</b>		
Job #	2116.002	
Project	ASSEMBLY SQUARE FIRE HOUSE	
Drawn By	Checked	
Date	9.18.2023	
Scale	As indicated	
Drawing Title	<b>SITE DETAILS</b>	
<b>C05.02</b>		

CITY OF SOMERVILLE  
93 HIGHLAND AVE  
SOMERVILLE, MA 02143 USA

FR ASSEMBLY SQUARE LLC  
909 ROSE AVE., SUITE 200  
NORTH BETHESDA, MD 20852 USA

PS NORTHEAST LLC  
701 WESTERN AVE  
GLENDALE, CA 91221