



**CITY OF SOMERVILLE**

Commonwealth of Massachusetts  
93 Highland Avenue  
Somerville, MA 02143  
(617) 625-6600

**BUSINESS LICENSE APPLICATION - Grant of Location**

File #: 20-012391

License #: BL20-000110

Address: 101 SOUTH ST

Licensee: Dave Flewelling Comcast of Massachusetts/ New Hampshire, LLC

DBA Name: Comcast Cable Communications Management, LLC

Business Ownership Type: LLC

Legal Name of Entity: Comcast Cable Communications Management, LLC

Owners/Officers: Brian Roberts, Brian Roberts, Brian Roberts, Brian Roberts

**License Information:**

**Grant of location issued to:** Comcast Cable Communications Management, LLC

**Describe the reason for the work, and the intended beneficiaries:** Providing Comcast Service to number 101 South Street

**Insert here the same detailed description of the work as appears in the attached Grant of Location**

**Order:** South Street & Earl Street : Starting at Pole No. 316/8 on South Street excavating to place (2) 4' PVC Conduits 294'+/\_ and (2) 3'x3' manholes to provide service to number 101 South Street. As shown on the attached plans

Approval Conditions:

**Approved By:**

**Karla Cuarezma, Approved**

**Malik Drayton, Approved with Conditions**

APPROVAL CONDITION: MD20200818: Contractor shall take all necessary precautions to avoid damaging any tree or tree part with equipment.

APPROVAL CONDITION: MD20200818: All nearby street tree(s) shall be protected prior to and during all construction activities using TREE BOX or TREE WRAPS. . TREE BOX shall be constructed from 2 in. x 4 in. lumber creating a box around the border of the tree pit with 2 in. x 4 in. lumber standing straight up at the corners and wrapped with orange snow fence. Detail attached. . TREE WRAPS (TREE TRUNK WRAPPING PROTECTION LUMBER) shall consist of 2 in. x 4 in. and 8 ft. height lumber wired together in close spacing with zip ties or 16 gauge galvanized steel wire to form a protective enclosure around tree trunks. Use burlap to separate the wood from the bark if necessary to prevent wood from scraping or bruising bark. Do not use staples or puncture the trunk in any way.

APPROVAL CONDITION: MD20200818: Any tree roots less than two (2) inches in diameter that cannot be avoided during construction shall be carefully and cleanly cut with a clean pair of pruning shears or loppers. Roots are to be cut back flush with the edge of the trench. If any tree roots greater than two (2) inches in diameter are encountered, stop work immediately and contact the City Urban Forester. Any and all pruning of roots greater than 2 inches in diameter must be completed under the supervision of the City Urban Forester.

**Mark Lawhorne, Approved**  
**John J. Long, Approved**



## CITY OF SOMERVILLE, MASSACHUSETTS

### CITY CLERK'S OFFICE

JOSEPH A. CURTATONE  
MAYOR

JOHN J. LONG  
CITY CLERK

September 15, 2020

### NOTICE OF PUBLIC HEARING

You are hereby notified that the Somerville City Council will hold a Public Hearing on the following Petition. You are receiving this Notice because the Petitioner has reported that you own property that abuts the work that is being proposed. You and other members of the public are invited to attend and be heard at this Hearing.

Because of Governor Baker's and Mayor Curtatone's recent orders limiting the number of people that may gather in one place, **this meeting of the City Council will be conducted via remote participation, online in a webinar hosted on the GoToWebinar platform.**

You have two ways to be heard at this meeting:

1. To attend and be heard, enter the link exactly as it appears below into your internet browser any time before the meeting. You will then be asked to register for the meeting. After registering, you will receive an email with instructions to join the webinar when it starts.
2. If you are unable to attend but wish to be heard, you may send written comments by US mail to the City Clerk at the address below, or by email to [cityclerk@somervillema.gov](mailto:cityclerk@somervillema.gov). Your comments must arrive no later than 12 Noon on the day of the Hearing, in order to be sure they are conveyed to the Council.

**PETITION:** Comcast Cable Communications seeks a Grant of Location to install a total of 294 feet of conduit as follows: Starting from utility pole 316/8 to a proposed manhole located at the intersection of South and Earle Street. Then continuing 182 feet to another proposed manhole, which will have an 18 feet extension for future use. From the proposed manhole, 77 feet to the rear of 101 South Street.

**PLACE:** <https://attendee.gotowebinar.com/register/7452069109734289164>.

**TIME:** Thursday, September 24, 2020, at 7:00 PM.

**PURPOSE:** The work is necessary to provide or improve service to 101 South Street.

Proposed Comcast Conduit Plan  
101 South Street Somerville, MA  
Date: 8/5/20  
Scale: NA  
Sketch by: DRF

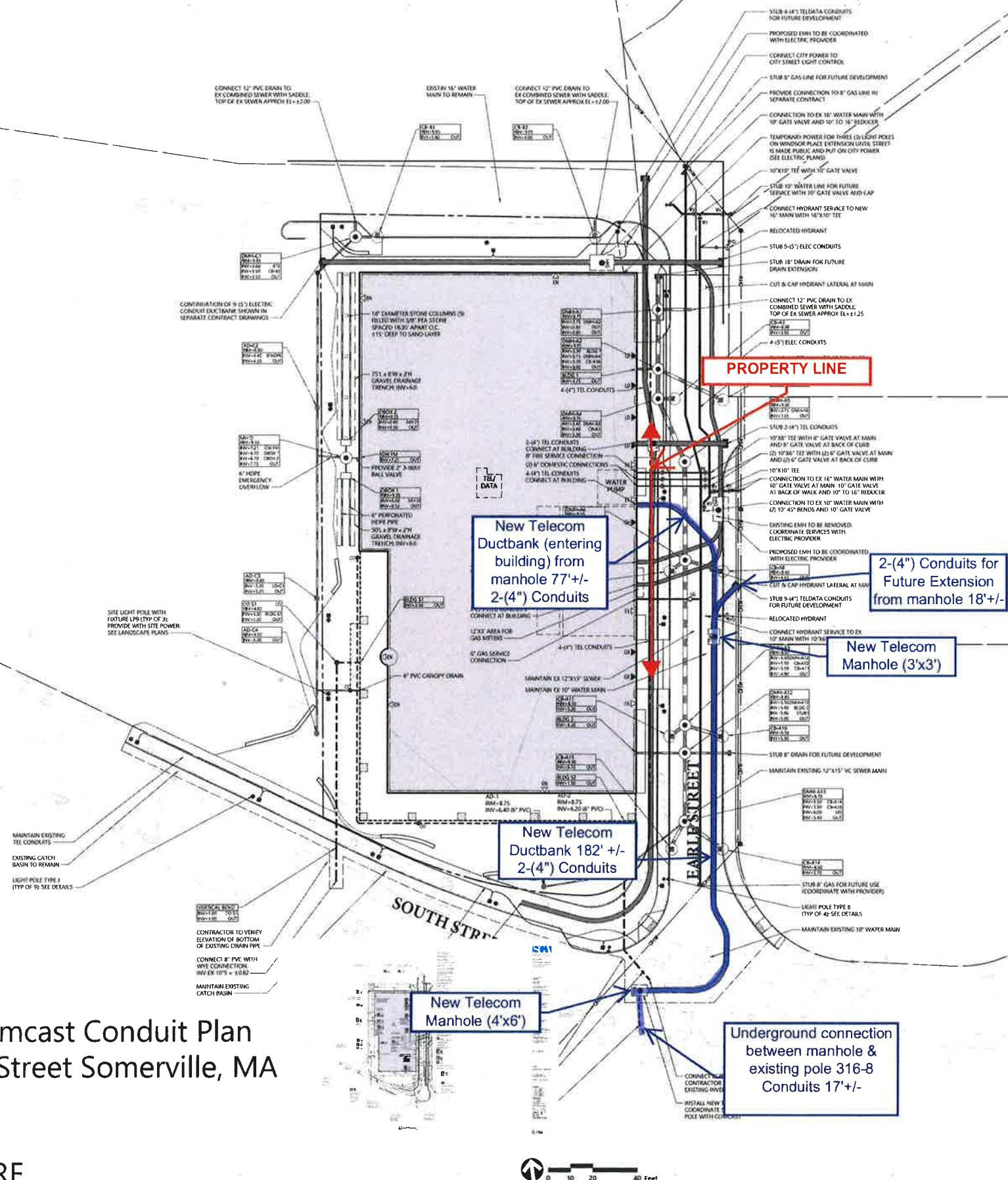

**97/B/23 BOYTON YARDS  
SOMERVILLE, MA**

| Map | Blo | Lot  | Stree | Use |     |      |            |       |                |                                |                            |                               |               |    |            |      |      |
|-----|-----|------|-------|-----|-----|------|------------|-------|----------------|--------------------------------|----------------------------|-------------------------------|---------------|----|------------|------|------|
| Map | Cut | Bloc | Cut   | Lot | Cut | Unit | Alternate  | Numbe | Location       | Grantee                        | Co grantee-s Name          | Mailing Address               | City          | St | Zip        | Code | Use  |
| 5   | D   | 1    |       | 35  |     |      |            |       | CHARLESTOWN ST | MBTA                           | C/O MARK DOYLE R E DIRECT  | 10 PARK PLAZA SUITE 5720      | BOSTON        | MA | 02116      | 9540 | HALL |
| 5   | D   | 2    |       | 174 |     |      | C 7-16 15  |       | SOMERVILLE AVE | TARGET CORPORATION             | C/O PROPERTY TAX DEPT      | PO BOX 9456 1441              | MINNEAPOLIS   | MN | 55440-9456 | 3230 | SEOI |
| 6   | A   | 6    |       | 561 |     |      | 7 40       |       | WINDSOR ST     | RPI 561 WINDSOR LLC            |                            | 27 MICA LANE SUITE 201        | WELLESLEY     | MA | 02481      | 3420 | PROI |
| 6   | A   | 9    |       | 541 |     |      | 11 12      |       | WINDSOR ST     | JAN REALTY LLC                 |                            | 480 COLUMBIA ST               | SOMERVILLE    | MA | 02143      | 4010 | IND  |
| 6   | A   | 16   |       | 474 |     |      | 13 15 17 1 |       | COLUMBIA ST    | TRUST COLUMBIA REAL ESTATE     | NISSSENBAUM JOSEPH L. & AL | 480 COLUMBIA ST               | SOMERVILLE    | MA | 02143-4103 | 3161 | COM  |
| 6   | A   | 20   |       | 8   |     |      |            |       | CONLON CT      | ROTOR REALTY CORPORATION       |                            | 480 COLUMBIA STREET           | SOMERVILLE    | MA | 02143-0499 | 3160 | COMM |
| 6   | A   | 22   |       | 486 |     |      | 21         |       | COLUMBIA ST    | JAN REALTY LLC                 |                            | 480 COLUMBIA ST               | SOMERVILLE    | MA | 02143      | 3161 | COMM |
| 6   | A   | 23   |       | 490 |     |      | 24         |       | COLUMBIA ST    | NISSSENBAUM JOSEPH L & ALLEN L | COLUMBIA REAL ESTATE TRUS  | 480 COLUMBIA ST               | SOMERVILLE    | MA | 02143      | 4410 | IND  |
| 6   | A   | 26   |       | 498 |     |      | 8 10 25    |       | COLUMBIA ST    | ROTOR REALTY CORPORATION       |                            | 480 COLUMBIA STREET           | SOMERVILLE    | MA | 02143      | 4400 | IND  |
| 6   | A   | 27   |       | 508 |     |      |            |       | COLUMBIA ST    | J A T REALTY CORP              |                            | 508 COLUMBIA ST               | SOMERVILLE    | MA | 02143      | 4010 | IND  |
| 6   | A   | 28   |       | 512 |     |      |            |       | COLUMBIA ST    | JAT REALTY CORP                |                            | 512 COLUMBIA ST               | SOMERVILLE    | MA | 02143      | 3370 | PARI |
| 6   | A   | 29   |       | 516 |     |      |            |       | COLUMBIA ST    | WEISBERG JANICE TRUSTEE        | THE CHERYL LANE 2018 REAL  | 33 CHERYL LANE                | WALTHAM       | MA | 02451      | 4410 | IND  |
| 6   | A   | 32   |       | 56  |     |      | 2 33 34 35 |       | WEBSTER AVE    | 56 WEBSTER AVE LLC             | C/O ROYAL HOSPITALITY SER  | 520 COLUMBIA ST ATT; D. NOBLE | SOMERVILLE    | MA | 02143      | 4010 | IND  |
| 6   | A   | 39   |       | 600 |     |      |            |       | WINDSOR PL     | US RELP 600 WINDSOR OWNER LLC  |                            | 225 N COLUMBUS DR SUITE 100   | CHICAGO       | IL | 60601      | 4010 | IND  |
| 6   | A   | 43   |       | 0   |     |      | 44, 45     |       | WINDSOR PL     | SOMERVILLE REDEVELOPMENT AUTH  | VACANT LAND                | 93 HIGHLAND AVE               | SOMERVILLE    | MA | 02143      | 9730 | VACU |
| 7   | A   | 6    |       | 0   |     |      |            |       | WINDSOR ST     | NISSSENBAUM JOSEPH L & ALLEN L |                            | 480 COLUMBIA ST               | SOMERVILLE    | MA | 02145      | 4400 | IND  |
| 7   | A   | 7    |       | 138 |     |      |            |       | SOUTH ST       | SOMERVILLE REDEVELOPMENT       | BOYNTON YARDS              | 93 HIGHLAND AVE               | SOMERVILLE    | MA | 02143      | 9730 | VACU |
| 7   | A   | 8    |       | 100 |     |      |            |       | SOUTH ST       | SOMERVILLE REDEVELOPMENT       | BOYNTON YARDS              | 93 HIGHLAND AVE               | SOMERVILLE    | MA | 02143      | 9730 | VACU |
| 7   | B   | 1    |       | 0   |     |      |            |       | WINDSOR PL     | RPI WINDSOR PLACE LLC          |                            | 27 MICA LANE SUITE 201        | WELLESLEY     | MA | 02481      | 3370 | PARI |
| 7   | B   | 2    |       | 33  |     |      | 24 25      |       | EARLE ST       | RECP V HARDING STREET OWNER,LL | C/O DLJ ESTATE CAPITOL PA  | 1123 BROADWAY SUITE 201       | NEW YORK      | NY | 10010      | 3161 | COM  |
| 7   | B   | 3    |       | 0   |     |      |            |       | WINDSOR PL     | JEK REALTY LLC                 |                            | 29 HARDING ST                 | SOMERVILLE    | MA | 02143      | 3370 | PARI |
| 7   | B   | 15   |       | 32  |     |      |            |       | WARD ST        | BOYTON YARDS LANDCO LLC        |                            | 10 POST OFFICE SQ             | BOSTON        | MA | 02109      | 1040 | TWO  |
| 7   | B   | 17   |       | 29  |     |      | 16         |       | HARDING ST     | BOYTON YARDS LANDCO LLC        |                            | 10 POST OFFICE SQ             | BOSTON        | MA | 02109      | 3161 | COM  |
| 7   | B   | 18   |       | 8   |     |      |            |       | HARDING ST     | BOYTON YARDS LANDCO LLC        |                            | 10 POST OFFICE SQ             | BOSTON        | MA | 02109      | 3370 | PARI |
| 7   | B   | 19   |       | 2   |     |      |            |       | HARDING ST     | BOYTON YARDS LANDCO LLC        |                            | 10 POST OFFICE SQ             | BOSTON        | MA | 02109      | 3370 | PARI |
| 7   | B   | 23   |       | 153 |     |      | 26         |       | SOUTH ST       | BOYTON YARDS LANDCO LLC        |                            | 10 POST OFFICE SQ             | BOSTON        | MA | 02109      | 4020 | IND  |
| 7   | G   | 1    |       | 48  |     |      |            |       | HUNTING ST     | COUTO JOSE P & MARIA A         |                            | 33 MAYALL ROAD                | WALTHAM       | MA | 02451      | 1040 | TWO  |
| 7   | G   | 2    |       | 46  |     |      |            |       | SOUTH ST       | LAKELAND CAPITAL 46-48 SOUTH S |                            | P.O. BOX 398                  | WINCHESTER    | MA | 01890      | 1110 | AFT  |
| 7   | G   | 7    |       | 44  |     |      |            |       | HUNTING ST     | LIMA JAMES & ANNE              |                            | 44 HUNTING ST                 | SOMERVILLE    | MA | 02143      | 1040 | TWO  |
| 7   | G   | 8    |       | 46  |     |      |            |       | HUNTING ST     | KONSTANTINOF GROZDAN PETKOF &  | NEWMAN SHELLEY             | 7 WOODSIDE PATH               | EAST WEYMOUTH | MA | 02189      | 1050 | THRI |
| 7   | E   | 1    |       | 66  |     |      |            |       | SOUTH ST       | JACOB LINDA & MANGANO JOSEPH   | GALASSO FRANCIS M & BARBA  | 15 WARD ST                    | SOMERVILLE    | MA | 02143      | 4000 | FAC  |
| 7   | E   | 3    |       | 47  |     |      | 2 4        |       | HUNTING ST     | FUD LLC                        |                            | 47 HUNTING ST #302            | SOMERVILLE    | MA | 02143      | 1110 | AFT  |
| 7   | H   | 5    |       | 39  |     |      |            |       | HUNTING ST     | CARRIERI GUY                   |                            | 75A BOLTON ST                 | SOUTH BOSTON  | MA | 02127      | 1040 | TWO  |
| 7   | H   | 6    |       | 0   |     |      |            |       | SOUTH ST       | CITY OF SOMERVILLE             | BOYNTON YARDS              | 93 HIGHLAND AVE               | SOMERVILLE    | MA | 02143      | 9300 | CIT  |
| 7   | I   | 1    |       | 33  |     |      |            |       | WARD ST        | FLANAGAN SCOTT W & LISA        |                            | 33 WARD ST                    | SOMERVILLE    | MA | 02143      | 1040 | TWO  |
| 7   | I   | 2    |       | 29  |     |      | 3          |       | WARD ST        | FLANAGAN SCOTT W               |                            | 29 WARD ST                    | SOMERVILLE    | MA | 02143      | 1050 | THRI |
| 7   | I   | 5    |       | 14  |     |      | 4 5 6 9 10 |       | HORACE ST      | ANTHONY ARTHUR J JR            |                            | 262 SANDY POND ROAD           | LINCOLN       | MA | 01773-9800 | 4000 | FAC  |
| 7   | I   | 11   |       |     |     |      |            |       | HARDING ST     | FLANAGAN SCOTT W               |                            | 33 WARD ST                    | SOMERVILLE    | MA | 02143      | 1320 | RE   |