



**CITY OF SOMERVILLE**  
Commonwealth of Massachusetts  
93 Highland Avenue  
Somerville, MA 02143  
(617) 625-6600

## **BUSINESS LICENSE APPLICATION - Grant of Location**

File #: 22-001302

License #: BL22-000013

Address: 599 SOMERVILLE AVE

Licensee: Hannah Cooper NSTAR Electric Company dba Eversource Energy

DBA Name: NSTAR dba Eversource Energy

Business Ownership Type: Corporation

Legal Name of Entity: NSTAR dba Eversource Energy

Owners/Officers: Joseph R Nolan Jr, , ,

### **License Information:**

**Grant of location issued to:** NSTAR dba Eversource Energy

**Describe the reason for the work, and the intended beneficiaries:** This work is necessary to provide electric service to #599 Somerville Avenue.

**Insert here the same detailed description of the work as appears in the attached Grant of Location Order:** Somerville Avenue - Westerly thence northwesterly from manhole MH28940, approximately 70 feet northeast from Garden Court, to private property at #599 Somerville Avenue, install approximately 308 feet of conduit. WO#5708894

Approval Conditions:

### **Approved By:**

**Isabela Maia, Approved with Conditions**

APPROVAL CONDITION IMM 2022-02-02 Provide the City a of copy approved MWRA 8(m) permit when applying for the street occupancy permit.

**Malik Drayton, Approved with Conditions**

APPROVAL CONDITION: MD20220201: Contractor shall take all necessary precautions to avoid damaging any tree or tree part with equipment.

APPROVAL CONDITION: MD20220201: All nearby street tree(s) shall be protected prior to and during all construction activities using TREE BOX or TREE WRAPS. . TREE BOX shall be constructed from 2 in. x 4 in. lumber creating a box around the border of the tree pit with 2 in. x 4 in. lumber standing straight up at the corners and wrapped with orange snow fence. Detail attached. . TREE WRAPS (TREE TRUNK WRAPPING PROTECTION LUMBER) shall consist of 2 in. x 4 in. and 8 ft.

height lumber wired together in close spacing with zip ties or 16 gauge galvanized steel wire to form a protective enclosure around tree trunks. Use burlap to separate the wood from the bark if necessary to prevent wood from scraping or bruising bark. Do not use staples or puncture the trunk in any way. APPROVAL CONDITION: MD20220201: Any tree roots less than two (2) inches in diameter that cannot be avoided during construction shall be carefully and cleanly cut with a clean pair of pruning shears or loppers. Roots are to be cut back flush with the edge of the trench. If any tree roots greater than two (2) inches in diameter are encountered, stop work immediately and contact the City Urban Forester. Any and all pruning of roots greater than 2 inches in diameter must be completed under the supervision of the City Urban Forester.

**Eric Weisman, Approved**

**Kimberly M. Wells, Approved**



CITY OF SOMERVILLE, MASSACHUSETTS  
CITY CLERK'S OFFICE  
KATJANA BALLANTYNE  
MAYOR

KIMBERLY M. WELLS  
CITY CLERK

March 1, 2022

**NOTICE OF PUBLIC HEARING**

You are hereby notified that the Somerville City Council will hold a Public Hearing on the following Petition. You are receiving this Notice because the Petitioner has reported that you own property that abuts the work that is being proposed. You and other members of the public are invited to attend and be heard at this Hearing.

Because of Governor Baker's orders limiting the number of people that may gather in one place, **this meeting of the City Council will be conducted via remote participation, online in a webinar hosted on the GoToWebinar platform.**

You have two ways to be heard at this meeting:

1. To attend and be heard, enter the link exactly as it appears below into your internet browser any time before the meeting. You will then be asked to register for the meeting. After registering, you will receive an email with instructions to join the webinar when it starts.
2. If you are unable to attend but wish to be heard, you may send written comments by US mail to the City Clerk at the address below, or by email to [cityclerk@somervillema.gov](mailto:cityclerk@somervillema.gov). Your comments must arrive no later than 12 Noon on the day of the Hearing, in order to be sure they are conveyed to the Council.

**PETITION:** Eversource (NStar Electric) is applying for a Grant of Location to install a total of 308 feet of conduit in Somerville Avenue as follows: From Manholes 28940 and 8634 to a point of pickup at the intersection of Spring Street and Somerville Avenue.

**PLACE:** <https://attendee.gotowebinar.com/register/7564266586558448909>

**TIME:** Thursday, March 10, 2022, at 7:00 PM.

**PURPOSE:** The work is necessary to provide or improve service to 599 Somerville Avenue.

W.O. #5708894

**EVERSOURCE**  
101 Linwood Street  
Somerville, MA 02143

February 28<sup>th</sup>, 2022

Ms. Kimberly Wells  
Office of the City Clerk  
93 Highland Avenue  
Somerville, MA 02143

RE: Somerville Avenue  
W.O. #5708894

Dear Members of the Board,

The NSTAR Electric Company d/b/a Eversource Energy respectfully requests a Grant of Location for the installation of approximately 245 feet of conduit from manhole MH28940 and approximately 63 feet of conduit from manhole MH8634 in Somerville Avenue.

This work is necessary to supply power to #599 Somerville Avenue.

If you have any questions or concerns, please call Jacqueline Duffy at 617-629-3204.

Very truly yours,

*Kelly-Ann Correia*

Kelly-Ann Correia  
Supervisor, Rights and Permits

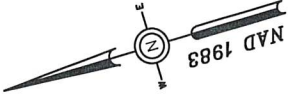

FIG	4" Ducts			6" Ducts		
	A	B	C	A	B	C
1A	10"	10"	11"	11"	12"	12"
1	16 1/2"	10 1/2"	18 1/2"	11 1/2"	21"	12 1/2"
2	20 1/2"	10 1/2"	26 1/2"	11 1/2"	29"	12 1/2"
3	28 1/2"	10 1/2"	34 1/2"	11 1/2"	37"	12 1/2"
4	16 1/2"	16 1/2"	18 1/2"	18 1/2"	21"	21"
5	22 1/2"	16 1/2"	25 1/2"	18 1/2"	29"	21"
6	16 1/2"	22 1/2"	18 1/2"	26 1/2"	21"	37"
7	16 1/2"	28 1/2"	18 1/2"	30 1/2"	21"	37"
8	28 1/2"	16 1/2"	34 1/2"	18 1/2"	29"	29"
9	22 1/2"	22 1/2"	25 1/2"	25 1/2"	29"	29"
10	34 1/2"	16 1/2"	39 1/2"	18 1/2"	45"	21"
11	16 1/2"	34 1/2"	18 1/2"	39 1/2"	21"	45"
12	22 1/2"	26 1/2"	25 1/2"	30 1/2"	29"	37"
13	28 1/2"	22 1/2"	30 1/2"	26 1/2"	37"	29"
14	40 1/2"	16 1/2"	46 1/2"	18 1/2"	53 1/2"	21"
15	16 1/2"	40 1/2"	18 1/2"	46 1/2"	21"	53 1/2"
16	16 1/2"	46 1/2"	18 1/2"	53 1/2"	21"	61"

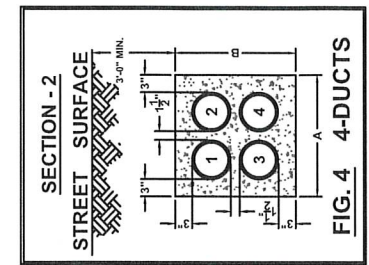
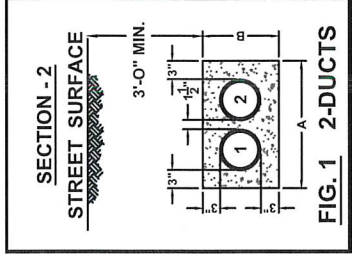

FIG	4" Ducts			6" Ducts		
	A	B	C	A	B	C
1A	10"	10"	11"	11"	12"	12"
1	16 1/2"	10 1/2"	18 1/2"	11 1/2"	21"	12 1/2"
2	20 1/2"	10 1/2"	26 1/2"	11 1/2"	29"	12 1/2"
3	28 1/2"	10 1/2"	34 1/2"	11 1/2"	37"	12 1/2"
4	16 1/2"	16 1/2"	18 1/2"	18 1/2"	21"	21"
5	22 1/2"	16 1/2"	25 1/2"	18 1/2"	29"	21"
6	16 1/2"	22 1/2"	18 1/2"	26 1/2"	21"	37"
7	16 1/2"	28 1/2"	18 1/2"	30 1/2"	21"	37"
8	28 1/2"	16 1/2"	34 1/2"	18 1/2"	29"	29"
9	22 1/2"	22 1/2"	25 1/2"	25 1/2"	29"	29"
10	34 1/2"	16 1/2"	39 1/2"	18 1/2"	45"	21"
11	16 1/2"	34 1/2"	18 1/2"	39 1/2"	21"	45"
12	22 1/2"	26 1/2"	25 1/2"	30 1/2"	29"	37"
13	28 1/2"	22 1/2"	30 1/2"	26 1/2"	37"	29"
14	40 1/2"	16 1/2"	46 1/2"	18 1/2"	53 1/2"	21"
15	16 1/2"	40 1/2"	18 1/2"	46 1/2"	21"	53 1/2"
16	16 1/2"	46 1/2"	18 1/2"	53 1/2"	21"	61"

44/1/8/8  
6 SPRING ST #6  
N/F  
SHULMAN MICHAEL  
& LERNER DANIELE

44/1/8/8  
6 SPRING ST #B  
N/F  
AGRAWAL SAURABH  
& SHAH SHAILY

44/1/7/1  
599 SOMERVILLE AVE  
N/F  
599 SOMERVILLE VENTURES LLC

44/H/1/11  
9 SPRING ST  
FERNANDES ANTONIO D  
& MARIA C TRISTEES  
& MARIA C TRISTEES  
9 SPRING STREET  
NOMINEE TRUST

44/H/1/13  
593 SOMERVILLE AVE  
N/F  
REFER TO ABUTTER'S LIST

44/H/1/14  
595 SOMERVILLE AVE  
N/F  
REFER TO ABUTTER'S LIST

44/H/1/12  
585 SOMERVILLE AVE  
N/F  
HETU SETH N  
& NYEEN MYAT A

45/A/1/1  
596 SOMERVILLE AVE  
N/F  
ANNE MARIE R CARNES TRUSTEE  
ANNE MARIE CARNES REVOC TRUST

45/A/2/1  
584 SOMERVILLE AVE  
N/F  
CARNES ANNE MARIE TRUSTEE  
S/O ANNE MARIE CARNES TRUSTEE  
REVOC LIV

45/B/20/1  
588 SOMERVILLE AVE  
N/F  
COMM OF MASS  
C/O DIVISION OF CAPITAL ASSET  
MANAGEMENT

45/B/21/1  
578 SOMERVILLE AVE  
N/F  
BBD SOMERVILLE AVE LLC

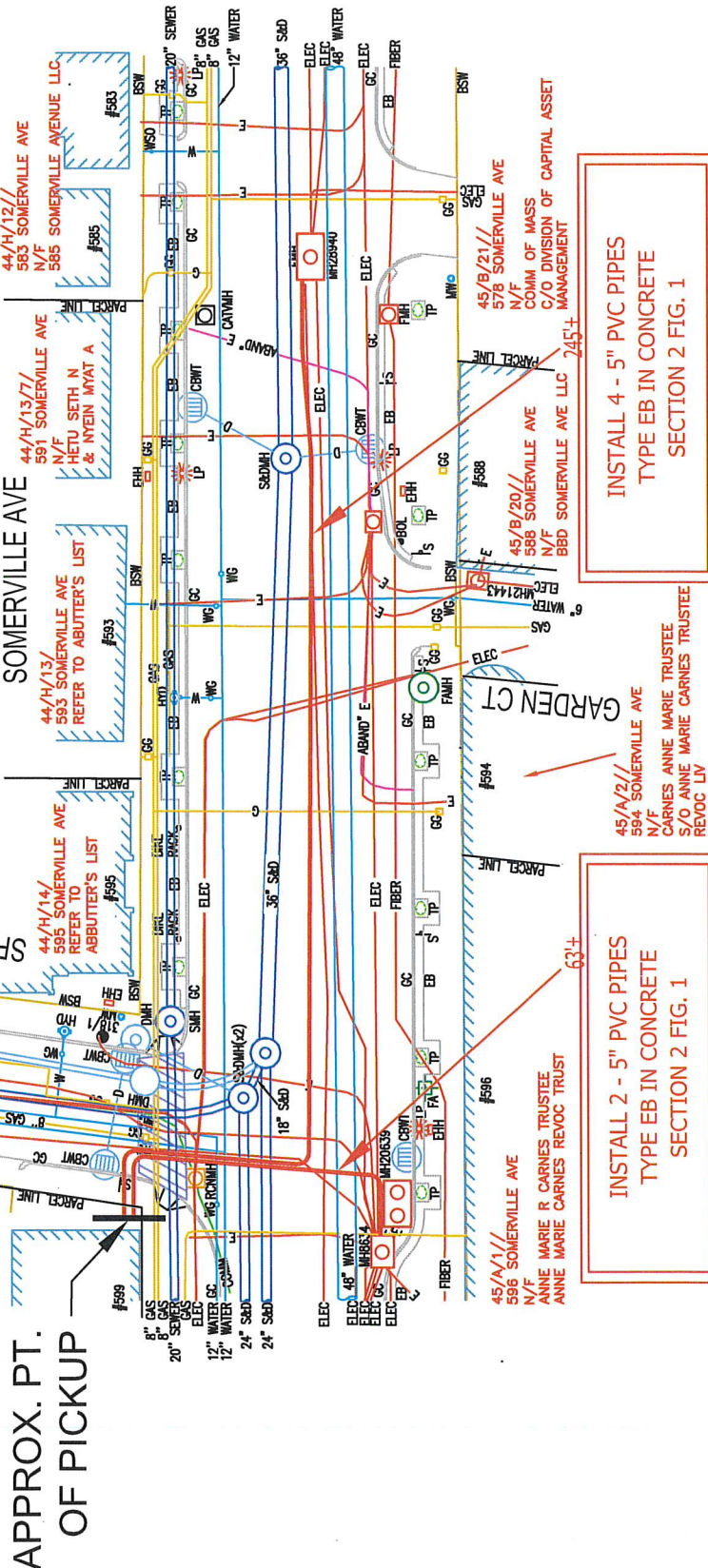

BY YOUR USE OF THE INFORMATION CONTAINED IN THIS MAP, YOU AGREE THAT NO WARRANTY OF ANY KIND, EXPRESS OR IMPLIED, IS GIVEN WITH RESPECT TO THE INFORMATION. NEITHER NSTAR ELECTRIC COMPANY, NSTAR GAS COMPANY NOR ITS PARENTS, AFFILIATES, OFFICERS, DIRECTORS, SHAREHOLDERS, EMPLOYEES OR AGENTS (COLLECTIVELY THE "NSTAR ENTITIES") SHALL BE LIABLE FOR ANY LOSS OR INJURY CAUSED IN WHOLE OR IN PART BY USE OF THIS INFORMATION, OR IN RELIANCE UPON IT, TO THE MAXIMUM EXTENT ALLOWED BY LAW. YOU AGREE BY YOUR ACCEPTANCE OF THE INFORMATION TO RELEASE, INDEMNIFY AND HOLD THE NSTAR ENTITIES HARMLESS FROM ANY SUCH LOSS OR INJURY.

THE INFORMATION MAY NOT REPRESENT A SURVEY, MAY NOT BE THE MOST COMPLETE AND IS SUBJECT TO CHANGE WITHOUT NOTICE. NO LIABILITY IS ASSUMED FOR THE ACCURACY OF THE INFORMATION, EITHER EXPRESSED OR IMPLIED. UNAUTHORIZED ATTEMPTS TO MODIFY THE INFORMATION OR USE THE INFORMATION FOR OTHER THAN ITS INTENDED PURPOSES ARE PROHIBITED.

**MASS. LAW**  
REQUIRES 72 HOURS ADVANCE NOTICE TO UTILITY COMPANIES BEFORE DIGGING BY ANYONE. CALL DIG-SAFE 1-888-344-7233



SCALE IN FEET

**NSTAR EVERSOURCE**  
Electric  
d/b/a  
1165 MASSACHUSETTS AVE. DORCHESTER, MASS. 02125

Plan of SOMERVILLE AVENUE  
SOMERVILLE  
PROPOSED CONDUIT LOCATION

C# 19-22  
Ward #  
Work Order # 5708894  
Surveyed by: SJ/GR  
Research by: JC  
Plotted by: BP  
Proposed Structures: BP  
Approved: T THIBAUT  
P#

Scale 1"=40'  
Date 01/15/2022  
SHEET 1 of 1

**WO# 5708894**  
**SOMERVILLE AVENUE**  
**SOMERVILLE, MA**

44/1/6/6  
6 SPRING ST #6  
N/F  
SHULMAN MICHAEL & LERNER DANIELE  
6 SPRING ST #6  
SOMERVILLE, MA 02143

44/1/6/8  
6 SPRING ST #8  
N/F  
AGRAWAL SAURABH & SHAH SHAILY  
6 SPRING ST #8  
SOMERVILLE, MA 02143

44/H/1//  
9 SPRING ST  
N/F  
FERNANDES ANTONIO D & MARIA C  
TRSTEES  
9 SPRING STREET NOMINEE TRUST  
9 SPRING ST  
SOMERVILLE, MA 02143

44/H/11//  
577 SOMERVILLE AVE  
N/F  
CHAN PETER HAK SANG & LAI YING  
PO BOX 536  
MILTON, MA 02186

45/B/21//  
578 SOMERVILLE AVE  
N/F  
COMM OF MASS  
C/O DIVISION OF CAPITAL ASSET  
MANAGEMENT  
ONE ASHBURTON PL 15<sup>TH</sup> FL  
BOSTON, MA 02108

44/H/12//  
583 SOMERVILLE AVE  
N/F  
585 SOMERVILLE AVENUE LLC  
P.O. BOX 44320  
SOMERVILLE, MA 02144

45/B/20//  
588 SOMERVILLE AVE  
N/F  
BBD SOMERVILLE AVE LLC  
99 CRESCENT AVE  
CHELSEA, MA 02150

44/H/13/7/  
591 SOMERVILLE AVE #7  
N/F  
HETU SETH N & NYEIN MYAT A  
591 SOMERVILLE AVE #7  
SOMERVILLE, MA 02143

44/H/13/1  
593 SOMERVILLE AVE #1  
N/F  
YANG PETER & NIZZA SUZANNE  
S/O SCHUMAN ARIEL & THAYER SAMUEL  
593 SOMERVILLE AVE #1  
SOMERVILLE, MA 02143

44/H/13/2  
593 SOMERVILLE AVE #2  
N/F  
KOCHARIAN NAIRA  
593 SOMERVILLE AVE #2  
SOMERVILLE, MA 02143

44/H/13/3  
593 SOMERVILLE AVE #3  
N/F  
GAN JOSHUA & GREEN SARA J  
S/O GAN JOSHUA & GREEN SARA J  
TRUSTEES  
593 SOMERVILLE AVE #3  
SOMERVILLE, MA 02143

**WO# 5708894**  
**SOMERVILLE AVENUE**  
**SOMERVILLE, MA**

44/H/13/4  
593 SOMERVILLE AVE #4  
N/F  
CHIRASEVINUPRAPHAND DENNIS  
HSU EVELEEN S  
593 SOMERVILLE AVE #4  
SOMERVILLE, MA 02143

44/H/13/5  
593 SOMERVILLE AVE #5  
N/F  
WANG NING & ZHANG YUCHEN  
593 SOMERVILLE AVE #5  
SOMERVILLE, MA 02143

44/H/13/6  
593 SOMERVILLE AVE #6  
N/F  
GAMBINO EMILY & MORESHEAD EVAN  
593 SOMERVILLE AVE #6  
SOMERVILLE, MA 02143

44/H/13/A/  
593 SOMERVILLE AVE #A  
N/F  
AUGMENT INVESTMENTS LLC  
4 TROWBRIDGE ST #2D  
CAMBRIDGE, MA 02138

44/H/13/B  
593 SOMERVILLE AVE #B  
N/F  
DOGRA SAMEER & NAGI SONIA  
32 STOWELL RD  
BEDFORD, MA 03110

45/A/2//  
594 SOMERVILLE AVE  
N/F  
CARNES ANNE MARIE TRUSTEE  
S/O ANNE MARIE CARNES TRUSTEE  
RELOC LIV  
3333 NE 34<sup>TH</sup> ST, UNIT 1608  
FORT LAUDERDALE, FL 33308

44/H/14/1/  
595 SOMERVILLE AVE #1  
N/F  
DENG EDDIE L & LIN CHAOCHUN  
595 SOMERVILLE AVE #1  
SOMERVILLE, MA 02143

44/H/14/2/  
595 SOMERVILLE AVE #2  
N/F  
CHEN YIJING  
777 TREMONT ST UNIT #3  
BOSTON, MA 02118

44/H/14/3/  
595 SOMERVILLE AVE #3  
N/F  
SENECHAL THIBAUD  
595 SOMERVILLE AVE #3  
SOMERVILLE, MA 02143

44/H/14/4/  
595 SOMERVILLE AVE #4  
N/F  
NICHOLSON PHILLIP D  
MIKEDIS MARIA M  
595 SOMERVILLE AVE #4  
SOMERVILLE, MA 02143

44/H/14/A/  
595 SOMERVILLE AVE #A  
N/F  
PIAZZA LLC  
595 SOMERVILLE AVE #A  
SOMERVILLE, MA 02143

45/A/1//  
596 SOMERVILLE AVE  
N/F  
ANNE MARIE R CARNES TRUSTEE  
ANNE MARIE CARNES REVOC TRUST  
3333 NE 34<sup>TH</sup> ST UNIT #1608  
FORT LAUDERDALE, FL 33308

**WO# 5708894**  
**SOMERVILLE AVENUE**  
**SOMERVILLE, MA**

44/1/7//  
599 SOMERVILLE AVE  
N/F  
599 SOMERVILLE VENTURES LLC  
251 LITTLE FALLS DRIVE  
WILMINGTON, DE 19808