



CITY OF SOMERVILLE

Commonwealth of Massachusetts
93 Highland Avenue
Somerville, MA 02143
(617) 625-6600

BUSINESS LICENSE APPLICATION - Grant of Location

File #: 24-004824

License #: BL24-000053

Address: 105 ALEWIFE BROOK PKWY

Licensee: Angel Hart NSTAR Electric dba Eversource Energy

DBA Name: EVERSOURCE ENERGY

Business Ownership Type: Corporation

Legal Name of Entity: NSTAR ELECTRIC dba EVERSOURCE ENERGY

Owners/Officers: JOSEPH NOLAN JR, , ,

License Information:

Grant of location issued to: NSTAR ELECTRIC COMPANY dba EVERSOURCE ENERGY

Describe the reason for the work, and the intended beneficiaries: TO INSTALL 12 FEET OF CONDUIT

Insert here the same detailed description of the work as appears in the attached Grant of Location Order: BROADWAY – Easterly from MH12332 to Alewife Brook Parkway, install approximately 12' of conduit WO# 11302311

Approval Conditions:

Approved By:

Isabela Maia, Approved with Conditions

APPROVAL CONDITION IMM 240313: This Grant of Location license reviews only the installation of approximately 12 feet of conduit on Broadway. The majority of installation takes place on DCR jurisdiction.

APPROVAL CONDITION IMM 240313: Any work requiring the use of the street and/or sidewalk will require a Street/Sidewalk Opening Permit from the Engineering Department. Apply via Citizen Serve before conduit installation.

APPROVAL CONDITION IMM 240313: Provide the City a copy of approved MWRA 8(m) Permit when submitting for Street Opening permit.

APPROVAL CONDITION IMM 240313: Provide the City a copy of approved DCR Construction Access Permit when submitting for Street Opening permit.

Malik Drayton, Approved with Conditions

APPROVAL CONDITION: MD20240312: Contractor shall take all necessary precautions to avoid

damaging any tree or tree part with equipment. APPROVAL CONDITION: MD20240312 All nearby street tree(s) shall be protected prior to and during all construction activities using TREE BOX or TREE WRAPS. . TREE BOX shall be constructed from 2 in. x 4 in. lumber creating a box around the border of the tree pit with 2 in. x 4 in. lumber standing straight up at the corners and wrapped with orange snow fence. Detail attached. . TREE WRAPS (TREE TRUNK WRAPPING PROTECTION LUMBER) shall consist of 2 in. x 4 in. and 8 ft. height lumber wired together in close spacing with zip ties or 16 gauge galvanized steel wire to form a protective enclosure around tree trunks. Use burlap to separate the wood from the bark if necessary to prevent wood from scraping or bruising bark. Do not use staples or puncture the trunk in any way. APPROVAL CONDITION: MD20240312: Any tree roots less than two (2) inches in diameter that cannot be avoided during construction shall be carefully and cleanly cut with a clean pair of pruning shears or loppers. Roots are to be cut back flush with the edge of the trench. If any tree roots greater than two (2) inches in diameter are encountered, stop work immediately and contact the City Urban Forester. Any and all pruning of roots greater than 2 inches in diameter must be completed under the supervision of the City Urban Forester.

APPROVAL CONDITION: MD20240312 All nearby street tree(s) shall be protected prior to and during all construction activities using TREE BOX or TREE WRAPS. . TREE BOX shall be constructed from 2 in. x 4 in. lumber creating a box around the border of the tree pit with 2 in. x 4 in. lumber standing straight up at the corners and wrapped with orange snow fence. Detail attached. . TREE WRAPS (TREE TRUNK WRAPPING PROTECTION LUMBER) shall consist of 2 in. x 4 in. and 8 ft. height lumber wired together in close spacing with zip ties or 16 gauge galvanized steel wire to form a protective enclosure around tree trunks. Use burlap to separate the wood from the bark if necessary to prevent wood from scraping or bruising bark. Do not use staples or puncture the trunk in any way.

APPROVAL CONDITION: MD20240312: Any tree roots less than two (2) inches in diameter that cannot be avoided during construction shall be carefully and cleanly cut with a clean pair of pruning shears or loppers. Roots are to be cut back flush with the edge of the trench. If any tree roots greater than two (2) inches in diameter are encountered, stop work immediately and contact the City Urban Forester. Any and all pruning of roots greater than 2 inches in diameter must be completed under the supervision of the City Urban Forester.

Eric Weisman, Approved

Kimberly M. Wells, Approved



CITY OF SOMERVILLE, MASSACHUSETTS
CITY CLERK'S OFFICE
KATJANA BALLANTYNE
MAYOR

KIMBERLY M. WELLS
CITY CLERK

March 19, 2024

NOTICE OF PUBLIC HEARING

You are hereby notified that the Somerville City Council will hold a Public Hearing on the following Petition. You are receiving this Notice because the Petitioner has reported that you own property that abuts the work that is being proposed. You and other members of the public are invited to attend and be heard at this Hearing.

This meeting of the City Council will also be conducted via remote participation, online in a webinar hosted on the Zoom platform.

You have three ways to be heard at this meeting:

1. To attend and be heard, enter the link exactly as it appears below into your internet browser any time before the meeting. You will then be asked to register for the meeting. After registering, you will receive an email with instructions to join the webinar when it starts.
2. You may also testify in person in the City Council Chamber, City Hall, 2nd Floor, 93 Highland Avenue, Somerville, MA 02143
3. If you are unable to attend but wish to be heard, you may send written comments by US mail to the City Clerk at the address below, or by email to cityclerk@somervillema.gov. Your comments must arrive no later than 12 Noon on the day of the Hearing, in order to be sure they are conveyed to the Council.

PETITION: Eversource (NStar Electric) is applying for a Grant of Location to install 12 feet of conduit in Alewife Brook Parkway, from Manhole 12332 at the intersection of Alewife Brook Parkway and Broadway.

PLACE: https://us02web.zoom.us/webinar/register/WN_8xeOG02qQNqIWJ2oht4Z6g or City Council Chambers, City Hall, 2nd Floor, 93 Highland Avenue, Somerville, MA 02143

TIME: Thursday, March 28, 2024, at 7:00 PM.

PURPOSE: The work is necessary to accommodate increased load demand.

W.O. #11302311

EVERSOURCE
101 Linwood Street
Somerville, MA 02143

March 3, 2024

Ms. Kimberly Wells
Office of the City Clerk
105 Alewife Brook Pkwy
Somerville, MA 02143

RE: Alewife Brook Pkwy
W.O. #11302311

Dear Members of the Board,

The NSTAR Electric Company d/b/a Eversource Energy respectfully requests a Grant of Location for the installation of approximately 12 feet of conduit.

This work is necessary for capital improvement to accommodate increased load demand.

If you have any questions or concerns, please call Jacqueline Duffy at 617-629-3204.

Very truly yours,

Kelly-Ann Correia

Kelly-Ann Correia
Supervisor, Rights and Permits

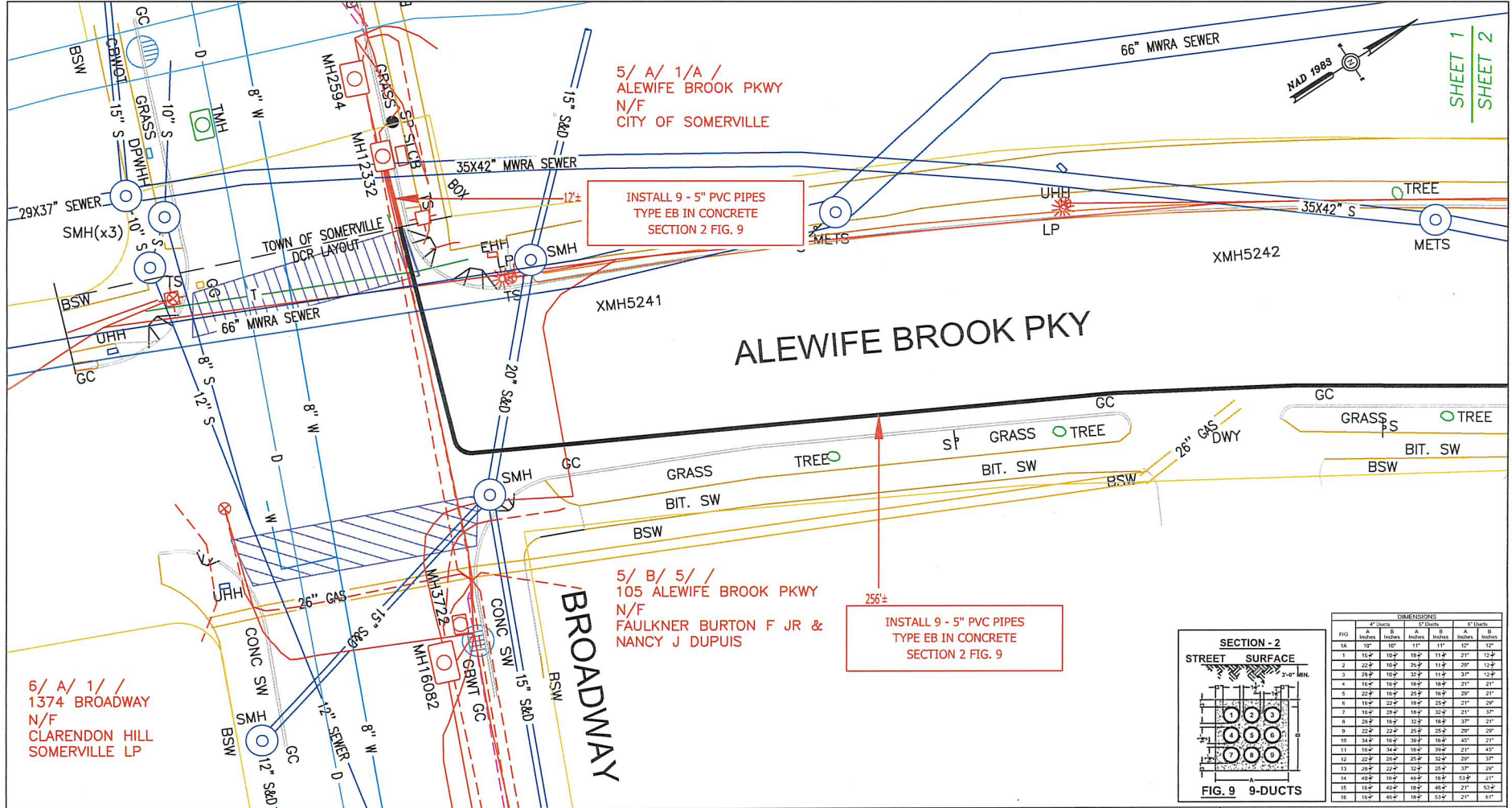

5/ A/ 1/A /
ALEWIFE BROOK PKWY
N/F
CITY OF SOMERVILLE

INSTALL 9 - 5" PVC PIPES
TYPE EB IN CONCRETE
SECTION 2 FIG. 9

5/ B/ 5/ /
105 ALEWIFE BROOK PKWY
N/F
FAULKNER BURTON F JR &
NANCY J DUPUIS

INSTALL 9 - 5" PVC PIPES
TYPE EB IN CONCRETE
SECTION 2 FIG. 9

6/ A/ 1/ /
1374 BROADWAY
N/F
CLARENDON HILL
SOMERVILLE LP

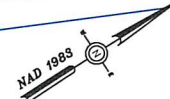

SHEET 1
SHEET 2

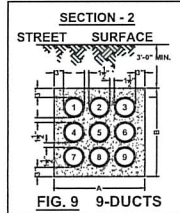
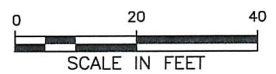

DUCT	4" Ducts			6" Ducts		
	A, Inches	B, Inches	C, Inches	A, Inches	B, Inches	C, Inches
1	10"	10"	18"	11"	21"	12"
2	22"	10"	25"	11"	29"	12"
3	26"	10"	32"	11"	37"	12"
4	10"	10"	18"	18"	21"	21"
5	22"	18"	25"	18"	29"	21"
6	18"	22"	18"	25"	21"	29"
7	18"	26"	18"	32"	21"	37"
8	26"	18"	32"	18"	37"	21"
9	22"	22"	25"	25"	29"	29"
10	34"	18"	39"	18"	45"	21"
11	18"	30"	18"	39"	21"	45"
12	22"	26"	25"	32"	29"	37"
13	26"	22"	32"	25"	37"	29"
14	40"	18"	45"	18"	51"	21"
15	18"	40"	18"	48"	21"	51"
16	18"	44"	18"	53"	21"	61"

FIG. 9 9-DUCTS

BY YOUR USE OF THE INFORMATION CONTAINED IN THIS MAP, YOU AGREE THAT NO WARRANTY OF ANY KIND, EXPRESS OR IMPLIED, IS GIVEN WITH RESPECT TO THE INFORMATION. NEITHER NESTAR ELECTRIC COMPANY, NESTAR GAS COMPANY NOR ITS PATENTS, AFFILIATES, OFFICERS, DIRECTORS, SHAREHOLDERS, EMPLOYEES OR AGENTS (COLLECTIVELY THE "NESTAR ENTITIES") SHALL BE LIABLE FOR ANY LOSS OF PROFIT CAUSED BY WHOLE OR IN PART BY USE OF THIS INFORMATION, OR IN RELIANCE UPON IT, TO THE MAXIMUM EXTENT ALLOWED BY LAW, YOU AGREE BY YOUR ACCEPTANCE OF THE INFORMATION TO RELEASE, INDEMNIFY AND HOLD THE NESTAR ENTITIES HARMLESS FROM ANY SUCH LOSS OR LIABILITY.

THE INFORMATION MAY NOT REPRESENT A SURVEY, MAY NOT BE THE MOST COMPLETE, AND IS SUBJECT TO CHANGE WITHOUT NOTICE. NO LIABILITY IS ASSIGNED FOR THE ACCURACY OF THE INFORMATION, EITHER EXPRESSED OR IMPLIED, UNLESS IT IS ATTEMPTED TO NEARLY THE INFORMATION OR USE THE INFORMATION FOR OTHER THAN ITS INTENDED PURPOSES ARE PROHIBITED.

MASS LAW
REQUIRES 72 HOURS ADVANCE NOTICE TO UTILITY COMPANIES BEFORE DIGGING BY ANYONE. CALL DIG-SAFE 1-888-344-7233

C# 176-23	
Ward #	
Work Order # 11302311	1165 MASSACHUSETTS AVE. DORCHESTER, MASS. 02125
Surveyed by: VI/BP	Plan of ALEWIFE BROOK PARKWAY
Research by: BP	SOMERVILLE
Plotted by: TL	Showing PROPOSED CONDUIT AND MANHOLE LOCATION
Proposed Structures: TL	
Approved: T THIBAUT	Scale 1"=20' Date JANUARY 02, 2024
P#	SHEET 1 of 2

SHEET 1
SHEET 2

INSTALL 9 - 5" PVC PIPES
TYPE EB IN CONCRETE
SECTION 2 FIG. 9

INSTALL CONCRETE MANHOLE
6.0' x 10.0' x 8.0' DEEP
SECTION 3 FIGURE 3

INSTALL 6 - 5" PVC PIPES
TYPE EB IN CONCRETE
SECTION 2 FIG. 5

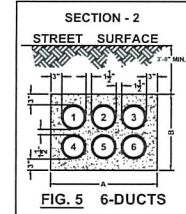

4" Ducts	DIMENSIONS			
	A	B	C	D
1	16"	10"	18"	21"
2	22"	10"	25"	29"
3	28"	10"	32"	37"
4	34"	10"	39"	45"
5	40"	10"	46"	53"
6	46"	10"	53"	61"
7	52"	10"	60"	69"
8	58"	10"	67"	77"
9	64"	10"	74"	85"
10	70"	10"	81"	93"
11	76"	10"	88"	101"
12	82"	10"	95"	109"
13	88"	10"	102"	117"
14	94"	10"	109"	125"
15	100"	10"	116"	133"
16	106"	10"	123"	141"

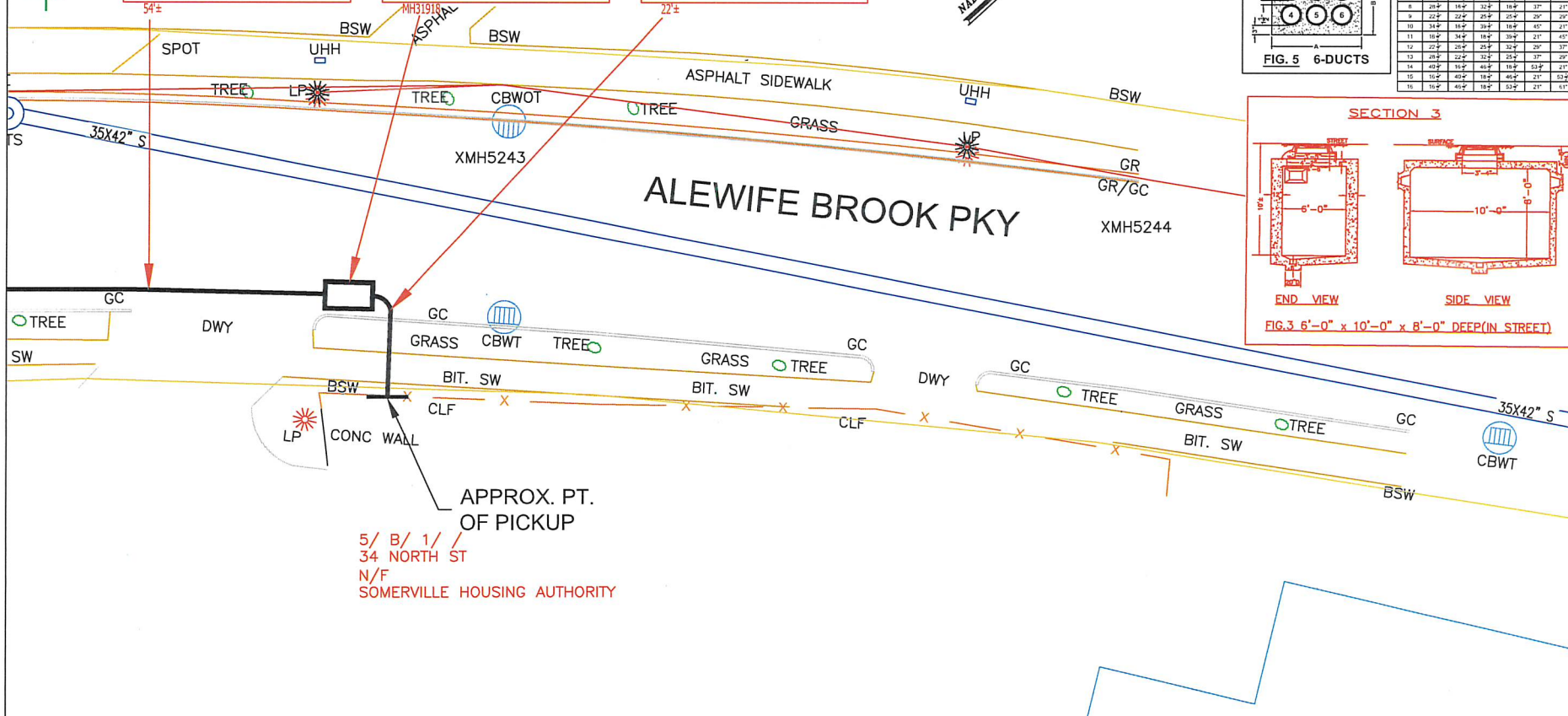
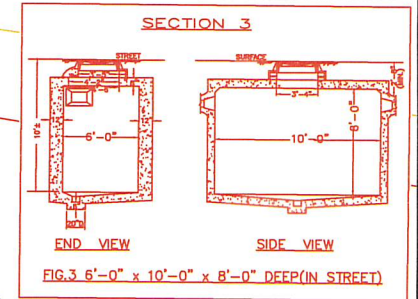

APPROX. PT.
OF PICKUP
5/ B/ 1/ /
34 NORTH ST
N/F
SOMERVILLE HOUSING AUTHORITY



BY YOUR USE OF THE INFORMATION CONTAINED IN THIS MAP YOU AGREE THAT NO WARRANTY OF ANY KIND, EXPRESS OR IMPLIED, IS GIVEN WITH RESPECT TO THE INFORMATION. NESTAR ELECTRIC COMPANY, NESTAR GAS COMPANY AND ITS AFFILIATES, OFFICERS, DIRECTORS, SHAREHOLDERS, EMPLOYEES OR AGENTS COLLECTIVELY (THE "NESTAR ENTITIES") SHALL BE LIABLE FOR ANY LOSS OR INJURY CAUSED IN WHOLE OR IN PART BY USE OF THIS INFORMATION OR IN RELIANCE UPON IT, TO THE MAXIMUM EXTENT ALLOWED BY LAW. YOU AGREE BY YOUR ACCEPTANCE OF THE INFORMATION TO RELEASE, INDEMNIFY AND HOLD THE NESTAR ENTITIES HARMLESS FROM ANY SUCH LOSS OR INJURY. THE INFORMATION MAY NOT REPRESENT A SURVEY. IT MAY NOT BE THE MOST COMPLETE AND IS SUBJECT TO CHANGE WITHOUT NOTICE. NO LIABILITY IS ASSUMED FOR THE ACCURACY OF THE INFORMATION, EITHER EXPRESSED OR IMPLIED. UNAUTHORIZED ATTEMPTS TO REPLY THE INFORMATION OR USE THE INFORMATION FOR OTHER THAN ITS INTENDED PURPOSES ARE PROHIBITED.

MASS. LAW
REQUIRES 72 HOURS ADVANCE NOTICE TO UTILITY COMPANIES
BEFORE DIGGING BY ANYONE. CALL DIG-SAFE 1-888-344-7233

C# 176-23
Ward #
Work Order # 11302311
Surveyed by: VT/BP
Research by: BP
Plotted by: TL
Proposed Structures: TL
Approved: T THIBAUT
P#

NSTAR EVERSOURCE
Electric
1185 MASSACHUSETTS AVE. DORCHESTER, MASS. 02125

Plan of ALEWIFE BROOK PARKWAY
SOMERVILLE
Showing PROPOSED CONDUIT AND MANHOLE LOCATION

Scale 1"=20' Date JANUARY 02, 2024
SHEET 2 of 2

CITY OF SOMERVILLE
93 HIGHLAND AVE
SOMERVILLE, MA 02144 USA

CLARENDON HILL SOMERVILLE LP
1372 BROADWAY
SOMERVILLE, MA 02144 USA

COMM OF MASS
ONE ASHBURTON PL 15TH FL
BOSTON, MA 02108 USA

FAULKNER BURTON F JR &
PO BOX 6500
CARLISLE, PA 17013 USA

SOMERVILLE HOUSING AUTHORITY
30 MEMORIAL RD
SOMERVILLE, MA 02144 USA