

CITY OF SOMERVILLE ORDINANCE NO. _____
IN THE BOARD OF ALDERMEN: _____

AN ORDINANCE AMENDING THE SOMERVILLE ZONING MAP TO EXTEND A RESIDENCE A ZONING DISTRICT ALONG PORTER STREET BETWEEN SUMMER STREET AND ELM STREET, INCLUDING PROPERTIES ON PORTER STREET, SUMMER STREET, GUSSIE TERRACE, CARVER STREET, WILLIAMS COURT, PARKER PLACE, GOULD AVENUE, EVERGREEN SQ, AND ARNOLD AVENUE.

WHEREAS, the city desires to protect the residential neighborhood of modest one- to three-family homes along and around the block of Porter Street between Summer Street and Elm Street; and,

WHEREAS, the current RB zoning district permits oversized additions to residential buildings; and,

WHEREAS, the current RB zoning district does not protect the built heritage of this area;

THEREFORE, be it adopted by the Board of Aldermen, in session assembled, that the Somerville Zoning Ordinance map is hereby amended by extending the Residence A (RA) zoning district to replace the RB zoning district encompassing the following parcels:

MBL	HOUSE_N O	STREET	MBL	HOUSE_N O	STREET
38-A-21	15	PORTER ST	36-B-6	232	SUMMER ST
38-A-31	41	PORTER ST	35-G-28	227	SUMMER ST
38-A-22	17	PORTER ST	35-G-27	227	SUMMER ST
36-C-35	5	PARKER PL	36-B-8	52	PORTER ST
36-C-24	1	WILLIAMS CT	36-B-9	50	PORTER ST
38-A-37	226	SUMMER ST	36-B-11	14	PETERSON TERR
38-A-14	11	PORTER ST	36-B-10	48	PORTER ST
36-C-38	10	PORTER ST	36-C-4	13	PETERSON TERR
38-A-5	16	EVERGREEN SQ	36-C-6	44	PORTER ST
38-A-2	3	EVERGREEN SQ	36-C-5	46	PORTER ST
38-A-38	224	SUMMER ST	38-A-36	51	PORTER ST
36-C-13	9	CARVER ST	38-A-35	49	PORTER ST
38-A-30	39	PORTER ST	36-C-8	0	GUSSIE TERR
36-C-16	1	CARVER ST	38-A-34	47	PORTER ST
38-A-29	37	PORTER ST	36-C-7	40	PORTER ST
38-A-32	43	PORTER ST	36-C-10	38	PORTER ST
36-C-11	36	PORTER ST	36-C-20	10	CARVER ST
38-A-20	15	PORTER ST	38-A-28	35	PORTER ST
38-A-19	7	GOULD AVE	36-C-26	6	WILLIAMS CT
36-C-22	7	WILLIAMS CT	36-C-19	8	CARVER ST
38-A-33	45	PORTER ST	38-A-27	33	PORTER ST

38-A-8	10	EVERGREEN SQ	36-C-18	4	CARVER ST
38-A-7	12	EVERGREEN SQ	36-C-23	5	WILLIAMS CT
36-B-7	56	PORTER ST	36-C-36	14	PORTER ST
38-A-12	2	EVERGREEN SQ	36-C-37	12	PORTER ST
36-C-28	12	WILLIAMS CT	36-C-33	12	PARKER PL
38-A-25	27	PORTER ST	38-A-23	19	PORTER ST
36-C-27	8	WILLIAMS CT	36-C-32	8	PARKER PL
36-C-21	11	WILLIAMS CT	36-C-30	18	PORTER ST
36-C-17	2	CARVER ST	36-C-31	16	PORTER ST
38-A-10	6	EVERGREEN SQ	36-C-34	9	PARKER PL
38-A-9	8	EVERGREEN SQ	38-A-15	5	ARNOLD AVE
38-A-24	23	PORTER ST	38-A-13	9	PORTER ST
36-C-25	2	WILLIAMS CT	36-C-39	8	PORTER ST
36-C-29	22	PORTER ST	38-A-16	9	ARNOLD AVE
38-A-26	31	PORTER ST	38-A-11	4	EVERGREEN SQ
35-H-22	70	PORTER ST	38-A-6	14	EVERGREEN SQ
35-H-23	66	PORTER ST	38-A-3	7	EVERGREEN SQ
35-H-24	64	PORTER ST	36-C-14	7	CARVER ST
36-B-5	234	SUMMER ST	36-C-15	7	CARVER ST
38-A-18	9	GOULD AVE	36-C-12	10	GUSSIE TERR
35-G-29	229	SUMMER ST	36-C-9	10	GUSSIE TERR

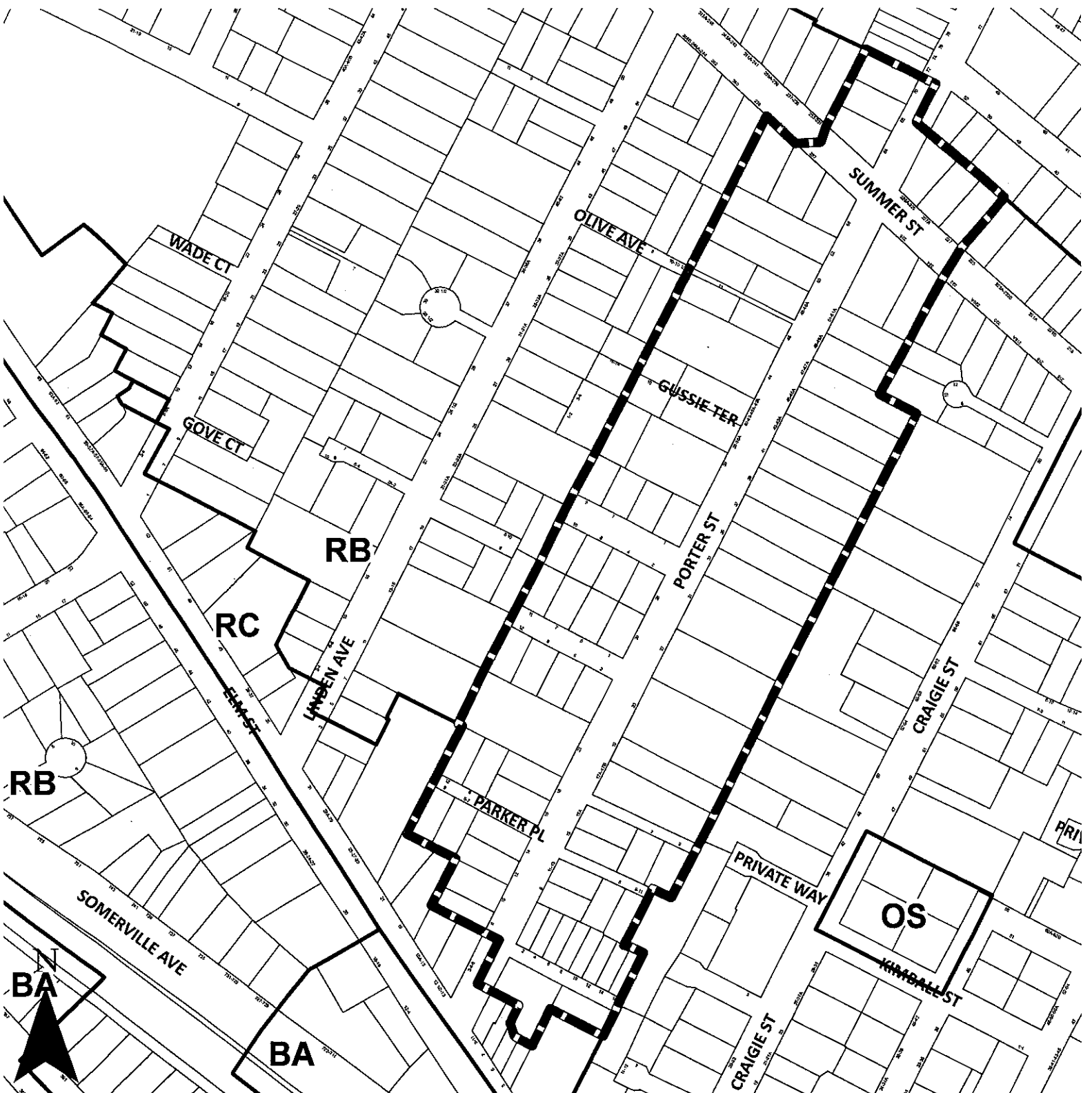

WADE CT

GOVE CT

OLIVE AVE

SUMMER ST

GUSSIE TER

RB

PORTER ST

RC

LINSEN AVE

RB

PARKER PL

CRAIGIE ST

SOMERVILLE AVE

PRIVATE WAY

OS

BA

BA

CRAIGIE ST

KIMBALL ST

PRV

