

VICINITY MAP  
NOT TO SCALE

**TC SYSTEMS, INC**  
An Affiliate of  **AT&T**

# PROPOSED CONDUIT PLACEMENT WASHINGTON STREET AT MAGNUS AVENUE SOMERVILLE, MA

CONDUIT CONSTRUCTION PLANS  
MIDDLESEX COUNTY  
JULY 28, 2020  
PERMIT ISSUE

**PRELIMINARY**  
NOT FOR CONSTRUCTION



50 Mall Road, Suite 203, Burlington, MA 01803  
p 781.221.8400 f 781.221.7117

SIENA ENGINEERING GROUP, INC.  
 18-14300 Node 14 - Washington St. At Dane St. Somerville,  
 MA.dwg  
 Edited: July 15, 2020 - 2:13 PM  
 Plotted: July 28, 2020 - 3:09 PM by joseph connor - \_Sienna.ctb

# LIST OF DRAWINGS

|       |  |
|-------|--|
|       | COVER  |
| PT001 | LIST OF DRAWINGS                               |
| PT002 | LEGEND & REFERENCES                            |
| DN001 | PROPOSED CONDUIT PLACEMENT PLAN                |
| DT001 | TYPICAL TRENCH & SURFACE RESTORATION DETAILS   |
| DT002 | PROPOSED HANDHOLE & HANDHOLE PLACEMENT DETAILS |
| DT003 | PROPOSED UTILITY RISER DETAIL                  |

|                               |                  |
|-------------------------------|------------------|
| <b>ISSUE DATE:</b>            | <b>INITIALS:</b> |
| 1. JULY 28, 2020 PERMIT ISSUE | JCC              |

**PRELIMINARY**  
 NOT FOR CONSTRUCTION

**NOTES:**

1. SUBSURFACE UTILITY LINES, AS SHOWN HEREON, WERE COMPILED ACCORDING TO AVAILABLE RECORD INFORMATION FROM THE REFERENCED COMPANIES AND PUBLIC AGENCIES, AND THEIR LOCATIONS ARE APPROXIMATE ONLY. ACTUAL LOCATIONS MUST BE DETERMINED IN THE FIELD PRIOR TO ANY CONSTRUCTION ACTIVITIES. SIENA ENGINEERING GROUP ASSUMES NO RESPONSIBILITY FOR DAMAGES INCURRED AS A RESULT OF UTILITIES OMITTED OR INACCURATELY SHOWN.



**Call before you dig.**

**AT&T PROPRIETARY**  
 (Internal Use Only)

Not for disclosure outside the AT&T companies, except under written agreement.

2019 AT&T Intellectual Property, All Rights Reserved

AT&T PROPRIETARY-This information constitutes confidential trade secrets and commercial or financial information owned by AT&T and is shared for Critical Infrastructure Protection purposes only. It is exempt from disclosure under the Freedom of Information Act (5 U.S.C. 552), Exemptions (b)(3)&(4), and its disclosure is prohibited under the Trade Secrets Act (18 U.S.C. 1905), the Critical Infrastructure Information Act of 2002, 6 U.S.C. 133, and any State or local law requiring disclosure of information or records. This information must not be copied or distributed to others not agreed upon by AT&T, but in all events do not copy or distribute to such others without notification pursuant to Executive Order 12600.

PREPARED FOR RECORD

|                    |          |      |
|--------------------|----------|------|
| APPROVED FOR _____ | ENGINEER | DATE |
| OUTSIDE PLANT      |          |      |

**TC SYSTEMS, INC**  
 An Affiliate of **AT&T**



|                            |                        |
|----------------------------|------------------------|
| DRAWN BY: J. CONNOR        | CHECKED BY: D. PUCHALA |
| APPROVED BY: B. DORWART PE |                        |

**PROPRIETARY**  
 USE PURSUANT TO COMPANY INSTRUCTIONS

SPECIFICATION  
 PROJECT NUMBER

OWNERSHIP:  
 LINE CODE:  
 CABLE CLLI:

SCALE:

WASHINGTON STREET AT  
 MAGNUS AVENUE  
 SOMERVILLE, MA

LIST OF DRAWINGS

PT001

# PLANIMETRIC SYMBOL LEGEND

|       |                            |  |                                |  |                    |  |                           |
|-------|----------------------------|--|--------------------------------|--|--------------------|--|---------------------------|
|       | UTILITY POLE W/LIGHT       |  | TRAFFIC SIGNAL POLE            |  | SURVEY ANGLE POINT |  | AT&T SPLICE MANHOLE       |
| UP    | UTILITY POLE               |  | TRAFFIC SIGNAL POLE W/LUMINARE |  | SURVEY BENCH MARK  |  | AT&T MANHOLE              |
|       | UTILITY POLE ANCHOR        |  | TRAFFIC SIGNAL SUPPORT POLE    |  | SURVEY IRON PIPE   |  | AT&T HANDHOLE             |
|       | PAD MOUNTED TRANSFORMER    |  | FLASHING WARNING SYSTEM        |  | MONUMENT (IN CASE) |  | AT&T VAULT                |
| GM    | GAS METER                  |  | JUNCTION BOX                   |  | MONUMENT (SURFACE) |  | AT&T REGEN                |
| GG    | GAS VALVE                  |  | R/R CROSSING GATE              |  | BUS STOP           |  | AT&T MARKER (CABLE LEFT)  |
| TMH   | TELEPHONE MANHOLE          |  | R/R CROSSING SIGNAL            |  | MAIL BOX           |  | AT&T MARKER (CABLE RIGHT) |
| WM    | WATER METER                |  | SIGNAL CONTROLLER              |  | RIP RAP            |  | MILEPOST                  |
| HYD   | 2-NOZZLE FIRE HYDRANT      |  | SIGN BRIDGE                    |  | ROCKERY            |  | DEPTH OF CABLE NOTE       |
| HYD   | 3-NOZZLE FIRE HYDRANT      |  | CANTILEVERED SIGN              |  | SHRUBBERY          |  | ELECTRONIC MARKER BALL    |
| WG    | WATER GATE                 |  | SINGLE POST                    |  | SIGN               |  | ● TONE WIRE GROUND        |
| CO    | SEWER CLEAN OUT            |  | DOUBLE POST                    |  | CONIFER TREE       |  | ○ TONE WIRE MARKER POLE   |
| SMH   | SEWER MANHOLE              |  | COUNTY ROAD                    |  | DECIDUOUS TREE     |  | ○ TONE WIRE SPLICE        |
| DMH   | DRAIN MANHOLE              |  | INTERSTATE HIGHWAY             |  | LIGHT POLE         |  |                           |
| CB    | CATCH BASIN                |  | STATE HIGHWAY                  |  | WETLAND            |  |                           |
| VZ MH | VERIZON MANHOLE            |  | US HIGHWAY                     |  | WATER FLOW         |  |                           |
| IRHH  | IRRIGATION HANDHOLE        |  | MONITORING WELL                |  |                    |  |                           |
| EHH   | ELECTRIC HANDHOLE          |  |                                |  |                    |  |                           |
| EOUT  | ELECTRIC OUTLET            |  |                                |  |                    |  |                           |
| SLHH  | STREET LIGHT HANDHOLE      |  |                                |  |                    |  |                           |
| MAHH  | MASS HIGHWAY HANDHOLE      |  |                                |  |                    |  |                           |
| SWTB  | STORMWATER TREATMENT BASIN |  |                                |  |                    |  |                           |

# LINETYPE LEGEND

## EXISTING UTILITIES

|  |     |                       |
|--|-----|-----------------------|
|  | OHW | OVERHEAD WIRES        |
|  | E   | BURIED ELECTRIC LINE  |
|  | T   | BURIED TELEPHONE LINE |
|  | TV  | BURIED CABLE TV LINE  |
|  | SAN | SANITARY SEWER LINE   |
|  | SD  | STORM DRAIN LINE      |
|  | W   | WATER LINE            |
|  | G   | GAS LINE              |

## SURFACE FEATURES

|  |                 |  |                   |
|--|-----------------|--|-------------------|
|  | RAILROAD TRACKS |  | EASEMENT LINE     |
|  | DITCH           |  | PROPERTY LINE     |
|  | TREE LINE       |  | RIGHT-OF-WAY LINE |
|  | GUARD RAIL      |  | STONEWALL         |
|  | FENCE           |  |                   |
|  | RETAINING WALL  |  |                   |

## AT&T CONDUIT

PROPOSED BURIED CONDUIT

# REFERENCES & NOTES

1. ELECTRIC UTILITY INFORMATION PER RECORD PLANS PROVIDED BY EVERSOURCE.
2. TELECOM UTILITY INFORMATION PER RECORD PLANS PROVIDED BY VERIZON, LEVEL(3), AT&T, COMCAST AND TCG.
3. GAS UTILITY INFORMATION PER RECORD PLANS PROVIDED BY EVERSOURCE.
4. WATER, SEWER & DRAIN UTILITY INFORMATION PER RECORD PLANS PROVIDED BY CITY OF SOMERVILLE.

ISSUE DATE: INITIALS:  
1. JULY 28, 2020 PERMIT ISSUE JCC

**PRELIMINARY**  
**NOT FOR CONSTRUCTION**

NOTES:  
1. SUBSURFACE UTILITY LINES, AS SHOWN HEREON, WERE COMPILED ACCORDING TO AVAILABLE RECORD INFORMATION FROM THE REFERENCED COMPANIES AND PUBLIC AGENCIES, AND THEIR LOCATIONS ARE APPROXIMATE ONLY. ACTUAL LOCATIONS MUST BE DETERMINED IN THE FIELD PRIOR TO ANY CONSTRUCTION ACTIVITIES. SIENA ENGINEERING GROUP ASSUMES NO RESPONSIBILITY FOR DAMAGES INCURRED AS A RESULT OF UTILITIES OMITTED OR INACCURATELY SHOWN.



Call before you dig.

**AT&T PROPRIETARY**  
(Internal Use Only)

Not for disclosure outside the AT&T companies, except under written agreement.

2019 AT&T Intellectual Property, All Rights Reserved

AT&T PROPRIETARY-This information constitutes confidential trade secrets and commercial or financial information owned by AT&T and is shared for Critical Infrastructure Protection purposes only. It is exempt from disclosure under the Freedom of Information Act (5 U.S.C. 552), Exemptions (b)(3)&(4), and its disclosure is prohibited under the Trade Secrets Act (18 U.S.C. 1905), the Critical Infrastructure Information Act of 2002, 6 U.S.C. 133, and any State or local law requiring disclosure of information or records. This information must not be copied or distributed to others not agreed upon by AT&T, but in all events do not copy or distribute to such others without notification pursuant to Executive Order 12600.

PREPARED FOR RECORD

APPROVED FOR: ENGINEER DATE  
OUTSIDE PLANT

**TC SYSTEMS, INC**  
An Affiliate of **AT&T**

**SIENA**  
ENGINEERING GROUP INC.  
50 Mill Road, Suite 203, Burlington, MA 01803  
978-251-8400 FAX: 978-251-7177

DRAWN BY: J. CONNOR  
CHECKED BY: D. PUCHALA  
APPROVED BY: B. DORWART PE

PROPRIETARY  
USE PURSUANT TO COMPANY INSTRUCTIONS  
SPECIFICATION  
PROJECT NUMBER

OWNERSHIP:  
LINE CODE:  
CABLE CLLI:

SCALE:

WASHINGTON STREET AT  
MAGNUS AVENUE  
SOMERVILLE, MA

LEGEND & REFERENCES

PT002

**SOMERVILLE  
MIDDLESEX COUNTY  
MASSACHUSETTS**

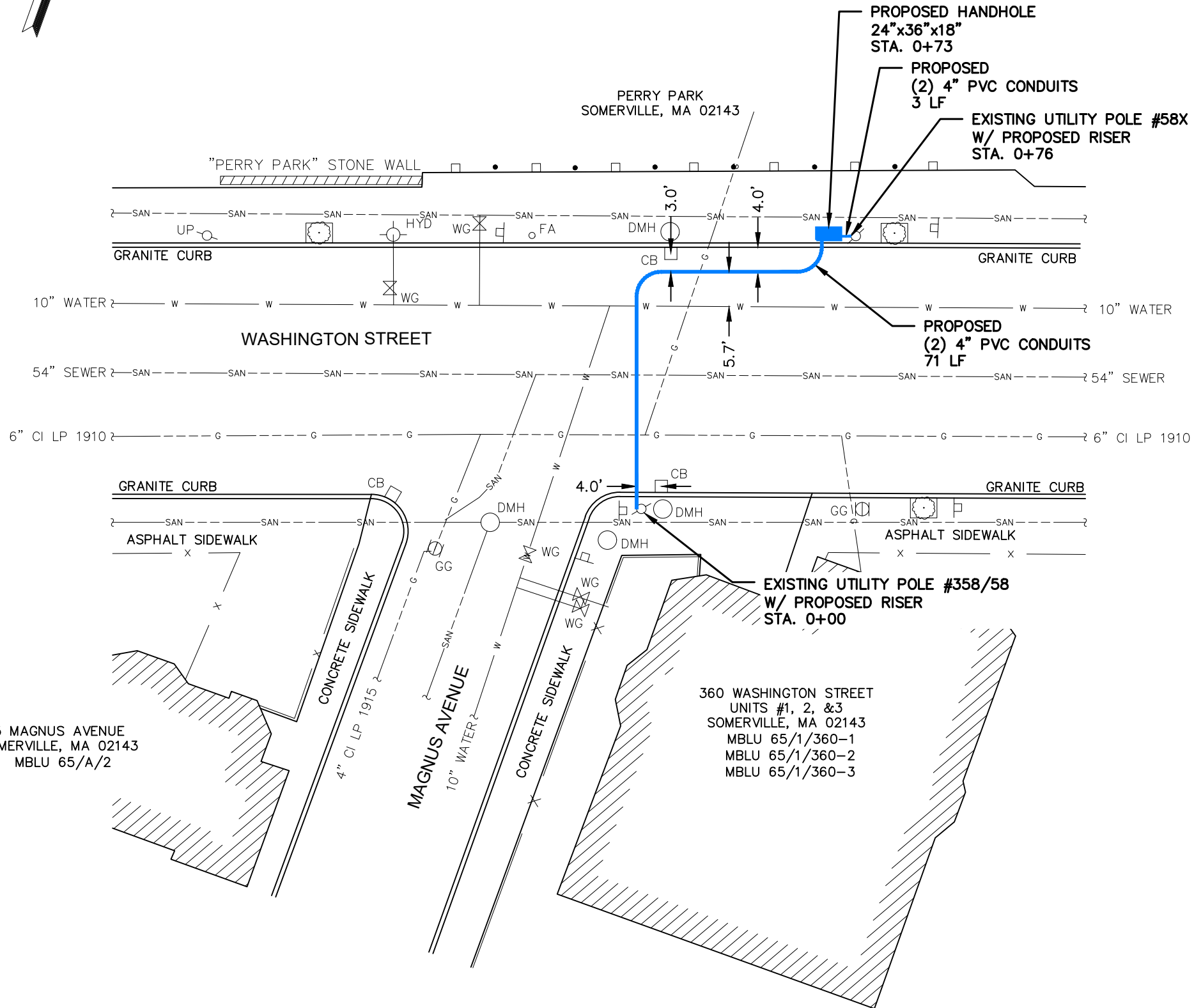
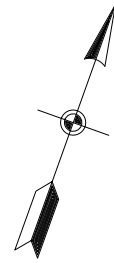

5 MAGNUS AVENUE  
SOMERVILLE, MA 02143  
MBLU 65/A/2

360 WASHINGTON STREET  
UNITS #1, 2, &3  
SOMERVILLE, MA 02143  
MBLU 65/1/360-1  
MBLU 65/1/360-2  
MBLU 65/1/360-3

SIENA ENGINEERING GROUP, INC.  
18-14300 Node 14 - Washington St At Dane St-Somerville,  
MA.dwg  
Edited: July 15, 2020 - 2:13 PM  
Plotted: July 28, 2020 - 3:09 PM by joseph connor - \_Sienna.ctb

ISSUE DATE: 1. JULY 28, 2020 PERMIT ISSUE INITIALS: JCC

**PRELIMINARY  
NOT FOR CONSTRUCTION**

**NOTES:**  
1. SUBSURFACE UTILITY LINES, AS SHOWN HEREON, WERE COMPILED ACCORDING TO AVAILABLE RECORD INFORMATION FROM THE REFERENCED COMPANIES AND PUBLIC AGENCIES, AND THEIR LOCATIONS ARE APPROXIMATE ONLY. ACTUAL LOCATIONS MUST BE DETERMINED IN THE FIELD PRIOR TO ANY CONSTRUCTION ACTIVITIES. SIENA ENGINEERING GROUP ASSUMES NO RESPONSIBILITY FOR DAMAGES INCURRED AS A RESULT OF UTILITIES OMITTED OR INACCURATELY SHOWN.



**Call before you dig.**

**AT&T PROPRIETARY**  
(Internal Use Only)

Not for disclosure outside the AT&T companies, except under written agreement.

2019 AT&T Intellectual Property, All Rights Reserved

AT&T PROPRIETARY-This information constitutes confidential trade secrets and commercial or financial information owned by AT&T and is shared for Critical Infrastructure Protection purposes only. It is exempt from disclosure under the Freedom of Information Act (5 U.S.C. 552), Exemptions (b)(3)&(4), and its disclosure is prohibited under the Trade Secrets Act (18 U.S.C. 1905), the Critical Infrastructure Information Act of 2002, 6 U.S.C. 133, and any State or local law requiring disclosure of information or records. This information must not be copied or distributed to others not agreed upon by AT&T, but in all events do not copy or distribute to such others without notification pursuant to Executive Order 12600.

PREPARED FOR RECORD  
APPROVED FOR OUTSIDE PLANT ENGINEER DATE

**TC SYSTEMS, INC**  
An Affiliate of **AT&T**

**SIENA**  
ENGINEERING GROUP INC.  
50 Mill Road, Suite 203, Burlington, MA 01803  
978-251-8400 FTSI-251-7517

DRAWN BY: J. CONNOR  
CHECKED BY: D. PUCHALA  
APPROVED BY: B. DORWART PE

**PROPRIETARY**  
USE PURSUANT TO COMPANY INSTRUCTIONS  
SPECIFICATION  
PROJECT NUMBER

OWNERSHIP:  
LINE CODE:  
CABLE CLLI:

SCALE: 1" = 20'

WASHINGTON STREET AT  
MAGNUS AVENUE  
SOMERVILLE, MA

PROPOSED CONDUIT  
PLACEMENT PLAN

**DN001**

NOTE:

DEPTH SHALL VARY BASED UPON ENCOUNTERS WITH EXISTING UTILITIES. CONTRACTOR SHALL MAINTAIN A MINIMUM OF 24" DEPTH OF COVER. IF 24" MINIMUM DEPTH OF COVER CANNOT BE ACHIEVED, CONSULT W/ ENGINEER.

TRENCH WIDTH DIMENSIONS SHOWN FOR CLARITY, ACTUAL WIDTH WILL DEPEND ON FIELD CONDITIONS.

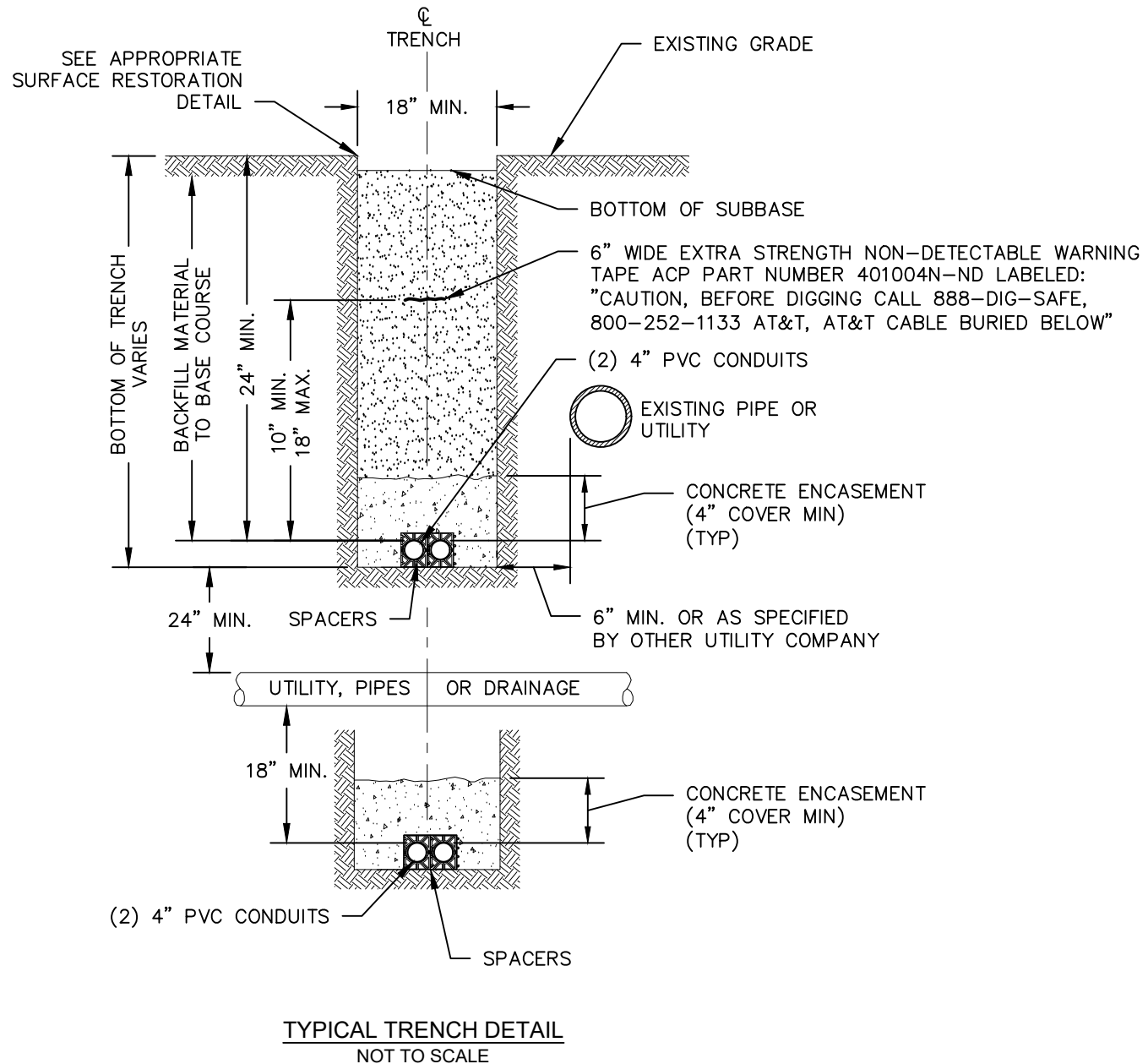

RESTORATION REQUIREMENTS:  
SUBBASE & TRENCH BACKFILL SHALL CONFORM TO CITY OF SOMERVILLE SPECIFICATIONS FOR MATERIAL, PLACEMENT & COMPACTION.

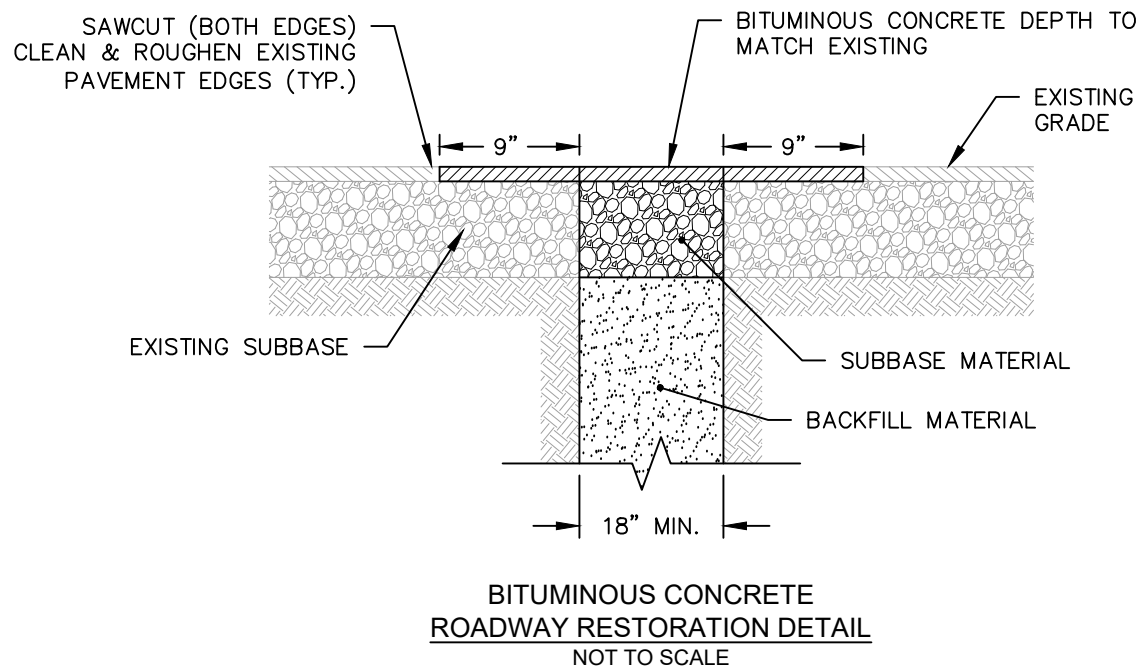
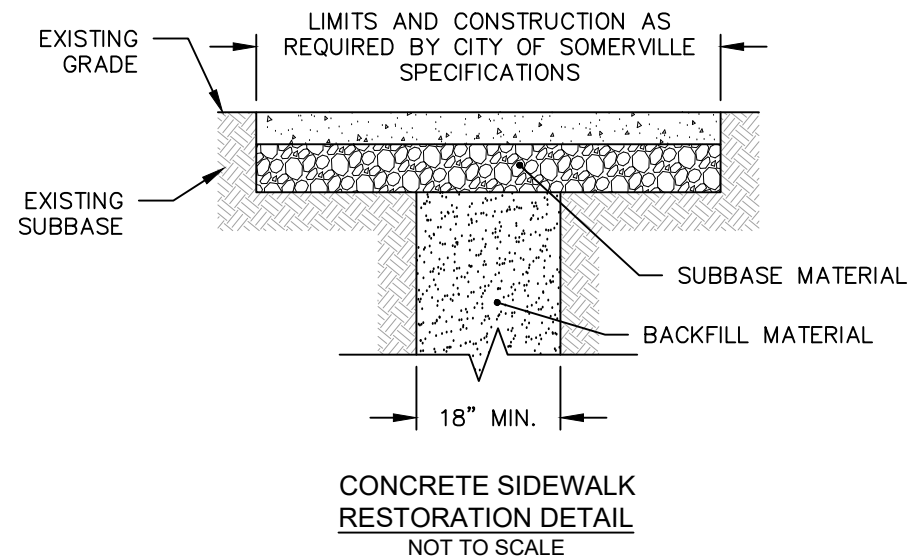

SIENA ENGINEERING GROUP, INC.  
 18-14300 Node 14 - Washington St At Dane St-Somerville,  
 MA.dwg  
 Edited: July 15, 2020 - 2:13 PM  
 Plotted: July 28, 2020 - 3:09 PM by joseph connor - \_Siena.ctb

|                               |           |
|-------------------------------|-----------|
| ISSUE DATE:                   | INITIALS: |
| 1. JULY 28, 2020 PERMIT ISSUE | JCC       |

**PRELIMINARY**  
NOT FOR CONSTRUCTION

**NOTES:**  
1. SUBSURFACE UTILITY LINES, AS SHOWN HEREON, WERE COMPILED ACCORDING TO AVAILABLE RECORD INFORMATION FROM THE REFERENCED COMPANIES AND PUBLIC AGENCIES, AND THEIR LOCATIONS ARE APPROXIMATE ONLY. ACTUAL LOCATIONS MUST BE DETERMINED IN THE FIELD PRIOR TO ANY CONSTRUCTION ACTIVITIES. SIENA ENGINEERING GROUP ASSUMES NO RESPONSIBILITY FOR DAMAGES INCURRED AS A RESULT OF UTILITIES OMITTED OR INACCURATELY SHOWN.



Call before you dig.

**AT&T PROPRIETARY**  
(Internal Use Only)

Not for disclosure outside the AT&T companies, except under written agreement.

2019 AT&T Intellectual Property, All Rights Reserved

AT&T PROPRIETARY-This information constitutes confidential trade secrets and commercial or financial information owned by AT&T and is shared for Critical Infrastructure Protection purposes only. It is exempt from disclosure under the Freedom of Information Act (5 U.S.C. 552), Exemptions (b)(3)&(4), and its disclosure is prohibited under the Trade Secrets Act (18 U.S.C. 1905), the Critical Infrastructure Information Act of 2002, 6 U.S.C. 133, and any State or local law requiring disclosure of information or records. This information must not be copied or distributed to others not agreed upon by AT&T, but in all events not copy or distribute to such others without notification pursuant to Executive Order 12600.

PREPARED FOR RECORD  
APPROVED FOR OUTSIDE PLANT ENGINEER DATE

**TC SYSTEMS, INC**  
An Affiliate of **AT&T**

**SIENA**  
ENGINEERING GROUP INC.  
50 Mill Road, Suite 203, Burlington, MA 01803  
978-251-8400 FTS: 251-7517

DRAWN BY: J. CONNOR  
CHECKED BY: D. PUCHALA  
APPROVED BY: B. DORWART PE

**PROPRIETARY**  
USE PURSUANT TO COMPANY INSTRUCTIONS  
SPECIFICATION  
PROJECT NUMBER

OWNERSHIP:  
LINE CODE:  
CABLE CLLI:

SCALE: AS NOTED

WASHINGTON STREET AT  
MAGNUS AVENUE  
SOMERVILLE, MA

PROPOSED TRENCH & SURFACE  
RESTORATION DETAILS

DT001



**PRELIMINARY**  
NOT FOR CONSTRUCTION

**NOTES:**

1. SUBSURFACE UTILITY LINES, AS SHOWN HEREON, WERE COMPILED ACCORDING TO AVAILABLE RECORD INFORMATION FROM THE REFERENCED COMPANIES AND PUBLIC AGENCIES, AND THEIR LOCATIONS ARE APPROXIMATE ONLY. ACTUAL LOCATIONS MUST BE DETERMINED IN THE FIELD PRIOR TO ANY CONSTRUCTION ACTIVITIES. SIENA ENGINEERING GROUP ASSUMES NO RESPONSIBILITY FOR DAMAGES INCURRED AS A RESULT OF UTILITIES OMITTED OR INACCURATELY SHOWN.



Call before you dig.

**AT&T PROPRIETARY**  
(Internal Use Only)

Not for disclosure outside the AT&T companies, except under written agreement.

2019 AT&T Intellectual Property, All Rights Reserved

AT&T PROPRIETARY-This information constitutes confidential trade secrets and commercial or financial information owned by AT&T and is shared for Critical Infrastructure Protection purposes only. It is exempt from disclosure under the Freedom of Information Act (5 U.S.C. 552), Exemptions (b)(3)&(4), and its disclosure is prohibited under the Trade Secrets Act (18 U.S.C. 1905), the Critical Infrastructure Information Act of 2002, 6 U.S.C. 133, and any State or local law requiring disclosure of information or records. This information must not be copied or distributed to others not agreed upon by AT&T, but in all events do not copy or distribute to such others without notification pursuant to Executive Order 12600.

PREPARED FOR RECORD  
APPROVED FOR OUTSIDE PLANT ENGINEER DATE

**TC SYSTEMS, INC**  
An Affiliate of **AT&T**

**SIENA**  
ENGINEERING GROUP INC.  
50 Mill Road, Suite 203, Burlington, MA 01803  
P: 781-231-8400 F: 781-231-7117

DRAWN BY: J. CONNOR  
CHECKED BY: D. PUCHALA  
APPROVED BY: B. DORWART PE

PROPRIETARY  
USE PURSUANT TO COMPANY INSTRUCTIONS  
SPECIFICATION  
PROJECT NUMBER

OWNERSHIP:  
LINE CODE:  
CABLE CLLI:

SCALE: AS NOTED

WASHINGTON STREET AT  
MAGNUS AVENUE  
SOMERVILLE, MA

PROPOSED HANDHOLE &  
HANDHOLE PLACEMENT DETAILS

DT002

**NOTES:**

- HANDHOLES INSTALLED IN ACCORDANCE WITH THE LATEST REVISION OF AT&T STANDARD SPECIFICATIONS FOR OUTSIDE PLANT CABLE CONSTRUCTION AND REMOVAL.
- HANDHOLE SECTIONS PROPERLY ALIGNED AND FREE OF DIRT AND STONES WHEN JOINED.
- HANDHOLE RACKING CONFORMS WITH AT&T SPECIFICATIONS.
- SPLICE HANDHOLES INCLUDE AC/DC FILTER PROTECTION PER AT&T SPECIFICATIONS.
- HANDHOLE MATERIAL IS POLYMER CONCRETE.
- HANDHOLE MANUFACTURED BY OLDCASTLE ENCLOSURE SOLUTIONS, 801 S. PINE ST., MADERA, CA 96367 1-800-486-7070. UNIT, PC2436-18.

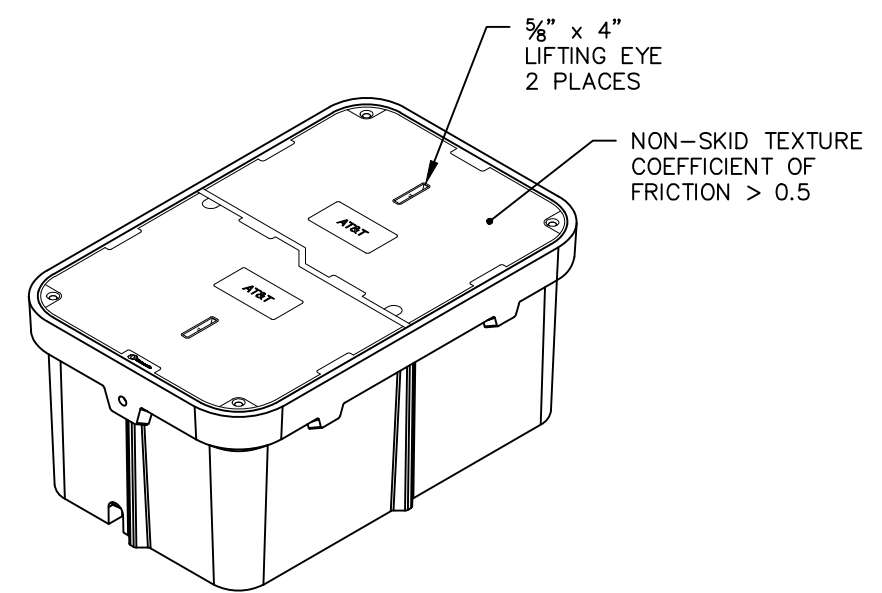

TYPICAL HANDHOLE DETAIL - 24"x36"x18"  
NOT TO SCALE

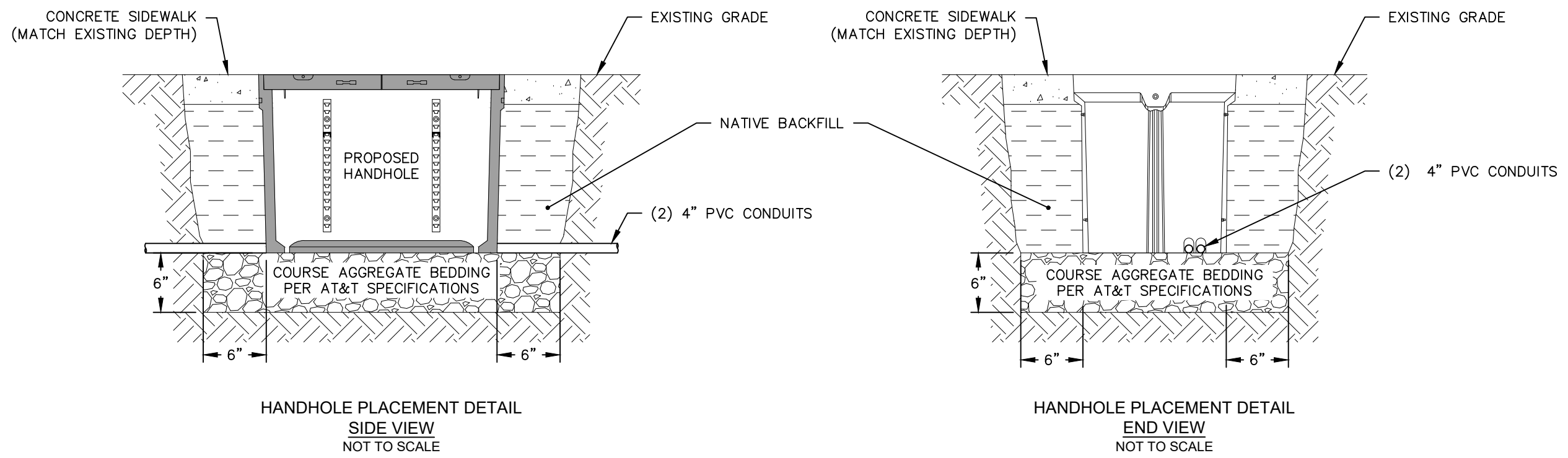

SIENA ENGINEERING GROUP, INC.  
18-14300 Node 14 - Washington St At Dane St.Somerville,  
MA.dwg  
Edited: July 15, 2020 - 2:13 PM  
Plotted: July 28, 2020 - 3:09 PM by joseph connor - \_Sienna.ctb

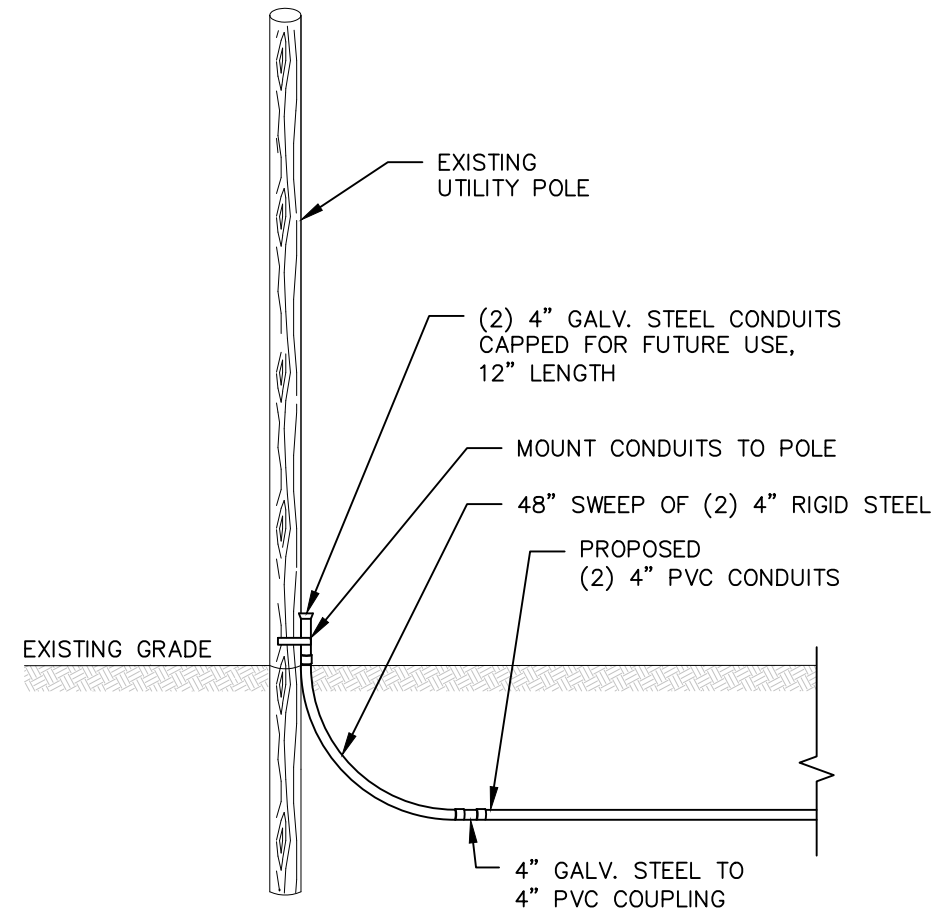

**PROPOSED RISER DETAIL**  
NOT TO SCALE

SIENA ENGINEERING GROUP, INC.  
18-14300 Node 14 - Washington St At Dane St.Somerville,  
MA.dwg  
Editted: July 15, 2020 - 2:13 PM  
Plotted: July 28, 2020 - 3:09 PM by joseph connor - \_Sienna.ctb

|             |           |
|-------------|-----------|
| ISSUE DATE: | INITIALS: |
|-------------|-----------|

|                               |     |
|-------------------------------|-----|
| 1. JULY 28, 2020 PERMIT ISSUE | JCC |
|-------------------------------|-----|

**PRELIMINARY**  
**NOT FOR CONSTRUCTION**

**NOTES:**

1. SUBSURFACE UTILITY LINES, AS SHOWN HEREON, WERE COMPILED ACCORDING TO AVAILABLE RECORD INFORMATION FROM THE REFERENCED COMPANIES AND PUBLIC AGENCIES, AND THEIR LOCATIONS ARE APPROXIMATE ONLY. ACTUAL LOCATIONS MUST BE DETERMINED IN THE FIELD PRIOR TO ANY CONSTRUCTION ACTIVITIES. SIENA ENGINEERING GROUP ASSUMES NO RESPONSIBILITY FOR DAMAGES INCURRED AS A RESULT OF UTILITIES OMITTED OR INACCURATELY SHOWN.



**Call before you dig.**

**AT&T PROPRIETARY**  
(Internal Use Only)

Not for disclosure outside the AT&T companies, except under written agreement.

2019 AT&T Intellectual Property, All Rights Reserved

AT&T PROPRIETARY-This information constitutes confidential trade secrets and commercial or financial information owned by AT&T and is shared for Critical Infrastructure Protection purposes only. It is exempt from disclosure under the Freedom of Information Act (5 U.S.C. 552), Exemptions (b)(3)&(4), and its disclosure is prohibited under the Trade Secrets Act (18 U.S.C. 1905), the Critical Infrastructure Information Act of 2002, 6 U.S.C. 133, and any State or local law requiring disclosure of information or records. This information must not be copied or distributed to others not agreed upon by AT&T, but in all events do not copy or distribute to such others without notification pursuant to Executive Order 12600.

PREPARED FOR RECORD

APPROVED FOR \_\_\_\_\_ DATE \_\_\_\_\_  
OUTSIDE PLANT ENGINEER



DRAWN BY: J. CONNOR  
CHECKED BY: D. PUCHALA  
APPROVED BY: B. DORWART PE

**PROPRIETARY**  
USE PURSUANT TO COMPANY INSTRUCTIONS

SPECIFICATION  
PROJECT NUMBER

OWNERSHIP:  
LINE CODE:  
CABLE CLLI:

SCALE: AS NOTED

WASHINGTON STREET AT  
MAGNUS AVENUE  
SOMERVILLE, MA

PROPOSED UTILITY  
RISER DETAIL

DT003