

2 ALDERMEN
2 UTILITIES



CITY OF SOMERVILLE, MASSACHUSETTS
CITY CLERK'S OFFICE
JOSEPH A. CURTATONE
MAYOR

JOHN J. LONG
CITY CLERK

March 30, 2015

NOTICE

You are hereby notified that the Board of Aldermen will hold a Public Hearing on the following Petition. You are receiving this Notice because City records indicate that you own property that abuts the work that is being proposed. You and other members of the public are invited to attend and be heard at this Hearing.

- PETITION:** Eversource (NStar Electric) for a Grant of Location to install 411 feet of conduit in School Street, from Madison Street to a new manhole constructed at the south side of the School Street bridge abutment, and 96 feet of conduit from Richdale Avenue to a new manhole constructed at the north side of the School Street bridge abutment.
- PLACE:** Aldermanic Chambers, 2nd Floor, City Hall, 93 Highland Avenue, Somerville.
- TIME:** Thursday, April 9, 2015, at 7:00 PM.
- PURPOSE:** The work is necessary for the MBTA Green Line Extension.

John J. Long
City Clerk

W.O. #1984950



CITY OF SOMERVILLE, MASSACHUSETTS

2015 MAR 18 P 2:52

DEPARTMENT OF PUBLIC WORKS

JOSEPH A. CURTATONE
MAYOR

CITY CLERK'S OFFICE
SOMERVILLE, MA

STAN KOTY
Commissioner

RICK WILLETTE
Director of Operations

March 17, 2015

The Honorable Board of Aldermen
City Hall
93 Highland Avenue
Somerville MA, 02143

**RE: Grant of Location
EVERSOURCE
School Street Bridge
W.O. #1984950**

Dear Board Members:

Preliminary approval is recommended for the petition and plan of NSTAR Electric/Eversource to install approximately (411') feet of conduit in School Street Somerville, MA. Approximately (315') feet of conduit, northeasterly from Madison Street to School Street abutment and install one manhole #29854 and the remaining (96') feet will be installed southwesterly from Richdale Avenue to the School Street bridge abutment and install one manhole #29855 in School Street Somerville, MA.

This recommendation is made with reference to Eversource's letter of March 17, 2015 and plan of May 30, 2014 upon stipulation that the Grant of Location is subject to: a reservation of rescission by the Board of Aldermen; indemnification of the City for all liability arising from said Grant; all permit procedures, conditions and approvals of municipal utilities; protection of existing infrastructure; and complete surface repair, restoration and maintenance. A public hearing will be required.

This work is necessary due to MBTA Green Line extension.

Respectfully requested,
Department of Public Works

Stan Koty, Commissioner

1 Franey Road Somerville, Massachusetts 02145

(617) 625-6600 Ext 5100 TTY (866) 808-4851 Fax (617) 623-7649

www.somervillema.gov

EVERSOURCE

101 Linwood Street
Somerville, MA 02143

March 17, 2015

John Long
Office of the City Clerk
93 Highland Avenue
Somerville, MA 02143

Re: School Street Bridge
Somerville, MA
W.O. #1984950

Dear Sir:

The NSTAR Electric Company d/b/a Eversource, respectfully request a Grant of Location to install approximately 411 feet of conduit and installation of two new manholes in School Street.

This work is necessary due to MBTA Green Line extension.

Thank you for your prompt attention to this request. If you have any questions, please call Jacqueline Duffy, Right of Way Agent, 617-369-5509.

Very truly yours,

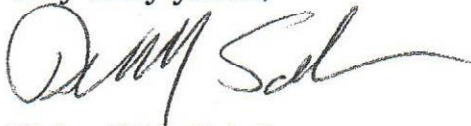

Richard M. Schifone,
Supervisor

RMS/jd

cc: Highway Department
Engineering Department

**PETITION OF NSTAR ELECTRIC COMPANY FOR LOCATION FOR CONDUITS
AND MANHOLES**

To the Board of Aldermen City of Somerville, Massachusetts

Respectfully represents NSTAR ELECTRIC COMPANY d/b/a Eversource a company incorporated for the transmission of electricity for lighting, heating or power, that it desires to construct a line for such transmission under the public way or ways hereinafter specified.

WHEREFORE, your petitioner prays that, after due notice and hearing as provided by law, the Board may by Order grant to your petitioner permission to construct, and a location for, such a line of conduits and manholes with the necessary wires and cables therein, said conduits and manholes to be located substantially as shown on the plan made by A. DeBenedictis dated May 30, 2014 herewith, under the following public way or ways of said City:

School Street – At and northeasterly from Madison Street to the School Street bridge abutment a distance of about 315 feet conduit and install one manhole #29854.

School Street – At and southwesterly from Richdale Avenue to the School Street bridge abutment a distance of about 96 feet conduit and install one manhole #29855.

W.O. #1984950

NSTAR ELECTRIC COMPANY d/b/a Eversource

By: 

Richard M. Schifone, Supervisor
Rights and Permits

Dated this 17th day of March, 2015

City of Somerville, Massachusetts

Received and filed _____, 2015

ORDER FOR LOCATION FOR CONDUITS AND MANHOLES

City of Somerville Massachusetts, _____

In Board of Aldermen

WHEREAS, NSTAR ELECTRIC COMPANY d/b/a Eversource has petitioned for permission to construct a line for the transmission of electricity for lighting, heating, or power under the public way or ways of the City hereinafter specified, and notice has been given and a hearing held on said petition as provided by law.

It is ORDERED that NSTAR ELECTRIC COMPANY d/b/a Eversource be and hereby is granted permission to construct, and a location for, such a line of conduits and manholes with the necessary wires and cables therein under the following public way or ways of said City:

School Street – At and northeasterly from Madison Street to the School Street bridge abutment a distance of about 315 feet conduit and install one manhole #29854.

School Street – At and southwesterly from Richdale Avenue to the School Street bridge abutment a distance of about 96 feet conduit and install one manhole #29855.

W.O. #1984950

All construction work under this Order shall be in accordance with the following conditions:

1. Conduits and manholes shall be located as shown on made by A. DeBenedictis plan dated **May 30, 2014**
2. Said Company shall comply with the requirements of existing ordinances and such as may hereafter be adopted governing the construction and maintenance of conduits and manholes.
3. All work shall be done to satisfaction of the City Council or such officer or officers as it may appoint to supervise the work.

A True Record.

Attest: _____
City Clerk

Approved _____ 2015

Mayor
CERTIFICATE

I hereby certify that the foregoing Order was adopted after due notice and public hearing as prescribed by Section 22 of Chapter 166 of the General Laws (Ter. Ed.) and any additions thereto or amendments thereof, to wit:--after written notice of the time and place of the hearing mailed at least seven days prior to the date of the hearing by the City Clerk to all owners of real estate abutting upon that part of the way or ways upon, along or across which the line is to be constructed under said Order, as determined by the last preceding assessment for taxation and a public hearing held on the _____ day of _____ 2015.

City Clerk

CERTIFICATE

I hereby certify that the foregoing are true copies of the Order Board of Aldermen of the City of Somerville Massachusetts duly adopted on the _____ day of _____, 2015 and recorded with the records of location Orders of Said City. Book _____ Page _____ and of the certificate of notice of hearing thereon required by Section 22 of Chapter 166 of the General Laws (Ter. Ed.), and any additions thereto or amendments thereof, as the same appear of record.

Attest: _____

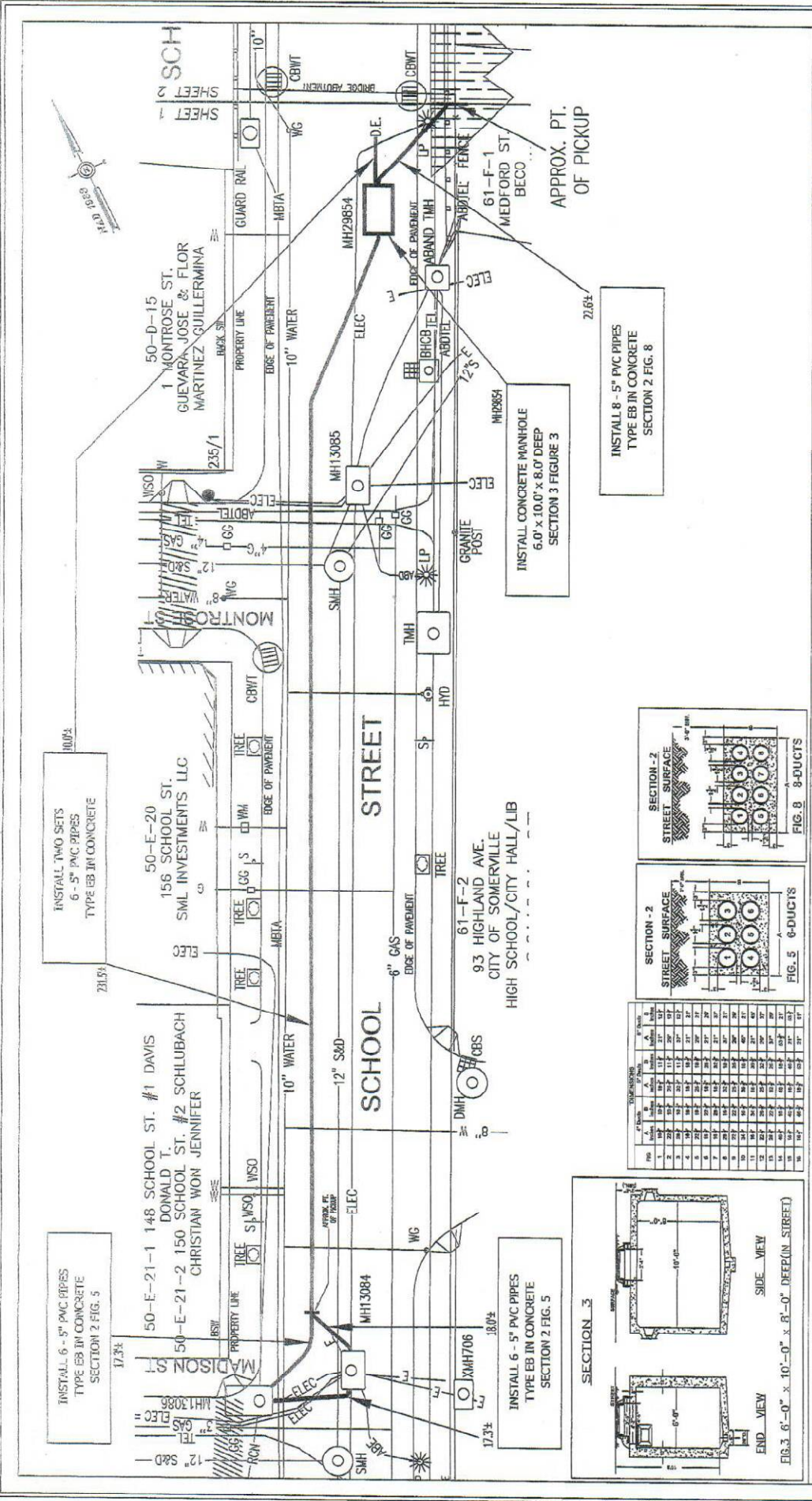

MASS. LAW
REQUIRES 72 HOURS ADVANCE NOTICE TO UTILITY COMPANIES BEFORE DESIGN BY ANYONE. CALL DIG-SAFE 1-888-344-7253

SECTION 3
END VIEW
SIDE VIEW
FIG. 3. 6'-0" x 10'-0" x 8'-0" DEEP (IN STREET)

SECTION 2
STREET SURFACE
FIG. 5. 6-DUCTS

SECTION 2
STREET SURFACE
FIG. 8. 8-DUCTS

FIG. NO.	A	B	C	D	E	F	G	H	I	J	K	L	M	N	O	P	Q	R	S	T	U	V	W	X	Y	Z
1	10	10	10	10	10	10	10	10	10	10	10	10	10	10	10	10	10	10	10	10	10	10	10	10	10	10
2	10	10	10	10	10	10	10	10	10	10	10	10	10	10	10	10	10	10	10	10	10	10	10	10	10	10
3	10	10	10	10	10	10	10	10	10	10	10	10	10	10	10	10	10	10	10	10	10	10	10	10	10	10
4	10	10	10	10	10	10	10	10	10	10	10	10	10	10	10	10	10	10	10	10	10	10	10	10	10	10
5	10	10	10	10	10	10	10	10	10	10	10	10	10	10	10	10	10	10	10	10	10	10	10	10	10	10
6	10	10	10	10	10	10	10	10	10	10	10	10	10	10	10	10	10	10	10	10	10	10	10	10	10	10
7	10	10	10	10	10	10	10	10	10	10	10	10	10	10	10	10	10	10	10	10	10	10	10	10	10	10
8	10	10	10	10	10	10	10	10	10	10	10	10	10	10	10	10	10	10	10	10	10	10	10	10	10	10
9	10	10	10	10	10	10	10	10	10	10	10	10	10	10	10	10	10	10	10	10	10	10	10	10	10	10
10	10	10	10	10	10	10	10	10	10	10	10	10	10	10	10	10	10	10	10	10	10	10	10	10	10	10
11	10	10	10	10	10	10	10	10	10	10	10	10	10	10	10	10	10	10	10	10	10	10	10	10	10	10
12	10	10	10	10	10	10	10	10	10	10	10	10	10	10	10	10	10	10	10	10	10	10	10	10	10	10
13	10	10	10	10	10	10	10	10	10	10	10	10	10	10	10	10	10	10	10	10	10	10	10	10	10	10
14	10	10	10	10	10	10	10	10	10	10	10	10	10	10	10	10	10	10	10	10	10	10	10	10	10	10
15	10	10	10	10	10	10	10	10	10	10	10	10	10	10	10	10	10	10	10	10	10	10	10	10	10	10
16	10	10	10	10	10	10	10	10	10	10	10	10	10	10	10	10	10	10	10	10	10	10	10	10	10	10
17	10	10	10	10	10	10	10	10	10	10	10	10	10	10	10	10	10	10	10	10	10	10	10	10	10	10
18	10	10	10	10	10	10	10	10	10	10	10	10	10	10	10	10	10	10	10	10	10	10	10	10	10	10

FIG. 3. 6'-0" x 10'-0" x 8'-0" DEEP (IN STREET)

SCALE IN FEET

0 20 40

NSSTAR ELECTRIC
A Division of Utility Company
100 Massachusetts Ave., CONCORD, MASS. 01742
Plan of SCHOOL STREET, SOUTHERLE
MADISON STREET - SOUTHERLE
Showing PROPOSED CONDUIT & MANHOLE LOCATIONS

CH 89-14
Word #
Work Order # 191920
Surveyed by: IIR/FR
Revised by: DJ
Plotted by: JF
Proposed Structures: PML
Approved: A DEB/CHS
Scale: 1"=20'
Date: MAY 30, 2014
SHEET 1 OF 2

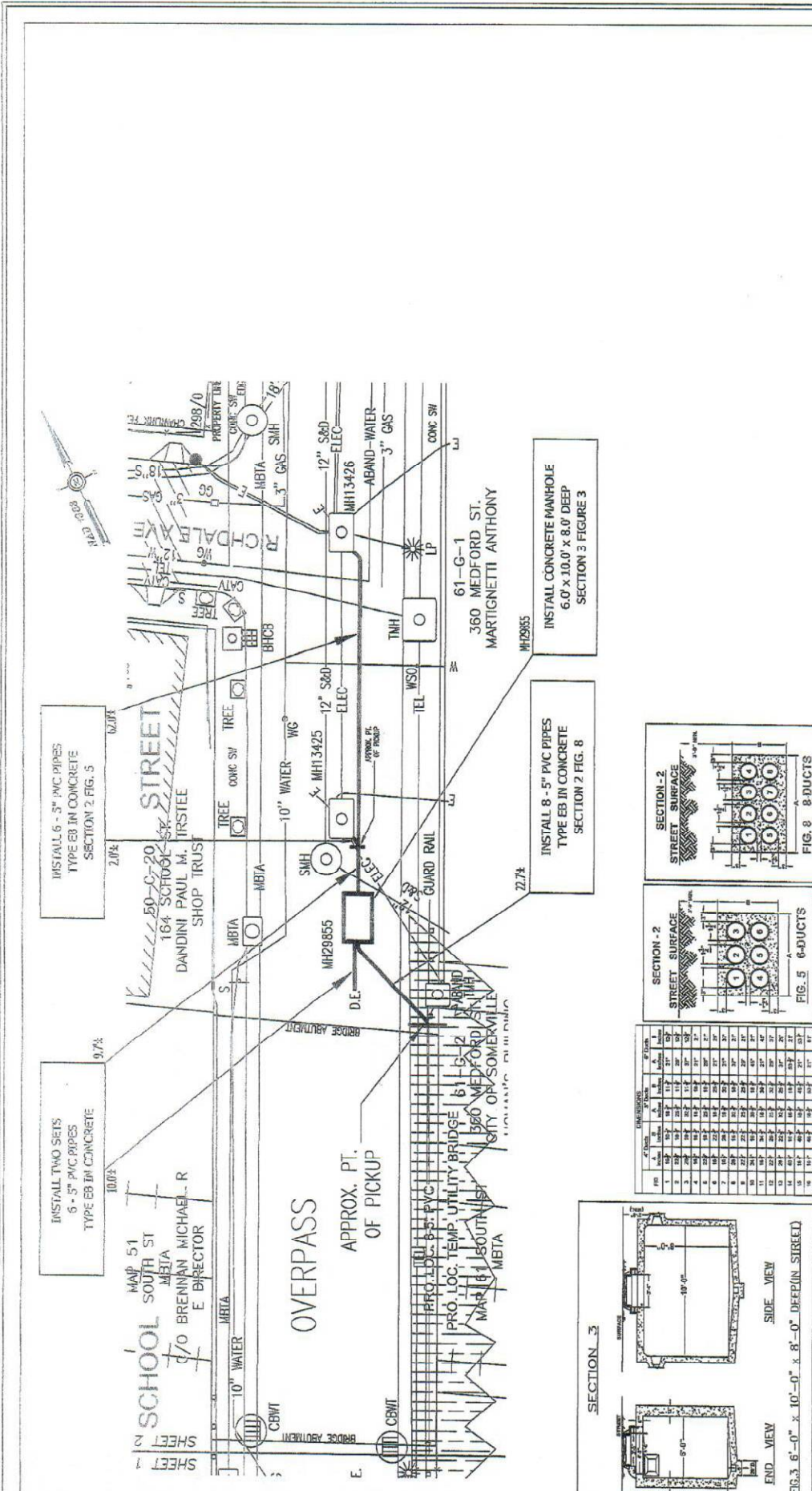

INSTALL TWO SETS
6-5" PVC PIPES
TYPE EB IN CONCRETE

INSTALL 6-5" PVC PIPES
TYPE EB IN CONCRETE
SECTION 2 FIG. 5

INSTALL 8-5" PVC PIPES
TYPE EB IN CONCRETE
SECTION 2 FIG. 8

INSTALL CONCRETE MANHOLE
6.0' x 10.0' x 8.0' DEEP
SECTION 3 FIGURE 3

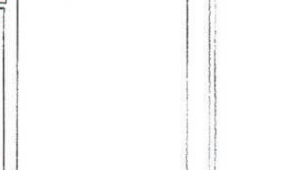

LINE	FROM	TO	DEPTH	NO. OF DUCTS	TYPE
1	100' A	100' B	12"	6	6-DUCTS
2	100' B	100' C	12"	6	6-DUCTS
3	100' C	100' D	12"	6	6-DUCTS
4	100' D	100' E	12"	6	6-DUCTS
5	100' E	100' F	12"	6	6-DUCTS
6	100' F	100' G	12"	6	6-DUCTS
7	100' G	100' H	12"	6	6-DUCTS
8	100' H	100' I	12"	6	6-DUCTS
9	100' I	100' J	12"	6	6-DUCTS
10	100' J	100' K	12"	6	6-DUCTS
11	100' K	100' L	12"	6	6-DUCTS
12	100' L	100' M	12"	6	6-DUCTS
13	100' M	100' N	12"	6	6-DUCTS
14	100' N	100' O	12"	6	6-DUCTS
15	100' O	100' P	12"	6	6-DUCTS
16	100' P	100' Q	12"	6	6-DUCTS

SECTION 3
END VIEW
SIDE VIEW
FIG. 3 6'-0" x 10'-0" x 8'-0" DEEP (IN STREET)

SECTION 2
STREET SURFACE
FIG. 5 6-DUCTS

SECTION 2
STREET SURFACE
FIG. 8 8-DUCTS

SCALE IN FEET

0 20 40

IN ALL CASES THE RESPONSIBILITY FOR THE DESIGN AND CONSTRUCTION OF THE WORK SHOWN ON THIS DRAWING IS THE RESPONSIBILITY OF THE ENGINEER. THE ENGINEER HAS NOT CONDUCTED A VISUAL INSPECTION OF THE WORK SHOWN ON THIS DRAWING. THE ENGINEER HAS NOT CONDUCTED A VISUAL INSPECTION OF THE WORK SHOWN ON THIS DRAWING. THE ENGINEER HAS NOT CONDUCTED A VISUAL INSPECTION OF THE WORK SHOWN ON THIS DRAWING.

MASS LAW
REGISTERED PROFESSIONAL ENGINEER
100 STATE STREET, SUITE 200, BOSTON, MA 02109
PHONE: 617-552-3423
FAX: 617-552-3424
WWW.MASSLAW.COM

PROJECT: 181850
SHEET: 2 OF 2

DATE: MAY 30, 2018

W.O. #1984950
BRIDGE STREET
SOMERVILLE, MA 02145

50-B-8
170 SCHOOL ST.
N/F
CORTEZ INVESTMENTS, LLC
S/O 170 SCHOOL STREET LLC
55 HAZEL ST.
WATERTOWN, MA 02472

50-C-20
164 SCHOOL ST.
N/F
DANDINI PAUL M. TRSTEE
SHOP TRUST
2 RICHDALE AVE.
SOMERVILLE, MA 02145

50-D-15
1 MONTROSE ST.
N/F
GUEVARA JOSE & FLOR
MARTINEZ GUILLERMINA
1 MONTROSE ST.
SOMERVILLE, MA 02145

50-E-20
156 SCHOOL ST.
N/F
SML INVESTMENTS LLC
311 HIGHLAND AVE.
SOMERVILLE, MA 02144

50-E-21-2
150 SCHOOL ST. #2
N/F
SCHLUBACH CHRISTIAN
WON JENNIFER
150 SCHOOL ST. #2
SOMERVILLE, MA 02143

MAP 51 & 61 SCHOOL ST
MBTA
C/O BRENNAN MICHAEL R E
DIRECTOR
10 PARK PLAZA SUITE 5750
BOSTON MA 02116

50-E-21-1
148 SCHOOL ST. #1
N/F
DAVIS DONALD T.
148 SCHOOL ST. #1
SOMERVILLE, MA 02143

50-F-18
144 SCHOOL ST.
N/F
MOUGHAN COLM F.
78 NONANTUM ST.
NEWTON, MA 02458

61-G-1
360 MEDFORD ST.
N/F
MARTIGNETTI ANTHONY
P.O. BOX 45452
SOMERVILLE, MA 02145

61-G-2
350 MEDFORD ST.
N/F
CITY OF SOMERVILLE
HOMAN'S BUILDING
93 HIGHLAND AVE.
SOMERVILLE, MA 02143

61-F-1
MEDFORD ST.
N/F
BOSTON EDISON COMPANY
PROPERTY TAX DEPT
PO BOX 567
NORWOOD, MA 02062

61-F-2
93 HIGHLAND AVE.
N/F
CITY OF SOMERVILLE
HIGH SCHOOL/CITY HALL/LIB
93 HIGHLAND AVE.
SOMERVILLE, MA 02143