



CITY OF SOMERVILLE

Commonwealth of Massachusetts
93 Highland Avenue
Somerville, MA 02143
(617) 625-6600

BUSINESS LICENSE APPLICATION - Grant of Location

File #: 22-011629

License #: BL22-000075

Address: 7 CENTRAL ST

Licensee: Hannah Cooper NSTAR Electric Company dba Eversource Energy

DBA Name: NSTAR dba Eversource Energy

Business Ownership Type: Corporation

Legal Name of Entity: NSTAR dba Eversource Energy

Owners/Officers: , , ,

License Information:

Grant of location issued to: NSTAR dba Eversource Energy

Describe the reason for the work, and the intended beneficiaries: This work is necessary to provide service to #7 Central Street.

Insert here the same detailed description of the work as appears in the attached Grant of Location Order: Somerville Avenue - Northerly from manhole MH8637, approximately 50 feet south of Central Street, to Central Street, install approximately 50 feet of conduit. Central Street - Northerly from Somerville Avenue, to private property at #7 Central Street, install approximately 110 feet of conduit. WO#5402444

Approval Conditions:

Approved By:

Isabela Maia, Approved with Conditions

APPROVAL CONDITION IMM 2022-07-11: Provide the city a of copy approved MWRA 8(m) Permit when submitting for street occupancy permit.

Malik Drayton, Approved with Conditions

APPROVAL CONDITION: MD20220718: Contractor shall take all necessary precautions to avoid damaging any tree or tree part with equipment.

APPROVAL CONDITION: MD20220718: All nearby street tree(s) shall be protected prior to and during all construction activities using TREE BOX or TREE WRAPS. . TREE BOX shall be constructed from 2 in. x 4 in. lumber creating a box around the border of the tree pit with 2 in. x 4 in. lumber standing straight up at the corners and wrapped with orange snow fence. Detail attached. . TREE WRAPS (TREE TRUNK WRAPPING PROTECTION LUMBER) shall consist of 2 in. x 4 in. and 8 ft. height lumber

wired together in close spacing with zip ties or 16 gauge galvanized steel wire to form a protective enclosure around tree trunks. Use burlap to separate the wood from the bark if necessary to prevent wood from scraping or bruising bark. Do not use staples or puncture the trunk in any way.

APPROVAL CONDITION: MD20220718: Any tree roots less than two (2) inches in diameter that cannot be avoided during construction shall be carefully and cleanly cut with a clean pair of pruning shears or loppers. Roots are to be cut back flush with the edge of the trench. If any tree roots greater than two (2) inches in diameter are encountered, stop work immediately and contact the City Urban Forester. Any and all pruning of roots greater than 2 inches in diameter must be completed under the supervision of the City Urban Forester.

Eric Weisman, Approved

Kimberly M. Wells, Approved



CITY OF SOMERVILLE, MASSACHUSETTS
CITY CLERK'S OFFICE
KATJANA BALLANTYNE
MAYOR

KIMBERLY M. WELLS
CITY CLERK

August 16, 2022

NOTICE OF PUBLIC HEARING

You are hereby notified that the Somerville City Council will hold a Public Hearing on the following Petition. You are receiving this Notice because the Petitioner has reported that you own property that abuts the work that is being proposed. You and other members of the public are invited to attend and be heard at this Hearing.

This meeting of the City Council will also be conducted via remote participation, online in a webinar hosted on the GoToWebinar platform.

You have three ways to be heard at this meeting:

1. To attend and be heard, enter the link exactly as it appears below into your internet browser any time before the meeting. You will then be asked to register for the meeting. After registering, you will receive an email with instructions to join the webinar when it starts.
2. You may also testify in person in the City Council Chamber, City Hall, 2nd Floor, 93 Highland Avenue, Somerville, MA 02143
3. If you are unable to attend but wish to be heard, you may send written comments by US mail to the City Clerk at the address below, or by email to cityclerk@somervillema.gov. Your comments must arrive no later than 12 Noon on the day of the Hearing, in order to be sure they are conveyed to the Council.

PETITION: Eversource (NStar Electric) is applying for a Grant of Location to install 160 feet of conduit in the intersection of Somerville Avenue and Central St, from Manhole 8637 to a point of pickup at 7 Central Street.

PLACE: <https://attendee.gotowebinar.com/register/5803739566728446733> or
City Council Chambers, City Hall, 2nd Floor, 93 Highland Avenue, Somerville, MA 02143

TIME: Thursday, August 25, 2022 at 7:00 PM.

PURPOSE: The work is necessary to provide service to 7 Central Street.

W.O. 5202444

EVERSOURCE
101 Linwood Street
Somerville, MA 02143

July 8th, 2022

Ms. Kimberly Wells
Office of the City Clerk
93 Highland Avenue
Somerville, MA 02143

RE: Central Street
W.O. #5402444

Dear Members of the Board,

The NSTAR Electric Company d/b/a Eversource Energy respectfully requests a Grant of Location for the installation of approximately 110 feet of conduit in Central Street and 50 feet of conduit in Somerville Avenue.

This work is necessary to provide service to #7 Central Street.

If you have any questions or concerns, please call Jacqueline Duffy at 617-629-3204.

Very truly yours,

Kelly-Ann Correia

Kelly-Ann Correia
Supervisor, Rights and Permits

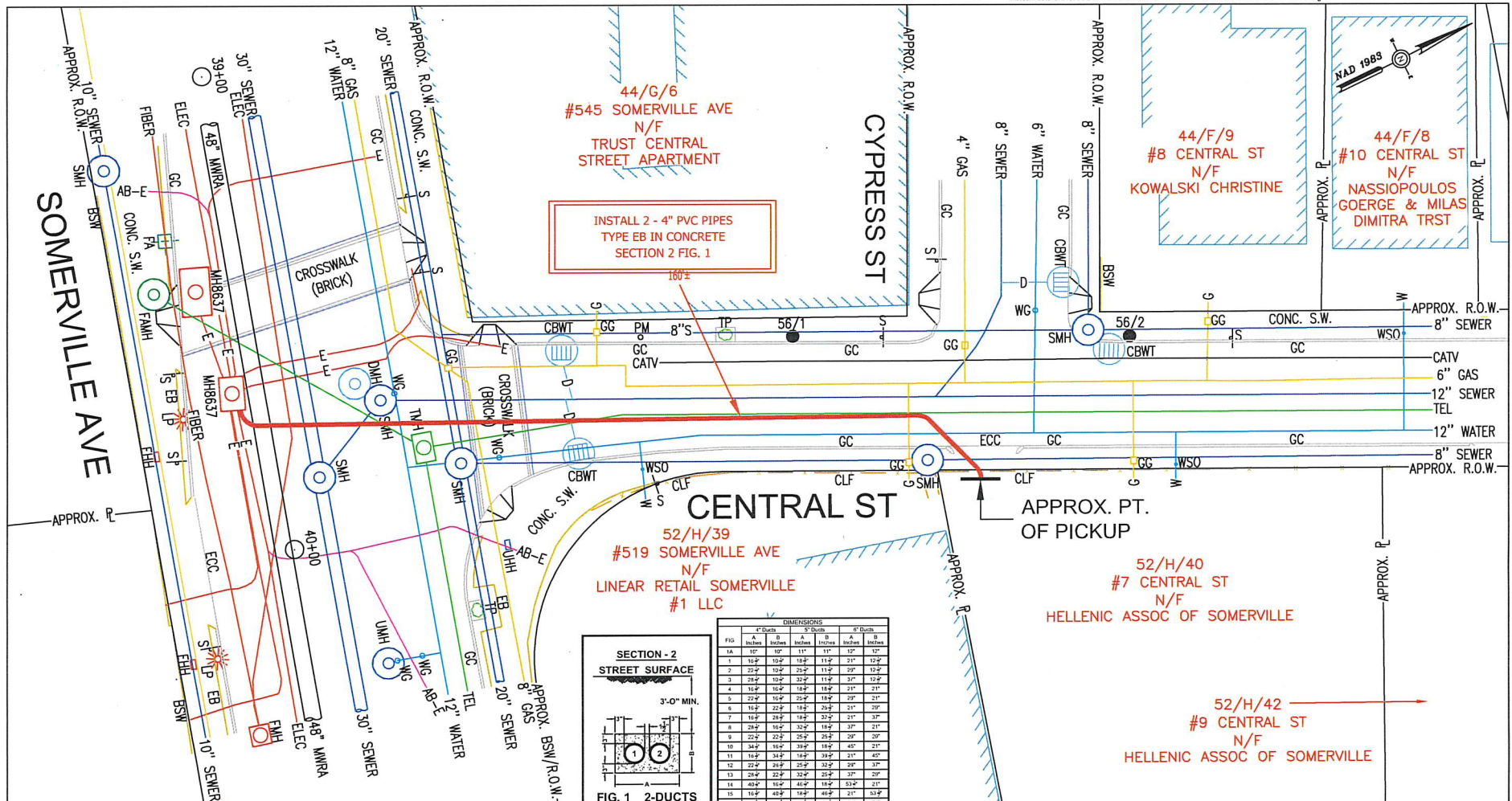

INSTALL 2 - 4" PVC PIPES
TYPE EB IN CONCRETE
SECTION 2 FIG. 1

52/H/39
#519 SOMERVILLE AVE
N/F
LINEAR RETAIL SOMERVILLE
#1 LLC

52/H/40
#7 CENTRAL ST
N/F
HELLENIC ASSOC OF SOMERVILLE

52/H/42
#9 CENTRAL ST
N/F
HELLENIC ASSOC OF SOMERVILLE

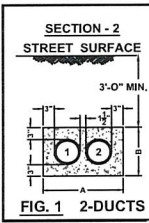

FIG. 1 2-DUCTS

FIG	4" Ducts		6" Ducts		8" Ducts	
	A	B	A	B	A	B
1A	10"	10"	15"	15"	22"	22"
2	22"	10"	25"	11"	29"	12"
3	25"	10"	32"	11"	37"	12"
4	10"	10"	18"	18"	21"	21"
5	22"	10"	25"	18"	29"	21"
6	10"	22"	18"	26"	21"	29"
7	10"	22"	18"	23"	21"	33"
8	25"	18"	32"	18"	37"	21"
9	22"	22"	25"	25"	29"	30"
10	34"	11"	39"	18"	45"	21"
11	18"	25"	18"	38"	21"	42"
12	22"	25"	25"	32"	29"	33"
13	28"	22"	32"	25"	37"	29"
14	40"	10"	46"	18"	52"	21"
15	18"	48"	18"	46"	21"	52"
16	10"	48"	18"	53"	21"	61"



BY YOUR USE OF THE INFORMATION CONTAINED IN THIS MAP, YOU AGREE THAT NO WARRANTY OF ANY KIND, EXPRESS OR IMPLIED, IS GIVEN WITH RESPECT TO THE INFORMATION. NEITHER NSTAR ELECTRIC COMPANY, NSTAR GAS COMPANY NOR ITS PARENTS, AFFILIATES, OFFICERS, EMPLOYEES, SHAREHOLDERS, EMPLOYEES OF AGENTS (COLLECTIVELY THE "NSTAR ENTITIES") SHALL BE LIABLE FOR ANY LOSS OF INQUIRY CAUSED BY NEGLIGENCE OR IN FIRST BY LOSS OF THIS INFORMATION OR BY RELIANCE THEREON. TO THE MAXIMUM EXTENT ALLOWED BY LAW, YOU AGREE BY YOUR ACCEPTANCE OF THE INFORMATION TO RELEASE, INDEMNIFY AND HOLD THE NSTAR ENTITIES HARMLESS FROM ANY SUCH LOSS OF INQUIRY.

THE INFORMATION MAY NOT REPRESENT A SURVEY, MAY NOT BE THE MOST COMPLETE AND IS SUBJECT TO CHANGE WITHOUT NOTICE. NO LIABILITY IS ASSIGNED FOR THE ACCURACY OF THE INFORMATION, EITHER EXPRESSED OR IMPLIED. UNAUTHORIZED ATTEMPTS TO MODIFY THE INFORMATION OR USE THE INFORMATION FOR OTHER THAN ITS INTENDED PURPOSES ARE PROHIBITED.

MASS. LAW
REQUIRES 72 HOURS ADVANCE NOTICE TO UTILITY COMPANIES BEFORE DIGGING BY ANYONE. CALL DIG-SAFE 1-888-344-7233

C#	132-21	NSTAR EVERSOURCE ELECTRIC d/b/a 1185 MASSACHUSETTS AVE. DORCHESTER, MASS. 02125
Ward #		
Work Order #	5402444	Plan of
Surveyed by:	GR/SJ	SOMERVILLE AVE & CENTRAL ST
Research by:	JC	SOMERVILLE
Plotted by:	GR	Showing
Proposed Structures:	BP	PROPOSED CONDUIT LOCATION
Approved:	T THIBAUT	Scale
P#		1"=20'
		Date
		09/01/2021
		SHEET
		1 of 1

Location:

44/ G/ 6/ /
545 SOMERVILLE AVE

Owner:
TRUST CENTRAL STREET APARTMENT
JOSEPH W HOWARD TRSTE
PO BOX 440-361
SOMERVILLE, MA 02144

Location:

52/ H/ 40/ /
7 CENTRAL ST

Owner:
7-9 CENTRAL ST
20 FOX RD
WALTHAM, MA 02451

Location:

45/ B/ 22/ /
526 SOMERVILLE AVE

Owner:
PJC REALTY MA,INC
200 WILMOT ROAD
DEERFIELD, IL 60015

Location:

45/ B/ 14/ /
550 SOMERVILLE AVE

Owner:
CITY OF SOMERVILLE
CONWAY FIELD
93 HIGHLAND AVE
SOMERVILLE, MA 02143

Location:

52/ H/ 39/ /
519 SOMERVILLE AVE

Owner:
LINEAR RETAIL SOMERVILLE #1 LLC
FIVE BURLINGTON WOODS DRIVE
BURLINGTON, MA 01803

Location:

52/ H/ 42/ /
9 CENTRAL ST

Owner:
7-9 CENTRAL ST
20 FOX RD
WALTHAM, MA 02451