

Maura Healey, Governor
Kimberley Driscoll, Lieutenant Governor
Gina Fiandaca, Secretary & CEO
Jonathan L. Gulliver, Highway Administrator



May 31, 2023

Massachusetts Department of Transportation
Highway Division
Right of Way Bureau (Rm. 7760)
10 Park Plaza
Boston, MA 02116-3969

Kimberly Wells, City Clerk
Town of Somerville
93 Highland Ave, 1st Floor
Somerville, MA 02143

Re: Somerville
Layout: 8899 (Order of Taking)
Dated: May 24, 2023

2023 JUN 12 A 11:41
CITY CLERK'S OFFICE
SOMERVILLE, MA

Dear Ms. Wells:

Acting under the provisions of Chapter 6C and Chapter 81 of the General Laws on May 24, 2023, the Massachusetts Department of Transportation-Highway Division altered the location of a section(s) of State highway in Somerville.

A copy of an instrument bearing a certificate that the Highway Division has altered the location laid out of said State highway in accordance with said plan, and a written instrument, is enclosed herewith for filing in your office in accordance with the statute referenced above.

Please sign the enclosed form of receipt and return it to the above address as soon as possible. If you have any questions regarding this matter, please contact the Right of Way Bureau at (857) 368-9218.

Sincerely,

Walter H. Lynch
Deputy Director, Right of Way Bureau

WHL/dd
Enclosures

The Commonwealth of Massachusetts
Massachusetts Department of Transportation
Highway Division

County of Middlesex
City of Somerville

Layout No. 8899
Alteration

I HEREBY CERTIFY that the following plan (and a written instrument) has been this day filed in the office of the Town Clerk:

A copy of a plan bearing thereon a certificate dated May 24, 2023 attesting that the Massachusetts Department of Transportation, Highway Division has altered the location of the State highway shown on said plan and has laid out and taken charge of as a Limited Access State highway as altered as shown on said plan.

Attest

By:

Kimberly Wells, City Clerk

Date: _____

MASSACHUSETTS DEPARTMENT OF TRANSPORTATION

---ooo00ooo---

**SOMERVILLE
Layout No. 8899**

WHEREAS, the Department of Public Works, acting on behalf of the Commonwealth of Massachusetts, did, under date of August 21, 1968 (Layout No. 5771), lay out and take charge of as a limited access State highway, a road in the City of Somerville, County of Middlesex, being known as Interstate Route 93, and said Department did, under date of April 20, 1977 (Layout No. 6299), revise a portion of the limited access provisions of said State highway, all as shown on the plans of said State highway on file in the office of the Massachusetts Department of Transportation, copies of which plans have been filed in the office of the County Commissioners of said County, or their successors, if any, and in the office of the City Clerk of said City of Somerville; and

WHEREAS, it now appears advisable to further revise a portion of the limited access provisions of said State highway;

NOW, THEREFORE, acting under the provisions of Chapter 6C and Chapter 81, Section 7C of the General Laws, as appearing in the Official Edition thereof, and acts in amendment thereof and in addition thereto, the Massachusetts Department of Transportation adjudges that public necessity and convenience require that said Department should alter the

location of said State highway, and should lay out and take charge of said State highway, as altered, with limited access provisions, as hereinafter described.

The alteration consists of revising a portion of the limited access provisions of the aforesaid State highway location, insofar as applicable to the location line thereof, being more fully described as follows:

The baselines used for the State highway hereby altered and laid out are portions of the Main baseline and the Auxiliary baseline "D" of the aforesaid August 21, 1968 State highway layout (Layout No. 5771) of Interstate Route 93.

The stations hereinafter referred to are points thereon. The coordinate system used is the Massachusetts Coordinate System North American Datum of 1983 (NAD 83).

The limited access provisions of the aforesaid August 21, 1968 State highway layout (Layout No. 5771) of Interstate Route 93 are hereby revised insofar as applicable to a portion of the easterly location line thereof, to allow access to and egress from said State highway location as follows:

Between a point thereon, bearing N 56°22'05" E and being 99.89 feet distant from station 144+56.57 of the Main baseline of the August 21, 1968 State highway layout (Layout No. 5771) of Interstate Route 93, and a point thereon, bearing N 59°07'28" E and being 119.71 feet distant from station 146+66.36 of said baseline.

The "Lines of No Transit at Ground Level" within the location lines of the State highway are hereby described, as follows:

1. Lines across which transit is not allowed at ground level are hereby established within State highway locations, as follows:

- a. Line of No Transit at ground level "A" begins at a point bearing N 55°24'25" E and being 66.48 feet distant from station 144+80.32 of the Main baseline of the aforesaid August 21, 1968 State highway layout (Layout No. 5771) of Interstate Route 93, and extends thence, N 54°21'31" E 31.68 feet; thence S 40°39'43" E 132.94 feet; thence S 30°03'31" E 19.47 feet; thence S 38°36'37" E 42.76 to the point of ending thereof, on the easterly location line of said 1968 layout, said point bearing N 59°07'28" E and being 119.71 feet distant from station 146+66.36 of said baseline.
- b. Line of No Transit at ground level "B" begins at a point bearing N 55°26'48" E and being 40.33 feet distant from station 144+82.40 of the Main baseline of the aforesaid August 21, 1968 State highway layout (Layout No. 5771) of Interstate Route 93, and extends thence, S 55°17'52" W 176.85 feet; thence by a curve to the left of 100.00 feet radius 55.86 feet with a chord bearing of S 39°17'39" W and a chord distance of 55.14 feet; thence S 23°17'26" W 14.80 feet to the point of ending thereof, on the existing Line of No Transit at ground level of the April 20, 1977 State highway alteration (Layout No. 6299) of Interstate Route 93, said point bearing S 69°29'00" E and being 33.39 feet distant from station 0+77.49 of the Auxiliary baseline "D" of the aforesaid August 21, 1968 State highway layout (Layout No. 5771) of Interstate Route 93.
- c. Line of No Transit at ground level "C" begins at a point bearing S 59°54'58" W and being 120.08 feet distant from station 146+94.00 of the Main baseline of the aforesaid August 21, 1968 State highway layout (Layout No. 5771) of Interstate Route 93, and extends thence, S 62°29'50" E 115.87 feet to the point of ending

thereof, on the dividing line between the City of Somerville and the City of Boston, said point bearing S 27°38'58" W and being 67.43 feet distant from station 147+55.82 of said baseline.

2. Portions of the existing Lines of No Transit are hereby abolished, being more fully described as follows:

- a. The restriction of transit imposed under the aforesaid August 21, 1968 State highway layout (Layout No. 5771) of Interstate Route 93 is hereby removed insofar as applicable to that "Line of No Transit" thereof extending between a point thereon bearing N 56°22'05" E and being 99.89 feet distant from station 144+56.57 of the Main baseline of said 1968 layout and a point thereon bearing S 69°29'00" E and being 31.00 feet distant from station 0+90.00 of the Auxiliary baseline "D" of said 1968 layout.
- b. The restriction of transit imposed under the aforesaid August 21, 1968 State highway layout (Layout No. 5771) of Interstate Route 93 is hereby removed insofar as applicable to that "Line of No Transit" thereof extending between a point thereon bearing S 59°54'58" W and being 120.08 feet distant from station 146+94.00 of the Main baseline of said 1968 layout and a point thereon bearing S 27°38'58" W and being 67.43 feet distant from station 147+55.82 of said baseline.
- c. The restriction of transit imposed under the aforesaid April 20, 1977 State highway alteration (Layout No. 6299) of Interstate Route 93 is hereby removed insofar as applicable to that "Line of No Transit" thereof extending between a point thereon bearing S 69°29'00" E and being 33.39 feet distant from station

0+77.49 of the Auxiliary baseline "D" of the aforesaid August 21, 1968 State highway layout (Layout No. 5771) of Interstate Route 93 and a point thereon bearing S 69°29'00" E and being 31.00 feet distant from station 0+90.00 of the said baseline.

The above described access-egress restrictions are more particularly shown on the plan to which reference is hereinafter made.

The State highway hereby altered and laid out is shown on a plan signed by the Chief Engineer and signed by the Massachusetts Department of Transportation, Highway Division, and on file in its office, said plan being entitled:

"MASSACHUSETTS DEPARTMENT OF TRANSPORTATION

PLAN OF ROAD IN THE CITY OF

SOMERVILLE

MIDDLESEX COUNTY

ALTERED AND LAID OUT AS A STATE HIGHWAY

BY THE MASSACHUSETTS DEPARTMENT

OF TRANSPORTATION, HIGHWAY DIVISION

MAY 24, 2023

SCALE: 20 FEET TO THE INCH (EXCEPT AS NOTED)"

an original of which is to be recorded with this "Order of Layout and Taking" in the Registry of Deeds for Middlesex County, Southern District, at Cambridge.

THE COMMONWEALTH OF MASSACHUSETTS

Suffolk, ss.

On this 24th day of May, 2023, before me, the undersigned notary public, personally appeared John DeLeire, the Director, Right of Way Bureau for the Massachusetts Department of Transportation, whose name is signed on the preceding document, and such person acknowledged to me that he signed such document voluntarily for its stated purpose. The identity of such person was proved to me through satisfactory evidence of identification, which was personal knowledge of the undersigned.

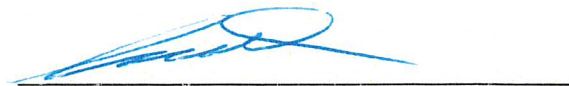

Notary Public

My commission expires: 10-28-2027



CAROL A. FRANKLIN
Notary Public
Commonwealth of Massachusetts
My Commission Expires
October 28, 2027

I CERTIFY THAT THIS PLAN HAS BEEN PREPARED IN CONFORMITY WITH THE RULES AND REGULATIONS OF THE REGISTER OF DEEDS OF THE COMMONWEALTH OF MASSACHUSETTS.

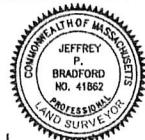

4/28/2023 DATE
 Jeffrey P. Bradford
 JEFFREY P. BRADFORD, PLS #41862

NOTES:

1. THE ALTERATION CONSISTS ONLY OF REVISING THE LIMITED ACCESS PROVISIONS OF THE AUGUST 21, 1968 STATE HIGHWAY LAYOUT (LAYOUT NO. 5771) AND THE APRIL 20, 1977 STATE HIGHWAY ALTERATION (LAYOUT NO. 6299) AS SHOWN ON THIS PLAN.
2. THE EXISTING MONUMENTATION SHOWN ON THIS PLAN AND THE LOCATION OF THE EXISTING LAYOUT LINES ARE FROM A SURVEY BASEPLAN PREPARED BY BRYANT ASSOCIATES, INC. IN OCTOBER 2018.

PLAN PREPARED BY:
 GREENMAN-PEDERSEN, INC.
 181 BALLARDVALE STREET, SUITE 202
 WILMINGTON, MASSACHUSETTS 01887
 (978) 570-2999 WWW.GPINET.COM

CONTINUED ON SHEET NO. 2

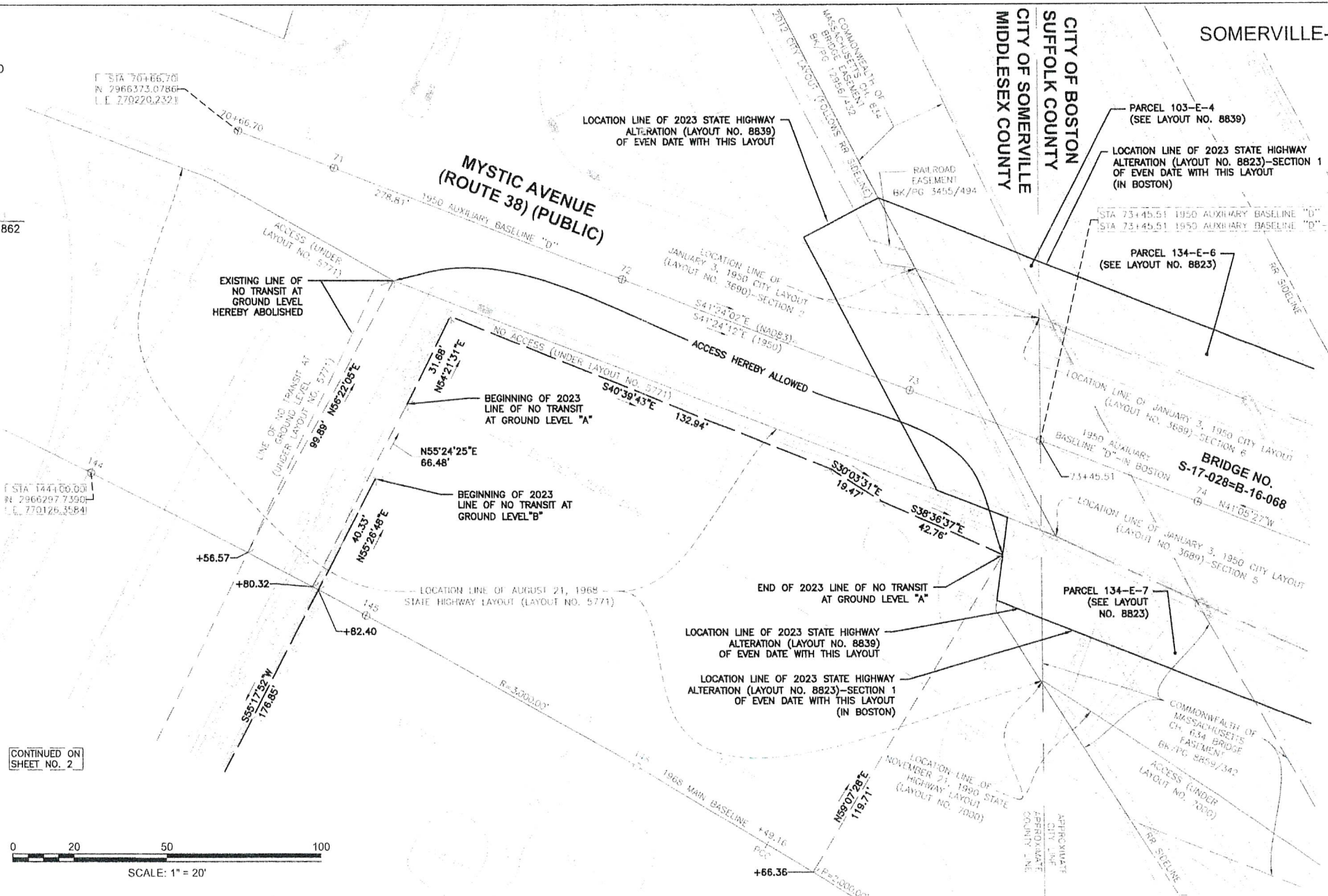
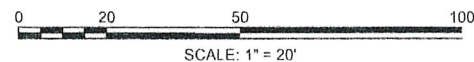

SOMERVILLE-2023 ALTERATION-SHEET 1 OF 4 SHEETS
 PROJECT FILE NO. 607670
 LAYOUT NO. 8899
 LIMITED ACCESS



THIS CERTIFIES THAT THE LOCATION OF THE STATE HIGHWAY HAS BEEN ALTERED AS SHOWN ON THIS PLAN AND THAT SAID HIGHWAY AS ALTERED WAS LAID OUT AND TAKEN CHARGE OF AS A LIMITED ACCESS STATE HIGHWAY BY THE MASSACHUSETTS DEPARTMENT OF TRANSPORTATION, HIGHWAY DIVISION ON MAY 24, 2023 IN ACCORDANCE WITH CHAPTER 6C AND CHAPTER 81 OF THE GENERAL LAWS.

[Signature]
 MASSACHUSETTS DEPARTMENT OF TRANSPORTATION
 DIRECTOR, RIGHT OF WAY BUREAU

MASSACHUSETTS DEPARTMENT OF TRANSPORTATION
 PLAN OF ROAD IN THE CITY OF
SOMERVILLE
 MIDDLESEX COUNTY
 ALTERED AND LAID OUT AS A STATE HIGHWAY
 BY THE MASSACHUSETTS DEPARTMENT
 OF TRANSPORTATION, HIGHWAY DIVISION
 MAY 24, 2023
 SCALE: 20 FEET TO THE INCH (EXCEPT AS NOTED)

[Signature]
 CHIEF ENGINEER LAYOUT NO. 8899

SOMERVILLE-2023 ALTERATION-SHEET 3 OF 4 SHEETS
 PROJECT FILE NO. 607670
 LAYOUT NO. 8899
 LIMITED ACCESS
 (BOUNDARY DETAIL SKETCH SHEET)

BOUNDARY DETAIL SKETCH 1 (IN BOSTON)
 SCALE: 1"=20'

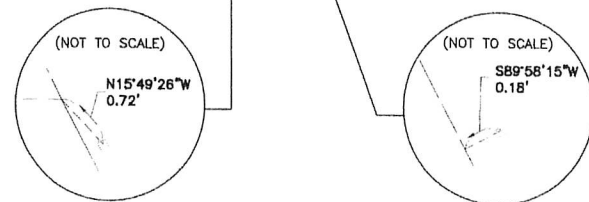
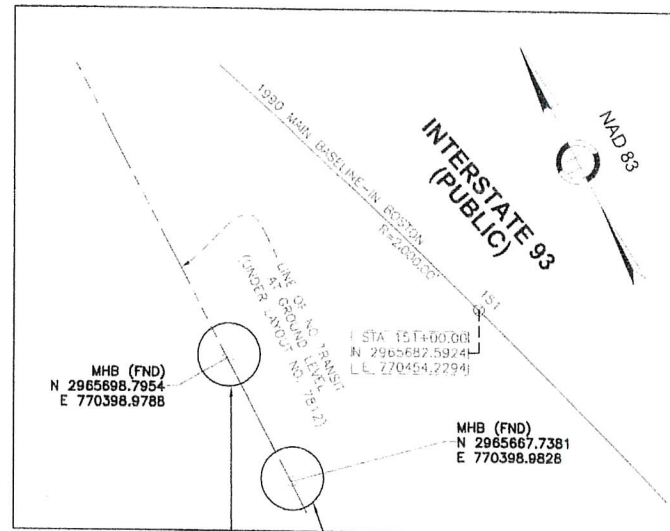

BOUNDARY DETAIL SKETCH 2 (IN BOSTON)
 SCALE: 1"=20'

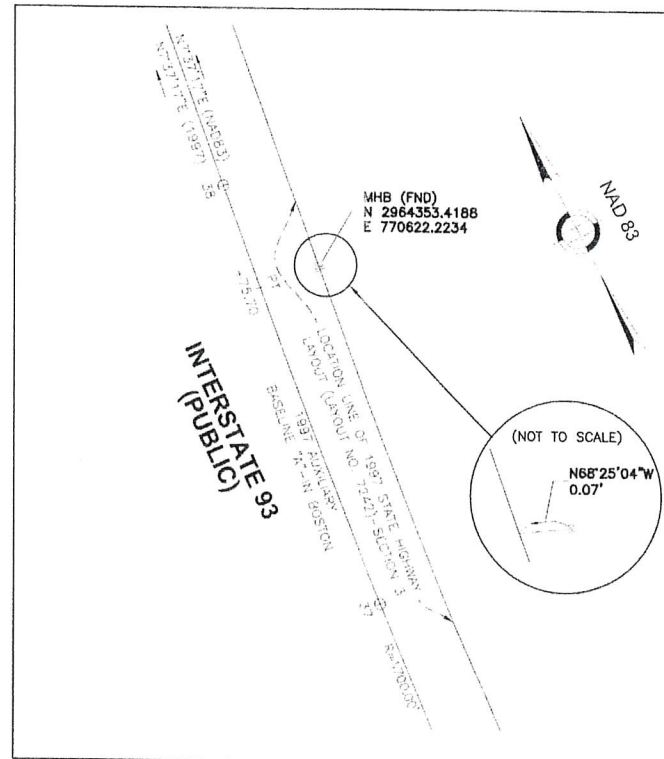

BOUNDARY DETAIL SKETCH 3
 SCALE: 1"=20'

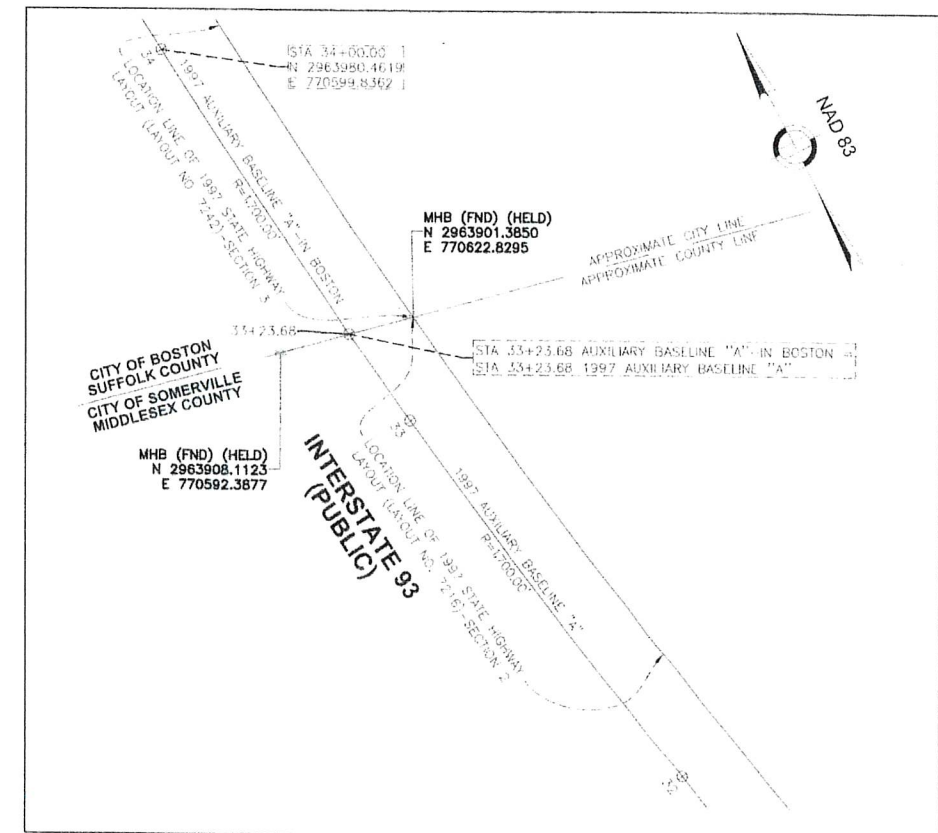

I CERTIFY THAT THIS PLAN HAS BEEN PREPARED IN CONFORMITY WITH THE RULES AND REGULATIONS OF THE REGISTERS OF DEEDS OF THE COMMONWEALTH OF MASSACHUSETTS.



4/29/2023
 DATE
 Jeffrey P. Bradford
 JEFFREY P. BRADFORD, PLS #41862

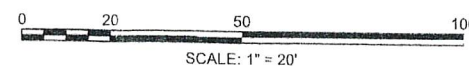

PLAN PREPARED BY:
 GREENMAN-PEDERSEN, INC.
 181 BALLARDVALE STREET, SUITE 202
 WILMINGTON, MASSACHUSETTS 01887
 (978) 570-2999 WWW.GPINET.COM

SOMERVILLE-2023 ALTERATION-SHEET 4 OF 4 SHEETS
 PROJECT FILE NO. 607670
 LAYOUT NO. 8899
 LIMITED ACCESS
 (KEY SHEET)

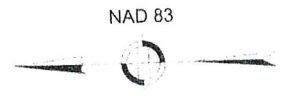
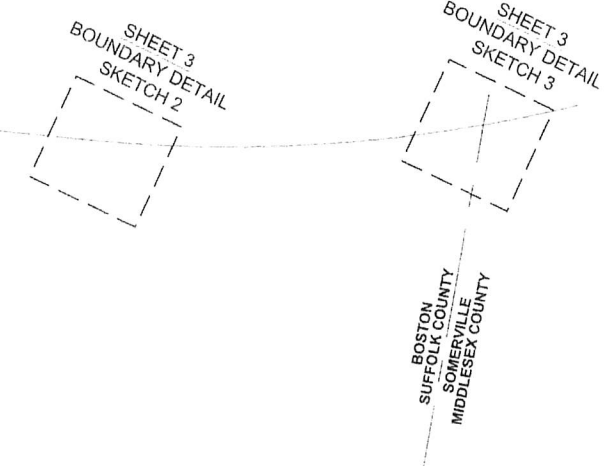
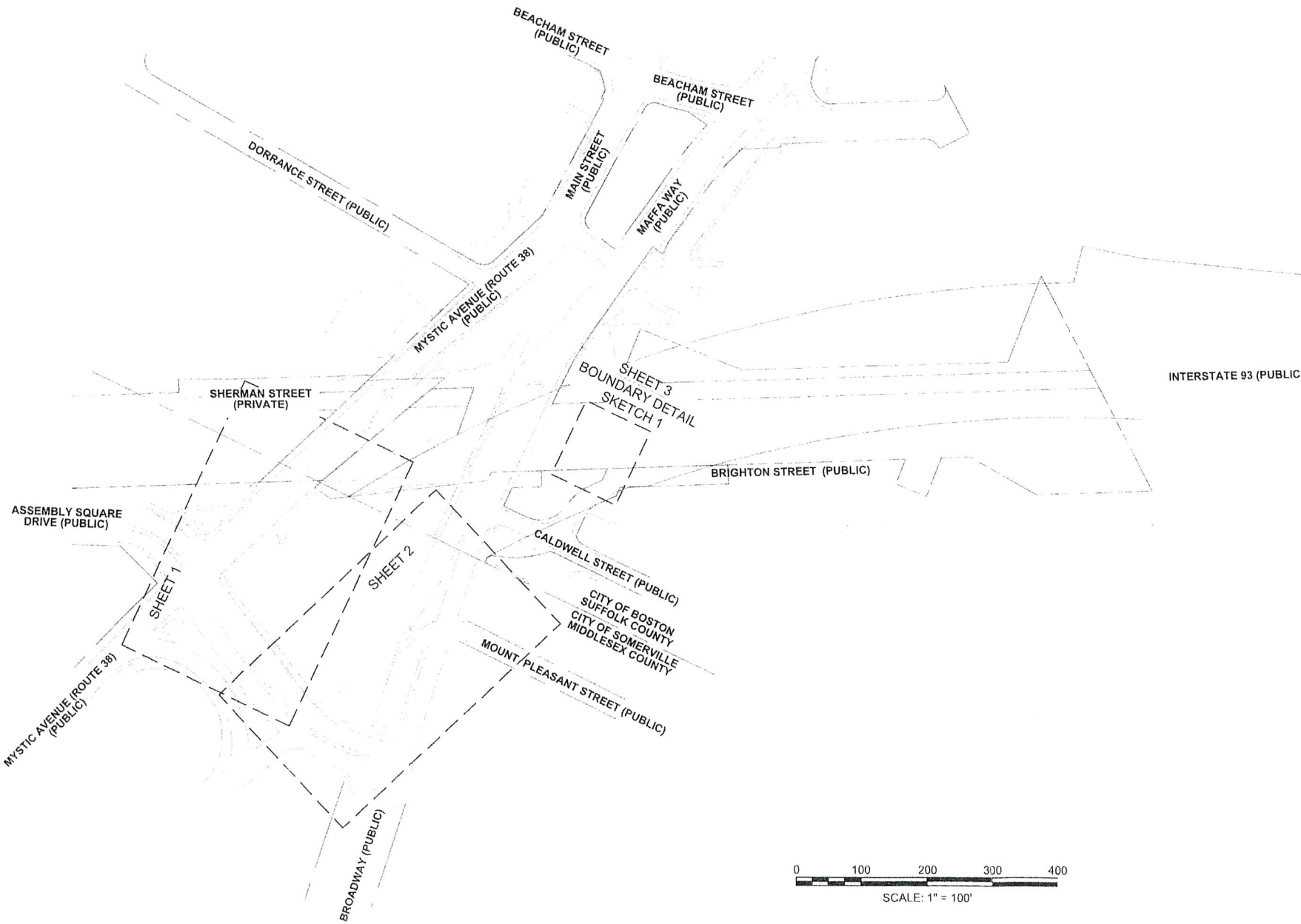

PLAN PREPARED BY:
 GREENMAN-PEDERSEN, INC.
 181 BALLARDVALE STREET, SUITE 202
 WILMINGTON, MASSACHUSETTS 01887
 (978) 570-2999 WWW.GPINET.COM

I CERTIFY THAT THIS PLAN HAS BEEN
 PREPARED IN CONFORMITY WITH THE RULES AND
 REGULATIONS OF THE REGISTERS OF DEEDS OF
 THE COMMONWEALTH OF MASSACHUSETTS.



4/20/2023
 DATE
 Jeffrey P. Bradford, PLS #41862