



CITY OF SOMERVILLE
Commonwealth of Massachusetts
93 Highland Avenue
Somerville, MA 02143
(617) 625-6600

BUSINESS LICENSE APPLICATION - Grant of Location

File #: 24-003160

License #: BL24-000041

Address: 307 MEDFORD

Licensee: Angel Hart NSTAR Electric dba Eversource Energy

DBA Name: NSTAR ELECTRIC COMPANY D/B/A EVERSOURCE ENERGY

Business Ownership Type: Corporation

Legal Name of Entity: NSTAR ELECTRIC COMPANY D/B/A EVERSOURCE ENERGY

Owners/Officers: JOSEPH NOLAN JR, , ,

License Information:

Grant of location issued to: NSTAR ELECTRIC COMPANY D/B/A EVERSOURCE ENERGY

Describe the reason for the work, and the intended beneficiaries: This work is necessary to provide service to 307 Medford Street.

Insert here the same detailed description of the work as appears in the attached Grant of Location Order: Northwesterly then Northeasterly from MH27346, northwest of Walnut Street, to private property at #307 Medford Street, install approximately 44 feet of conduit WO# 14743086

Approval Conditions:

Approved By:

Isabela Maia, Approved with Conditions

APPROVAL CONDITION IMM 240216: Concrete sidewalk to be restored in-kind after conduit installation.

APPROVAL CONDITION IMM 240216: Any work requiring the use of the street and/or sidewalk will require a Street/Sidewalk Occupancy Permit from the Engineering Department. Apply via Citizen Serve before conduit installation.

Malik Drayton, Approved with Conditions

APPROVAL CONDITION: MD20240220: Contractor shall take all necessary precautions to avoid damaging any tree or tree part with equipment.

APPROVAL CONDITION: MD20240220 All nearby street tree(s) shall be protected prior to and during all construction activities using TREE BOX or TREE WRAPS. . TREE BOX shall be constructed from 2 in. x 4 in. lumber creating a box around the border of the tree pit with 2 in. x 4 in. lumber standing straight up at the corners and wrapped with orange snow fence. Detail attached. . TREE WRAPS

(TREE TRUNK WRAPPING PROTECTION LUMBER) shall consist of 2 in. x 4 in. and 8 ft. height lumber wired together in close spacing with zip ties or 16 gauge galvanized steel wire to form a protective enclosure around tree trunks. Use burlap to separate the wood from the bark if necessary to prevent wood from scraping or bruising bark. Do not use staples or puncture the trunk in any way.

APPROVAL CONDITION: MD20240220: Any tree roots less than two (2) inches in diameter that cannot be avoided during construction shall be carefully and cleanly cut with a clean pair of pruning shears or loppers. Roots are to be cut back flush with the edge of the trench. If any tree roots greater than two (2) inches in diameter are encountered, stop work immediately and contact the City Urban Forester. Any and all pruning of roots greater than 2 inches in diameter must be completed under the supervision of the City Urban Forester.

Eric Weisman, Approved

Kimberly M. Wells, Approved



CITY OF SOMERVILLE, MASSACHUSETTS
CITY CLERK'S OFFICE
KATJANA BALLANTYNE
MAYOR

KIMBERLY M. WELLS
CITY CLERK

March 5, 2024

NOTICE OF PUBLIC HEARING

You are hereby notified that the Somerville City Council will hold a Public Hearing on the following Petition. You are receiving this Notice because the Petitioner has reported that you own property that abuts the work that is being proposed. You and other members of the public are invited to attend and be heard at this Hearing.

This meeting of the City Council will also be conducted via remote participation, online in a webinar hosted on the Zoom platform.

You have three ways to be heard at this meeting:

1. To attend and be heard, enter the link exactly as it appears below into your internet browser any time before the meeting. You will then be asked to register for the meeting. After registering, you will receive an email with instructions to join the webinar when it starts.
2. You may also testify in person in the City Council Chamber, City Hall, 2nd Floor, 93 Highland Avenue, Somerville, MA 02143
3. If you are unable to attend but wish to be heard, you may send written comments by US mail to the City Clerk at the address below, or by email to cityclerk@somervillema.gov. Your comments must arrive no later than 12 Noon on the day of the Hearing, in order to be sure they are conveyed to the Council.

PETITION: Eversource (NStar Electric) is applying for a Grant of Location to install 44 feet of conduit in Medford Street, from Manhole 27346 to a point of pickup at 307 Medford Street.

PLACE: https://us02web.zoom.us/webinar/register/WN_FnziYDLPT0qTcQbGkL9bbw or City Council Chambers, City Hall, 2nd Floor, 93 Highland Avenue, Somerville, MA 02143

TIME: Thursday, March 14, 2024, at 7:00 PM.

PURPOSE: The work is necessary to provide service to 307 Medford Street.

W.O. 14743086

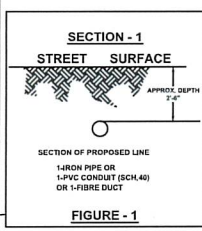
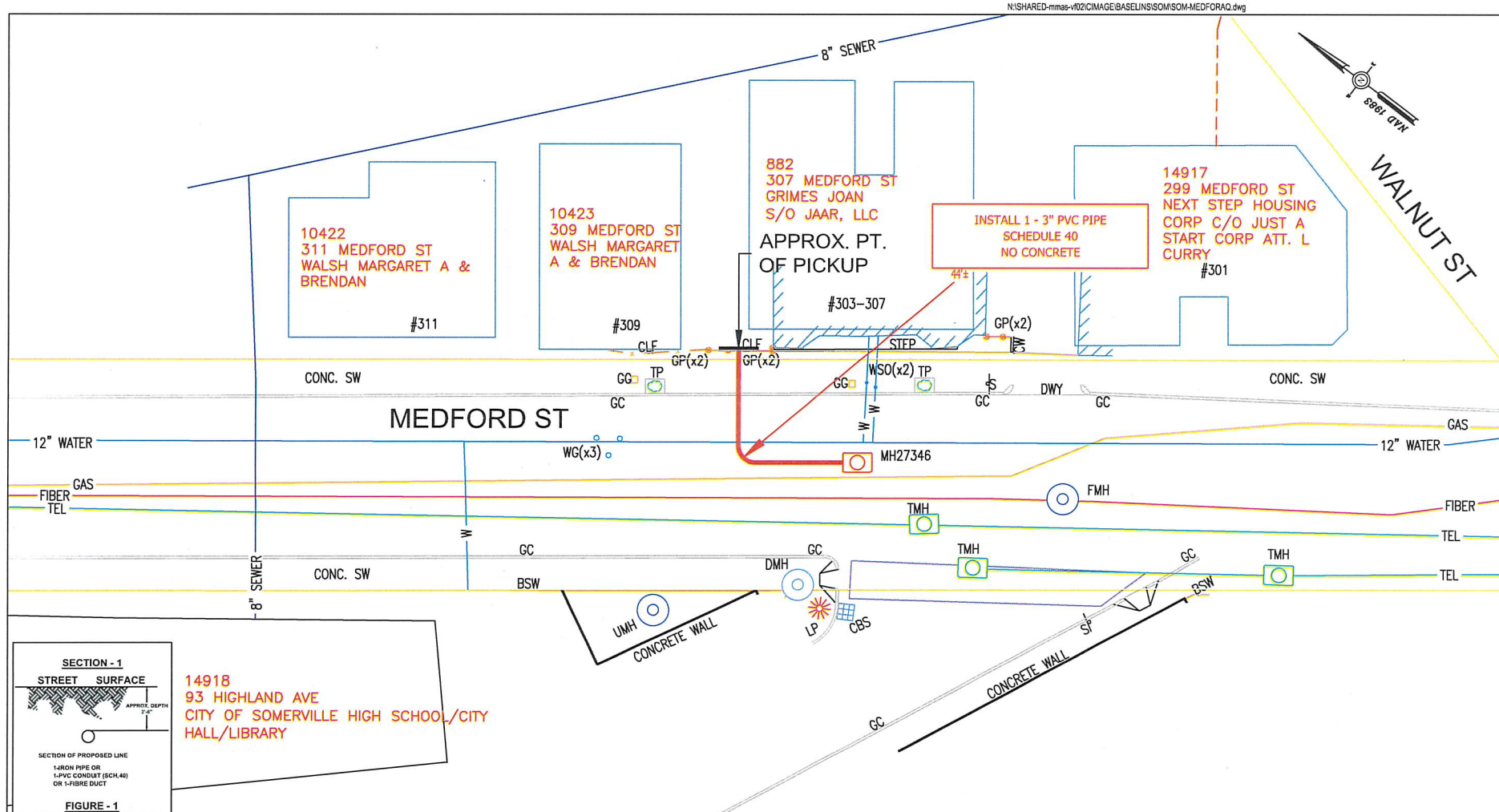
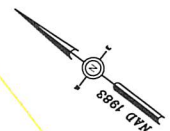

14918
93 HIGHLAND AVE
CITY OF SOMERVILLE HIGH SCHOOL/CITY
HALL/LIBRARY

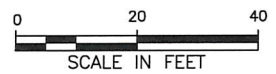

BY YOUR USE OF THE INFORMATION CONTAINED IN THIS MAP, YOU AGREE THAT NO WARRANTY OF ANY KIND, EXPRESS OR IMPLIED, IS GIVEN WITH RESPECT TO THE INFORMATION. NEITHER NESTAR ELECTRIC COMPANY, NESTAR GAS COMPANY NOR ITS PARENTS, AFFILIATES, OFFICERS, DIRECTORS, SHAREHOLDERS, EMPLOYEES OR AGENTS (COLLECTIVELY THE "NEMAP ENTITIES") SHALL BE LIABLE FOR ANY LOSS OF INQUIRY CAUSED BY RELIANCE ON OR IN FRAY OF USE OF THIS INFORMATION, OR IN RELIANCE UPON IT, TO THE EXTENT PERMITTED BY LAW. YOU AGREE BY YOUR ACCEPTANCE OF THE INFORMATION TO RELEASE, HOLD HARMLESS AND HOLD THE NEMAP ENTITIES HARMLESS FROM ANY SUCH LOSS OR INQUIRY.

THE INFORMATION MAY NOT REPRESENT A SURVEY, MAY NOT BE THE MOST COMPLETE AND IS SUBJECT TO CHANGE WITHOUT NOTICE. NO LIABILITY IS ASSIGNED FOR THE ACCURACY OF THE INFORMATION, EITHER EXPRESSLY OR IMPLIED, UNAUTHORIZED ATTEMPTS TO MODIFY THE INFORMATION OR USE THE INFORMATION FOR OTHER THAN ITS INTENDED PURPOSES ARE PROHIBITED.

MASS. LAW
REQUIRES 72 HOURS ADVANCE NOTICE TO UTILITY COMPANIES
BEFORE DIGGING BY ANYONE. CALL DIG-SAFE 1-888-344-7233

C# 297-23
Ward #
Work Order # 14743086
Surveyed by: BP/GC
Research by: BP
Plotted by: TL/ZA
Proposed Structures: TL
Approved: T THIBAUT
P#

NSTAR EVERSOURCE ELECTRIC d/b/a	
1165 MASSACHUSETTS AVE. DORCHESTER, MASS. 02125	
Plan of MEDFORD STREET SOMERVILLE, MA	
Showing PROPOSED CONDUIT LOCATION	
Scale 1"=20'	Date NOVEMBER 17, 2023
SHEET 1 of 1	

JAAR, LLC
66 HINCKLEY ST
SOMERVILLE, MA 02145

NEXT STEP HOUSING CORP
1035 CAMBRIDGE ST #12
CAMBRIDGE, MA 02141 USA

WALSH MARGARET A & BRENDAN
7 WINTER ST
EVERETT, MA 02149 USA